



# Cabinet Systems Manual

*Effective Spring 2007*

## **Section 3: Specifications**

Cabinetmaker's Choice (r-1169)

P.O. Box 729

Newtown, CT 06470-0729

Neil Ratner- Phone: (203) 426-3247 Fax: (203) 270-9994 Email: sales1@cabinetmakerschoice.com

Chad Witwer - Phone: (717) 823-6204 Fax: (717) 427-1743 Email: sales2@cabinetmakerschoice.com

© 2007 Conestoga Wood Specialties Corporation. All the information contained herein is thought to be accurate at the time of printing. However, no responsibility is assumed by Conestoga Wood Specialties Corporation or Cabinetmaker's Choice, LLC. All rights reserved. Reproduction of any part of this publication without the express written permission of Conestoga Wood Specialties Corporation is a violation of applicable laws. Order forms may be reproduced without notice to Conestoga Wood Specialties Corporation provided they are used to order Conestoga Wood Specialties Corporation products. All prices and specifications are subject to change without notice. All pictures and graphics are for visual representation only. This publication supersedes all prior technical, policy and price data.

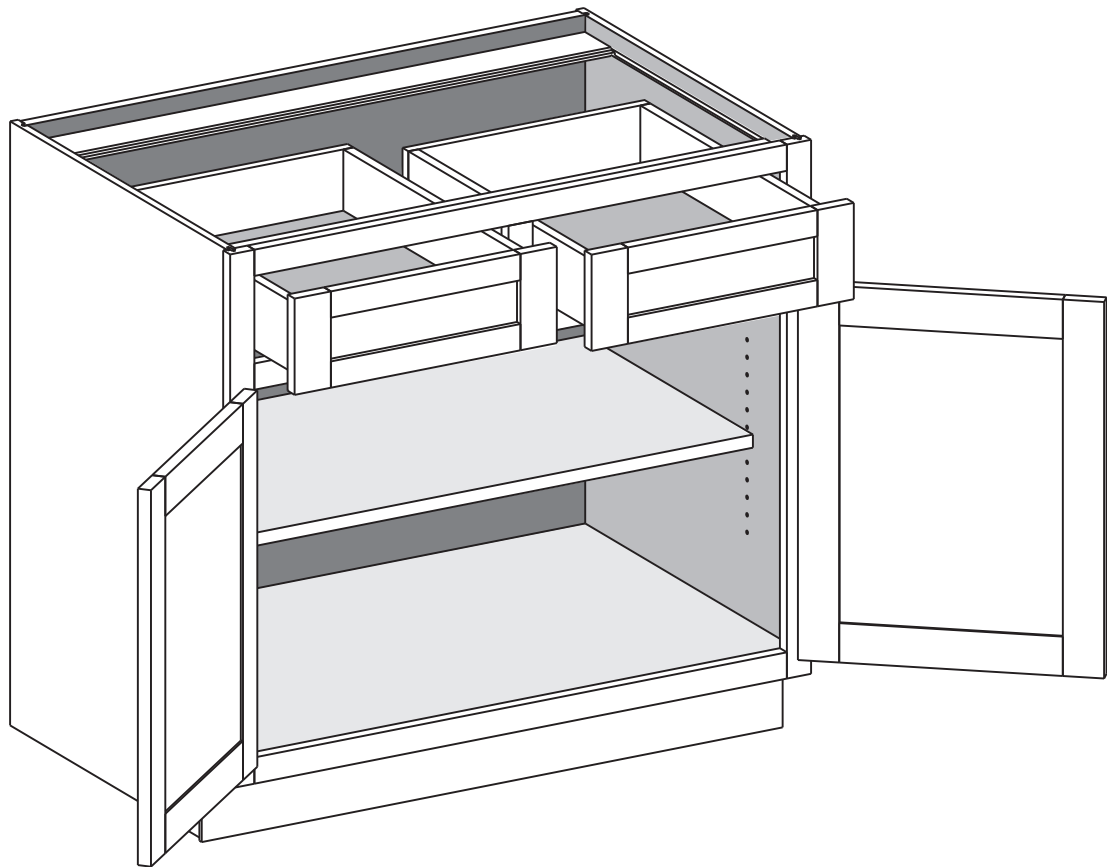
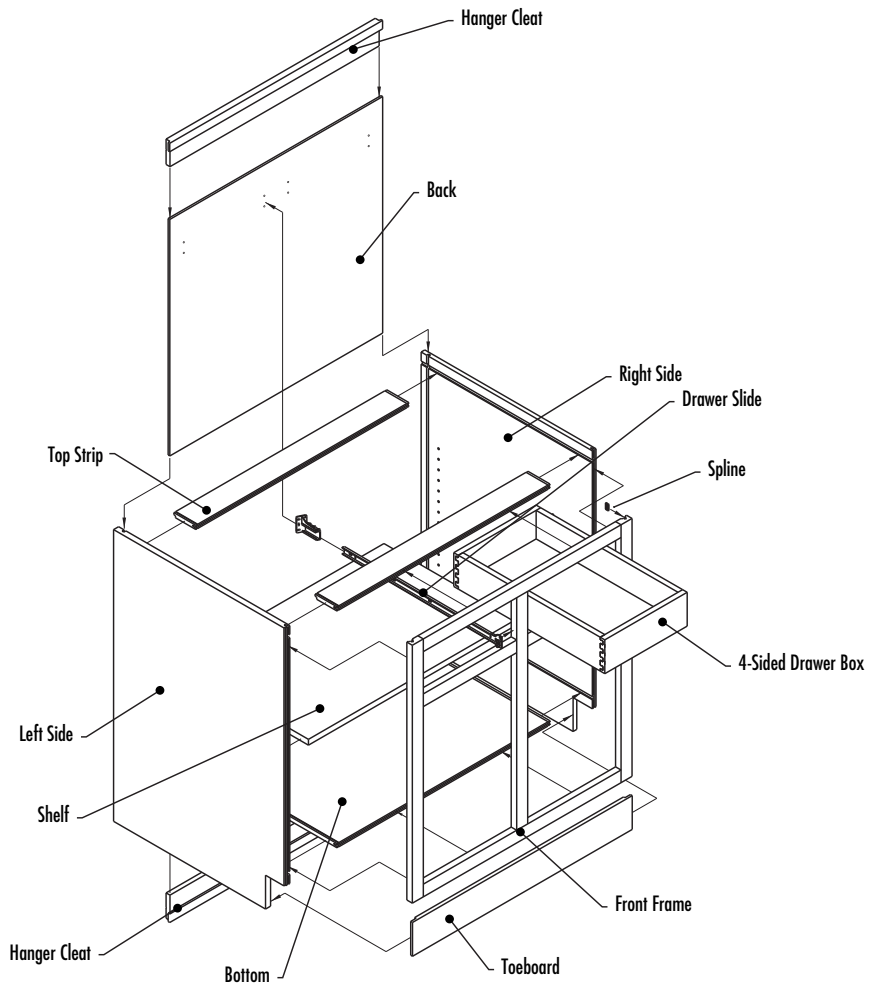



## Craftsman line "All Wood Series"

---

- **Front Frames:** 3/4" thick solid wood with 1-1/2" wide stiles and rails unless otherwise specified. Blind mortise and tenon joints. Any other configuration must be ordered as a custom front.
- **Cabinets Backs:** 1/4" thick 3-ply plywood with Birch face and Luan back. 3" high, 3/4" thick solid wood hanger cleats provided for top and bottom.
- **Cabinet Tops:** 1/2" thick 7-ply plywood with Birch veneer on both sides. Most base cabinets, including vanities, have open tops with two 1/2" thick by 3" deep plywood support strips running across the full width of the cabinet in the front and back.
- **Cabinet Bottoms:** 1/2" thick 7-ply plywood with Birch veneer on both sides.
- **Cabinet Sides:** 1/2" thick 7-ply plywood with Birch veneer on both sides. Matching veneer on the exterior face for cabinets ordered with exposed or 11/16" flush ends. Matching veneer on the inside for cabinets ordered with matching interior.
- **Drawer Sides and Backs:** Three-sided, French dovetail construction standard. 1/2" thick with bull nose on the top edge. Drawer sides slotted to receive bottom. Optional 5/8" thick four-sided, eased top edge, dovetailed drawer boxes available at an upcharge (standard with 1-1/4" and 1-3/8" overlays). See Options section for additional four-sided drawer box options.
- **Drawer Bottoms:** 1/4" thick plycore with Birch face and Luan back. Optional 3/8" thick MDF core bottoms with Hard Maple veneer on both faces is available on four-sided assembled drawer boxes. Additional upcharges apply.
- **Shelves:** 11/16" thick solid wood with a bull nose on front edge. Shelves adjustable in 32mm increments.
- **Toeboards:** Optional 4" high solid wood toeboard. All units priced without toeboards. Also available in 4" high x 8' long x 1/2" thick plywood strips in Red Oak, Hard Maple, Cherry or Hickory.

### Prefinished Interior Specifications (Craftsman line)

---

- Clear finished interiors are standard in the Craftsman line. Clear finish is on interior sides, shelves, backs, tops and bottoms. Optional unfinished interiors are available and must be specified per cabinet in the Special Instructions area of the order form.
- Matching specie interior cabinets are unfinished (typically these items are finished by the customer to match exterior finish). Drawer box parts do not apply.
- Finished interior cabinet surfaces are not designed to be painted. Scuff sanding with 220 grit paper and painting with a high quality latex or solvent paint may be effective but will void all warranties.
- Prefinished, solid wood shelves are standard in the Craftsman line and optional on Pioneer cabinets with the solid wood shelf upgrade.
- Prefinished, three-sided drawer boxes are standard for 1/4" and 1/2" overlays. A clear topcoat is applied to all three-sided drawer boxes.
- Optional four-sided, dovetailed, 5/8" thick drawer boxes are available prefinished only if ordered assembled. Unassembled four-sided drawer boxes are not available prefinished. Assembly and finish carry an additional upcharge.



## Pioneer line

---

- **Front Frames:** 3/4" thick solid wood with 1-1/2" wide stiles and rails unless otherwise specified. Blind mortise and tenon joints. Any other configuration must be ordered as a custom front.
- **Cabinet Backs:** 1/4" thick hardboard. 3" high, 3/4" thick solid wood hanger cleats provided for top and bottom.
- **Cabinet Tops:** 1/2" thick particle board. Most base cabinets, including vanities, have open tops with two 1/2" thick by 3" deep plywood support strips running across the full width of the cabinet in the front and back.
- **Cabinet Bottoms:** 1/2" thick particle board.
- **Cabinet Sides:** 1/2" thick particle board. Matching veneer on the outside for cabinets with exposed ends.
- **Drawer Sides and Backs:** Three-sided, French dovetail construction standard. 1/2" thick with bull nose on the top edge. Drawer sides slotted to receive bottom. Optional 5/8" thick four-sided, eased top edge, dovetailed drawer boxes available at an upcharge (standard with 1-1/4" and 1-3/8" overlays). See Options section for all additional four-sided drawer box options.
- **Drawer Bottoms:** 1/4" thick plycore with Birch face and Lauan back.
- **Toeboards:** Optional 4" high solid wood toeboard. All units priced without toeboards. Also available in 4" high x 8' long x 1/2" thick plywood strips in Red Oak, Hard Maple, Cherry or Hickory.
- **Shelves:** 3/4" thick particle board with banded front edge. Shelves adjustable in 32mm increments. Optional upgrade to 11/16" thick solid wood shelf available.

## Particle Board Specifications (Pioneer line)

---

- All particle board laminated on both sides using a maple wood grain paper. Cabinet backs are laminated on one side only.
- During period of high humidity, particle board will have a tendency to take on moisture and expand in thickness, length and width. During this time parts may require additional care in assembling as there may be a tighter fit than usual between the dovetailed parts.
- To help avoid moisture absorption, keep all parts packaged until ready to assemble. Keep parts stacked on top of each other, not on open racks. Keep parts away from open doors leading to the outside.

## Specie Specifications

---

- **Red Oak: Value Grade Doors and Standard Grade Front Frames \***  
Panels are similar in color. Panels containing all sapwood are not allowed. Light to medium color is acceptable. Mineral and pin knots will be present. Framing color may vary from panel.
- **Cherry: Value Grade Doors and Standard Grade Front Frames \***  
Panels may vary in color. Panels and framing will contain sapwood. Mineral and pin knots may be present. Framing color may vary from panel.
- **Hickory: Standard Grade Doors and Front Frames**  
Contrasting colors are present within panels. Light to medium gray shades are acceptable. Mineral and small to medium peck is unlimited. Small sound knots and/or pin knots may be present. Framing color may vary from panel, but is similar.



• **Soft Maple: Standard Grade Doors and Front Frames**

Panels are matched for color and grain. Minor shade variations with light gray and blue are acceptable. Mineral and pin knots may be present. Framing color may vary from panel, but is similar. Heartwood may appear in profiled areas. Not available in Premium grade.

• **Hard Maple: Standard Grade Doors and Front Frames**

Panels are matched for color and grain. Minor shade variations are acceptable. Mineral, pin knots and curly grain may be present. Framing color may vary from panel, but is similar. Heartwood may appear in profiled areas.

\* Red Oak and Cherry doors are also available in Standard and Premium grade, Hard Maple is available in Premium grade with no additional lead-time. Upcharges apply. Door options must match those offered on program doors to be eligible for the seven day lead-time.

**Specie and Grade Characteristics**

---

**Why Have Different Grades?**

Conestoga has developed different grades of material in order to utilize natural resources to the fullest, and to provide valued customers the choices needed to fulfill their customers' expectations. Conestoga's grading system for material used in the manufacturing process allows our customers to produce a quality product at a competitive price. Three distinct grades are available. The best grade, "Premium" is for that discerning application when clear or very light finishes are used. For most applications, Conestoga's "Standard" grade of material is acceptable. "Value" grade can be used when a more natural look is desired, when darker finishes are going to be used, or when a painted application is desired. See section 3 of the Custom Product Manual for additional specie and grade information.

**Premium Grade**

Conestoga's "Premium" grade was developed for those jobs where a more uniform look is needed. This grade contains less natural material characteristics and produces a much narrower range of color differences.

Premium orders are matched to obtain a look that is as uniform as possible; however, since each board is different, there may be slight differences in appearance and color between pieces. Premium products contain fewer and smaller mineral streaks and knots than Standard grade. A Premium grade order is consistent throughout for color and material characteristics.

In "heartwood" species, such as Red Oak or Cherry, no sapwood is seen on the face of the door, and in other "sapwood" species such as Maple, no heartwood is seen on the face. This includes machined areas from a normal viewpoint after installation.

Premium grade is what Conestoga recommends for natural and transparent finishes.

Pecan/Hickory is an exception to normal Premium grade guidelines in that the color variations and lack of uniformity are a characteristic of this specie. A Premium grade of this specie will include a narrower range of variation, but will not be uniform in heartwood or sap color.

**Standard Grade**

Conestoga's "Standard" grade of material was developed to meet a wide variety of applications and to provide a very versatile product at a reasonable cost. Standard grade material allows for many natural characteristics of the wood to be present in the product while limiting or eliminating the most objectionable. This allows Conestoga to utilize as much of the natural resource as possible and still produce a product that meets the needs of our customers.

Even though each board has its own individual appearance as to color and grain, panels are matched for a pleasing appearance. Colors are blended within each door, and character marks such as knots and mineral streaks are strictly limited in size and amount in most species.

In "heartwood" species such as Red Oak or Cherry, the amount of sapwood present on the face of a door is strictly limited and will only be present in the machined areas. Conversely, in sapwood species such as Maple, the heartwood is limited and will only show in the machined areas.



This grade works very well with most finishes. Lighter and clear finishes may tend to accentuate the natural color differences within the product and may not be pleasing to some people. If unsure of the appearance with the required finish, two or more sample doors should be ordered and finished prior to ordering the entire job.

### **Value Grade**

Conestoga's "Value" grade material was developed as an alternative price point product for medium and darker finishes and only available in Red Oak and Cherry. This grade provides increased utilization of natural resources by allowing more color variations and other natural characteristics than our Standard grade.

While each board has its own individual appearance as to color and grain, panels are moderately matched for color. Sapwood may be present on the face. Character marks such as pin knots and mineral streaks, although limited in size and amount, are more prevalent and numerous than in Conestoga's Standard grade.

This grade works very well with most medium to dark finishes. Light and natural finishes will accentuate the natural color differences within the product and may not be pleasing to some people. If unsure of the appearance with the required finish, two or more sample doors should be ordered and finished prior to ordering the entire job.

## **Accessory Specifications**

---

- **Lazy Susan**

Rev-A-Shelf almond molded plastic, independently rotating shelves.

- **Wood Susan**

Prefinished plywood susan with durable laminated wooden edge. Designed for use without a center pole. Ring bearings are included per susan.

- **Drawer Slides**

- **Bottom Lip Mount 3/4 extension – Blum STANDARD 230**

- Epoxy coated and self-closing with rear mount screw-in boot. 75 lb. dynamic load capacity. Standard with three-sided or four-sided drawer boxes.

- **Undermount 3/4 extension – Blum SOLO**

- Epoxy coated and self-closing with rear mount screw-in boot. 75 lb. dynamic load capacity. Optional with four-sided drawer boxes only.

- **Undermount Full extension – Blum TANDEM plus 562**

- Zinc coated steel and self-closing with rear mount screw-in bracket. 75 lb. dynamic load capacity. Optional with four-sided drawer boxes only.

- **Side Mount – Full Extension Ball Bearing**

- Chrome plated steel ball-bearing slide for 12-1/2" deep wall cabinets, POT's and Home Office cabinets only. 75 lb. dynamic load capacity.

- **Shelf Rests**

- Brass-plated 5mm diameter metal shelf rests. Optional plastic shelf lock clips sold in quantities of 100.

- **Pie-Cut Soss Hinge**

- Polished brass colored Soss hinge option available on Base Lazy Susan and Wall Corner Pie-cut cabinets only. Routing for Soss hinges are spaced 18" apart and entered on the edge of the door. This rout will be the same for all cabinet heights and overlays. Maximum door height is 42".



- **Vanity Tri-View Mirror Hardware**

Chrome plated single touch hinge and strike plate set.

- **Tambour Door Track**

Spring tension track system with opening control similar to a window shade. Tambour door is a balanced construction veneer core to prevent warping.

Cabinet Systems accessories subject to change. Replacement items will maintain similar specifications.