

Allure

Specifications Guide / Valid thru July 2022

Please Note: Items are subject to change without prior notice. This spec book is missing some updated information, so to stay up to date with product specifications and modification options please use our new digital spec book which can be found at <https://ezpricing.fabuwood.com/specbook>

Construction Specifications

Doors and Drawer Fronts:

Doors and drawer fronts in the Allure line are made of solid wood stiles and rails joined together using mortise and tenon joints with an MDF center panel to reduce the possibility of shrinkage and is the preferred material for painted finishes.

Hinges:

Compact Blumotion soft-close mechanism integrated in concealed six-way adjustable hinges.* Hinges open at 110°. Please note: Lazy Susan, Easy Reach and Pie Cut cabinets do not feature the soft-close mechanism.

*NOTE: Luna door style comes standard with Blum Compact Clip Hinge with Quick-Release technology.

Drawers:

The Allure line includes a 5/8" thick solid wood dovetail drawer box with a 3/8" plywood bottom attached to Tandem plus Blumotion full extension soft-closing concealed drawer runners. Interior drawer height is 3".

Shelving:

18mm (3/4") thick select veneered plywood with matching wood veneer edge banding is used on all wall, tall, and base cabinetry where applicable. The adjustable shelves are supported by metal shelf clips. All standard depth base cabinetry includes an 18" deep adjustable shelf, wall cabinetry 10 5/8" deep adjustable shelves, and tall cabinetry 21" deep adjustable shelves.

Cabinet Sides, Backs, Tops and Bottoms:

1/2" thick veneered plywood with natural finished interiors, dovetailed side panels engineered to create a solid integrated cabinet box. Backs are stapled and screwed into place for additional support.

Face Frame:

3/4" x 1 1/2" solid wood stiles and rails jointed with glue and dowels. Back of face frames are dovetail grooved to accept side panels. The face frame is engineered so that the bottoms of all base and wall cabinets are flushed with the top inside edge of the face frame creating a custom look.

Toe Kick:

Base and tall cabinets are constructed with 3/4" x 4 1/2" unfinished plywood toe kick. Additional 8-foot lengths of 1/4" toe kicks are available in matching color to our cabinetry.

Panel Beams:

A 2 1/2" x 1/2" plywood panel beam is fastened into a dovetail groove at the top of each base cabinet to ensure a straight fully integrated side, and for use of support and mounting of a countertop.

Construction Specifications

- 1 Solid wood door and drawer front frames are mortise and tenon.
- 2 Compact Blumotion soft-close mechanism integrated in concealed six-way adjustable hinges. Hinges open at 110°.*
- 3 5/8" solid wood dovetail drawer with a 3/8" plywood bottom features Tandem plus Blumotion full extension concealed drawer runners.
- 4 3" interior drawer height.
- 5 3/4" x 1 1/2" solid wood face frame.
- 6 1/2" veneered plywood back with a natural finished interior.
- 7 1/2" unfinished plywood side panels dovetailed into face frame.
- 8 18mm (3/4") veneered plywood adjustable shelving with matching wood veneer edge banding.
- 9 3/4" x 4 1/2" unfinished plywood toe kick attached to cabinet. Matching 1/4" Toe Kick cover to be ordered separately.
- 10 2 1/2" x 1/2" plywood panel beams dovetailed into the side panels for strength and stability.
- 11 Base cabinet has 18" deep shelf.
- 12 When placing an order, need to select exposed sides; Right, Left or Both. A 1/4" select medium-density fiberboard panel will be applied to the selected side(s), and the side will be near flush finished.
- 13 Doors and drawers are full overlay

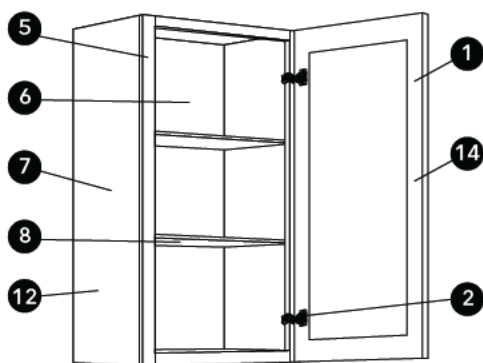

* Luna Door style only: Compact Clip Hinges with Quick-Release technology. Includes Blumotion soft-close mechanism integrated in six-way adjustable hinges. Hinges open at 110°

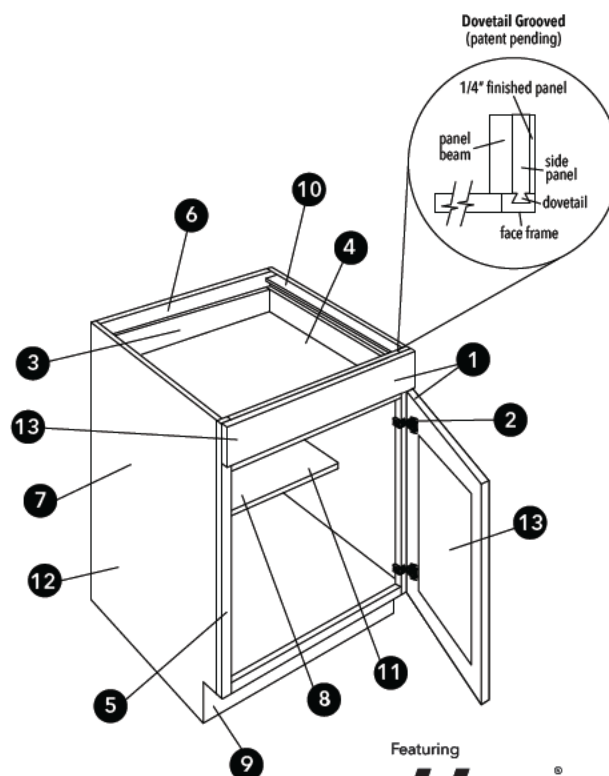

Featuring
blum®



What exactly defines a Q12 cabinet?

To fully achieve Q12 eligibility, a cabinet must encompass twelve unique standards of quality. Read below to learn more about the twelve fundamental pillars that establish the Q12 qualification:

Q1: QUALITY SOURCED LUMBER

This Q12 standard requires the use of carefully selected top-grade lumber, guaranteeing the finest and most dependable kitchen cabinets. To meet this requirement, Fabuwood has implemented a rigorous inspection process to assure that only first-class products, free of irregularities leave the plant.

Q2: PRO TOUCH TECHNIQUES

To fully permeate a Q12 assessment, expert finishing methods are required to heavily influence first impressions and assure a lasting finish that is easy to maintain. Fabuwood's own pro touch technique uses renowned brands to create a durable, simple to clean cabinet that will hold its beauty for years.

Q3: DOVETAIL CONSTRUCTION

Another important facet of Q12 is the required use of dovetail construction. A process that involves plywood side panels to perfectly interlock with a solid wood face frame through corresponding dovetail grooves. This highly resilient technique that Fabuwood introduced to the market guarantees that Q12 cabinet lines are secure, strong, and long-lasting.

Q4: ANTI-WARP STRUCTURES

The anti-warp component involves the use of plywood panels comprised of rigid reinforcement beams. By applying the beams with a dovetail construction technique to secure all components, Fabuwood meets this standard ensuring a strong, reliable build that is resistant to distortion.

Q5: METAL SHELF CLIPS

To maintain a maximum level of stability that preserves a shelf's longevity, these metal shelf clips assure sturdiness and durability. With this feature your shelves are sure to stand the test of time.

Q6: SOLID BACK BUILDS

For superior structural longevity, this Q12 feature requires that the back of a cabinet is constructed from one piece of solid half-inch plywood. Fabuwood fulfills this standard by manufacturing cabinet backs with a strong and single piece of plywood to ensure durable strength and dimensional stability.

Q7: FLUSH FIT FRAMES

In order to be considered Q12 compliant, a cabinet must have flush inner frames that provide an attractive appearance while giving added dimension to the internal area. Fabuwood's Q12 lines display prime craftsmanship with their flat surface top and bottom interior planes that result in convenient and practical usage.

Q8: FINISHED INTERIORS

Treated and finished cabinet interiors are another significant feature of Q12 as they produce a clear statement of quality and attention to detail. As opposed to manufacturing with an applied lining, Fabuwood's vigorous top treatment techniques create a refined and durable design that is free of bubbling, peeling and chipping.

Q9: SOFT-CLOSING ACTION

Another great characteristic of the Q12 qualification is the use of compact hinges with built-in, soft-close mechanism. Fabuwood uses the smooth-running capability and soft closing action of Blum's tandem plus blumotion hinges, providing an impeccably gentle and fluid cabinet function.

Q10: FLUID FULL-EXTENSION

Cabinets built with smooth full-extension glides guarantee an enhanced running action that maximizes a cabinet's storage to its full capacity and ensures Q12 eligibility. Fabuwood manufactures Q12 cabinets with Blum's tandem plus runners and soft-closing technology, precisely utilizing space while also preventing damage and depreciation.

Q11: EZ LEVEL DRAWER FRONTS

To ensure proper door alignment and function, a Q12 cabinet requires an effortless system utilizing a degree of mechanical precision for installing perfectly positioned drawer faces. Fabuwood innovates with a unique technique using circular discs that allow for easy 3/8" adjustments in any direction, resulting in a Q12 cabinet that achieves an aesthetically graceful balance.

Q12: SEALED SIGNATURE

The final Q12 metric requires a thorough review at each manufacturing stage to ensure the completed product meets the provisions specified in the quality assurance system. Upon factory exit, a stamp of approval is given to show Fabuwood's commitment to quality control from the very first level of Q1 to the final Q12 stage, thus guaranteeing a superior and immaculate end product.

5 Year Limited Warranty

COVERAGE OF WARRANTY

Fabuwood Cabinetry Corp ("Fabuwood") is pleased to provide the following limited warranty on all cabinets imported to and assembled and sold in the United States by Fabuwood. This warranty does not cover cabinets sold or shipped outside of the United States. This limited warranty is subject to all limitations, exclusions, disclaimers and procedures set forth herein. Fabuwood warrants to the original purchasing consumer that all cabinets purchased from Fabuwood will be free from all unnatural defects in material and workmanship in accordance with the Fabuwood quality standards sheet under normal residential use for 5 years from the date of the original purchase or as long as the original purchasing consumer owns the home in which such cabinets are installed, whichever is less. This warranty is non transferable to subsequent owners of the home.

EXCLUSIONS

THIS WARRANTY SUPERSEDES ANY AND ALL PREVIOUS WARRANTIES BY FABUWOOD AND CONSTITUTES THE EXCLUSIVE REMEDY AGAINST FABUWOOD FOR ALL DEFECTS, DAMAGES AND WORKMANSHIP. THERE ARE NO IMPLIED WARRANTIES EXTENDING BEYOND THE TERMS OF THIS WARRANTY. FABUWOOD SHALL NOT BE LIABLE FOR ANY INDIRECT, SPECIAL, PUNITIVE, INCIDENTAL OR CONSEQUENTIAL COSTS, EXPENSES OR DAMAGES. THIS WARRANTY GIVES YOU SPECIFIC LEGAL RIGHTS, AND YOU MAY ALSO HAVE OTHER RIGHTS, WHICH VARY FROM STATE TO STATE. IT IS POSSIBLE THAT ONE OR MORE OF THE LIMITATIONS AND EXCLUSIONS IN THIS WARRANTY MAY NOT APPLY TO YOU. THIS WARRANTY APPLIES ONLY TO FABUWOOD PRODUCTS PURCHASED ON OR AFTER MARCH 15, 2014

LIMITATIONS

This warranty shall become void if the cabinets, cabinetwork, drawer slides or hinges are modified from its original form, improperly installed or damaged prior to or during the installation, or used in any way other than for residential purposes. This warranty covers only parts and materials of the cabinets as supplied by Fabuwood. This warranty does not cover any products used or installed in connection with cabinets, such as gas or electric appliances, countertops, or plumbing fixtures. This warranty does not apply to products installed in locations that do not maintain year-round environmental controls. This warranty shall not apply to damages caused by transportation, storage, dirt, chemicals, exposure to moisture, humidity or excessive heat or cold, nor does it cover defects arising from normal wear and tear, misuse, neglect, accidents, alterations, improper use or failure to maintain properly, house settling, or acts of God. No installer, retailer, distributor, agent or employee of Fabuwood has the authority to alter the obligations or limitations in this warranty.

QUALITY STANDARDS

This warranty covers all damages and unnatural defects that are deemed as such under the current Fabuwood Quality Standards sheet. The current Fabuwood Quality Standards sheet is available for download in the dealer login section of the Fabuwood website (www.fabuwood.com), which should be reviewed at each time a claim for warranty service is being considered. Fabuwood reserves the right to modify or change the Fabuwood Quality Standards sheet at any time without notice.

DISCLAIMERS

The following is a brief recap of some of the characteristics of the wood and finishes on the cabinets you are about to purchase. Please read them carefully. If some of these characteristics concern you, please choose something else. We bring these characteristics to your attention so you will realize that Fabuwood

will not be held responsible for these variations in your cabinetry. It is important to note that wood products claimed as defective are most often the result of atmospheric conditions such as excess moisture and humidity. Fabuwood strongly recommends testing the intended location of the products for such conditions prior to installation.

WOOD AND COLOR VARIATIONS Wood is a product of nature, and since no two trees are alike, cabinets may vary in color, texture and grain. Wood characteristics naturally occurring such as variations in color, grain, mineral streaks, pinholes and knots are not considered defects. Color variations in cabinets are also a natural occurrence due to species, age, character of cabinets, and exposure to UV light and sunlight. For these reasons, new and/or replacement cabinets may not match display samples and/or existing cabinets. This may result in overall color variations, but is not considered a defect.

WOOD DOORS Wood by nature will undergo expansion and contraction movements year after year as it compensates and adjusts to ever changing atmospheric humidity and temperature conditions. It is very common for center panels on doors to shrink, expand or move during these transitions. Typically, the panel will return to its normal position within a year once it has adjusted to seasonal changes. It is for these same reasons that it is very common for doors to warp during these periods. Doors that are warped up to 1/4" are not considered defective. Note It is advisable to check if the door was properly installed, since doors that appear warped are very often the result of improper installation.

PAINTED FINISHES Plywood is a non-porous, smooth grained wood. Additionally, wood by nature undergoes periods of expansion and contraction while it adjusts to atmospheric conditions mentioned above. As such, finish stress lines may become visible on painted cabinets especially at the joints. Any such occurrence is not considered a defect.

GLAZED FINISHES A glazed finish by character is an uneven finish. Some edges and profiles will have heavier hang up than others and glazing may vary cabinet to cabinet, door to drawer and item to item. This may result in overall color variations but is not considered a defect.

WARRANTY PERFORMANCE

If a defect does occur within the terms and conditions of this warranty such defective part will be repaired or replaced by Fabuwood at its sole discretion. Fabuwood will not provide or pay for the cost of removal of defective product, transportation of defective, repaired or replaced product or installation of repaired or replaced product. Fabuwood will not be responsible for any shipping damages to the defective, replaced or repaired product. If defective item has been discontinued or is not available at the time, Fabuwood reserves the right to replace the item with the most similar item available in Fabuwood's inventory at that time. Fabuwood cannot guarantee that the finish of any replacement will exactly match the finish and appearance of the defective item due to the natural aging process of the wood and finishes of the cabinets. Fabuwood may require at its discretion that the customer submit a clear photo, or that a company representative view the item being claimed before honoring this warranty.

CLAIMS

To submit a claim covered under this warranty, the original proof of purchase and full payment or copies thereof must be provided. Please email all documents to customerservice@fabuwood.com. Your dealer will contact you once your claim has been reviewed.

NOTE

Please do not send back any items to Fabuwood prior to receiving proper authorization from customer service. Fabuwood takes no responsibility on any items sent back to Fabuwood without proper return authorization.

Door Styles

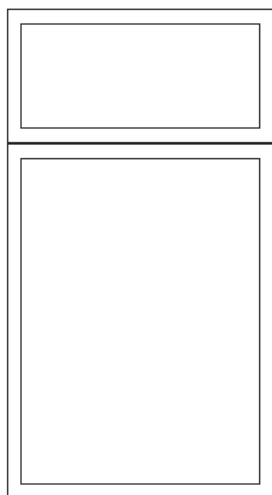

LUNA

	COLOR	FINISH	PRICE COLUMN
NEW! →	Dove	Paint	H / K
NEW! →	Kona	Stain	H / K

- Full Overlay door with applied molding detail
- Door / drawer stiles and rails are 3/4" wide
- Constructed with mortise and tenon joints
- 5/8" thick Moisture-Resistant MDF center panel
- 5-piece recessed panel drawer front matches door design and detail.
- Luna door features Blum's latest Compact Clip Hinges with Quick-Release technology. Please note: Lazy Susan, Easy Reach, and Pie Cut cabinets do not feature the soft-close mechanism.

* KONA DISCLAIMER:

Due to the nature of wood, Kona cabinets may vary in color.

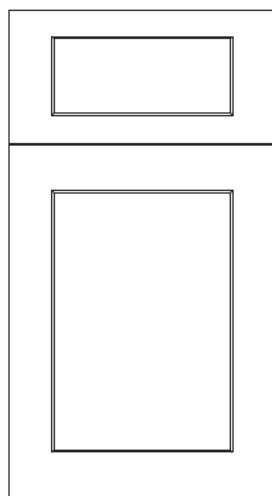

GALAXY

	COLOR	FINISH	PRICE COLUMN
	Frost	Paint	I
	Linen	Paint	I
	Nickel	Paint	I
NEW! →	Indigo	Paint	I
	Espresso	Stain	I
	Horizon*	Stain	I
	Cobblestone	Stain	I

- Full overlay door
- Stiles and rails are 3/4" thick and 2 1/2" wide
- Constructed with mortise and tenon joints
- Doors consist of 3/8" thick recessed MDF/veneer center panel
- 5-piece drawer fronts are 1/2" thick recessed MDF/veneer center panel that match door design and detail

* HORIZON DISCLAIMER:

Due to the nature of wood and the complex finish used to generate Horizon, these cabinets may vary in color.

Door Styles

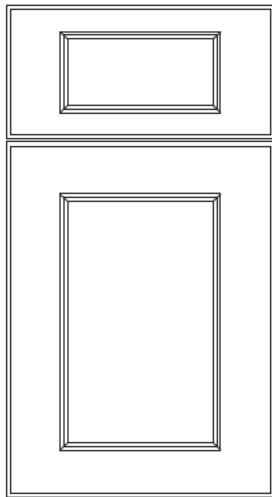

FUSION

COLOR	FINISH	PRICE COLUMN
Blanc	Paint + Glaze	H / K
Nickel	Paint	H / K
Dove	Paint	H / K
NEW! → Stone	Paint	H / K
NEW! → Oyster	Paint	H / K
NEW! → Kona*	Stain	H / K

- Full overlay door
- Stiles and rails are 3/4" thick and 3" wide
- Constructed with mortise and tenon joints
- 3/8" thick reversed MDF / veneer center panel
- 5-piece recessed panel drawer front matches door design and detail.

* **KONA DISCLAIMER:**

Due to the nature of wood, Kona cabinets may vary in color.

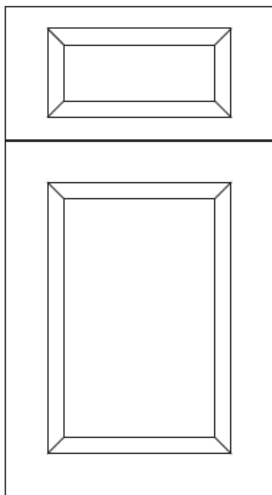

ONYX

COLOR	FINISH	PRICE COLUMN
Frost	Paint	H / K
Horizon*	Stain	H / K
Cobblestone	Stain	H / K

- Full overlay door
- Stiles and rails are 3/4" thick and 3" wide
- Constructed with mortise and tenon joints
- 3/8" thick reversed MDF / veneer center panel
- 5-piece recessed panel drawer front matches door design and detail

* **HORIZON DISCLAIMER:**

Due to the nature of wood and the complex finish used to generate Horizon, these cabinets may vary in color.

Door Styles

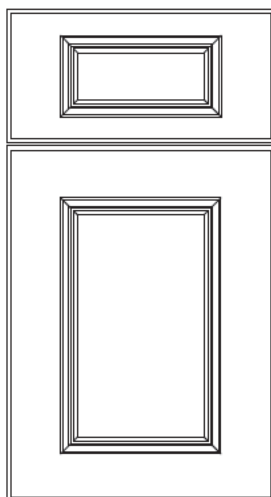

IMPERIO

COLOR	FINISH	PRICE COLUMN
Dove	Paint	H / K
Nickel	Paint	H / K

- Full overlay door
- Frames are solid wood $\frac{3}{4}$ " thick and 3" wide
- Constructed with mortise and tenon joints
- MDF center panel is $\frac{5}{8}$ " thick
- An **applied moulding** is added to the inside edge of the door frame
- 5 piece recessed panel drawer front matches door design and moulding detail
- **Cabinet installed next to a wall or deeper cabinet requires a $\frac{1}{4}$ " filler for full door opening**

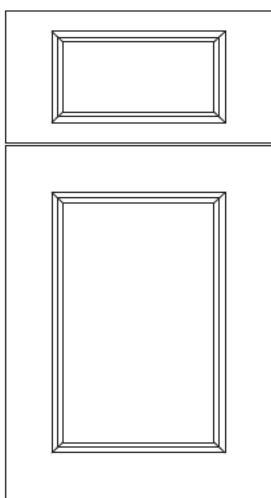

NEXUS

COLOR	FINISH	PRICE COLUMN
Frost	Paint	H / K
Slate	Paint	H / K

DISCONTINUING →

- Full overlay door
- Stiles and rails are $\frac{3}{4}$ " thick and $3\frac{1}{4}$ " wide
- Constructed with mortise and tenon joints
- $\frac{3}{8}$ " thick reversed MDF center panel
- 5-piece recessed panel drawer front matches door design and detail.

Sales Tools

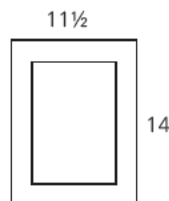
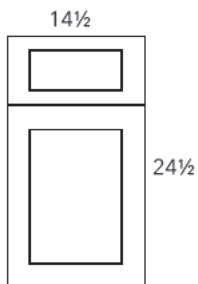

DOOR SAMPLES WITH DRAWER FRONT

ITEM	DESCRIPTION
SDNF	NEXUS FROST
SDGF	GALAXY FROST
SDGL	GALAXY LINEN
SDGN	GALAXY NICKEL
SDGI	GALAXY INDIGO
SDGE	GALAXY ESPRESSO
SDGH	GALAXY HORIZON
SDGC	GALAXY COBBLESTONE
SDFB	FUSION BLANC
SDFN	FUSION NICKEL
SDFD	FUSION DOVE
SDFO	FUSION OYSTER
SDFS	FUSION STONE
SDFK	FUSION KONA
SDOF	ONYX FROST
SDOH	ONYX HORIZON
SDOC	ONYX COBBLESTONE
SDID	IMPERIO DOVE
SDIN	IMPERIO NICKEL
SDIK	IMPERIO KONA
SDLD	LUNA DOVE
SDLK	LUNA KONA

SMALL DOOR SAMPLES

ITEM	DESCRIPTION
SDGF-2	GALAXY FROST
SDGL-2	GALAXY LINEN
SDGN-2	GALAXY NICKEL
SDGI-2	GALAXY INDIGO
SDGE-2	GALAXY ESPRESSO
SDGH-2	GALAXY HORIZON
SDGC-2	GALAXY COBBLESTONE
SDFB-2	FUSION BLANC
SDFN-2	FUSION NICKEL
SDFD-2	FUSION DOVE
SDFK-2	FUSION OYSTER
SDFO-2	FUSION STONE
SDFD-2	FUSION KONA
SDOF-2	ONYX FROST
SDOH-2	ONYX HORIZON
SDOC-2	ONYX COBBLESTONE
SDID-2	IMPERIO DOVE
SDIN-2	IMPERIO NICKEL
SDIK-2	IMPERIO KONA
SDLD-2	LUNA DOVE
SDLK-2	LUNA KONA

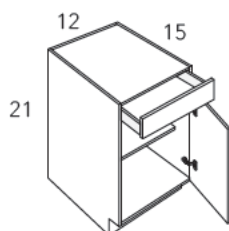

MINI BASE SAMPLE

ITEM	DESCRIPTION
GF MBS	BASE SAMPLE 12"W X 21"H X 15"D

- Available in Allure Galaxy Frost, and Quest Metro Mist finish only.

Sales Tools

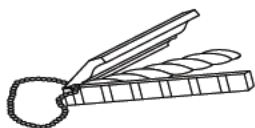

MOLDING CHAIN

ITEM	DESCRIPTION
MLK-ALLURE	COMPLETE CHAIN OF ALLURE MOLDINGS

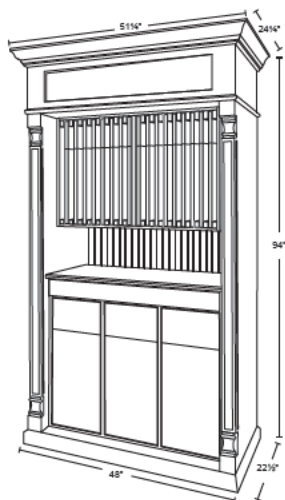

SELLING CENTER

ITEM	DESCRIPTION
DEALER SELLING CENTER	FABUWOOD SELLING CENTER

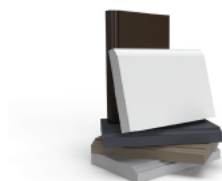

COLOR BLOCKS

ITEM	DESCRIPTION
COLOR BLOCK	BOX OF COLOR BLOCKS



SAMPLE PACKAGES

ITEM	DESCRIPTION
SMALL SAMPLE PACKAGE	SMALL SAMPLE PACKAGE
DEALER PACKAGE	LITERATURE AND ACCESSORIES



DIGITAL BROCHURE

ITEM	DESCRIPTION
DIGITAL BROCHURE QR	QR CODE KEY RING



STYLE GUIDE

ITEM	DESCRIPTION
SG22	25PK. 2022 STYLE GUIDE BROCHURE

Modifications

CUT ITEMS

ITEM	DESCRIPTION
CUT-BASE	Reduce depth of base cabinet (min. depth 12")
CUT-DBASE	Reduce depth of drawer base cabinet (min. depth 12")
CUT-SBASE	Reduce depth of sink base cabinet (no min.)
CUT-WALL	Reduce depth of wall cabinet (no min.)
CUT-TALL	Reduce depth of tall cabinet (no min.)
CUT-DOOR*	Cut out center panel of door for glass insert (per door, glass not included)
CUT-COLUMN	Reduce depth of column (specify depth)
CUT-BASE HEIGHT	Reduce height of base cabinet by cutting off top drawer (total base height: 28½)
CUT-TK	Reduce toe kick height (no min.)
CUT-PANEL	Cut down a panel to any size
CUT-ROD	Reduce depth of rollout drawer (specify depth of cabinet)
CUT-KD30	Reduce depth of knee drawer cabinet (specify depth of cabinet)

* Not available for Luna

PIPE CHASE

ITEM	DESCRIPTION
CHASE-BASE	Make chase in base cabinet
CHASE-DBASE	Make chase in drawer base cabinet
CHASE-WALL	Make chase in wall cabinet
CHASE-TALL	Make chase in tall cabinet
CHASE-CORNER	Make chase in corner cabinet (WDC, WPC & ERB only)

Must supply a drawing for all chase modifications.

CUSTOMIZATIONS

ITEM	DESCRIPTION
CREATE-ERB	Remove tray, install bottom panel on top, to create easy reach
CREATE-RETURN WALL*	Create a return wall filler up to 6"W x 15"D x 42"H (materials incl.)
CREATE-RETURN TALL*	Create a return tall filler up to 6"W x 30"D x 96"H (materials incl.)
CREATE-COLUMN BASE*	Create a 3 column up to 30 D by 34½ H
CREATE-COLUMN TALL*	Create an oversized column
CREATE-COLUMN WALL*	Create a 3 column up to 15 D x 42 H
HAMPER	Install door mounted pull out wood hamper in cabinet (cabinet not incl.)
CUSTOM DOOR**	Order any custom size door

* Email orders@fabuwood.com for quote

** Not available for Luna

MODIFICATIONS

ITEM	DESCRIPTION
REMOVE-DRAWER	Remove cabinet drawer to create false drawer front
CLOSE-BLIND	Close open section of a blind wall or base cabinet

Modifications

MODIFICATIONS CONT.

ITEM	DESCRIPTION
ATTACH-TK	Attach toe kick on wall cabinet
RECESS-TK	Recess toe kick of base cabinet (must supply a drawing)
EDGE-BAND	Additional edge banding (price per linear foot)
PEN-CABINET	Create a peninsula cabinet from 2 cabinets (cabinets not incl.)
INCREASE-BASE	Increase depth on base cabinet
INCREASE-WALL	Increase depth on wall cabinet
INCREASE-TALL	Increase depth on tall cabinet
MATCH-INTERIOR	Stain interior of cabinet to match exterior
CREATE- SQ BOTTOM	Square bottom shelf for wall open end to enable light rail molding
FLUSH-WALL BOTTOM	Flush the bottom of a wall cabinet
FLUSH-TOE KICK	Flush toe kick of base cabinet to face frame (sides not finished)
FULL-DOORS	Create full height door base cabinet from 2 cabinets (cabinets not incl.)
OE6	Cut OE12 to 6

* Email orders@fabuwood.com for quote

UPGRADES

ITEM	DESCRIPTION
INSTALL-ACCES	Install any accessory in a cabinet (accessories not incl.)
GLAZE	Custom glazes available for a charge
CUSTOM COLOR PAINT	Refinish to custom color paint

* Email orders@fabuwood.com for quote

LOOSE PARTS

ITEM	DESCRIPTION
SHELF BASE	Loose 24" deep shelf (specify cabinet size)
SHELF WALL	Loose 12" deep shelf (specify cabinet size)
SHELF TALL	Loose 24" deep shelf (specify cabinet size)
SHELF-DSB	Loose shelf (specify cabinet size)
SK BASE	Skin for base cabinet with adhesion
SK MC	Skin for microwave wall cabinet with adhesion
SK TALL	Skin for tall cabinet with adhesion
SK W30	Skin for 30 high wall cabinet with adhesion
SK W36	Skin for 36 high wall cabinet with adhesion
SK W42	Skin for 42 high wall cabinet with adhesion
SK WD	Skin for wall with drawer cabinet with adhesion

Many more modifications available- please contact your customer service rep.

12" - 27" High Wall Cabinets



* single door cabinet

12" - 21" HIGH

ITEM
W3012
W3312
W3612
W1215*
W1515*
W1815*
W2115*
W2415
W2715
W3015
W3315
W3615
W2418
W3018
W3318
W3618
W3021**

** Has 1 shelf

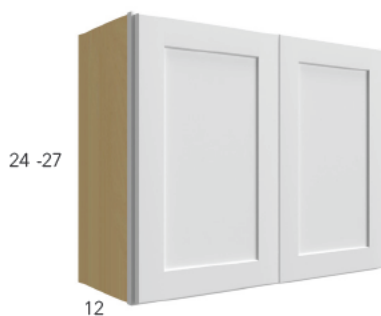

24" - 27" HIGH DOUBLE DOOR

ITEM
W2424
W3024
W3324
W3624
W3027*

* Discontinued items are available in limited quantities while supplies last.

12" - 24" High & 24" Deep Wall Cabinets



24" DEEP

ITEM
W301524
W301824
W302424*
W331224
W331524
W331824
W332424*
W361224
W361524
W361824
W362424*

* Has 1 shelf

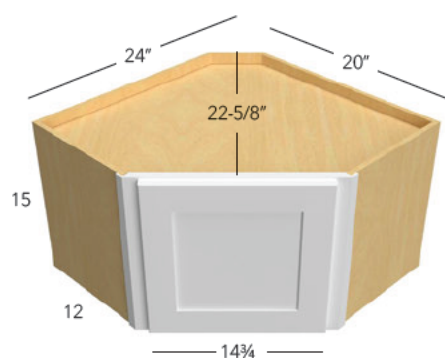

DIAGONAL CORNER

ITEM
WDC2415

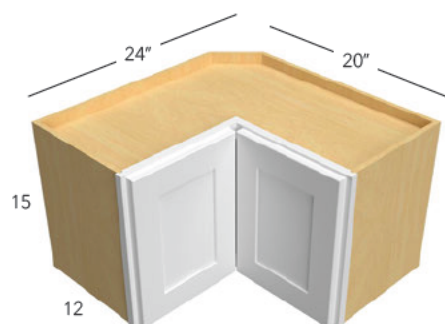

PIE CUT CORNER

ITEM
WPC2415

• Soft close hinge not available

30" High Wall Cabinets



SINGLE DOOR

ITEM

W0930

W1230

W1530

W1830

W2130



DOUBLE DOOR

ITEM

W2430

W2730

W3030

W3330

W3630

W3930*

* Has 1½" center stile



SINGLE DOOR BLIND

ITEM

WBC2430

WBC3030

WBC3630

- Must use filler on adjacent side (not supplied)
- Dimensions are rounded off to closest 1/8"

	Act	Max	Door	Stile	Open (door side)
WBC2430	24"	27"	9½"	7"	7"
WBC3030	30"	33"	14¾"	7¾"	12¼"
WBC3630	36"	39"	21½"	7"	19"

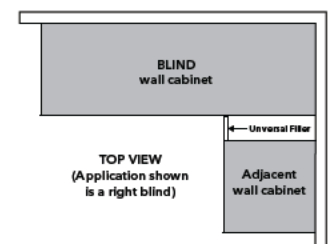

30" High Wall Cabinets

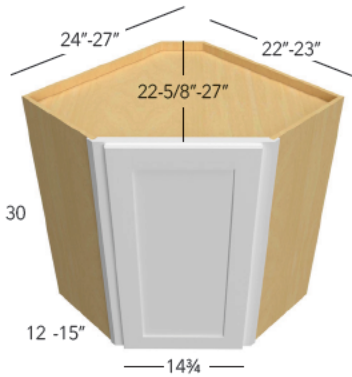

DIAGONAL CORNER

ITEM

WDC2430

- For Lazy Susan see accessories on page 43

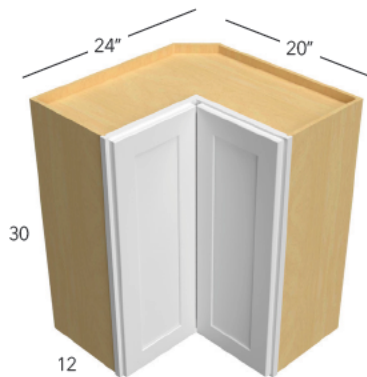

PIE CUT CORNER

ITEM

WPC2430

- Soft close hinge not available

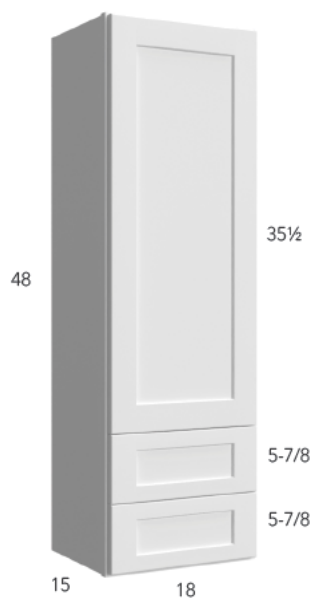

WALL WITH DRAWERS

ITEM

WD1848

- Cabinet exposed sides come pre-finished with near-flush finished ends.

36" High Wall Cabinets

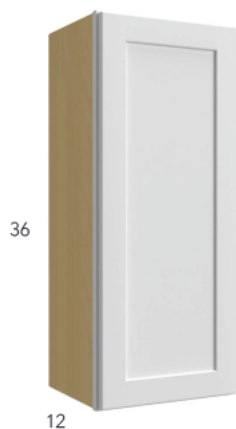

SINGLE DOOR

ITEM
W0936
W1236
W1536
W1836
W2136



DOUBLE DOOR

ITEM
W2436
W2736
W3036
W3336
W3636
W3936*

* Has 1½" center stile



SINGLE DOOR BLIND

ITEM
WBC2436
WBC3036
WBC3636

- Must use filler on adjacent side (not supplied)
- Dimensions are rounded off to closest ¼"

	Act	Max	Door	Stile	Open (door side)
WBC2436	24"	27"	9½"	7"	7"
WBC3036	30"	33"	14¾"	7¾"	12¼"
WBC3636	36"	39"	21½"	7"	19"

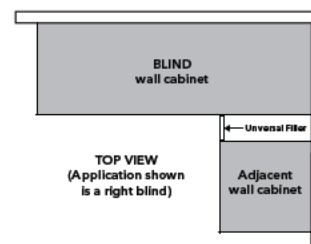

36" High Wall Cabinets

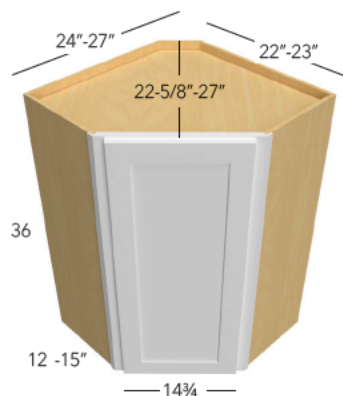

DIAGONAL CORNER

ITEM

WDC2436

- For Lazy Susan see accessories on page 43

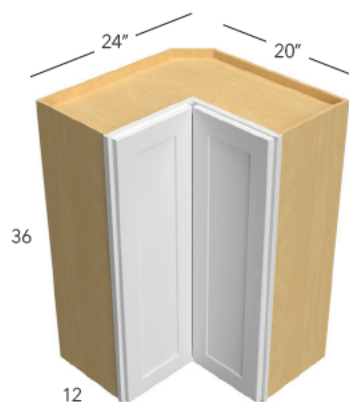

PIE CUT CORNER

ITEM

WPC2436

- Soft close hinge not available

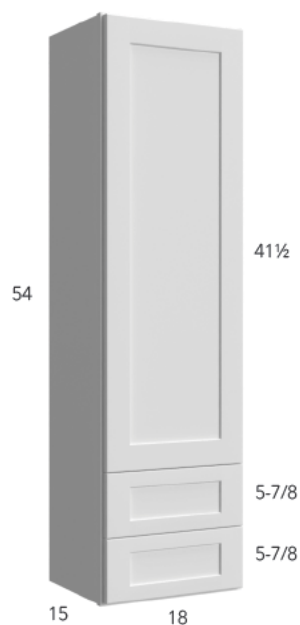

WALL WITH DRAWERS

ITEM

WD1854

- Cabinet exposed sides come pre-finished with near-flush finished ends.

42" High Wall Cabinets

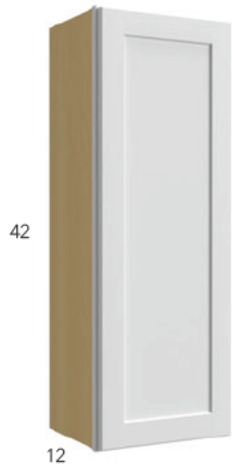

SINGLE DOOR

ITEM

W0942

W1242

W1542

W1842

W2142



DOUBLE DOOR

ITEM

W2442

W2742

W3042

W3342

W3642

W3942*

* Has 1½" center stile



SINGLE DOOR BLIND

ITEM

WBC2442

WBC3042

WBC3642

- Must use filler on adjacent side (not supplied)
- Dimensions are rounded off to closest ¼"

	Act	Max	Door	Stile	Open (door side)
WBC2442	24"	27"	9½"	7"	7"
WBC3042	30"	33"	14¾"	7¾"	12¼"
WBC3642	36"	39"	21½"	7"	19"

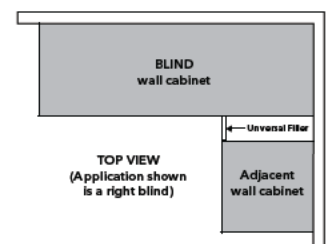

42" High Wall Cabinets

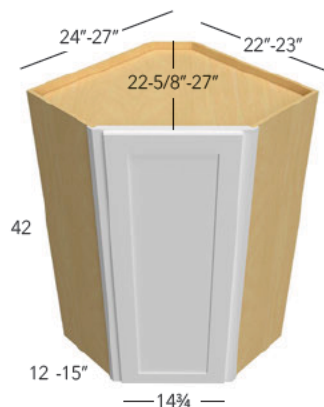

DIAGONAL CORNER

ITEM

WDC2442

- For Lazy Susan see accessories on page 43

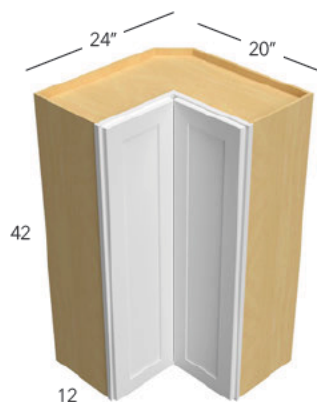

PIE CUT CORNER

ITEM

WPC2442

- Soft close hinge not available

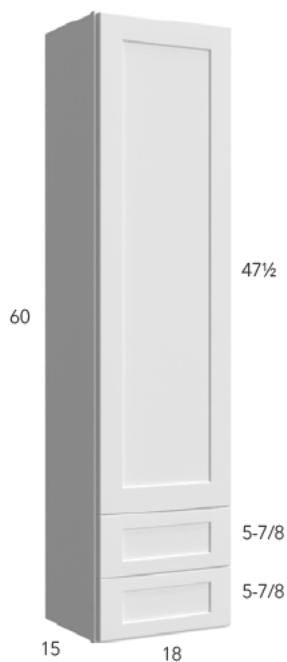

WALL WITH DRAWERS

ITEM

WD1860

- Cabinet exposed sides come pre-finished with near-flush finished ends.

Specialty Wall Cabinets



NO DOOR

ITEM

NDW1530

NDW1536

NDW1542

NDW1830

NDW1836

NDW1842

NDW2430

NDW2436

NDW2442

NDW3030

NDW3036

NDW3042

NDW3630

NDW3636

NDW3642

- Door not included in price. Designed to use with glass doors. See glass doors listed on pg. 10
- Has hinges installed
- Cabinet comes pre-drilled for hinges. Fabuwood can fill up hinge holes for additional charge.
- Finished interior to match color of frame
- Adjustable ¼" thick tempered glass shelves
- Increased or decreased depth cabinets will come with matching interior wood shelves instead of glass shelves.

* Has three shelves

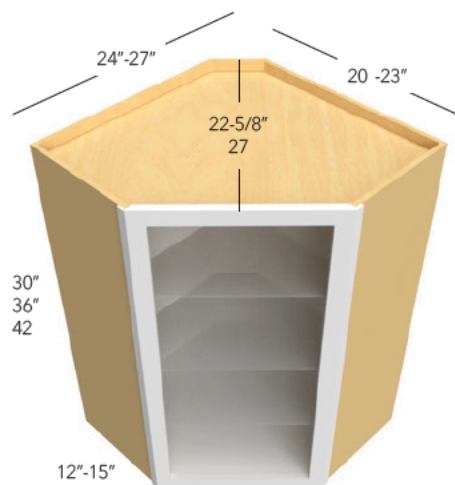

DIAGONAL CORNER NO DOOR

ITEM

NDWDC2430

NDWDC2436

NDWDC2442*

- Door not included. Designed to use with glass doors. See glass doors listed on pg. #10
- Cabinet comes pre-drilled for hinges. Fabuwood can fill up hinge holes for additional charge.
- Finished interior
- Adjustable ¼" thick tempered glass shelves
- Increased or decreased depth cabinets will come with matching interior wood shelves instead of glass shelves.

* Has three shelves

Glass Doors



29½"
35½"
41½"
47½"

GLASS DOOR (CLEAR GLASS ONLY)

ITEM
GDW1530
GDW1536
GDW1542
GDW1830
GDW1836
GDW1842
GDW2430**
GDW2436**
GDW2442**
GDW3030**
GDW3036**
GDW3042**
GDW3630**
GDW3636**
GDW3642**
GDWD1860
GDWDC2430*
GDWDC2436*
GDWDC2442*

• Glass doors are pre-installed with clear glass only.

* 14 ¾" wide

** Cost is for a single door, need to order quantity of 2 doors per cabinet

Doors Prepped for Glass



29½"
35½"
41½"
47½"

DOOR PREPPED FOR GLASS

ITEM
DFG1530
DFG1536
DFG1542
DFG1830
DFG1836
DFG1842
DFG2430**
DFG2436**
DFG2442**
DFG3030**
DFG3036**
DFG3042**
DFG3630**
DFG3636**
DFG3642**
DFGWD1860

- Glass not included
 - Comes with the center panel removed; vinyl gasket is included for easy installation of glass in the field.
- ** Cost is for a single door, need to order quantity of 2 doors per cabinet

Specialty Wall Cabinets

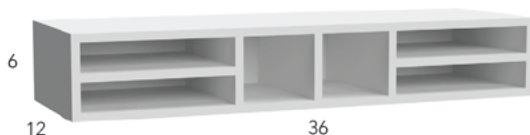
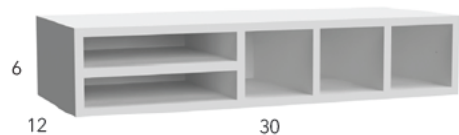

WALL ORGANIZER

ITEM

WO306

WO366

- Veneer plywood with edge banding
- Finished Interior & Exterior

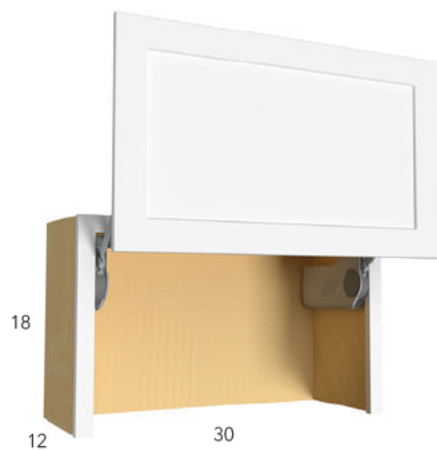

WALL APPLIANCE

ITEM

WAC3018

Specialty Wall Cabinets

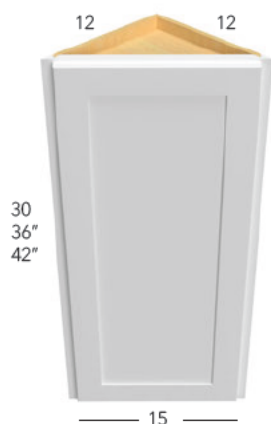

ANGLE END

ITEM

WAE1230

WAE1236*

WAE1242*

- Can use glass door from diagonal corner wall cabinet.
Requires 1" overlay hinges
- Adjustable shelves
- * Has three shelves



OPEN END

ITEM

OE1230

OE1236

OE1242*

- Comes as 12" (Fabuwood will cut to 6" at no charge)
- * Has three shelves
- * For Square Bottom Shelf, see modifications on pg. VII

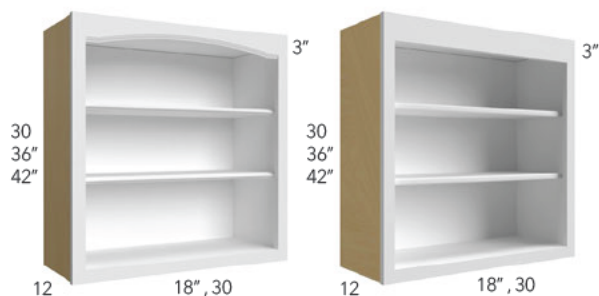
NEXUS
**LUNA, GALAXY, FUSION,
ONYX & IMPERIO**

OPEN SHELF

ITEM

WOS1830

WOS1836*

WOS1842*

WOS3030

WOS3036*

WOS3042*

- * Has three shelves
- Finished interior
- NEXUS: Arch valance
- Top rail & shelf front matches door profile
- Adjustable shelves
- Increased depth cabinets will not have edge profile

Edge on shelves:



NEXUS

**LUNA
GALAXY
ONYX**

FUSION

IMPERIO

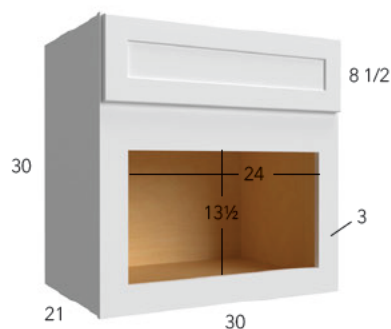
Microwave Wall Cabinets



30" MICROWAVE

ITEM

MC303021

- Cabinet exposed sides come pre-finished with near-flush finished ends.
- 3" Wide rails face frame to be trimmed on site
- Minimum Width opening 24"
- Maximum **cut out** width 28½"
- Minimum Height opening 13"
- Maximum **cut out** height is 19"
- Maximum **overall** trim kit height 21"
- Lift-up door

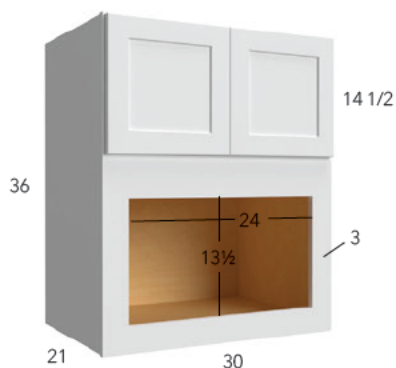

36" MICROWAVE

ITEM

MC303621

- Cabinet exposed sides come pre-finished with near-flush finished ends.
- 3" Wide rails face frame to be trimmed on site
- Minimum width opening 24"
- Maximum **cut out** width 28½"
- Minimum Height opening 13"
- Maximum **cut out** height is 19"
- Maximum **overall** trim kit height 21"

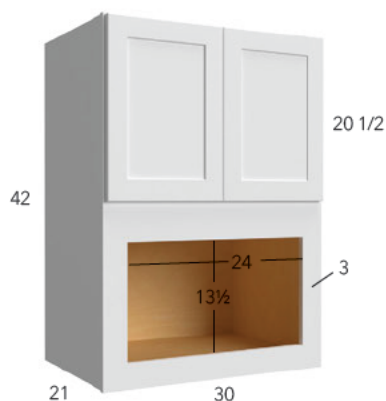

42" MICROWAVE

ITEM

MC304221

- Cabinet exposed sides come pre-finished with near-flush finished ends.
- 3" Wide rails face frame to be trimmed on site
- Minimum Width opening 24"
- Maximum **cut out** width 28½"
- Minimum Height opening 13"
- Maximum **cut out** height is 19"
- Maximum **overall** trim kit height 21"

Wine Cabinets

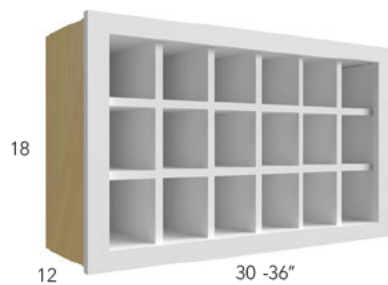

WINE RACK

ITEM

WR3018*

WR3618**

- Finished interior
- 1-½" Framed cabinet construction
- * Fits 18 bottles
- ** Fits 21 bottles

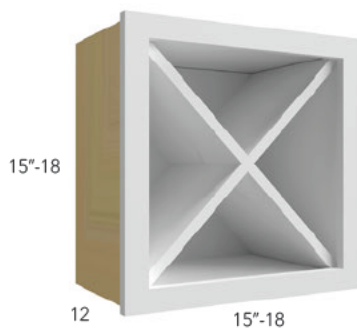

WINE RACK

ITEM

WR15X15

WR18X18

- Finished Interior
- 1-½" Framed cabinet construction
- Exterior has 3/4" recess from face frame (all around)
- Interior has 1/4" recess from face frame (all around)

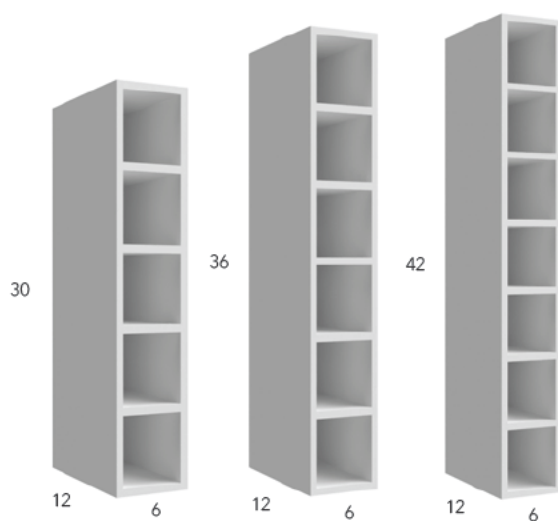

WINE CUBE

ITEM

WC0630

WC0636

WC0642

- Veneer plywood with edge banding
- Finished Interior & Exterior
- Frameless construction

Wood Hoods

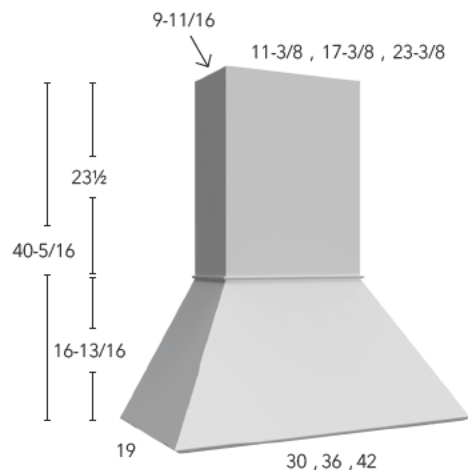

EURO HOOD

ITEM

RHE30

RHE36

RHE42

- Includes Stainless Steel Hood Liner (liner is user removable)
- Chimney is trimmable on site (refer to assembly and installation instructions for more details)
- Modifications are not available for this item
- Liner specifications found on pg. 18

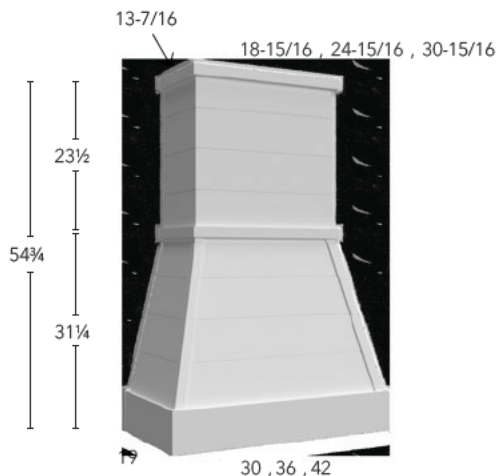

FARMHOUSE HOOD

ITEM

RHF30

RHF36

RHF42

- Includes Stainless Steel Hood Liner (liner is to be installed after hood is mounted on wall)
- Chimney is trimmable on site (refer to assembly and installation instructions for more details)
- Modifications are not available for this item
- Liner specifications found on pg. 19

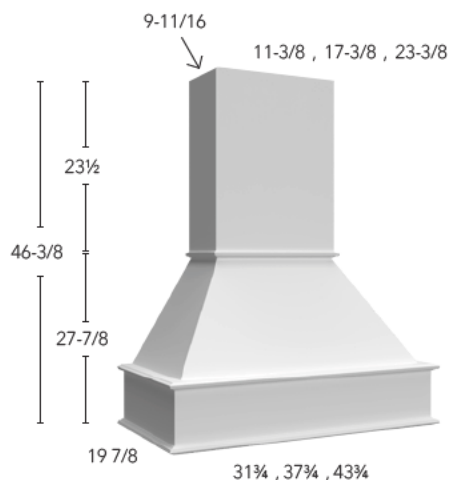

SIGNATURE HOOD

ITEM

RHS30

RHS36

RHS42

- Includes Full Interior Stainless Steel Liner (liner is user removable)
- Chimney is trimmable on site (refer to assembly and installation instructions for more details)
- Modifications are not available for this item
- Liner specifications found on pg. 19

Wood Hoods

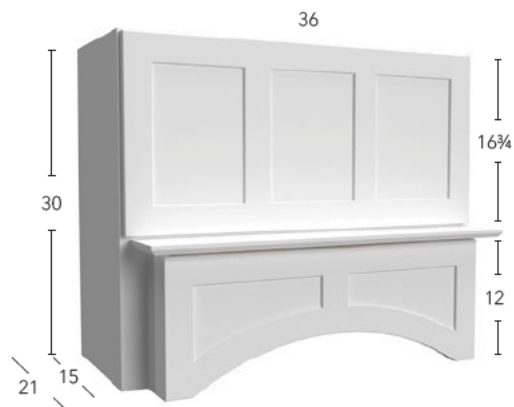

3 PANEL ARCHED HOOD

ITEM

RHA363021*

- *Arched valance profile coordinates with that of door style*
- *Includes Full Interior Stainless Steel Hood Liner (liner is user removable)*
- *Top panel lifts up*
- *Sides are flush finished ends*
- *Crown to be installed above cabinet, not on face frame*
- *Hood depth can be increased or decreased (contact Custom Quotes for pricing)*
- *Liner specifications found on pg. 20*
- * *Not available in Luna*



4 PANEL ARCHED HOOD

ITEM

RHA423021*

RHA483021*

- *Not available in Luna*
- *Arched valance profile coordinates with that of door style*
- *Includes Full Interior Stainless Steel Hood Liner (liner is user removable)*
- *Top panel lifts up*
- *Sides are flush finished ends*
- *Crown to be installed above cabinet, not on face frame*
- *Hood depth can be increased or decreased (contact Custom Quotes for pricing)*
- *Liner specifications found on pg. 20*
- * *Not available in Luna*

Hood / Liner Specifications

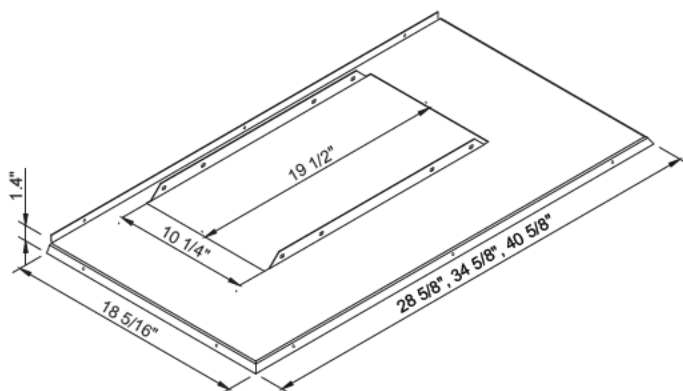

EURO HOOD LINER

ITEM

HOOD LINER-RHE30

HOOD LINER-RHE36

HOOD LINER-RHE42

- Liner is included as a standard on Allure Euro Hoods (hood will ship with liner pre-installed)
- Blower is **NOT** included, must be purchased separately by other
- Blowers that fit this liner:
 - Broan NuTone / Model NSPM250
 - Broan / Model PM300
 - Broan NuTone / Model NSPM390
 - Broan / Model PM400SS
 - Broan / Model PM500SS Power Pack
 - Best / Model P195P1M52SB6
 - XO / Model XO121SMUA
 - XO / Model XO122SC
 - Zephyr / Model AK8400BS
 - Zephyr / Model AK8400BS290

MODELS LISTED ARE RECOMMENDATIONS ONLY; Fabuwood takes no responsibility for the selection of blower. Dealer is responsible for specifying and recommended to consult with an appliance dealer to select compatible blower options based on their individual cooking appliance needs and manufacturer specifications.

CONSTRUCTION DETAILS:

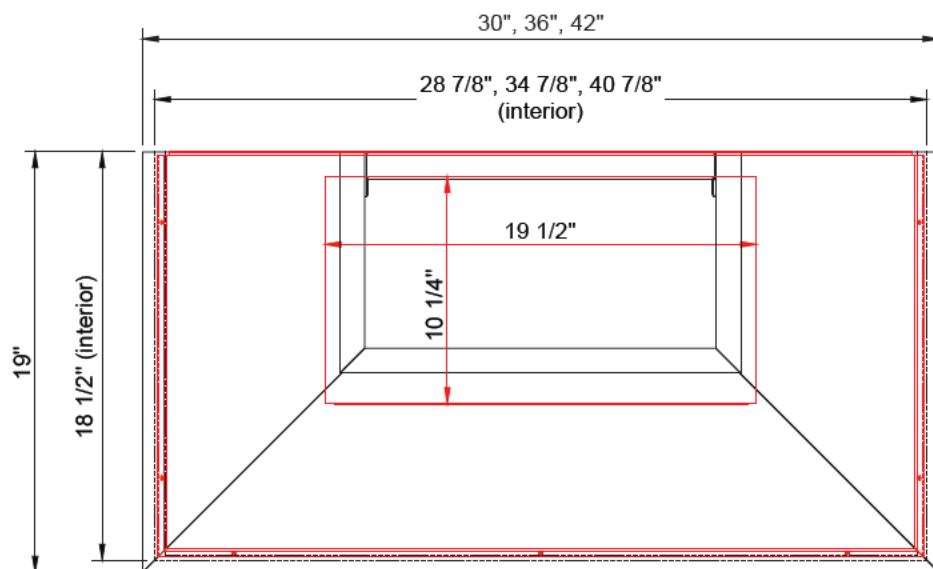

Stainless Steel Liner

Hood / Liner Specifications

FARMHOUSE/SIGNATURE HOOD LINER

ITEM

HOOD LINER-RHA/F/S30

HOOD LINER-RHA/F/S36

HOOD LINER-RHA/F/S42

- Liner is included as a standard on Allure Farmhouse & Signature Hoods (hood will ship with liner to be installed on site)
- Blower is **NOT** included, must be purchased separately by other
- Blowers that fit this liner:
 Broan NuTone / Model NSPM250
 Broan / Model PM300
 Broan NuTone / Model NSPM390
 Broan / Model PM400SS
 Broan / Model PM500SS Power Pack
 Best / Model P195P1M52SB6
 XO / Model XO121SMUA
 XO / Model XO122SC
 Zephyr / Model AK8400BS
 Zephyr / Model AK8400BS290

MODELS LISTED ARE RECOMMENDATIONS ONLY; Fabuwood takes no responsibility for the selection of blower. Dealer is responsible for specifying and recommended to consult with an appliance dealer to select compatible blower options based on their individual cooking appliance needs and manufacturer specifications.

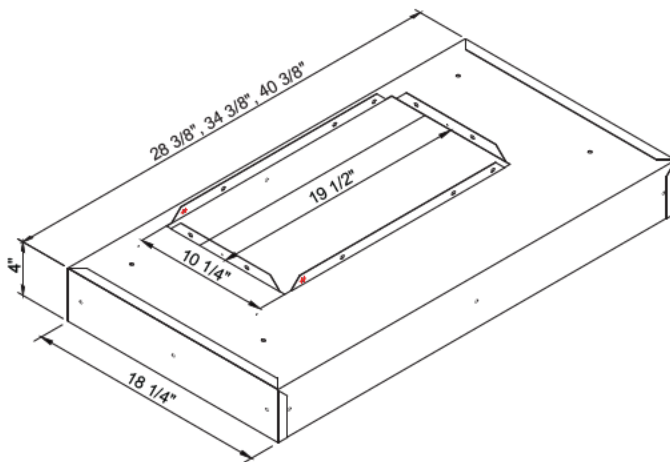

FARMHOUSE CONSTRUCTION DETAILS:

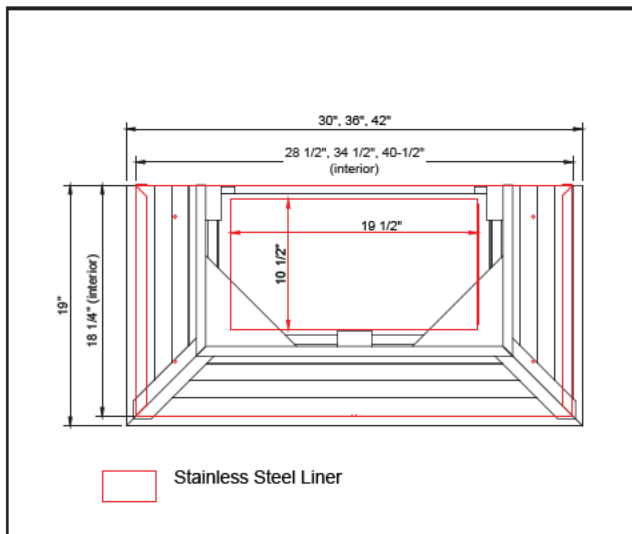

SIGNATURE CONSTRUCTION DETAILS:

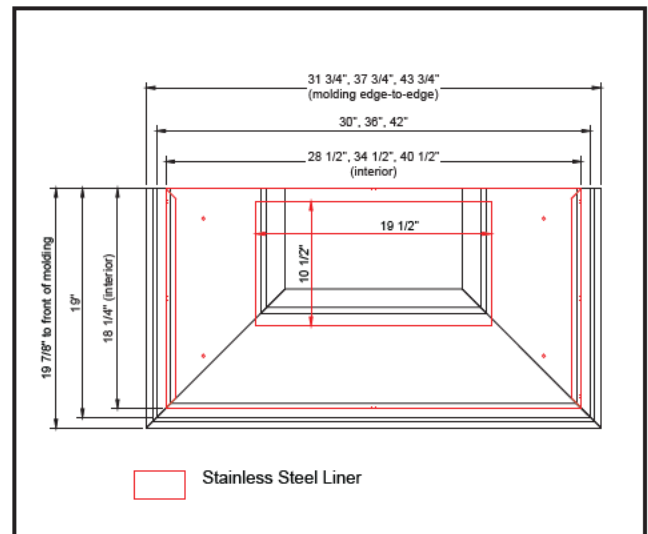

Hood / Liner Specifications

ARCHED HOOD LINER

ITEM

HOOD LINER-RHA363021

HOOD LINER-RHA423021

HOOD LINER-RHA483021

- Liner is included as a standard on Allure Arched Hoods (hood will ship with liner preinstalled)
- Blower is **NOT** included, must be purchased separately by other
- Blowers that fit this liner:
 Broan NuTone / Model NSPM250
 Broan / Model PM300
 Broan NuTone / Model NSPM390
 Broan / Model PM400SS
 Broan / Model PM500SS Power Pack
 Best / Model P195P1M52SB6
 XO / Model XO121SMUA
 XO / Model XO122SC
 Zephyr / Model AK8400BS
 Zephyr / Model AK8400BS290

MODELS LISTED ARE RECOMMENDATIONS ONLY; Fabuwood takes no responsibility for the selection of blower. Dealer is responsible for specifying and recommended to consult with an appliance dealer to select compatible blower options based on their individual cooking appliance needs and manufacturer specifications.

BLOWER GOES HERE

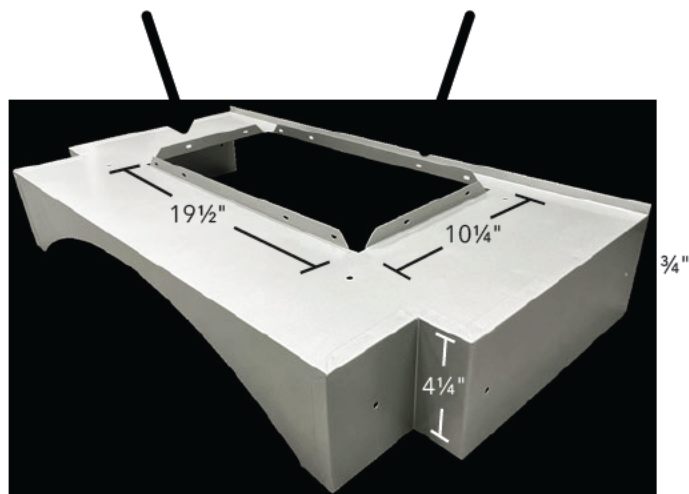

CONSTRUCTION DETAILS:

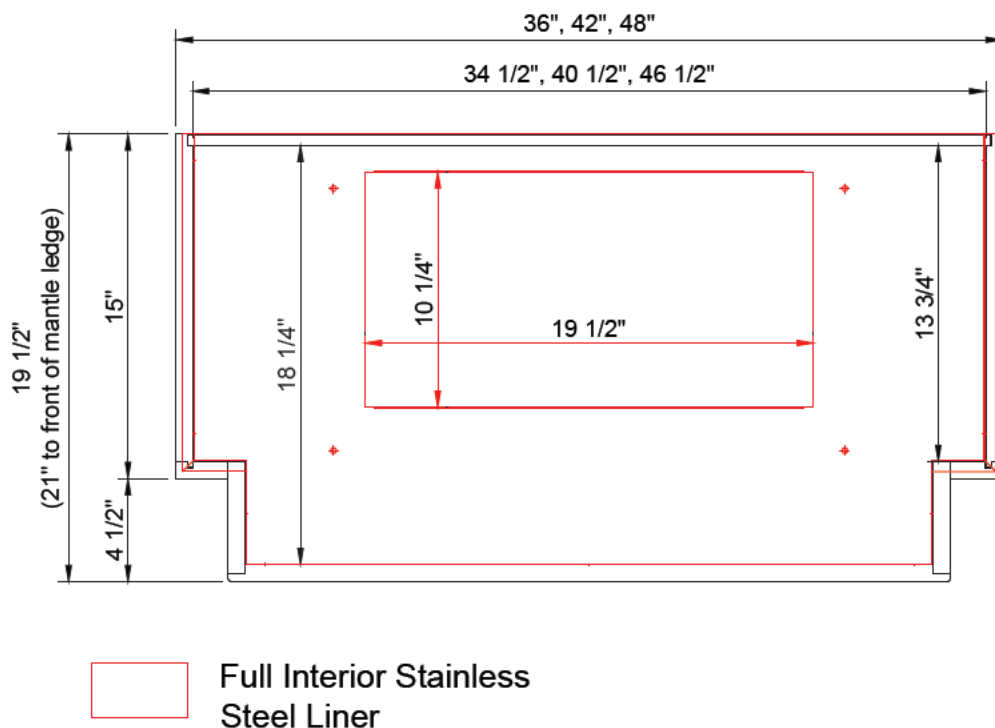

Base Cabinets



FULL HEIGHT SINGLE DOOR

ITEM

B09FD*

B12FD

B15FD

B18FD

B21FD

- * Does not have a shelf
- * B09 accessories available on pg. 40
- Trash Can available on pg. 38
- Peninsula modification available on pg. XII
- Roll Out available on pg. 39



FULL HEIGHT DOUBLE DOOR

ITEM

B24FD

B27FD

B30FD

B33FD

B36FD

B39FD

- Peninsula modification available on pg. XII
- Roll Out available on pg. 39



SINGLE DOOR

ITEM

B12

B15

B18

B21

- * Has a full height door without a drawer and shelf
- * B09 accessories available on pg. 40
- Trash Can available on pg. 38
- Cutlery Divider available on pg. 49
- Peninsula modification available on pg. XII
- Roll Out available on pg. 39

Base Cabinets



DOUBLE DOOR

ITEM

B24

B27

B30

- *Cutlery Divider available on pg. 49*
- *Peninsula modification available on pg. XII*
- *Roll Out available on pg. 39*



DOUBLE DOOR & DRAWER

ITEM

B33

B36

B39*

B42*

B48*

- * *Has 3" center stile*
- *Cutlery Divider available on pg. 46*
- *Roll Out available on pg. 39*



2 DRAWER

ITEM

DB30-2

DB36-2

Base Cabinets



3 DRAWER

ITEM

DB12

DB15

DB18

DB21

DB24

DB27

DB30

DB33

DB36

- Cutlery Divider available on pg. 49



4 DRAWER

ITEM

DB15-4

DB18-4

DB21-4

- Cutlery Divider available on pg. 46



BLIND

ITEM

BLB36/39

BLB39/42

BLB42/45

BLB48/51

- Must use filler on adjacent wall (not supplied)
- Measurements are rounded off to closest 1/8"

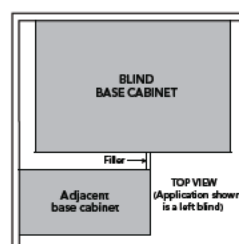

	Act	Min	Max	Door	Stile	Open
BLB36/39	27"	36"	41 1/2"	9 1/4"	9 1/2"	7 1/4"
BLB39/42	33"	39"	45"	12 1/4"	10 1/4"	9 1/4"
BLB42/45	39"	42"	48"	15 3/8"	10 1/4"	12 3/4"
BLB48/51	48"	48"	51"	21 1/4"	7 3/8"	18 3/4"

Base Cabinets



DIAGONAL SINK FRONT

ITEM

DSF36*

DSFL36**

- * DSF36 The sink front has a 17" face dimension
- ** DSFL36 The floor must be ordered separately
- Uses 3/8" overlay hinge
- Tilt Out available on pg. 45

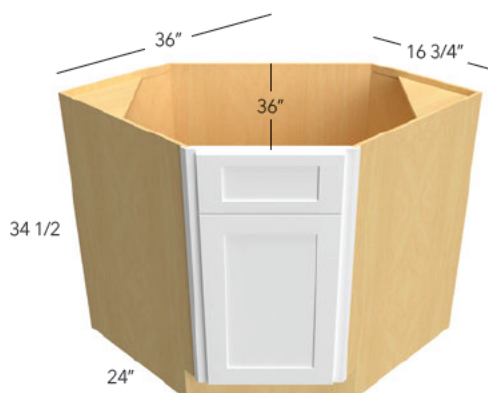

DIAGONAL SINK

ITEM

DSB36*

DSB36FD

- * Tilt Out available on pg. 45
- Uses 3/8" overlay hinge

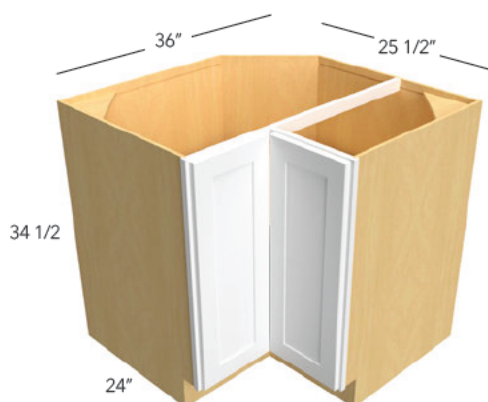

EASY REACH

ITEM

ERB36

- Center shelf is adjustable
- Soft close hinge not available

Base Cabinets

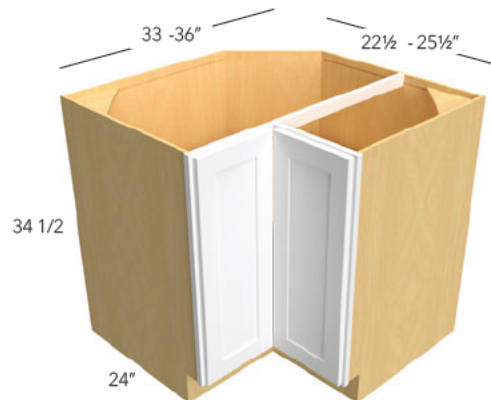

LAZY SUSAN

ITEM

LSB33

LSB36

- Both wooden Lazy Susan trays rotate independently
- Center tray is mounted on 18mm (3/4") adjustable shelf
- Soft close hinge not available



SINK

ITEM

SB24

SB27

SB30

SB33*

SB36*

SB39* ♦

SB42* ♦

- * Has two drawer fronts
- Tilt Out available on pg. 30
- ♦ Has 3" center stile



FARM SINK

ITEM

FS30

FS33

FS36

- Cut opening on job site
- Frame has a full closed top panel
- Maximum **cutout** height 12"
- Maximum **cutout** width 1-1/2" less than the cabinet size

Note: To avoid damage please apply extra care when cutting the front panel.

Specialty Base Cabinets

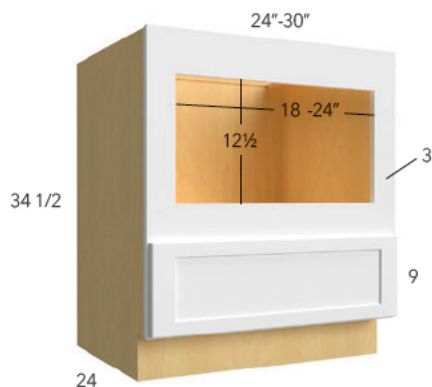

MICROWAVE

ITEM

BMC24

BMC30

- 3" Wide rails face frame to be trimmed on site,
- Minimum Width opening 18" - 24"
- Maximum **cut out** width 22-1/2" - 28-1/2"
- Minimum Height opening 12-1/2"
- Maximum **cut out** height is 18-3/4"H
- Maximum **overall** trim kit height 21"

Note: To avoid damage to the frame & side panels, please apply extra care when cutting the front panel.

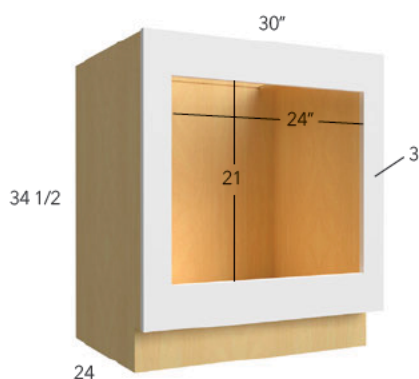

OVEN

ITEM

BOC30

- 3" Wide rails face frame to be trimmed on site,
- Minimum Width opening 24"
- Maximum **cut out** width 28-1/2"
- Minimum Height opening 21"
- Maximum **cut out** height is 28"
- Maximum **overall** oven height 29-3/4"

Note: To avoid damage to the frame & side panels, please apply extra care when cutting the front panel.

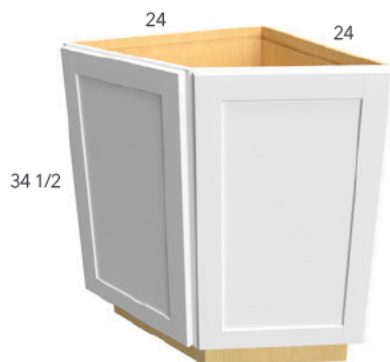

RETURN ANGLE

ITEM

BRA24

- Adjustable shelves
- Available in Galaxy Frost only



TRANSITIONAL

ITEM

BTL12

BTR12

- Cabinet exposed side comes pre-finished with near-flush finished end.
- Cabinet unexposed side comes flush and is not able to have a loose skin or applied finished end. If Interior side needs to be finished, please reach out to Customer Service to have a quote for this modification.

**BASE TRANSITIONAL
RIGHT SHOWN**

Tall Pantry Cabinets



SINGLE DOOR

ITEM

TP152484

TP152490

TP152496

TP182484

TP182490

TP182496

- 21" deep shelves
- 84" high - 5 shelves
- 90" & 96" high - 6 shelves
- Roll Out Drawer available on pg. 39

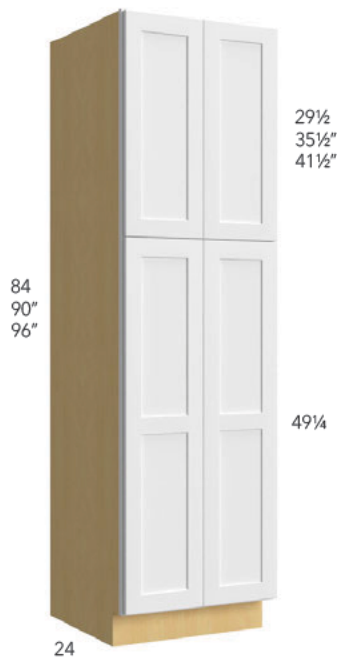

DOUBLE DOOR

ITEM

TP242484

TP242490

TP242496

TP302484

TP302490

TP302496

- 21" deep shelves
- 84" high - 5 shelves
- 90" & 96" high - 6 shelves
- Roll Out Drawer available on pg. 39

Oven Cabinets

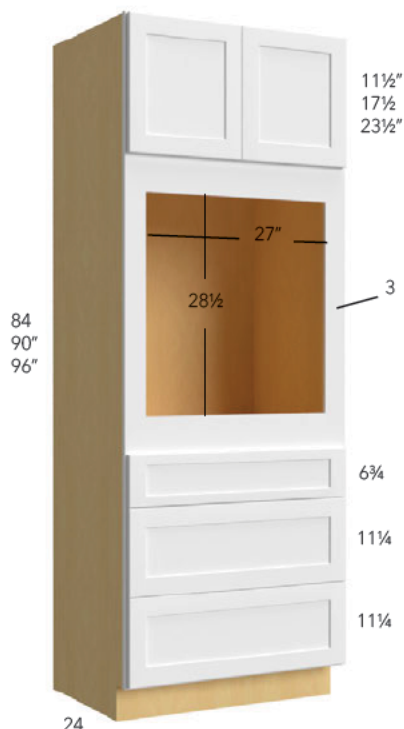

OVEN CABINET SINGLE WITH 3 DRAWERS

ITEM

OC3384S

OC3390S

OC3396S*

- * Has one shelf in top cabinet.
- 3" Wide rails face frame to be trimmed on site

When using a Single Oven:

- Wide rails face frame to be trimmed on side
- Minimum Width opening 27"
- Maximum **cut out** width 31"
- Minimum Height opening 28 1/2"
- Maximum **cut out** height is 37"
- Maximum **overall** oven Height 37 1/2"

Full panel face frame to be trimmed on site (not by Fabuwood).

Note: To avoid damage to the frame & side panels, please apply extra care when cutting the front panel.

SPECIFICATION FOR OVEN CABINET

Tall Oven Cabinets come with single fixed shelf above top drawer.
Fixed shelf will be located above the uppermost drawer; location is based on the selected configurations: Single
Frame is to be trimmed on site to accommodate configuration & appliance needs.

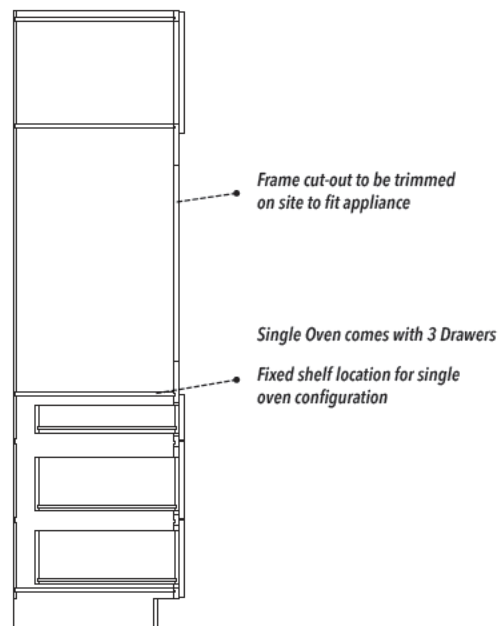

Oven Cabinets

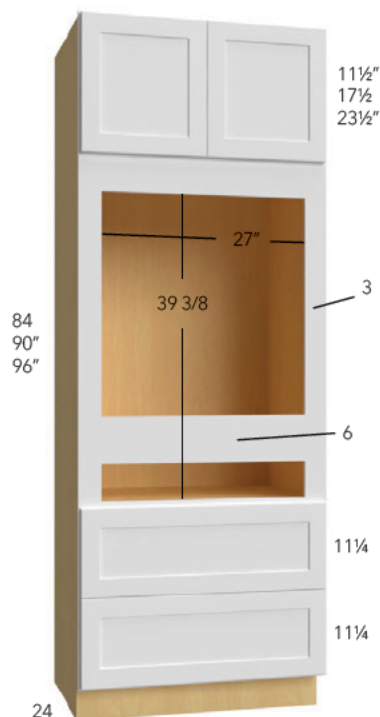

OVEN CABINET COMBO WITH 2 DRAWERS

ITEM

OC3384C

OC3390C

OC3396C*

- * Has one shelf in top cabinet.
- 3" Wide rails face frame to be trimmed on site

When using a Combo Oven:

- Wide rails face frame to be trimmed on side
- Minimum Width opening 27"
- Maximum **cut out** width 31"
- Minimum **cut out** height 39 3/8"
- Maximum **cut out** height is 44"
- Maximum **overall** oven Height 44 5/8"

When using two appliances:

- Will need to insert a filler and fixed shelf to support top appliance, filler and shelf to be purchased separately

Full panel face frame to be trimmed on site (not by Fabuwood).

Note: To avoid damage to the frame & side panels, please apply extra care when cutting the front panel.

SPECIFICATION FOR OVEN CABINET

Tall Oven Cabinets come with single fixed shelf above top drawer.
Fixed shelf will be located above the uppermost drawer; location is based on the selected configurations: Combo
Frame is to be trimmed on site to accommodate configuration & appliance needs.

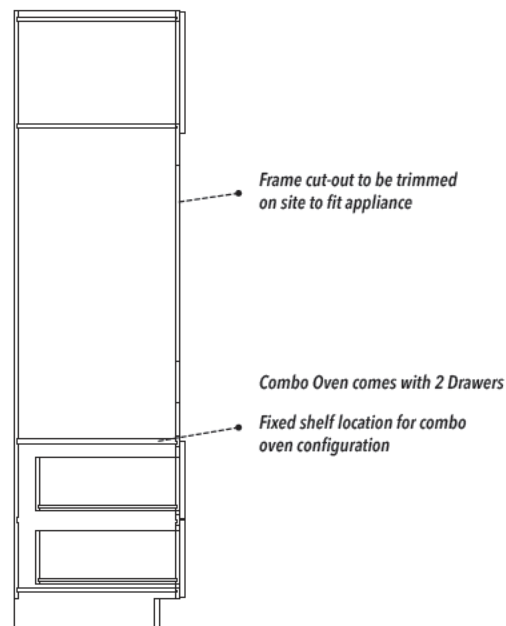

Oven Cabinets

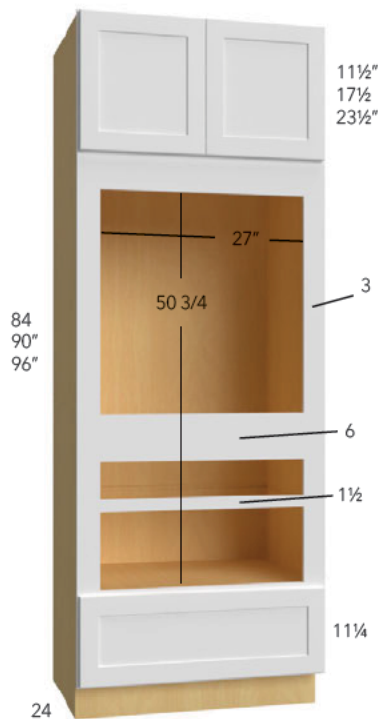

OVEN CABINET DOUBLE WITH 1 DRAWER

ITEM

OC3384D

OC3390D

OC3396D*

- * Has one shelf in top cabinet.
- 3" Wide rails face frame to be trimmed on site

When using a Double Oven:

- Wide rails face frame to be trimmed on side
- Minimum Width opening 27"
- Maximum cut out width 31"
- Minimum cut out height is 50 3/4"
- Maximum cut out height is 55 1/2"
- Maximum overall oven Height 56"

When using two appliances:

Will need to insert a filler and fixed shelf to support top appliance, filler and shelf to be purchased separately

Full panel face frame to be trimmed on site (not by Fabuwood).

Note: To avoid damage to the frame & side panels, please apply extra care when cutting the front panel.

SPECIFICATION FOR OVEN CABINET

Tall Oven Cabinets come with single fixed shelf above top drawer.
Fixed shelf will be located above the uppermost drawer; location is based on the selected configurations: Double
Frame is to be trimmed on site to accommodate configuration & appliance needs.

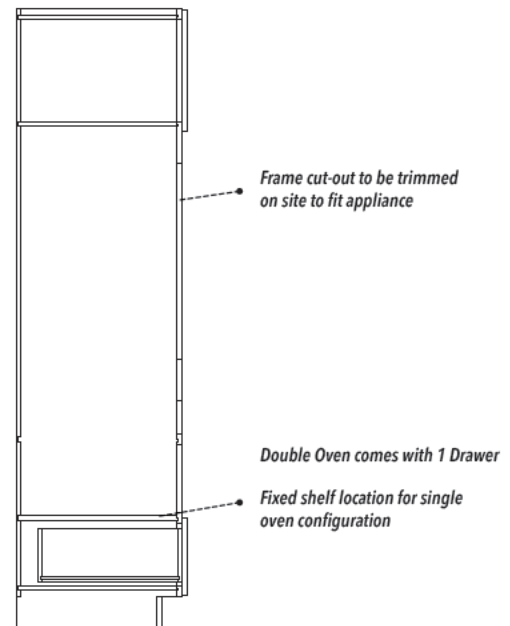

Vanities



FULL HEIGHT SINGLE DOOR VANITY BASE

ITEM

VB12FD

VB15FD

- Shelf depth: 15"



FULL HEIGHT DOUBLE DOOR VANITY BASE

ITEM

VB24FD

VB27FD

VB30FD

VB33FD

VB36FD

- Shelf depth: 15"



VANITY BASE

ITEM

VB12-34

VB15-34

- 2" clearance between drawer and back panel
- Shelf depth: 15"

Vanities



VANITY DRAWER BASE

ITEM

VDB12-34

VDB15-34

VDB18-34

- 2" clearance between drawer and back panel



VANITY SINK BASE

ITEM

VSB24-34

VSB27-34

VSB30-34



VANITY SINK BASE

ITEM

VSB33-34

VSB36-34

Vanities



VANITY SINK & DRAWER COMBO

ITEM

VSD30DR

VSD30DL

- Not available in Nexus

Need to select drawer on right or left side, cabinet can't be reversed R/L after assembled.

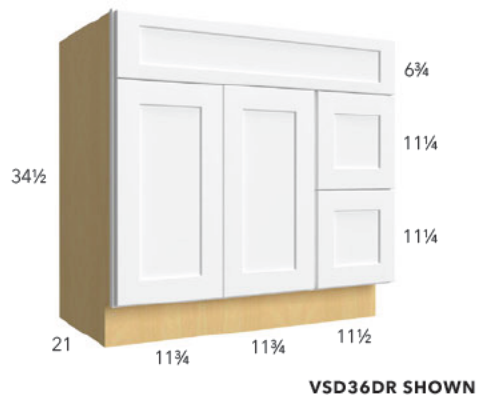

VANITY SINK & DRAWER COMBO

ITEM

VSD36DR

VSD36DL

Need to select drawer on right or left side, cabinet can't be reversed R/L after assembled.



VANITY SINK & DRAWER COMBO

ITEM

VSD42

Vanities



VANITY SINK & DRAWER COMBO

ITEM

VSD48

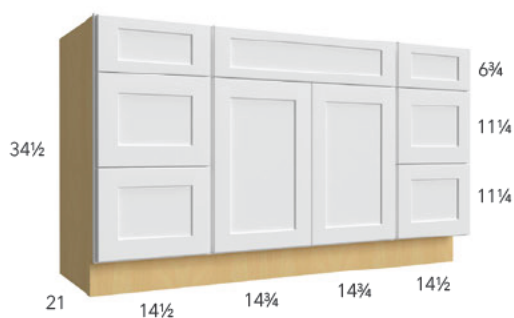

VANITY SINK & DRAWER COMBO

ITEM

VSD60 SINGLE



VANITY SINK & DRAWER COMBO

ITEM

VSD60 DOUBLE

File Drawer / Vanities

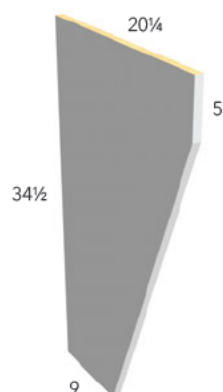

VANITY DESK LEG

ITEM

VDL

- Plywood veneer 3/4" thick
- Front matching color edge banding
- Only available in Frost

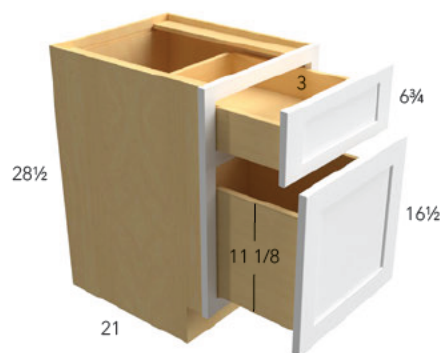

FILE DRAWER BASE

ITEM

FD18

- Cabinet height is 28 1/2"
- File rack not included

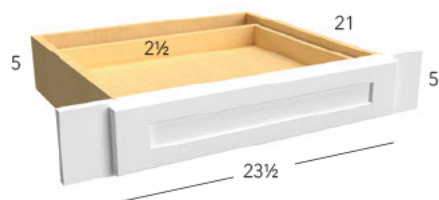

KNEE DRAWER

ITEM

KD30

- Can be trimmed up to 3" on both sides
- Blum soft close undermount
- Recessed drawer front

ADA Cabinets

* All ADA cabinets have a 4½" toe kick

Discontinuation Notice: ADA Cabinets have been discontinued from Allure. Limited quantities available while supplies last.



SINGLE DOOR BASE

ITEM

ADA-B12

ADA-B15

ADA-B18

- Available in Galaxy Espresso, Fusion Dove, and Fusion Nickel
- Cutlery Divider available on pg. 46
- Peninsula modification available on pg. XII
- Roll Out Drawer available on pg. 39



DOUBLE DOOR BASE

ITEM

ADA-B24

ADA-B30

- Available in Galaxy Espresso, Fusion Dove, and Fusion Nickel
- Cutlery Divider available on pg. 46
- Peninsula modification available on pg. XII
- Roll Out Drawer available on pg. 39



DOUBLE DOOR & DRAWER BASE

ITEM

ADA-B36

- Available in Galaxy Espresso, Fusion Dove, and Fusion Nickel
- Peninsula Modification available on pg. XII
- Cutlery Divider available on pg. 49
- Roll Out Drawer available on pg. 39



DRAWER BASE

ITEM

ADA-DB15

ADA-DB24

- Available in Galaxy Espresso, Fusion Dove, and Fusion Nickel
- Cutlery Divider available on pg. 46

ADA Cabinets

* All ADA cabinets have a 4½" toe kick

Discontinuation Notice: ADA Cabinets have been discontinued from Allure. Limited quantities available while supplies last.



SINK BASE - REMOVABLE FRONT

ITEM

ADA-SB30-R

ADA-SB36-R

- Available in Galaxy Espresso, Fusion Dove, and Fusion Nickel
- Match interior



VANITY DRAWER BASE

ITEM

ADA-VDB15

- Available in Galaxy Espresso, Fusion Dove, and Fusion Nickel
- 2" clearance between drawer and back panel



VANITY SINK BASE - REMOVABLE FRONT

ITEM

ADA-VSB30-R

ADA-VSB36-R

- Available in Galaxy Espresso, Fusion Dove, and Fusion Nickel
- Match interior

Waste Solutions / Accessories



TRASH CAN

ITEM

TC15*

TC18

TC21

- Cabinet not included, cabinet must be ordered separately
- Full extension slides (not soft-close)
- 2 - 35 qt. cans included
- Not for ADA cabinet use
- * Single 35 qt. can + one bags bin



TC15



TRASH CAN (BLUM SLIDES)

ITEM

TC15 BLUM*

TC18 BLUM

TC21 BLUM

TCV15 BLUM♦

- Tandem plus Blumotion full extension concealed drawer runners
- Cabinet not included, cabinet must be ordered separately
- 2 - 35 qt. cans included
- Not for ADA cabinet use
- * Single 35 qt. can + one bags bin
- ♦ Smaller depth for vanity cabinets



TC15FHD BLUM



TRASH CAN FULL HEIGHT DOOR (BLUM SLIDES)

ITEM

TC15FHD BLUM*

TC21FHD BLUM

- Tandem plus Blumotion full extension concealed drawer runners
- Cabinet not included, cabinet must be ordered separately
- 2 - 50 qt. can included
- Not for ADA cabinet use
- FULL-DOORS modification is required
- * Single 50 qt. can + one bags bin

Base / Accessories



ROLL OUT (PARTIAL EXTENSION BLUM SLIDES)

ITEM

ROD-B15 BLUM E

ROD-B18 BLUM E

ROD-B21 BLUM E

ROD-B24 BLUM E

ROD-B27 BLUM E

ROD-B30 BLUM E

ROD-B33 BLUM E

ROD-B36 BLUM E

- Cabinet not included
- Price is for a single Roll Out drawer
- Blumotion partial extension concealed drawer runners
- Drawers are adjustable
- Can be used for pantries



ROLL OUT (FULL EXTENSION BLUM SLIDES)

ITEM

ROD-B15 BLUM H

ROD-B18 BLUM H

ROD-B21 BLUM H

ROD-B24 BLUM H

ROD-B27 BLUM H

ROD-B30 BLUM H

ROD-B33 BLUM H

ROD-B36 BLUM H

- Cabinet not included
- Price is for a single Roll Out drawer
- Blumotion full extension concealed drawer runners
- Drawers are adjustable
- Can be used for pantries

Base / Accessories



TWO-TIER COOKWARE ORGANIZER

ITEM

CWO-B18 BLUM

CWO-B24 BLUM

- Cabinet not included
- Full-extension Blum slides
- Pegboard bottoms
- 4 Press-in pegs included



3" TOWEL BAR PULL OUT

ITEM

TBPO-BF3

- Filler & Overlay Filler are required and need to be ordered separately
- 2 Towel bars
- Single static shelf with chrome wire accents
- UV coated maple wood
- Installed on site
- Installed between two cabinets
- Full-extension, ball-bearing slides with soft-close



SPICE PULL OUT BASE 9"

ITEM

SPO-B9*

SPO-B9 BLUM

- Cabinet not included, cabinet must be ordered separately
- Chrome rails
- Adjustable shelves
- UV coated maple wood
- Not for ADA cabinet use
- * Full extension ball-bearing slides (not soft-close)

Base / Accessories



9" UTENSIL PULL OUT

ITEM

UPO-B9 BLUM

- Cabinet not included, cabinet must be ordered separately
- Chrome rails
- Adjustable shelves
- UV coated maple wood
- Not for ADA cabinet use
- Features Blumotion soft-close drawer slides



UTENSIL & KNIFE PULL OUT

ITEM

UKBPO-B12 BLUM

- Cabinet not included, cabinet must be ordered separately
- Designed for 12" full height base cabinet
- Knife block features flex rod technology that adjust to securely hold knives
- Chrome rails
- Adjustable top shelf
- 2 qt. removable stainless steel bin included
- 4 flexible plastic cutting mats included
- UV coated maple wood
- Not for ADA cabinet use
- Features Blumotion soft-close drawer slides



9" TRAY DIVIDER PULL OUT

ITEM

TDPO-B9 BLUM

- Cabinet not included, cabinet must be ordered separately
- UV coated maple wood
- Not for ADA cabinet use
- Features Blumotion soft-close drawer slides

Base & Wall / Accessories



SPICE PULL OUT BASE FILLER

ITEM

SPO-BF3*

SPO-BF3 BLUM

SPO-BF6*

SPO-BF6 BLUM

- Filler & Overlay Filler are required and need to be ordered separately
- Chrome rails
- Adjustable shelves
- UV coated maple wood
- Installed on site
- Installed between two cabinets
- Not for ADA cabinet use
- Wall filler 30" high is recommended instead of a base filler, requires to build toe kick separately
- * Full extension ball-bearing slides (not soft-close)

SPICE PULLOUT WALL FILLER

ITEM

SPO-WF330

SPO-WF336

SPO-WF342

SPO-WF630

SPO-WF636

SPO-WF642

- Filler & Overlay Filler are required and need to be ordered separately
- Chrome rails
- Full extension ball-bearing slides (BLUM soft-close slides not available)
- Adjustable shelves
- UV coated maple wood
- Installed on site
- Installed between two cabinets

Wall / Accessories



LAZY SUSAN

ITEM	
PLASTIC	LSP24 30
	LSP24 36/42
WOOD	LSW24 30
	LSW24 36/42
	LSW27 30*
	LSW27 36/42*

- Adjustable metal post
- 42" lazy susan has 3 trays
- Prepared for installation at job site
- 42" poles can be cut to fit 36" high cabinet
- * 20" trays



STEMWARE RACK

ITEM	
STEMWARE 30	
STEMWARE 36	

- Comes unfinished. Product finished per order. May have extended ETA.

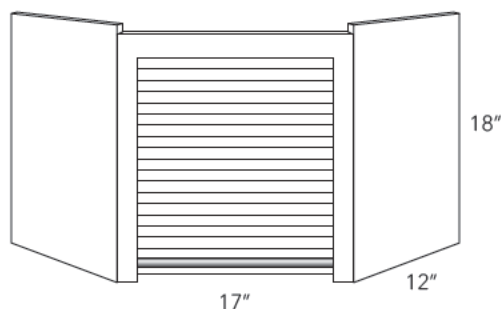

CORNER APPLIANCE GARAGE

ITEM	
APPLIANCE GARAGE	

- Comes unfinished. Product finished per order. May have extended ETA
- Designed to be installed under a diagonal corner wall 24".

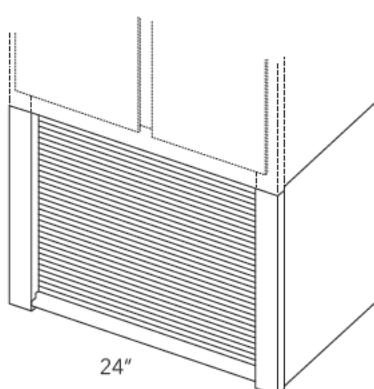

STRAIGHT APPLIANCE GARAGE

ITEM	
APPLIANCE GARAGE 24"	

- Product finished per order. May have extended ETA
- Designed to be placed under a 24" wide wall cabinet.
- Stiles are 2" wide

Wall / Accessories



FLOATING SHELF

ITEM

FLS24

FLS30

FLS36

FLS42

FLS48

FLS54

- Includes hanging bracket & mounting hardware
- Dimensions:
Width: 24", 30", 36", 42", 48", 54"
Height - 2½"
Depth - 10"
- Floating shelves are finished at the time of order placement and may extend the ETA on the order



WALNUT FLOATING SHELF

ITEM

FLS24 WALNUT

FLS30 WALNUT

FLS36 WALNUT

FLS42 WALNUT

FLS48 WALNUT

FLS54 WALNUT

- Includes hanging bracket & mounting hardware
- Dimensions:
Width: 24", 30", 36"
Height - 2½"
Depth - 10"

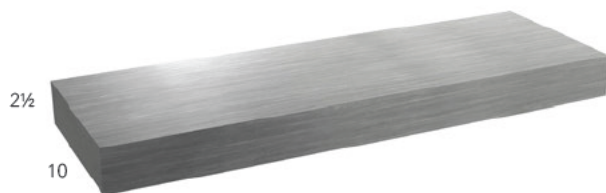

STAINLESS STEEL FLOATING SHELF

ITEM

SSFLS24

SSFLS30

SSFLS36

- Includes hanging bracket & mounting hardware
- Dimensions:
Width: 24", 30", 36"
Height - 2½"
Depth - 10"

Sink / Accessories



TILT OUT

ITEM
TILTOUT 11
TILTOUT 14
TILTOUT 24

- *White plastic tray*

Drawer / Accessories



TRIMMABLE CUTLERY INSERT

ITEM

CD-S

CD-L

- UV coated maple wood
- $\frac{3}{8}$ " dividers
- $2\frac{1}{2}$ " interior height
- $\frac{3}{8}$ " plywood bottom
- Includes installation

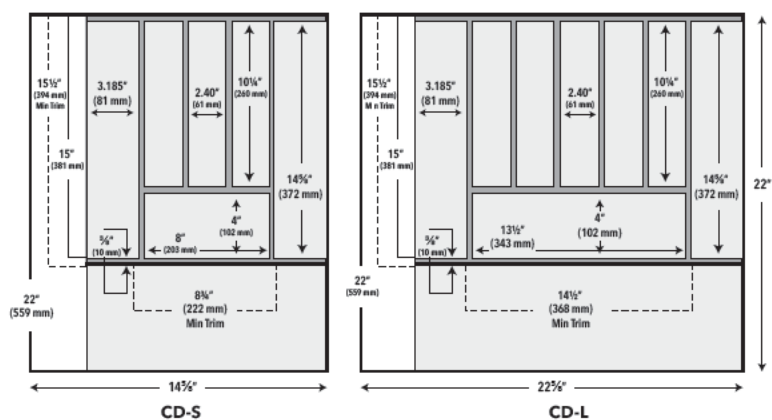

WIDE TRIMMABLE CUTLERY INSERT

ITEM

CD-XL

- Designed for 36" or smaller base cabinet drawers
- UV coated maple wood
- $\frac{3}{8}$ " dividers
- $2\frac{1}{2}$ " interior height
- $\frac{3}{8}$ " plywood bottom
- Includes installation

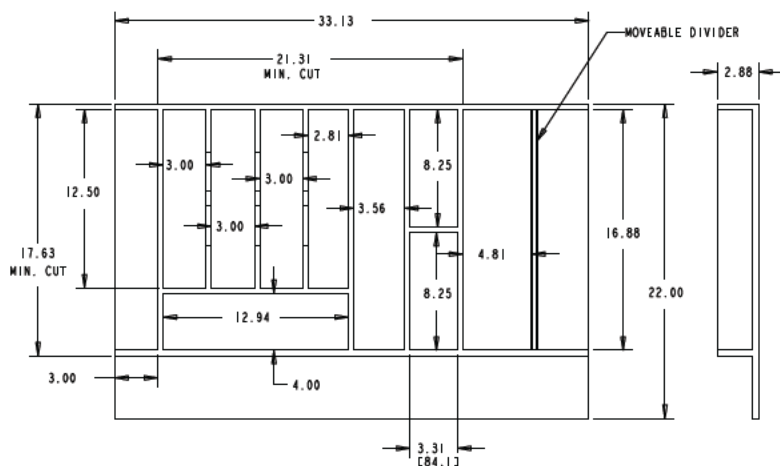

Drawer / Accessories



TRIMMABLE UTENSIL INSERT

ITEM

UT-15/24

- To fit 15" - 24" drawer
- Minimum cut width 8-1/2" W, Max 18-1/2" W. In a 24"W cabinet, will have extra room.
- UV coated maple wood
- 3/8" dividers
- 2 1/2" interior height
- 3/8" plywood bottom
- Includes installation

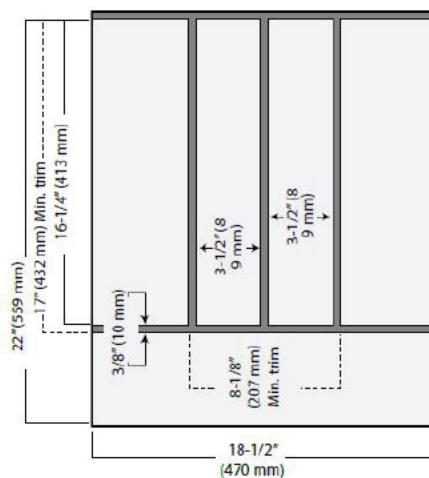

Drawer / Accessories



TIERED DEEP DRAWER

ITEM

DTD-DB30 BLUM

DTD-DB36 BLUM

- For DB30 & DB36 only
- Replaces the original drawer box of cabinet
- UV coated maple wood
- Drawer front not included
- 3 drawer compartments
- Blumotion full extension concealed drawer runners



CUTTING BOARD & KNIFE DRAWER

ITEM

CBKD-B18 BLUM

- For 18" cabinet drawer only
- Replaces the original drawer box of cabinet
- UV coated maple wood
- Up to 4 compartments and built-in knife organizer
- 1 wooden cutting board
- Blumotion full extension concealed drawer runners



CHARGING DRAWER

ITEM

CHD-B18 BLUM

- For 18" cabinet drawer only
- Replaces the original drawer box of cabinet
- UV coated maple wood
- Blumotion full extension concealed drawer runners
- (2) 120V plugs and (2) 201 amp USB ports
- Tamper resistant outlets
- Max current: AC: 12 amps @ 120VAC; USB 2.1 amp & 5 VDC
- Power cord with NEMA 5 - 15 plug
- Integrated cord guide to ensure safe operation
- Shock absorbent mat, black
- Overall safety of this product is determined by its end use

Drawer / Accessories



2-TIER CUTLERY DRAWER

ITEM

DCD-15 BLUM

DCD-18 BLUM

DCD-21 BLUM

DCD-24 BLUM

- UV coated maple wood
- Includes complete 3¾" high drawer box
- Features Blum soft-close slides



2-TIER CUTLERY COMBO DRAWER

ITEM

DCD-30 BLUM

DCD-36 BLUM*

- UV coated maple wood
- Includes complete 3¾" high drawer box
- Features Blum soft-close slides
- * For DB36 only



TRIMMABLE KNIFE DIVIDER

ITEM

DKI-18/24

- UV coated maple wood
- Total height: 2"
- ¾" plywood bottom

Vanity / Accessories



VANITY OUTLET GROOMING ORGANIZER

ITEM

VGO12FD BLUM

- Cabinet not included, cabinet must be ordered separately
- Designed for 12" full height cabinet
- 2 removable stainless steel bins included
- 2 shelves with non-skid vinyl lining and acrylic accents
- In-drawer receptacle with (2) 120V plugs
- Tamper-resistant outlets
- Max Current: AC: 12 amps @ 120VAC
- Power cord with NEMA 5 - 15 plug
- Integrated cord guide ensures safe operation
- Drawer stop prevents items from being stored "ON" inside the cabinet
- Its end-use determines the overall safety of this product
- UV coated maple wood
- Not for ADA cabinet use
- Blumotion full extension concealed drawer runners



TRIMMABLE VANITY DRAWER ORGANIZER INSERT

ITEM

VDO

- Designed for 21" or smaller vanity base drawers
- Fits perfectly for KD30 cabinet
- Anti-skid vinyl lining
- Up to 13 compartments
- 2 clear acrylic lids
- UV coated maple wood



VANITY APPLIANCE STORAGE RACK

ITEM

VASR-30

- Designed for 30" vanity base cabinet
- Mounts to inside of right or left door
- Non-skid lining on lower level shelf
- (2) 1.25 qt. stainless steel bins
- UV coated maple wood

Vanity / Accessories



VANITY ORGANIZER PULL OUT

ITEM

VOPO-24 BLUM

- Tandem plus Blumotion full extension drawer runners
- Designed for 24"-30" Vanity Sink Base
- Reversible
- 6 Acrylic bins included



U-SHAPED VANITY SINK BASE PULL OUT

ITEM

UVTCPO-30 BLUM

- Tandem plus Blumotion full extension drawer runners
- Designed for 30" Vanity Sink Base, but works great in standard depth base cabinets as well
- Non-skid vinyl lining
- 4 adjustable dividers
- 8 qt. waste container included

Any accessories can be ordered and installed through Fabuwood

Fillers / Accessories

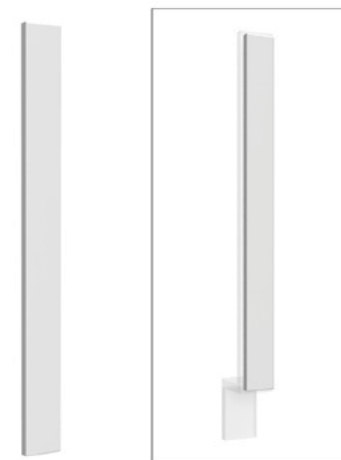
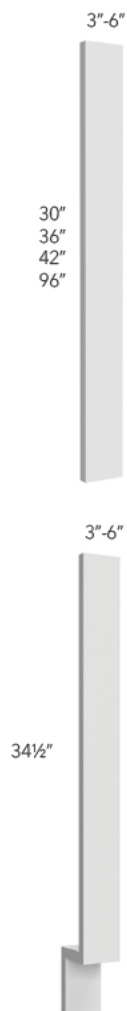

**OVERLAY FILLER ON
BASE FILLER SHOWN**

WALL & TALL

ITEM
WF330
WF336
WF342
WF630
WF636
WF642
TF396
TF696

- Wall/Tall Fillers are finished on all four edges and front face
- Spice Pullout available on pg. 42

BASE

ITEM
BF3
BF6

- Base Fillers are finished on all four edges of upper filler area and front face; recessed toe kick area not finished
- Spice Pullout available on pg. 42

OVERLAY

ITEM
OLF330*
OLF336*
OLF342*
OLF384* ♦
OLF390* ♦
OLF396* ♦
OLF630**
OLF636**
OLF642**

* Actual width: 2½"

** Actual width: 5½"

- All four edges and front face of Overlay Filler are finished
- Back filler to be ordered separately
- ♦ Height is 5-1/8" less then the cabinet height

Valances / Accessories



STRAIGHT

ITEM

VST96

- Edge profile



**FUSION
PROFILE**



**GALAXY/LUNA
PROFILE**



**IMPERIO
PROFILE**



**NEXUS
PROFILE**



**ONYX
PROFILE**



ARCHED

ITEM

VAR36

VAR54

- Edge profile
- Can be trimmed up to 3" on each side



**FUSION
PROFILE**



**GALAXY/LUNA
PROFILE**



**IMPERIO
PROFILE**



**NEXUS
PROFILE**



**ONYX
PROFILE**



ARCHED-RECESSED PANEL

ITEM

VARP36

VARP42

VARP48

VARP54

- Not available in Luna
- Can be trimmed up to 3" on each side

Posts / Accessories

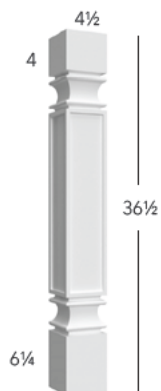

STANDARD POST

ITEM

SP36

- Must trim 2" from top or bottom

Disclaimer: Posts are handmade and may therefore feature inconsistencies in shape or form. These are in no way considered defects.

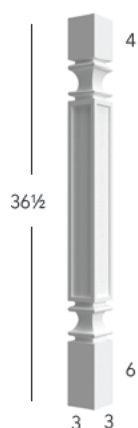

STANDARD POST

ITEM

SP3X3

- Must trim 2" from top or bottom

Disclaimer: Posts are handmade and may therefore feature inconsistencies in shape or form. These are in no way considered defects.

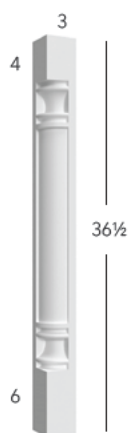

CORNER POST

ITEM

CP36

- Must trim 2" from top or bottom

Disclaimer: Posts are handmade and may therefore feature inconsistencies in shape or form. These are in no way considered defects.

Pilasters / Accessories



PLAIN PILASTER BASE & TALL

ITEM

PP-BASE*

PP-TP84

PP-TP90

PP-TP96

- * Must trim 2" from top or bottom
- Features a toe kick block behind the pilaster

Disclaimer: Pilasters are handmade and may therefore feature inconsistencies in shape or form. These are in no way considered defects.



PLAIN PILASTER WALL

ITEM

PP-W30

PP-W36

PP-W42

Disclaimer: Pilasters are handmade and may therefore feature inconsistencies in shape or form. These are in no way considered defects.

Moldings (8') / Accessories

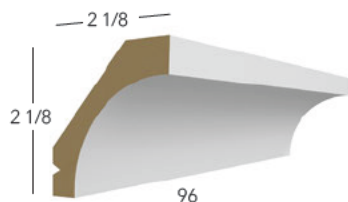

SMALL COVE

ITEM

CM-3

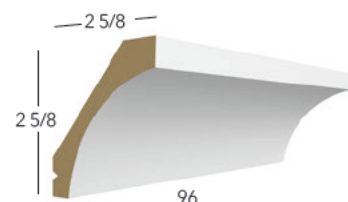

LARGE COVE

ITEM

CM-4

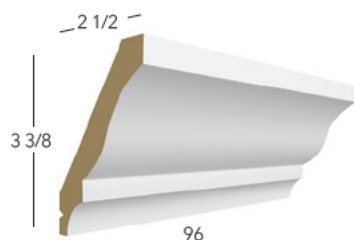

LARGE CROWN

ITEM

CM-6

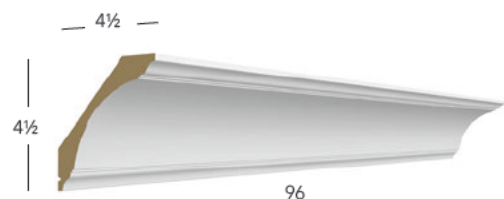

LARGE COVE CROWN

ITEM

CM-7

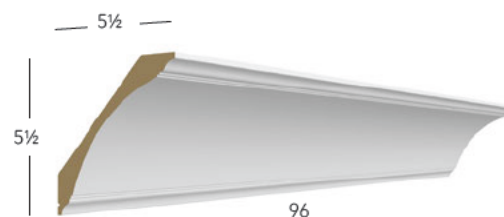

X-LARGE COVE CROWN

ITEM

CM-8

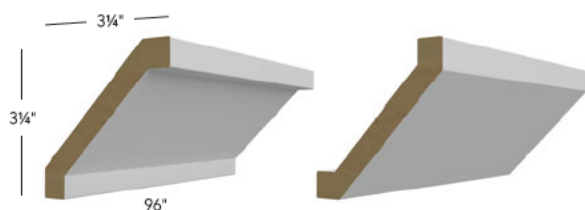

SHAKER CROWN

ITEM

CM-9*

- Reversible molding, can be installed two ways
- * Only available in Dove & Kona

Moldings (8') / Accessories

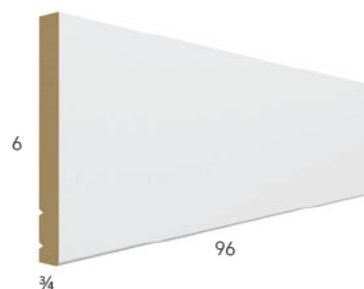

EXTENSION

ITEM

MEX-8



STARTER

ITEM

STRM-8



STACKING

ITEM

STKM-8

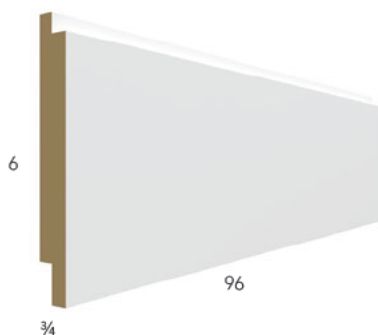

SHIP LAP

ITEM

SHL-8

Moldings (8') / Accessories

LIGHT RAIL

ITEM
LRM

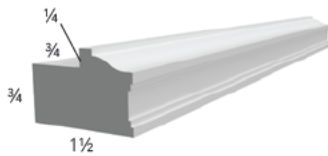

NEXUS

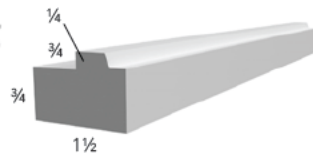

LUNA/GALAXY/ONYX

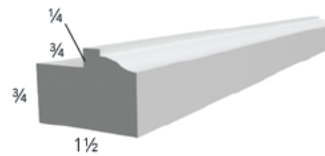

FUSION

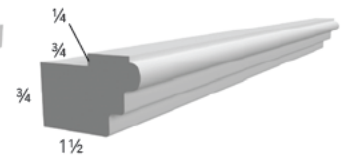

IMPERIO

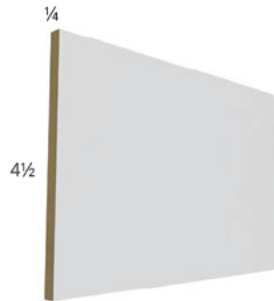

TOE KICK

ITEM
TK8

- Matching color medium-density fiberboard toe kick



BASE BOARD

ITEM
BBM



**FUSION
PROFILE**



**LUNA & GALAXY
PROFILE**



**IMPERIO
PROFILE**



**NEXUS
PROFILE**



**ONYX
PROFILE**

Moldings (8') / Accessories

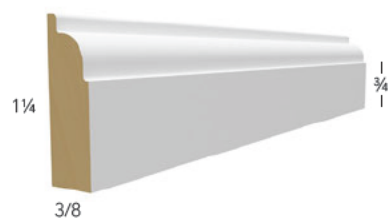

DECORATIVE SCRIBE

ITEM

SM8-D



SIMPLE SCRIBE

ITEM

SM8-S

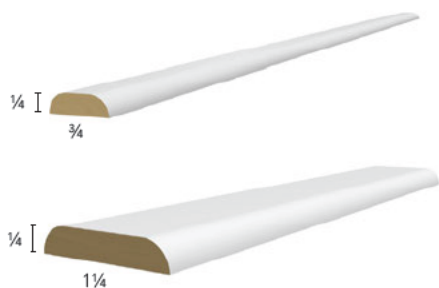

BATTEN

ITEM

BM3/4

BM1 1/4

Moldings (8') / Accessories



QUARTER ROUND

ITEM

QRM

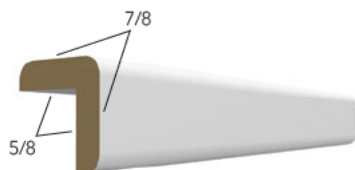

OUTSIDE CORNER

ITEM

OCM8

OCM8-1 1/4

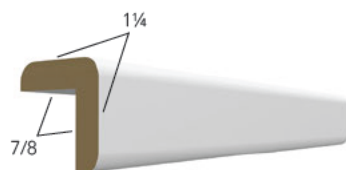

INSIDE CORNER

ITEM

ICM8

Corbels & Panels / Accessories

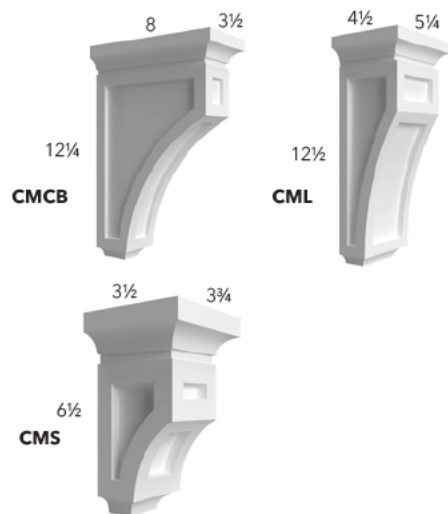

CORBEL

ITEM

CMCB

CML

CMS

Disclaimer: Corbels are handmade and may therefore feature inconsistencies in shape or form. These are in no way considered defects.

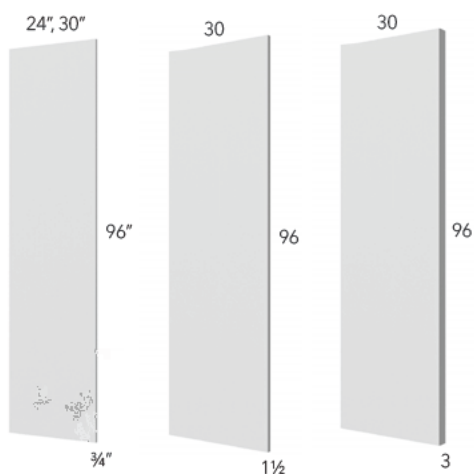

REFRIGERATOR END PANEL

ITEM

REP1-1/2**

REP2496*

REP3**

REP3096*

REP3096 x 1 1/2**

REP3096 x 3**

* Both 96" sides are edge-banded

** Sides are flush finished, (no 1/4" reveal)

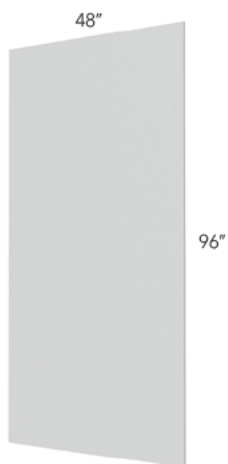

PLYWOOD

ITEM

PAN-1/4

PLY-1/2

PLY-3/4

• Finished on 2 sides only

Panels / Accessories

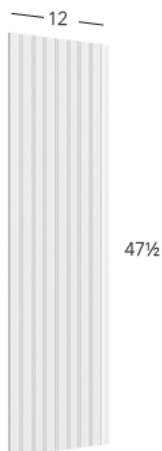

**BPP-12
CLOSE-UP**

BEADED PANEL PLANK

ITEM

BPP-12

- Replaces BP4x8
- 3/8" thick x 12 7/8"W x 47 1/2"H interlocking panel.
- Beads are 1 1/2" center-to-center.
- Visible finished portion of the panel is 12"W so when assembled together with additional planks they install in 12" increments.
- Trim panel to fit on site.

Panels / Accessories



WAINSCOT PANEL

ITEM

WP-BASE

WP-T84*

WP-T90*

WP-T96*

WP-W15

WP-W30

WP-W36

WP-W42

- Same profile as cabinet door
- Base: 23 1/2"W x 29 1/2"H
- Wall: 11 1/2"W x 14 1/2" / 29 1/2" / 35 1/2" / 41 1/2"
- Tall: 11 3/4"W each door. Height matches that of pantry configuration. Tall bottom door is 49-1/4"H. Includes set of 4 doors.

* Can be used for 12" deep pantry

NOTE: Wainscot Panels may come with hinge holes pre-drilled on the back of the door

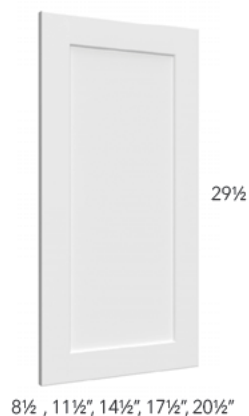

DECO DOOR

ITEM

DD W0930 DOOR

DD W1230 DOOR

DD W1530 DOOR

DD W1830 DOOR

DD W2130 DOOR

- Size of door is same as door on cabinet
- May have extended ETA
- Comes pre-drilled for hinges

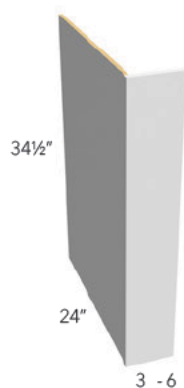

DISHWASHER RETURN END PANEL

ITEM

DWR3

DWR6

- Sides are flush finished, (no 1/4" reveal)

Columns / Accessories



COLUMNS

ITEM

CLM-30

CLM-36

CLM-42

CLM-96

CLM-BASE

- Base: 24" deep
- Tall: 27" deep
- Wall: 15" deep
- To cut column see modifications available on pg. XI
- Any size custom column can be created for additional charge
- Sides are flush finished (no 1/4" reveal)
- Back is unfinished

TOUCH UP KIT

ITEM

TOUCH UP KIT

- Includes stick, marker, & scraper



This image shows a full page of white paper with horizontal blue or grey ruling lines. The lines are evenly spaced and run across the width of the page, providing a template for handwriting practice or general writing. There are no margins, text, or other markings on the page.

Copyright © 2022 by Fabuwood Cabinetry Corp.

All rights reserved.

No part of this publication may be reproduced, distributed, or transmitted in any form or by any means, including photocopying, scanning, or other electronic or mechanical methods, including online sharing, without the prior written permission of Fabuwood Cabinetry Corp.



69 Blanchard Street | Newark, NJ 07105 | T: (201) 432-6555 | F: (201) 432-6055 | www.fabuwood.com