



## Quest

Specifications Guide / Valid thru May 2022

**Please Note:** Items are subject to change without prior notice. This spec book is missing some updated information, so to stay up to date with product specifications and modification options please use our new digital spec book which can be found at <https://ezpricing.fabuwood.com/specbook>

## Construction Specifications

### Quest Doors and Drawer Fronts:

The 5 piece Quest traditional overlay door has an MDF recessed center panel captured in a  $\frac{3}{4}$ " solid frame and is complimented with 5-piece matching drawer front.

### Hinges:

Compact Blumotion (#38N355B.06) soft-close mechanism integrated in concealed six-way adjustable hinges.

### Drawers:

The Quest line includes a  $\frac{5}{8}$ " thick solid wood dovetail drawer box with a  $\frac{3}{8}$ " plywood bottom. Tandem plus Blumotion (#554H5330B01) 80% extension concealed drawer runners.

### Shelving:

15mm ( $\frac{5}{8}$ ") thick select veneered plywood with matching wood edge-banding is used on all wall and base cabinetry where applicable. The adjustable shelves are supported by plastic self locking shelf clip.

### Backs, Tops and Bottoms:

$\frac{1}{2}$ " thick veneered plywood with natural finished interiors. The backs are stapled and screwed into place for additional support.

### Face Frame:

$\frac{3}{4}$ " x  $1\frac{1}{2}$ " solid wood stiles and rails jointed with glue and dowels. Back of face frames are grooved to accept side panels.

### Toe Kick:

$\frac{3}{4}$ " x  $4\frac{1}{2}$ " select unfinished plywood toe kick is added to each assembled cabinet. Additional 8-foot lengths of  $\frac{1}{4}$ " toe kicks are available in matching colors to our cabinetry.

### Panel Beams:

Panel beam is fastened into a dovetail groove at the top of each base cabinet to ensure a straight fully integrated side, and for the mounting of the countertop.

## Construction Specifications

- ❶ Solid wood door and drawer front frames are mortise and tenon.
- ❷ Door and drawer fronts are standard overlay.
- ❸ Compact Blumotion (®38N355B.06) soft-close mechanism integrated in concealed six-way adjustable hinges.
- ❹ 5/8" solid wood dovetail drawer with 3/8" plywood bottom. Tandem plus Blumotion (®554H5330B01) 80% extension concealed drawer runners.
- ❺ 2 1/2" interior drawer height.
- ❻ 3/4" x 1 1/2" solid wood face frame.
- ❼ 1/2" select veneered plywood back with a natural finished interior.
- ❽ 1/2" unfinished plywood side panels grooved into face frame.
- ❾ 15mm (5/8") select veneered plywood adjustable shelving with matching wood veneer edge banding.
- ❿ Base and tall cabinets are constructed with 3/4" x 4 1/2" plywood toe kick. Additional 8-foot lengths of 1/4" toe kicks are available in matching colors to our cabinetry.
- ⓫ Panel beam is fastened into a dovetail groove at the top of each base cabinet to ensure a straight fully integrated side, and for mounting of the countertop.
- ⓫ Base cabinet has 11 7/8" deep shelf.
- ⓫ When placing an order, need to select exposed sides; Right, Left or Both. A 1/4" select medium-density fiberboard panel will be applied to the selected side(s), and the side will be near flush finished.

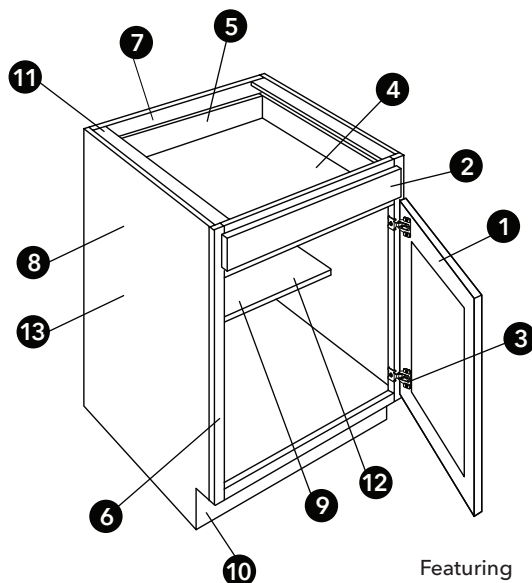
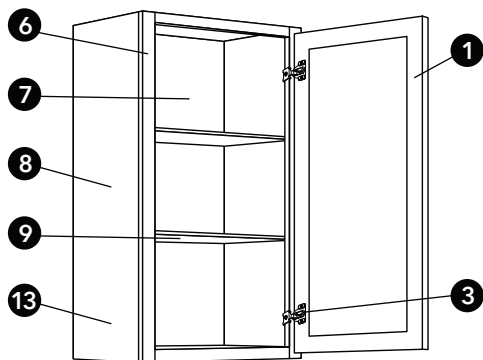

Featuring  

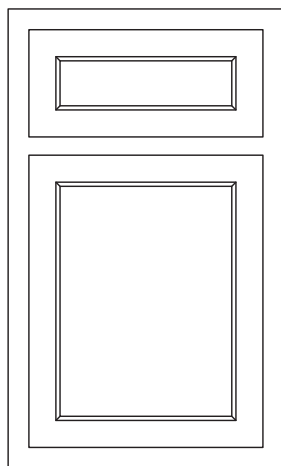

## Door Style



### METRO

COLOR	FINISH
Frost	Paint
Mist	Stain
Java	Stain

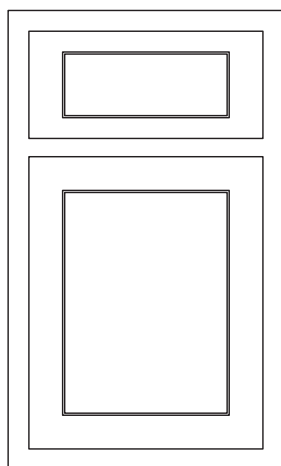
- Traditional overlay door
- Rails are solid wood 3/4" thick and 2" wide
- Constructed with mortise and tenon joints
- MDF center panel captured into solid wood rails 6mm thick
- 5-piece recessed panel drawer front matches door edge design
- Door & drawer stiles and rails are 3/4" thick



### DISCOVERY

COLOR	FINISH
Frost	Paint

- Traditional overlay door
- Rails are solid wood 3/4" thick and 2 1/4" wide
- Constructed with mortise and tenon joints
- MDF center panel is 5mm thick
- 5-piece recessed panel drawer front matches door edge design

## Sales Tools

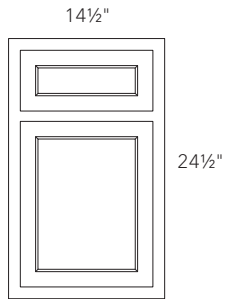

### DOOR SAMPLES WITH DRAWER FRONT

ITEM	DESCRIPTION
SDMF	METRO FROST
SDMM	METRO MIST
SDMJ	METRO JAVA
SDDF	DISCOVERY FROST

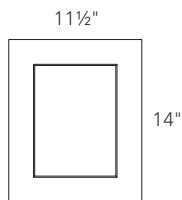

### SMALL DOOR SAMPLES

ITEM	DESCRIPTION
SDMF-2	METRO FROST
SDMM-2	METRO MIST
SDMJ-2	METRO JAVA
SDDF-2	DISCOVERY FROST

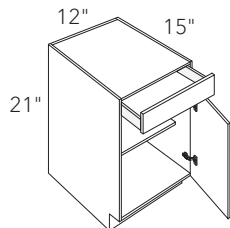

### MINI BASE SAMPLE

ITEM	DESCRIPTION
MM MBS	BASE SAMPLE 12\"W X 21\"H X 15\"D

- Available in Allure Galaxy Frost and Quest Metro Mist finish only.

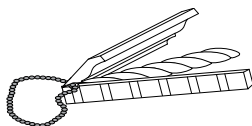

### MOLDING CHAIN

ITEM	DESCRIPTION
MLK-QUEST	COMPLETE CHAIN OF ALLURE MOLDINGS

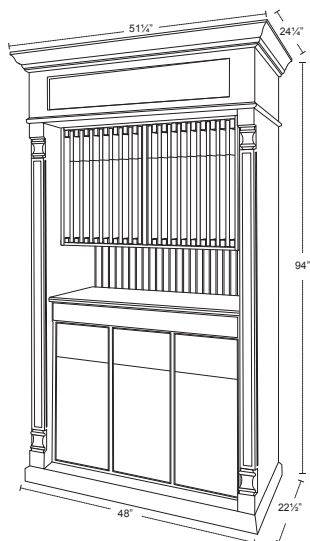

### SELLING CENTER

ITEM	DESCRIPTION
DEALER SELLING CENTER	FABUWOOD SELLING CENTER

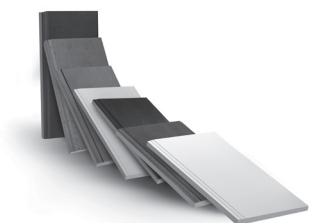

### COLOR BLOCKS

ITEM	DESCRIPTION
COLOR BLOCK	BOX OF COLOR BLOCKS

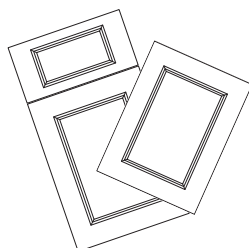

### SAMPLE PACKAGES

ITEM	DESCRIPTION
SMALL SAMPLE PACKAGE	SMALL SAMPLE PACKAGE
DEALER PACKAGE	LITERATURE AND ACCESSORIES



### DIGITAL BROCHURE

ITEM	DESCRIPTION
DIGITAL BROCHURE QR	QR CODE KEY RING

## Modifications

### CUT ITEMS

ITEM	DESCRIPTION
CUT-BASE	Reduce depth of base cabinet (min. depth 12")
CUT-DBASE	Reduce depth of drawer base cabinet (min. depth 12")
CUT-SBASE	Reduce depth of sink base cabinet (no min.)
CUT-WALL	Reduce depth of wall cabinet (no min.)
CUT-TALL	Reduce depth of tall cabinet (no min.)
CUT-DOOR	Cut out center panel of door for glass insert (per door, glass not included)
CUT-COLUMN	Reduce depth of column (specify depth)
CUT-BASE HEIGHT	Reduce height of base cabinet by cutting off top drawer (total base height: 28½")
CUT-TK	Reduce toe kick height (no min.)
CUT-PANEL	Cut down a panel to any size
CUT-ROD	Reduce depth of rollout drawer (specify depth of cabinet)

### PIPE CHASE

ITEM	DESCRIPTION
CHASE-BASE	Make chase in base cabinet
CHASE-DBASE	Make chase in drawer base cabinet
CHASE-WALL	Make chase in wall cabinet
CHASE-TALL	Make chase in tall cabinet
CHASE-CORNER	Make chase in corner cabinet (WDC, WPC & ERB only)

*Must supply a drawing for all chase modifications.*

### CUSTOMIZATIONS

ITEM	DESCRIPTION
CREATE-ERB	Remove tray, install bottom panel on top, to create easy reach
CREATE-RETURN WALL*	Create a return wall filler up to 6"W x 15"D x 42"H (materials incl.)
CREATE-RETURN TALL*	Create a return tall filler up to 6"W x 30"D x 96"H (materials incl.)
CREATE-COLUMN BASE*	Create a 3" column up to 30"D by 34½"H
CREATE-COLUMN TALL*	Create an oversized column
CREATE-COLUMN WALL*	Create a 3" column up to 15"D x 42"H
HAMPER	Install door mounted pull out wood hamper in cabinet (cabinet not incl.)

\* Email orders@fabuwood.com for quote

### MODIFICATIONS

ITEM	DESCRIPTION
BMC24	Create a 24" base microwave cabinet from a DB24 with a closed front
REMOVE-DRAWER	Remove cabinet drawer to create false drawer front
CLOSE-BLIND	Close open section of a blind wall or base cabinet
ATTACH-TK	Attach toe kick on wall cabinet

## Modifications

### MODIFICATIONS CONT.

ITEM	DESCRIPTION
RECESS-TK	Recess toe kick of base cabinet (must supply a drawing)
EDGE-BAND	Additional edge banding (price per linear foot)
PEN-CABINET	Create a peninsula cabinet from 2 cabinets (cabinets not incl.)
INCREASE-BASE	Increase depth on base cabinet
INCREASE-WALL	Increase depth on wall cabinet
INCREASE-TALL	Increase depth on tall cabinet
MATCH-INTERIOR	Stain interior of cabinet to match exterior
CREATE- SQ BOTTOM	Square bottom shelf for wall open end to enable light rail molding
FLUSH-WALL BOTTOM	Flush the bottom of a wall cabinet
FLUSH-TOE KICK	Flush toe kick of base cabinet to face frame (sides not finished)
FULL-DOORS	Create full height door base cabinet from 2 cabinets (cabinets not incl.)
OE6	Cut OE12 to 6"

\* Email orders@fabuwood.com for quote

### UPGRADES

ITEM	DESCRIPTION
INSTALL-ACCES	Install any accessory in a cabinet (accessories not incl.)

\* Email orders@fabuwood.com for quote

### LOOSE PARTS

ITEM	DESCRIPTION
SHELF BASE	Loose 24" deep shelf (specify cabinet size)
SHELF WALL	Loose 12" deep shelf (specify cabinet size)
SHELF TALL	Loose 24" deep shelf (specify cabinet size)
SHELF-DSB	Loose shelf (specify cabinet size)
SK BASE	Skin for base cabinet with adhesion
SK MC	Skin for microwave wall cabinet with adhesion
SK TALL	Skin for tall cabinet with adhesion
SK W30	Skin for 30" high wall cabinet with adhesion
SK W36	Skin for 36" high wall cabinet with adhesion
SK W42	Skin for 42" high wall cabinet with adhesion

*Many more modifications available- please contact your customer service rep.*



## 12", 15" & 18" High Wall Cabinets

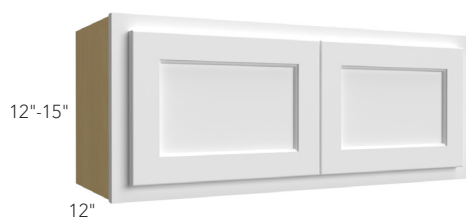

### 12" - 15" HIGH

ITEM
W3012
W3612
W2415
W3015
W3315
W3615

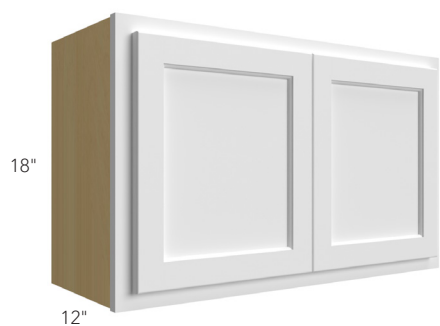

### 18" HIGH

ITEM
W2118*♦
W2418
W3018
W3318
W3618

\* One door only

♦ Discontinued items are available in limited quantities while supplies last.

## 24" High & 24" Deep Wall Cabinets

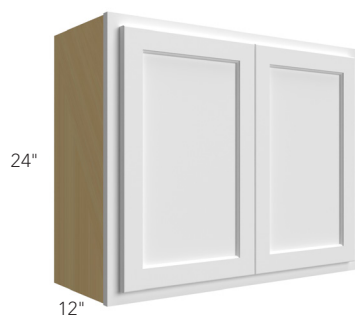

### 24" HIGH

#### ITEM

W2424

W3024

W3324

W3624

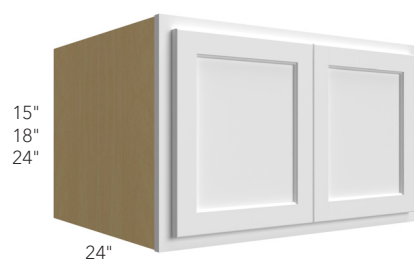

### 24" DEEP

#### ITEM

W301524

W331524

W361524

W301824

W331824

W361824

W302424\*

W332424\*

W362424\*

\* Has 1 shelf

## 30" High Wall Cabinets



### SINGLE DOOR

ITEM
W0930
W1230
W1530
W1830
W2130

- Peninsula modification available on pg. VIII

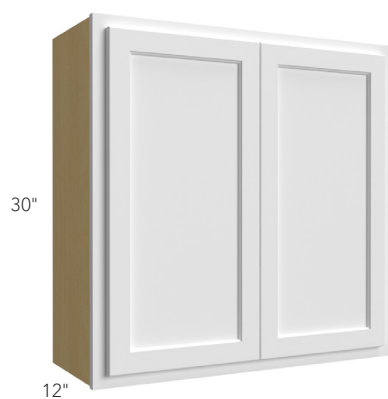

### DOUBLE DOOR

ITEM
W2430
W2730
W3030
W3330
W3630

- Peninsula modification available on pg. VIII

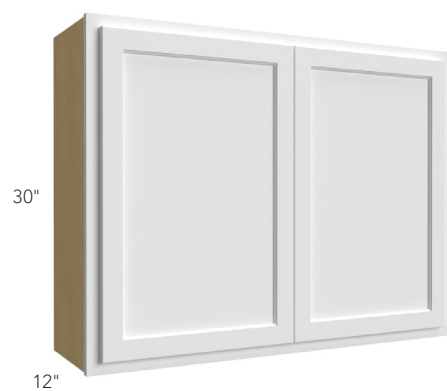

### DOUBLE DOOR

ITEM
W3930
W4230

- 1½" center stile
- Peninsula modification available on pg. VIII

## 30" High Wall Cabinets



### 60" WIDE COMBINATION

#### ITEM

W6030

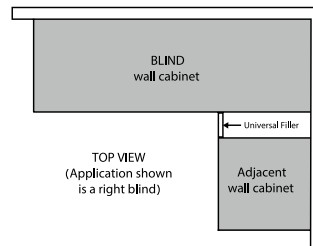

### SINGLE DOOR BLIND

#### ITEM

WBC2430

WBC3030

WBC3630

- *Must use filler on adjacent side (not supplied)*
- *Measurements are rounded off to closest 1/8"*

	Act.	Max	Door	Stile	Open (door side)
WBC2430	24"	27"	8¾"	6"	7¾"
WBC3030	30"	33"	14½"	6"	13¾"
WBC3630	36"	39"	20½"	6"	19¾"

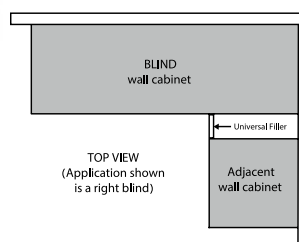

### DOUBLE DOOR BLIND

#### ITEM

WBC4230

- *Must use filler on adjacent side (not supplied)*
- *Measurements are rounded off to closest 1/8"*

	Act.	Max	Door	Stile	Open (door side)
WBC4230	42"	45"	13¾"	6"	25¾"

## 30" High Wall Cabinet & Glass Doors

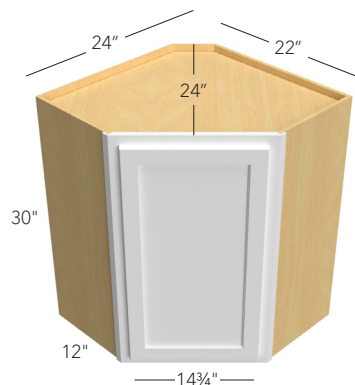

### DIAGONAL CORNER

#### ITEM

WDC2430

- For Lazy Susan see accessories on pg. 25

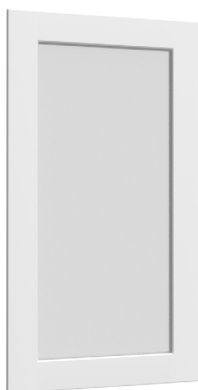
**METRO**

**DISCOVERY**

### GLASS DOOR

#### ITEM

GDD2430\*

GD3030♦

GD3630♦

- Glass doors are pre-installed with clear glass only
- \* 14 3/4" wide for WDC2430
- ♦ Cost is for a single door - need to order quantity of 2 doors per cabinet

## 36" High Wall Cabinets



### SINGLE DOOR

#### ITEM

W0936

W1236

W1536

W1836

W2136

- Peninsula modification available on pg. VIII



### DOUBLE DOOR

#### ITEM

W2436

W2736

W3036

W3336

W3636

- Peninsula modification available on pg. VIII

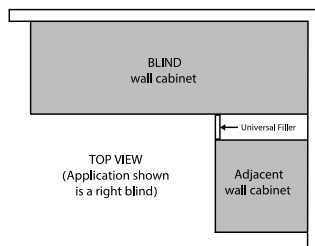

### SINGLE DOOR BLIND

#### ITEM

WBC2436

WBC3636

- Must use filler on adjacent side (not supplied)
- Measurements are rounded off to closest 1/8"

	Act.	Max	Door	Stile	Open (door side)
WBC2436	24"	27"	8 3/4"	6"	7 3/4"
WBC3636	36"	39"	20 1/2"	6"	19 3/4"

## 36" High Wall Cabinets & Glass Doors

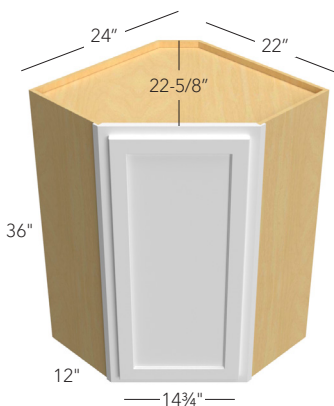

### DIAGONAL CORNER

#### ITEM

WDC2436

- For Lazy Susan see accessories on pg. 25

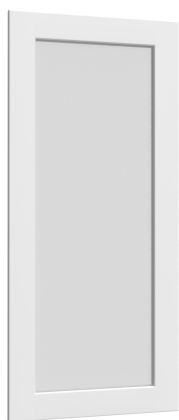
**METRO**

**DISCOVERY**

### GLASS DOOR

#### ITEM

GDD2436\*

GD3036♦

GD3636♦

- Glass doors are pre-installed with clear glass only
- \* 14 3/4" wide for WDC2436
- ♦ Cost is for a single door - need to order quantity of 2 doors per cabinet

## 42" High Wall Cabinets

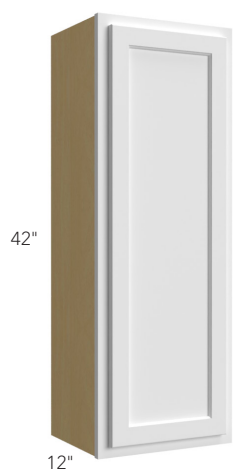

### SINGLE DOOR

#### ITEM

W0942

W1242

W1542

W1842

W2142

- Peninsula modification available on pg. VIII



### DOUBLE DOOR

#### ITEM

W2442

W2742

W3042

W3342

W3642

- Peninsula modification available on pg. VIII



### DOUBLE DOOR

#### ITEM

W3942

- 1½" center stile
- Peninsula modification available on pg. VIII



## 42" High Wall Cabinets & Glass Doors

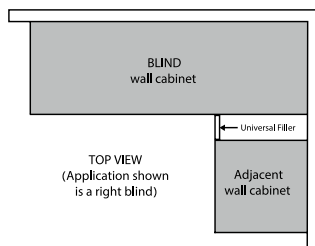
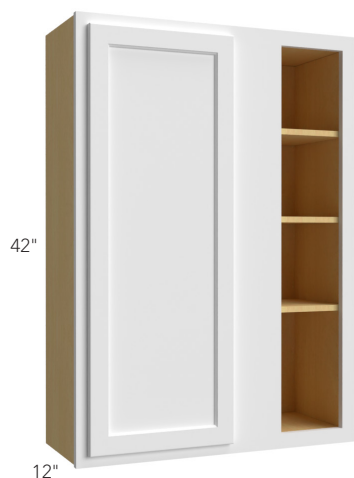

### SINGLE DOOR BLIND

#### ITEM

WBC2442

WBC3642

- Must use filler on adjacent side (not supplied)
- Measurements are rounded off to closest 1/8"

	Act.	Max	Door	Stile	Open (door side)
WBC2442	24"	27"	8 3/4"	6"	7 3/4"
WBC3642	36"	39"	20 1/2"	6"	19 3/4"

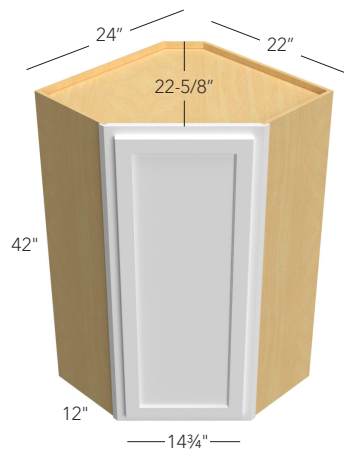

### DIAGONAL CORNER

#### ITEM

WDC2442

- For Lazy Susan see accessories on pg. 25

**METRO**

**DISCOVERY**

### GLASS DOOR

#### ITEM

GDD2442\*

GD3042♦

GD3642♦

- Glass doors are pre-installed with clear glass only
- \* 14 3/4" wide for WDC2442
- ♦ Cost is for a single door - need to order quantity of 2 doors per cabinet

## Specialty Wall Cabinets

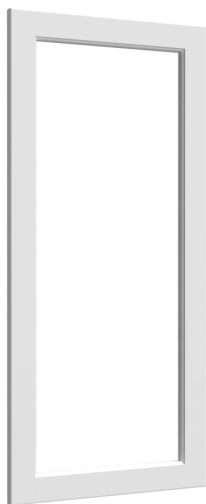

### DOOR PREPPED FOR GLASS

#### ITEM

DFG3030\*

DFG3036\*

DFG3042\*

DFG3630\*

DFG3636\*

DFG3642\*

DFGD2430

DFGD2436

DFGD2442

- Glass not included
- Comes with the center panel removed; vinyl gasket is included for easy installation of glass in the field.

\* Cost is for a single door, need to order quantity of 2 doors per cabinet

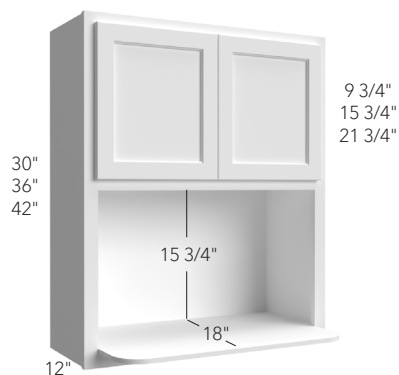

### MICROWAVE

#### ITEM

MW3030

MW3036

MW3042

- Microwave Wall cabinets have been discontinued from Quest. Items are available in limited quantities while supplies last.

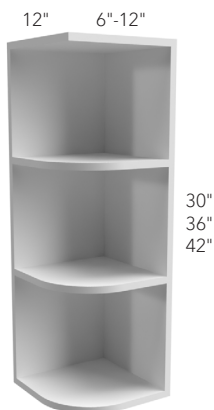

### OPEN END

#### ITEM

OE1230

OE1236

OE1242\*

- Comes as 12" (Fabuwood will cut to 6" at no charge)
- \* Has 3 shelves

## Full Height Door Base Cabinets



### FULL HEIGHT SINGLE DOOR

#### ITEM

B09FD

B12FD

B15FD

B18FD

B21FD



### FULL HEIGHT DOUBLE DOOR

#### ITEM

B24FD

B27FD

B30FD

B33FD

B36FD

B39FD

B42FD

## Base Cabinets



### SINGLE DOOR

#### ITEM

B09

B12

B15

B18

B21

- B09 accessories available on pg. 23
- Peninsula modification available on pg. VIII
- Roll Outs available on pg. 21



### DOUBLE DOOR

#### ITEM

B24

B27

B30

- Peninsula modification available on pg. VIII
- Roll Outs available on pg. 21



### DOUBLE DOOR & DRAWER

#### ITEM

B33

B36

B39\*

B42\*

- Roll Outs available on pg. 21
- \* Has 3" center stile

## Base Cabinets



### DRAWER

#### ITEM

DB12

DB15

DB18

DB24

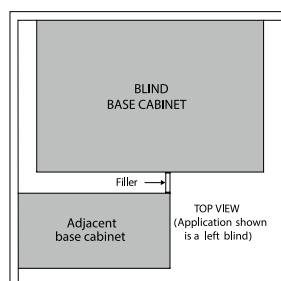

### BLIND

#### ITEM

BLB36/39

BLB42/45

BLB48/51

- *Must use filler on adjacent side (not supplied)*
- *Measurements are rounded off to closest 1/8"*

	Act.	Min.	Max	Door	Stile	Open
BLB36/39	27"	36"	41 1/4"	8 3/4"	8"	8"
BLB42/45	39"	42"	47 1/4"	14 7/8"	9"	14"
BLB48/51	48"	48"	52"	19 1/2"	7 1/4"	18 3/4"



### DIAGONAL SINK FRONT

#### ITEM

DSF36\*

DSFL36-Q♦

- *Tilt Out available on pg. 26*
- *The sink front has a 17" face dimension.*
- ♦ *DSFL36 - The floor must be ordered separately*

## Base Cabinets

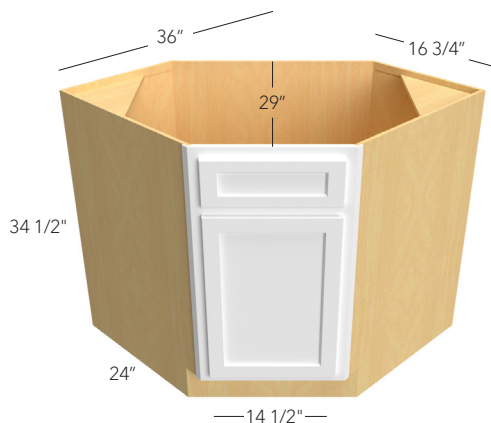

### DIAGONAL SINK

#### ITEM

DSB36

DSB36FD

- *Tilt Out available on pg. 26*

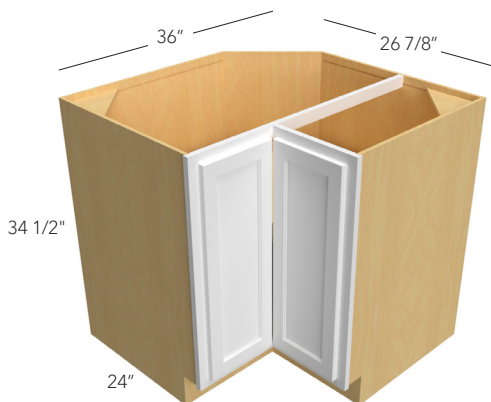

### LAZY SUSAN

#### ITEM

LSB36

- *Both wooden Lazy Susan trays rotate independently*
- *Center tray is mounted on 15mm (5/8") adjustable shelf*

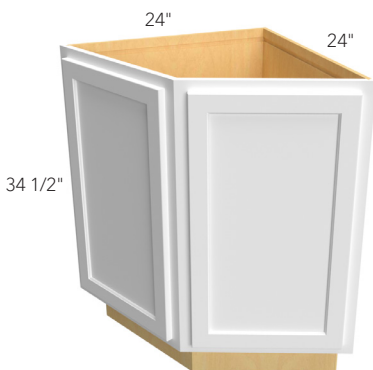

### RETURN ANGLE

#### ITEM

BRA24

- *Discontinued items are available in limited quantities while supplies last.*
- *Door width: 15 5/8"*
- *Adjustable shelving*

## Base Cabinets



### SINK

#### ITEM

SB27

SB30

- *Tilt Out available on pg. 26*



### SINK

#### ITEM

SB33

SB36

SB39\*

SB42\*

- *Tilt Out available on pg. 26*
- \* *Has 3" center stile*



### COMBINATION SINK

#### ITEM

SB60

- *Tilt Out available on pg. 26*

## Tall Pantry Cabinets



### SINGLE DOOR

#### ITEM

TP152484

TP182484

TP152490

TP182490

TP152496

TP182496

- 84" high - 5 shelves
- 90" & 96" high - 6 shelves
- Shelves are 18" deep
- Roll Outs available on pg. 21



### DOUBLE DOOR

#### ITEM

TP242484

TP242490

TP242496

- 84" high - 5 shelves
- 90" & 96" high - 6 shelves
- Shelves are 18" deep
- Roll Outs available on pg. 21



## Vanities



### FULL HEIGHT DOOR VANITY BASE

#### ITEM

VB24FD

VB30FD

VB36FD



### VANITY SINK BASE

#### ITEM

VS24-34

VS30-34



### VANITY SINK BASE

#### ITEM

VS36-34



### VANITY DRAWER BASE

#### ITEM

VDB12-34

VDB15-34

## ADA Cabinets

**Discontinuation Notice:** ADA Cabinets have been discontinued from Discovery Frost. Limited quantities available while supplies last.

\* All ADA cabinets have a 4½" toe kick

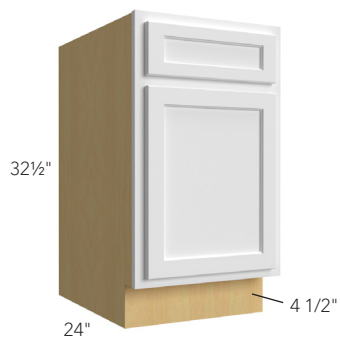

### SINGLE DOOR BASE

#### ITEM

ADA-B12

ADA-B15

ADA-B18

- Peninsula modification available on pg. VIII
- Roll Outs available on pg. 21

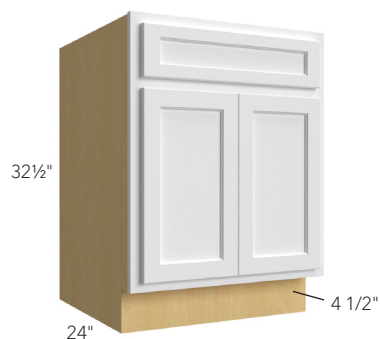

### DOUBLE DOOR BASE

#### ITEM

ADA-B24

ADA-B30

- Peninsula modification available on pg. VIII
- Roll Outs available on pg. 21



### DOUBLE DOOR & DRAWER BASE

#### ITEM

ADA-B36

- Peninsula modification available on pg. VIII
- Roll Outs available on pg. 21

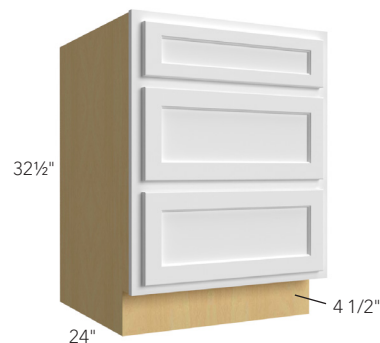

### DRAWER BASE

#### ITEM

ADA-DB15

ADA-DB24

## ADA Cabinets

\* All ADA cabinets have a 4½" toe kick

**Discontinuation Notice:** ADA Cabinets have been discontinued from Discovery Frost. Limited quantities available while supplies last.



### SINK BASE - REMOVABLE FRONT

#### ITEM

ADA-SB30-R

ADA-SB36-R

- Matching interior



### VANITY DRAWER BASE

#### ITEM

ADA-VDB15



### VANITY SINK BASE - REMOVABLE FRONT

#### ITEM

ADA-VSB30-R

ADA-VSB36-R

- Matching interior

## Waste Solutions / Accessories



### TRASH CAN

ITEM	LIST
TC15*	
TC18	
TC21	

- Cabinet not included, cabinet must be ordered separately
- Full extension slides (not soft-close)
- 35 qt. can(s) included
- Not for ADA cabinet use
- \* One garbage can and one bags bin



### TRASH CAN (W/ BLUM SLIDES)

ITEM
TC15 BLUM*
TC18 BLUM
TC21 BLUM
TCV15 BLUM♦

- Cabinet not included, cabinet must be ordered separately
- Tandem plus Blumotion full extension concealed drawer runners
- 2 - 35 qt. cans included
- Not for ADA cabinet use
- \* Single 35 qt. can + one bags bin
- ♦ Smaller depth for vanity cabinets 21" deep



### TRASH CAN FULL HEIGHT DOOR (W/ BLUM SLIDES)

ITEM
TC15FHD BLUM*
TC21FHD BLUM

- Cabinet not included, cabinet must be ordered separately
- Tandem plus Blumotion full extension concealed drawer runners
- 2 - 50 qt. can included
- Not for ADA cabinet use
- FULL-DOORS modification is required
- \* Single 50 qt. can + one bags bin

## Base / Accessories



### ROLL OUT (PARTIAL EXTENSION BLUM SLIDES)

ITEM
ROD-B15 BLUM E
ROD-B18 BLUM E
ROD-B21 BLUM E
ROD-B24 BLUM E
ROD-B27 BLUM E
ROD-B30 BLUM E
ROD-B33 BLUM E
ROD-B36 BLUM E

- Cabinet not included
  - Price is for a single Roll Out drawer
  - Blumotion partial extension concealed drawer runners
  - Drawers are adjustable
- \* Can be used for pantries

## Base / Accessories



### TWO-TIER COOKWARE ORGANIZER

#### ITEM

CWO-B18 BLUM

CWO-B24 BLUM

- Cabinet not included
- Full-extension Blum slides
- Pegboard bottoms
- 4 Press-in pegs included



### 3" TOWEL BAR PULL OUT

#### ITEM

TBPO-BF3

- Filler & Overlay Filler are required and need to be ordered separately
- 2 Towel bars
- Single static shelf with chrome wire accents
- UV coated maple wood
- Installed on site
- Installed between two cabinets
- Full-extension, ball-bearing slides with soft-close



### SPICE PULL OUT BASE 9"

#### ITEM

#### LIST

SPO-B9\*

SPO-B9 BLUM

- Cabinet not included, cabinet must be ordered separately
- FULL-DOORS modification is required
- Chrome rails
- Adjustable shelves
- UV coated maple wood
- Not for ADA cabinet use

\* Full extension ball-bearing slides (not soft-close)

## Base / Accessories



### UTENSIL PULL OUT BASE 9" (W/ BLUM SLIDES)

#### ITEM

UPO-B9 BLUM

- Cabinet not included, cabinet must be ordered separately
- FULL-DOORS modification is required
- Chrome rails
- Adjustable shelves
- UV coated maple wood
- Not for ADA cabinet use
- Features Blumotion soft-close drawer slides



### UTENSIL & KNIFE PULL OUT

#### ITEM

UKBPO-B12 BLUM

- Cabinet not included, cabinet must be ordered separately
- FULL-DOORS modification required
- Knife block features flex rod technology that adjust to securely hold knives
- Chrome rails
- Adjustable top shelf
- 2 qt. removable stainless steel bin included
- 4 flexible plastic cutting mats included
- UV coated maple wood
- Not for ADA cabinet use
- Features Blumotion soft-close drawer slides



### TRAY DIVIDER PULL OUT BASE 9" (W/ BLUM SLIDES)

#### ITEM

TDPO-B9 BLUM

- Cabinet not included, cabinet must be ordered separately
- FULL-DOORS modification is required
- UV coated maple wood
- Not for ADA cabinet use
- Features Blumotion soft-close drawer slides

## Base & Wall / Accessories



### SPICE PULL OUT BASE FILLER

#### ITEM

SPO-BF3\*

SPO-BF6\*

SPO-BF3 BLUM

SPO-BF6 BLUM

- Filler required - must be ordered separately
- 30" high Wall Filler recommended instead of Base Filler. Requires toe kick to be built separately.
- Chrome rails
- Adjustable shelves
- UV coated maple wood
- Installed on site
- Installed between two cabinets
- Not for ADA cabinet use

\* Full extension ball-bearing slides (not soft-close)

### SPICE PULL OUT WALL FILLER

#### ITEM

SPO-WF330

SPO-WF336

SPO-WF342

SPO-WF630

SPO-WF636

SPO-WF642

- Filler required - must be ordered separately
- Chrome rails
- Full extension ball-bearing slides (not soft-close - BLUM slides not available)
- Adjustable shelves
- UV coated maple wood
- Installed on-site
- Installed between two cabinets



## Wall / Accessories

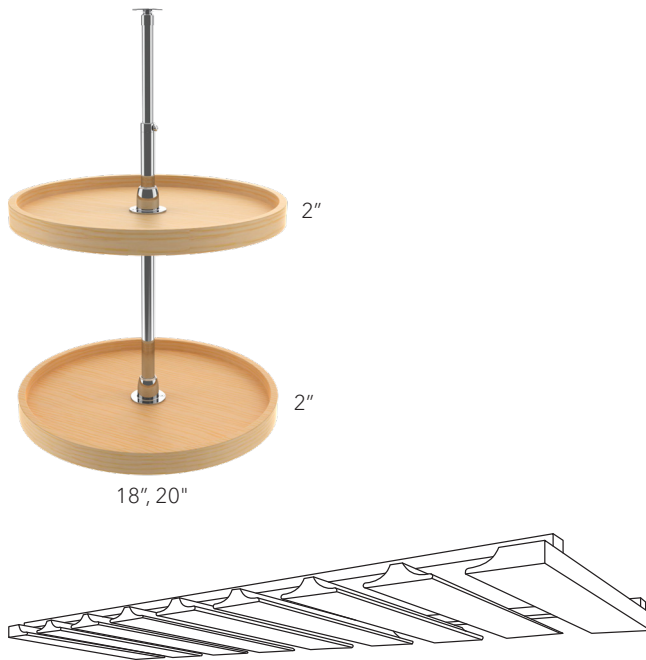

### LAZY SUSAN

#### ITEM

PLASTIC LSP24 30

LSP24 36/42

WOOD LSW24 30

LSW24 36/42

- Adjustable metal post
- 42" lazy susan has 3 trays
- 42" poles can be cut to fit 36" high cabinet
- Prepared for installation at job site

### STEMWARE RACK

#### ITEM

STEMWARE 30

STEMWARE 36

- Comes unfinished. Product finished per order. May have extended ETA.

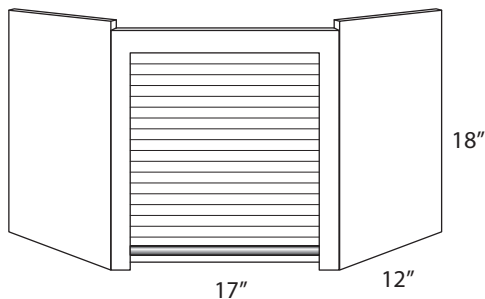

### CORNER APPLIANCE GARAGE

#### ITEM

APPLIANCE GARAGE

- Comes unfinished. Product finished per order. May have extended ETA.
- Designed to be installed under a diagonal corner wall 24".

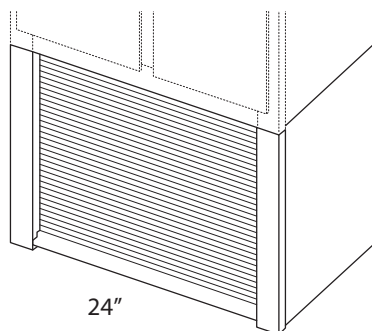

### STRAIGHT APPLIANCE GARAGE

#### ITEM

APPLIANCE GARAGE 24"

- Product finished per order. May have extended ETA.
- Designed to be placed under a 24" wide wall cabinet.
- Stiles are 2" wide

## Sink / Accessories



### TILT OUT

#### ITEM

TILTOUT 11"

TILTOUT 14"

TILTOUT 24"

- *White plastic tray*

## Drawer / Accessories



### CUTTING BOARD & KNIFE DRAWER

#### ITEM

CBKD-B18 BLUM

- For 18" cabinet drawer only
- Replaces the original drawer box of cabinet
- UV coated maple wood
- Up to 4 compartments and built-in knife organizer
- 1 wooden cutting board
- Blumotion full extension concealed drawer runners



### CHARGING DRAWER

#### ITEM

CHD-B18 BLUM

- For 18" cabinet drawer only
- Replaces the original drawer box of cabinet
- UV coated maple wood
- Blumotion full extension concealed drawer runners
- (2) 120V plugs and (2) 201 amp USB ports
- Tamper resistant outlets
- Max current: AC: 12 amps @ 120VAC; USB 2.1 amp & 5 VDC
- Power cord with NEMA 5 - 15 plug
- Integrated cord guide to ensure safe operation
- Shock absorbent mat, black
- Overall safety of this product is determined by its end use



### 2-TIER CUTLERY DRAWER

#### ITEM

DCD-15 BLUM

DCD-18 BLUM

DCD-21 BLUM

DCD-24 BLUM

DCD-30 BLUM

DCD-36 BLUM

- UV coated maple wood
- Includes complete 3¾" high drawer box
- Blumotion full-extension concealed drawer runners



### TRIMMABLE KNIFE DIVIDER

#### ITEM

DKI-18/24

- UV coated maple wood
- Total height: 2"
- ¾" plywood bottom

## Vanity / Accessories



### VANITY OUTLET GROOMING ORGANIZER

#### ITEM

VGO12FD BLUM

- Cabinet not included, cabinet must be ordered separately
- FULL-DOORS modification required
- 2 removable stainless steel bins included
- 2 shelves with non-skid vinyl lining and acrylic accents
- In-drawer receptacle with (2) 120V plugs
- Tamper-resistant outlets
- Max Current: AC: 12 amps @ 120VAC
- Power cord with NEMA 5 - 15 plug
- Integrated cord guide ensures safe operation
- Drawer stop prevents items from being stored "ON" inside the cabinet
- Its end-use determines the overall safety of this product
- UV coated maple wood
- Not for ADA cabinet use
- Blumotion full extension concealed drawer runners



### TRIMMABLE VANITY DRAWER ORGANIZER INSERT

#### ITEM

VDO

- Designed for 21" or smaller vanity base drawers
- Anti-skid vinyl lining
- Up to 13 compartments
- 2 clear acrylic lids
- UV coated maple wood



### VANITY APPLIANCE STORAGE RACK

#### ITEM

VASR-30

- Designed for 30" vanity base cabinet
- Mounts to inside of right or left door
- Non-skid lining on lower level shelf
- (2) 1.25 qt. stainless steel bins
- UV coated maple wood

## Vanity / Accessories



### VANITY ORGANIZER PULL OUT

#### ITEM

VOPO-24 BLUM

- Tandem plus Blumotion full extension drawer runners
- Designed for 24"-30" Vanity Sink Base
- Reversible
- 6 Acrylic bins included



### U-SHAPED VANITY SINK BASE PULL OUT

#### ITEM

UVTCPO-30 BLUM

- Tandem plus Blumotion full extension drawer runners
- Designed for 30" Vanity Sink Base, but works great in standard depth base cabinets as well
- Non-skid vinyl lining
- 4 adjustable dividers
- 8 qt. waste container included

*Any accessories can be ordered and installed through Fabuwood*



### TOUCH UP KIT

#### ITEM

TOUCH UP KIT

## Fillers & Valance / Accessories

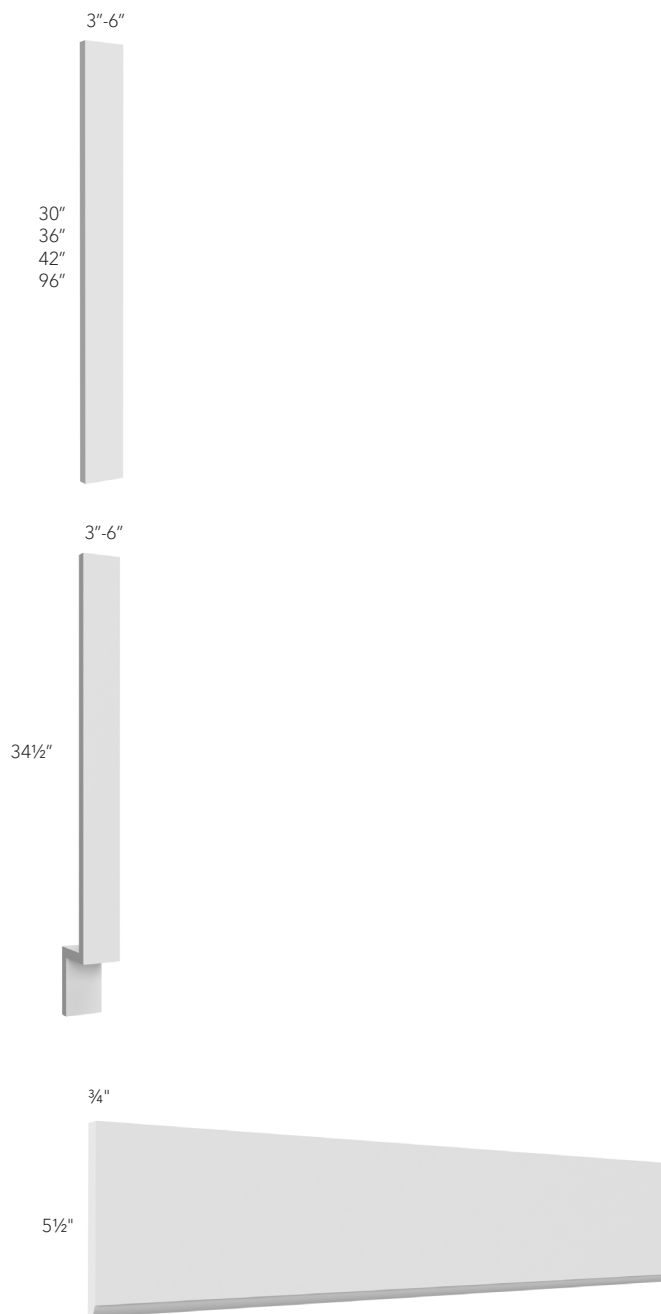

### WALL & TALL FILLER

ITEM
WF330
WF336
WF342
WF630
WF636
WF642
TF396
TF696

- 2 sides of filler are finished

### BASE FILLER

ITEM
BF3
BF6

- 2 sides of filler are finished

### STRAIGHT VALANCE

ITEM
VST96

## Moldings (8') / Accessories

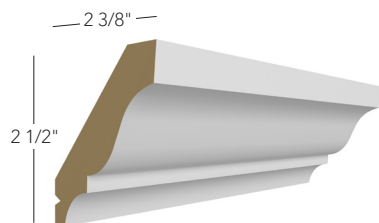

### SMALL CROWN

ITEM

CM-1

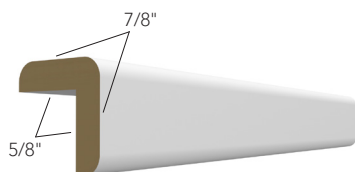

### OUTSIDE CORNER

ITEM

OCM8



### INSIDE CORNER

ITEM

ICM8

## Moldings (8') / Accessories



### QUARTER ROUND

ITEM

QRM

- Available in Discovery Frost only



### SCRIBE

ITEM

SM8



### BATTEN

ITEM

BM3/4

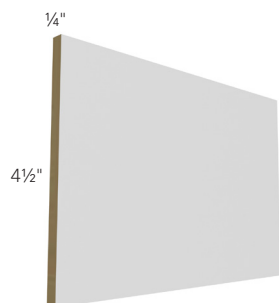

### TOE KICK

ITEM

TK8

- Matching color medium-density fiberboard toe kick



## Panels / Accessories

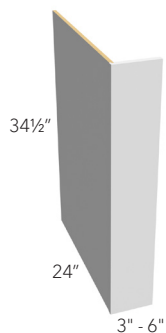

### DISHWASHER END PANEL

#### ITEM

DWR3

DWR6

- Sides are flush finished (no 1/4" reveal)

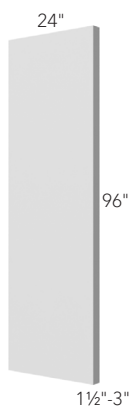

### REFRIGERATOR END PANEL WITH RETURN

#### ITEM

REP1-1/2

REP3

- Sides are flush finished (no 1/4" reveal)

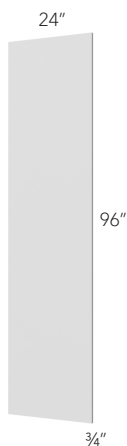

### REFRIGERATOR END PANEL

#### ITEM

REP2496

- Edge banded on both 96" sides.

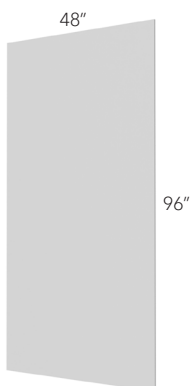

### PLYWOOD

#### ITEM

PAN-1/4\*

PLY-1/2

PLY-3/4

- \* MDF panel

Copyright © 2022 by Fabuwood Cabinetry Corp.

All rights reserved.

No part of this publication may be reproduced, distributed, or transmitted in any form or by any means, including photocopying, scanning, or other electronic or mechanical methods, including online sharing, without the prior written permission of Fabuwood Cabinetry Corp.



69 Blanchard Street | Newark, NJ 07105 | T: (201) 432-6555 | F: (201) 432-6055 | [www.fabuwood.com](http://www.fabuwood.com)

