

Custom Valances - Special Designs

Conestoga offers a wide variety of arched panel configurations and options. Valances illustrated on the following pages represent popular custom arched panel designs. The manufacturing of custom valances is based off of customer-supplied dimensioned drawings. **If any of the following illustrations below match the look you desire, please copy the appropriate page, designate the necessary dimensions and forward it to Customer Service.**

- Arched panel valances are available in most mortise and tenon and miter designs. Applied moulding designs, while commonly available, depend on the radius of the panel.
- Design options include, but are not limited to all published panel raises and framing beads, edge profiles, grooved panels, wide framing, and custom rise dimensions.
- A CAD drawing will be created prior to the manufacturing of any custom arched panel. After a review and sign off by the customer, the drawing must be returned to Special Designs in order for production to begin. Lead-time calculations will not begin until Conestoga has received an approved drawing.
- Framing widths will match door style selected unless otherwise noted by customer.
- Please provide all necessary dimensions when ordering.

Design Option A

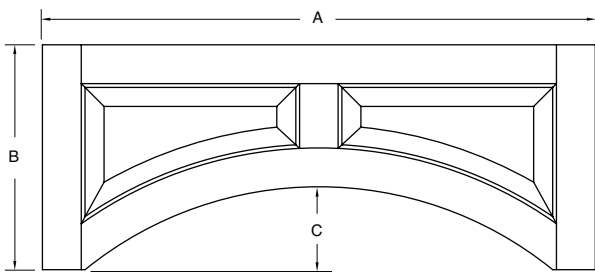

Sizes	
A	
B	
C	
Grain Direction	
Vertical	Horizontal

Design Option B

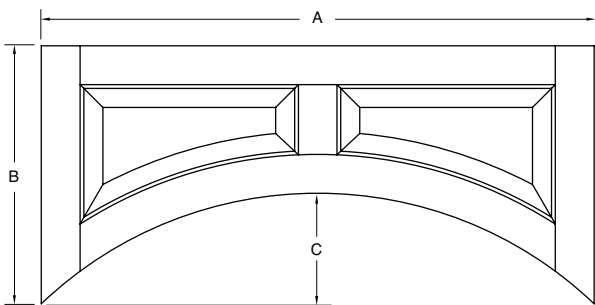

Sizes	
A	
B	
C	
Grain Direction	
Vertical	Horizontal

Design Option C

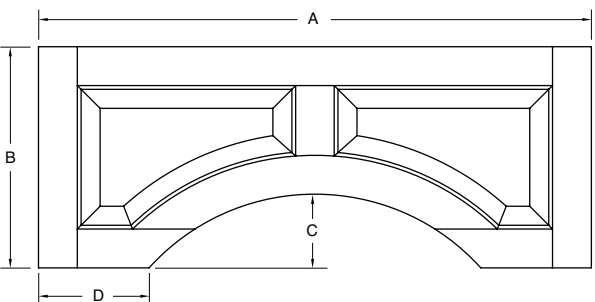

Sizes	
A	
B	
C	
D	
Grain Direction	
Vertical	Horizontal

Custom Valances - Special Designs (continued)

Design Option D

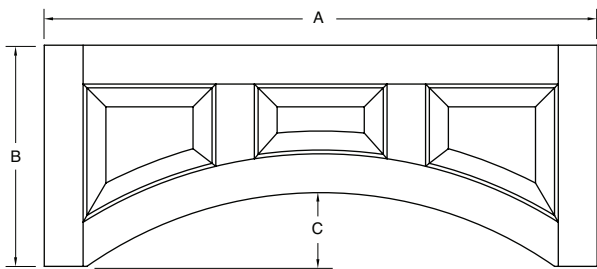

Sizes	
A	
B	
C	
Grain Direction	
<input type="checkbox"/> Vertical	<input type="checkbox"/> Horizontal

Design Option E (horizontal grain only)

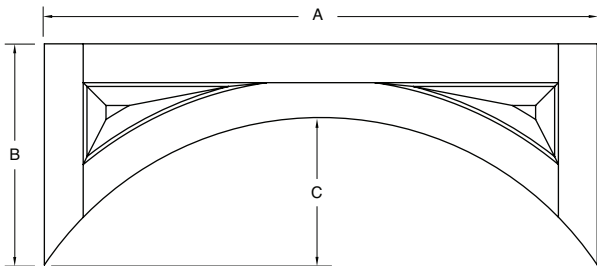

Sizes	
A	
B	
C	

Horizontal grain direction only.

Design Option F

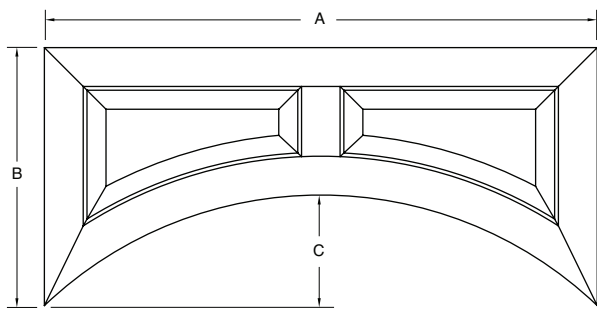

Sizes	
A	
B	
C	
Grain Direction	
<input type="checkbox"/> Vertical	<input type="checkbox"/> Horizontal

Design Option G (applied moulding)

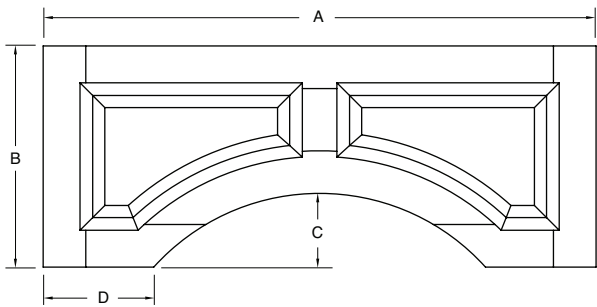

Sizes	
A	
B	
C	
D	
Grain Direction	
<input type="checkbox"/> Vertical	<input type="checkbox"/> Horizontal

Design Option H (available with or without applied moulding)

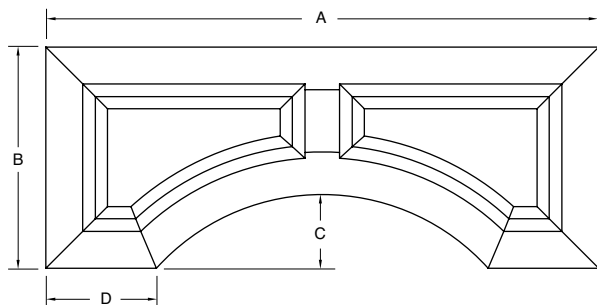

Sizes	
A	
B	
C	
D	
Grain Direction	
<input type="checkbox"/> Vertical	<input type="checkbox"/> Horizontal

Standard Arched Valances

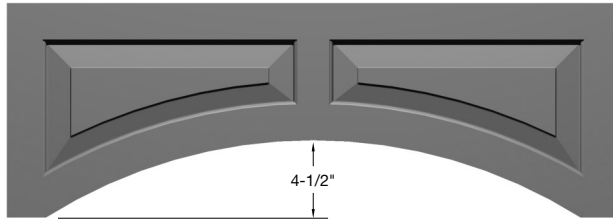

Arched Valance

Valances 30" to 48" – Design Charge

Valances 51" to 72" – Design Charge

- Standard Arched Raised Panel Valances are available in three inch wide increments from 30" to 72" only.
- Minimum size – 30" wide x 12-1/2" high. Maximum size – 72" wide x 30" high. Framing widths: 2-3/4" stiles, 2-5/16" rails, 2-1/2" upright mid-rail. The rise is always 4-1/2", regardless of valance width.
- Horizontal grain panels are standard, vertical grain is available with a \$25.00 list per valance upcharge.
- Design standard as shown. Individual designs, including applied moulding, must be ordered through Special Designs.

Offering And Availability	
Species	
Material Pricing Guide	All 3/4" and 1" species available except Rustic Knotty.
Edge Profiles	
pg 7.1	Machine Edge only.
Framing Beads	
pg 7.2	All 3/4" and 1" available.
Panel Raises	
pg 7.2	All 3/4" and 1" available.
Options	
pgs 7.3-7.15	Available with pegs, distressing, cross grain sanding, wear sanding, putty pin holes, weathered grain and cut down in width only.

Standard 1-Piece Valances

- 1-Piece Valances are available in a 6" height only.
- 1-Piece Valance pricing is determined using design plus material calculations. See the drawings below to determine appropriate Design Charge. Calculate overall square footage of valances and refer to Category B of the specie desired in the Material Pricing Guide to determine Material Charge.



Classic Arch

Valances 21" to 60" – Design Charge
Valances 60-1/16" to 96" – Design Charge

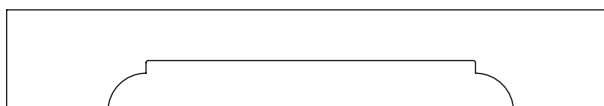

Elegant Arch

Valances 21" to 60" – Design Charge
Valances 60-1/16" to 96" – Design Charge

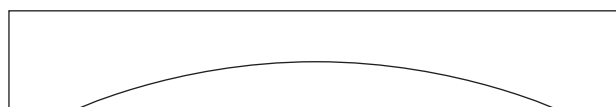

Roman Arch

Valances 12" to 60" – Design Charge
Valances 60-1/16" to 96" – Design Charge



Straight

Valances 12" to 60" – Design Charge
Valances 60-1/16" to 96" – Design Charge

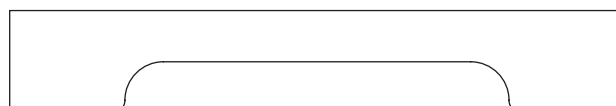

Traditional Arch

Valances 16" to 60" – Design Charge
Valances 60-1/16" to 96" – Design Charge

Edge Profile Options

- Straight valance comes standard with Machine Edge, but is available with any edge profile. Specify which edges receive an edge profile, other than Machine Edge.
- Roman Arch valance and Traditional Arch valance come standard with Machine Edge. These valances are available with edge profiles: B-2, C-2, CFP-2, E-2, H-2, J-2, L-059, L-120, L-149, L-281, L-382, L-772, L-803, L-1160, LC-2, PRS-2, RC-2 and V-2. Specify which edges receive profiles other than Machine Edge.
- Classic Arch valance and Elegant Arch valance are only available with a Machine Edge.
- See matrix on next page to determine pattern related dimensions.

Standard 1-Piece Valances (continued)

Valance Matrix Instructions

Use the matrix below to determine the specifications for patterned valances. Find the desired valance length in one of the C rows. The top number (white numbers in black) in the column with the desired length is the pattern length. The pattern will be centered on the valance.

From the C block containing the desired overall valance length, the extreme right number in that row, which is under column B is the size of the flat areas on the left and right side of the pattern.

Example: If ordering a Traditional Arch valance with an overall length of 30" (dimension C), note that:

- 30" appears in the sixth C row, fourth column of the matrix.
- Referring to the top of the column, in row A, a pattern length of 19" will be found.
- Referring back to the 30" C row, at the right end of the row, in column B, flat areas of 5-1/2" on both the left and right ends of the valance will be found.
- The selected 30" valance will have a pattern 19" wide, centered on the valance, with 5-1/2" wide flat areas at both ends of the valance.

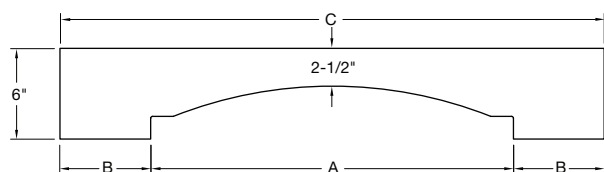

Classic Arch

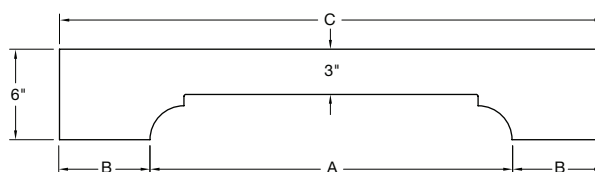

Elegant Arch

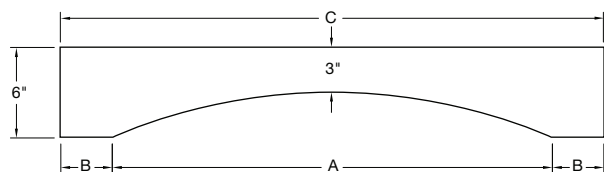

Roman Arch

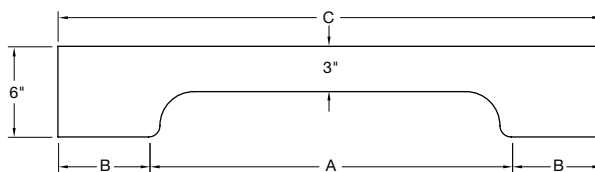

Traditional Arch

Valance Matrix											
A*	9"	11"	14"	19"	24"	30"	42"	54"	66"	78"	B
C	15"	17"									3"
C	16"	18"	21"	26"	31"	37"	49"	61"	73"	85"	3-1/2"
C		19"	22"	27"	32"	38"	50"	62"	74"	86"	4"
C		20"	23"	28"	33"	39"	51"	63"	75"	87"	4-1/2"
C			24"	29"	34"	40"	52"	64"	76"	88"	5"
C			25"	30"	35"	41"	53"	65"	77"	89"	5-1/2"
C					36"	42"	54"	66"	78"	90"	6"
C						43"	55"	67"	79"	91"	6-1/2"
C						44"	56"	68"	80"	92"	7"
C						45"	57"	69"	81"	93"	7-1/2"
C						46"	58"	70"	82"	94"	8"
C						47"	59"	71"	83"	95"	8-1/2"
C						48"	60"	72"	84"	96"	9"

*Note: Any increment 1/2" or less round down to nearest measurement in row "A". Any increment 9/16" or greater round up to nearest measurement in row "A".

Slab Fillers



Slab Filler

- Slab fillers can be ordered in widths from 1-1/2" to 48" and heights from 4-1/2" to 96". Available in all 3/4" and 1" species.
- All 3/4" and 1" edge profiles are available.
- Slab fillers are available with pegs, radius corners, grooves, back-routed hand pulls, distressing, wear sanding and weathered grain.

11

Specialty Products

1-Piece Design Upcharges				
	Height			
Width	Minimum – 39-15/16"	40" – 54-15/16"	55" – 69-15/16"	70"+
Minimum – 11-15/16"	Design Charge			
12" – 23-15/16"	Design Charge			
24"+	Design Charge			

Glass Shelves

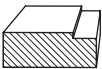

1/8" depth

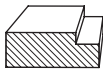

1/4" depth

Grafton

8" x 12"

2" Framing

- Used in conjunction with a frame only door or with a wire grille insert.
- Allows light to flow through the entire cabinet, accentuating fine dinnerware, glassware or other collectibles.
- All 3/4" and 1" species available.
- Maximum size – 23-15/16" deep x 36" long.
- Edge profiles – defaults to machine edge on all 4 edges. Additional edge profiles include B-2, C-2, CFP-2, H-2, J-2, L-034, L-059, L-149, L-382, L-803, L-1160, LC-2 and PRS-2.
- Two framed options accept either 1/8" or 1/4" glass (glass not included).

Fluted Fillers

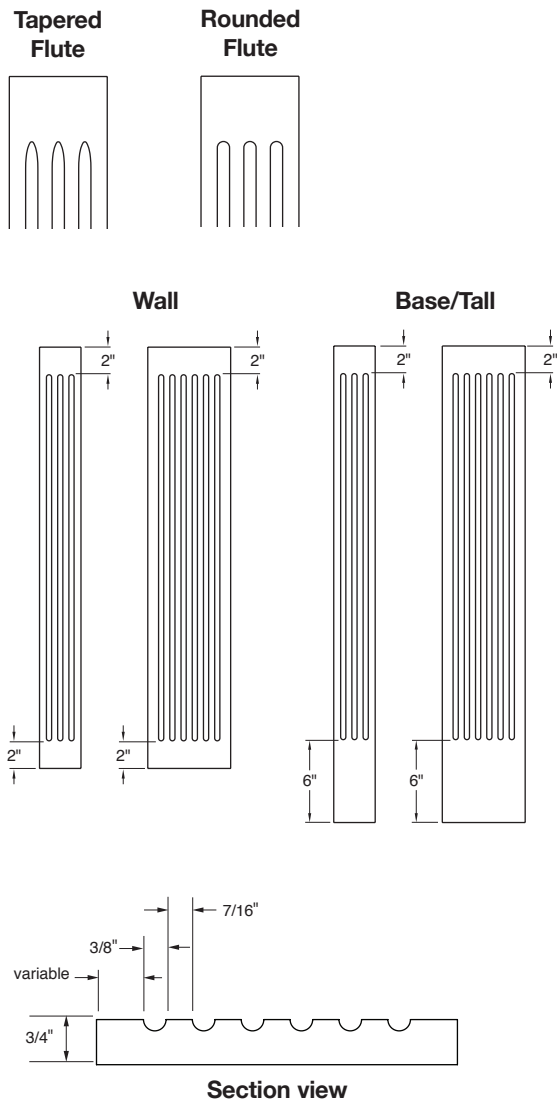

- Fluted Fillers can be ordered in custom widths from 3" to 15-15/16" and heights up to 96" in all standard 3/4" species.
- Choose from either Tapered or Rounded flutes. If not specified, flutes will be produced using the Tapered design.
- Non-fluted or "flat" areas are design specific, but can be customized to meet your design needs. Simply specify the flat dimensions desired. Specify "Flats to measure 0" to extend flutes the entire length of filler.
- Fluted Filler pricing is determined using design plus material calculations. See the chart below to determine appropriate Design Charge. Calculate overall square footage of filler and refer to category B of the specie desired in the Material Pricing Guide to determine Material Charge.
- The number of flutes per filler width is indicated in the chart below. Custom flute spacing is available through Special Designs.

Fluted Filler Pricing			
Filler Width	# Flutes	Under 60" in length	60" or greater in length
3" to 3-15/16"	3		
4" to 4-15/16"	4		
5" to 5-15/16"	5		
6" to 6-15/16"	6		
7" to 7-15/16"	7		
8" to 8-15/16"	9		
9" to 9-15/16"	10		
10" to 10-15/16"	11		
11" to 11-15/16"	12		
12" to 12-15/16"	14		
13" to 13-15/16"	15		
14" to 14-15/16"	16		
15" to 15-15/16"	17		

Edge Profile Options

- Fluted Fillers come standard with a Machine Edge, but can be ordered with a variety of edge profiles including B-2, C-2, LC-2, L-034, L-059, L-149, L-253, L-382, L-686, L-1160, PRS-2, RC-2 and V-2.
- Beveled edge profile selections include the L-991 (45 degree back bevel) and the L-423 (22-1/2 degree back bevel).
- Premium edge profiles include the L-297, L-304 and LC-Inset edge. Upcharge applies.

Wood Floating Shelves

The Floating Shelf is a functional way to add style to the interior décor of kitchens, bathrooms and other living areas throughout a home. These shelves have a support frame that must be mounted securely to the studs in the wall, then the exterior portion of the shelf slides over the support frame to completely conceal the sub-structure. The result is an attractive, fashionable shelf to display pictures, dishware and other interior design accents.

Wood Floating Shelf, Beaded Floating Shelf and Crown Floating Shelf

- Available species include Cherry, Hard Maple, Paint Grade Hard Maple, Quarter Sawn White Oak, Red Oak and Walnut.
- The front and sides of the shelves are made from 3/4" solid hardwoods, mitered at the two front corners.
- The Beaded Floating Shelf includes a decorative bead on both the top and bottom of the front and side returns.
- The Crown Floating Shelf includes a modified crown moulding on the front and side returns.
- The shelf top and bottom is 3/8" thick plywood, matching the specie of the hardwood.
- Once the Floating Shelf is fully installed, it is recommended that the shelf be secured to the support frame using headless pins or small finishing nails so the shelf cannot inadvertently slide off of the support frame.
- Custom lengths available.

Support Frame

- Manufactured using 3/4" thick unselected hardwoods.
- It is imperative that Floating Shelves be mounted to two or more wall studs using four or more coarse thread screws at least 2-1/2" in length. The 60" Floating Shelf should be mounted to three or more studs.
- Maximum load capacity for the shelf and support frame is 10 lbs. per linear foot. While Floating Shelves are built from strong, sturdy materials, the load capacity of these shelves is dependent on upon the quality of the installation screws and whether the shelves are secured into the wall studs. If not secured into two or more studs using two or more high quality installation screws per stud, the shelf may not support the desired weight. Conestoga will not be responsible for shelf failure due to inadequate installation techniques or materials.
- All models of Wood Floating Shelves are available with primers, stains, Colourtones, Prism Paints and glazes.
- Finish pricing: Design Charge multiplier – 1.5x
Material Charge – actual sq. footage x 1.25

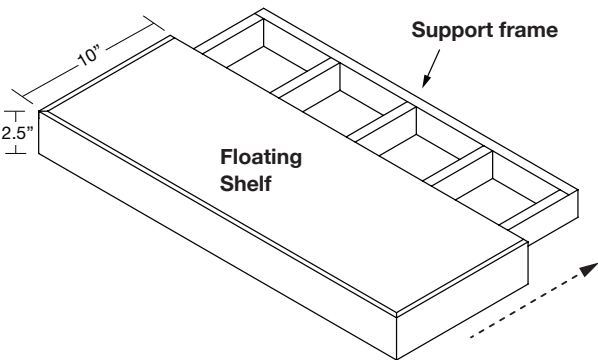

Floating Shelf (Includes Design & Material Charge)					
Specie	24" or 30"	36"	42"	48"	60"
Cherry					
Hard Maple					
PG Hard Maple					
QS White Oak					
Red Oak					
Walnut					

Wood Floating Shelves (continued)

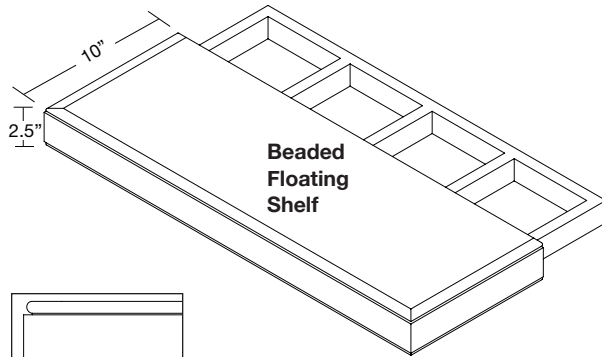

Beaded Floating Shelf - Side View

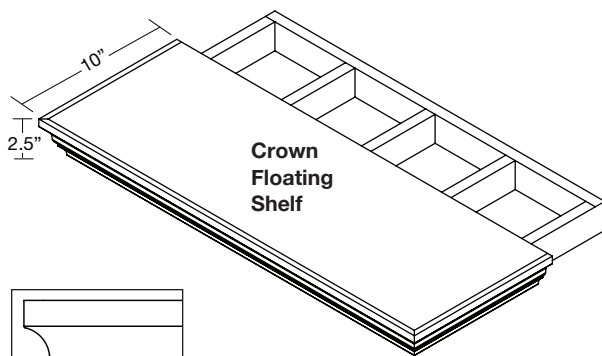

Crown Floating Shelf - Side View

Beaded Floating Shelf (Includes Design & Material Charge)					
Specie	24" or 30"	36"	42"	48"	60"
Cherry					
Hard Maple					
PG Hard Maple					
QS White Oak					
Red Oak					
Walnut					

Crown Floating Shelf (Includes Design & Material Charge)					
Specie	24" or 30"	36"	42"	48"	60"
Cherry					
Hard Maple					
PG Hard Maple					
QS White Oak					
Red Oak					
Walnut					

Alternative Material Floating Shelves

Stainless Floating Shelves

- ♦ A perfect complement of today's industrial, transitional and modern kitchens.
- ♦ Can be mounted between cabinets, at the end of a cabinet run, or free standing in any room of the home.

Support Frame

- ♦ The support frame consists of a wood mounting plate with protruding metal supports. The support frame must be secured to at least two wall studs using 3" coarse thread screws. The stainless shelf slides over the support frame, completely concealing it to provide the classic floating shelf appearance. Mounting instructions and installation screws are included.
- ♦ Maximum load capacity is 10 pounds per linear foot. While Floating Shelves are built from strong, sturdy materials, the load capacity of these shelves is dependent upon the quality of the installation screws and if the support frame is secured to the wall studs. If not secured into two or more studs using two 3" screws per stud, the shelf may not support the desired weight. Conestoga will not be responsible of shelf failure due to inadequate installation techniques or materials.



Stainless Steel Floating Shelf (Includes Design & Material Charge)				
Part Number	Length	Depth	Height	List Price
2200232A	24"	10"	2.5"	
2200233A	30"	10"	2.5"	
2200234A	36"	10"	2.5"	

Alternative Material Floating Shelves (continued)

Super Matte Floating Shelves

- ◆ Available in all Super Matte colors – see pricing chart below.
- ◆ The front and sides of the shelf are made from 3/4" edgebanded material, mitered at the two front corners.
- ◆ The shelf top and bottom is 6mm thick Super Matte material.
- ◆ Once the Floating Shelf is fully installed, it is recommended that the shelf be secured to the support frame using headless pins or small finishing nails so the shelf cannot inadvertently slide off of the support frame.
- ◆ Custom lengths available - pricing rounded to next largest published size plus an additional charge.

Support Frame

- ◆ Manufactured using 3/4" thick unselected hardwoods.
- ◆ It is imperative that Floating Shelves be mounted to two or more wall studs using four or more coarse thread screws at least 2-1/2" in length. The 60" Floating Shelf should be mounted to three or more studs.
- Maximum load capacity for the shelf and support frame is 10 pounds per linear foot. While Super Matte Floating Shelves are built from strong, sturdy materials, the load capacity of these shelves is dependent upon the quality of the installation screws and whether the shelves are secured into the wall studs. If not secured to two or more studs using two or more high quality installation screws per stud, the shelf may not support the desired weight. Conestoga will not be responsible for shelf failure due to inadequate installation techniques or materials.

Super Matte Floating Shelf						
Colors	24"	30"	36"	42"	48"	60"
Anthracite Matte, Black Matte, Light Grey Matte, White Matte						

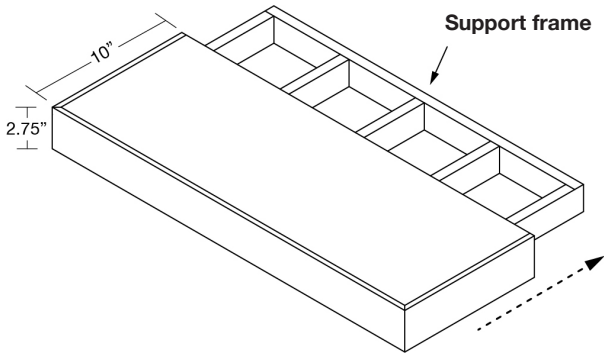

Alternative Material Floating Shelves (continued)

Thermally Textured Surface Floating Shelves

- ◆ Available in most Intrigue, Strata and Vogue TTS materials - see available colors in the pricing charts below.
- ◆ The front and sides of the shelf are made from 3/4" banded TTS material, mitered at the two front corners.
- ◆ The shelf top and bottom is 8mm thick TTS material.
- ◆ Once the Floating Shelf is fully installed, it is recommended that the shelf be secured to the support frame using headless pins or small finishing nails so the shelf cannot inadvertently slide off of the support frame.
- ◆ Custom lengths available - pricing rounded to next largest published size plus an additional charge.

Support Frame

- ◆ Manufactured using 3/4" thick unselected hardwoods.
- ◆ It is imperative that Floating Shelves be mounted to two or more wall studs using four or more coarse thread screws at least 2-1/2" in length. The 60" Floating Shelf should be mounted to three or more studs.
- ◆ Maximum load capacity for the shelf and support frame is 10 pounds per linear foot. While TTS Floating Shelves are built from strong, sturdy materials, the load capacity of these shelves is dependent on upon the quality of the installation screws and whether the shelves are secured into the wall studs. If not secured to two or more studs using two or more high quality installation screws per stud, the shelf may not support the desired weight. Conestoga will not be responsible for shelf failure due to inadequate installation techniques or materials.

Strata Floating Shelf						
Tier 1	24"	30"	36"	42"	48"	60"
Ash Brown (LM98), Aspen Oak (LM67), Barn Oak (LN27), Bianco (BO11), Carbone (LM08), City Oak (LM69), French Roast (LK10), Graphite (LG18), Oregon Pine (LK84), Palissandro (LK55), Stratos (LM37), Swiss Almond (LM96), Vineyard Oak (LN30)						
Tier 3	24"	30"	36"	42"	48"	60"
Burned (SO12), Cypress Point (SO13), Dublin (S135), French Grey (SO27), Light Carbon (S015), Madrid (S133), Nero (U129), Silver Sand (SO11)						

Vogue Floating Shelf						
Colors	24"	30"	36"	42"	48"	60"
Fresno Glacial (16N), Roble Aurora (98V), Roble Azabache (75V), Roble Colorado (97V)						

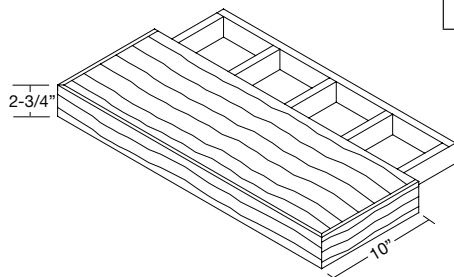

Intrigue Floating Shelf						
Colors	24"	30"	36"	42"	48"	60"
Castle Grey (U732), Inkwell (U999), Khaki (U702), Naval Grey (U960), Whisper (W1100)						

Alternative Material Floating Shelves (continued)

Decorative Laminate Veneer Floating Shelves

- ◆ Available in all Allure colors, except Bright White with glaze and White Dove with glaze - see pricing chart below.
- ◆ The front and sides of the shelf are made from 3/4" banded DLV material, mitered at the two front corners.
 - ◆ Bright White and White Dove shelves are manufactured using 19mm DLV board; Canadian Grey, Monaco, Hazelnut Elm, Silva, Silver Elm, Skye and White Chocolate shelves are manufactured using DLV center panel material sandwiched to 1/2" MDF, then edgebanded. Interior of sandwiched material is raw MDF.
- ◆ The shelf top and bottom utilizes DLV center panel material.
- ◆ Once the Floating Shelf is fully installed, it is recommended that the shelf be secured to the support frame using headless pins or small finishing nails so the shelf cannot inadvertently slide off of the support frame.
- ◆ Custom lengths available - pricing rounded to next largest published size plus an additional charge.

Support Frame

- ◆ Manufactured using 3/4" thick unselected hardwoods.
- ◆ It is imperative that Floating Shelves be mounted to two or more wall studs using four or more coarse thread screws at least 2-1/2" in length. The 60" Floating Shelf should be mounted to three or more studs.
- ◆ Maximum load capacity for the shelf and support frame is 10 pounds per linear foot. While DLV Floating Shelves are built from strong, sturdy materials, the load capacity of these shelves is dependent on upon the quality of the installation screws and whether the shelves are secured into the wall studs. If not secured to two or more studs using two or more high quality installation screws per stud, the shelf may not support the desired weight. Conestoga will not be responsible for shelf failure due to inadequate installation techniques or materials.

Allure DLV Floating Shelf						
Colors	24"	30"	36"	42"	48"	60"
Bright White						
White Dove						
Canadian Grey						
Hazelnut Elm						
Monaco						
White Chocolate						
Silva						
Silver Elm						
Skye						

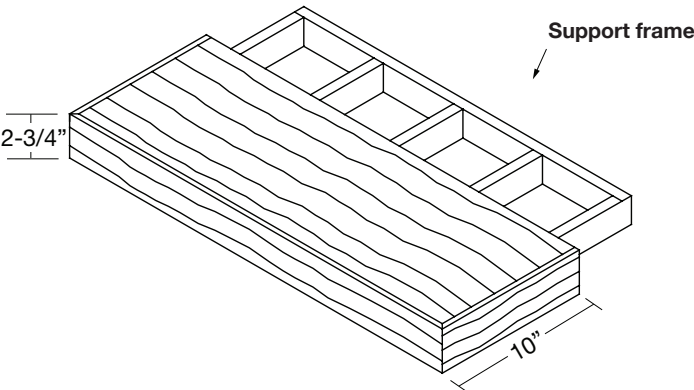

Stemware Holders

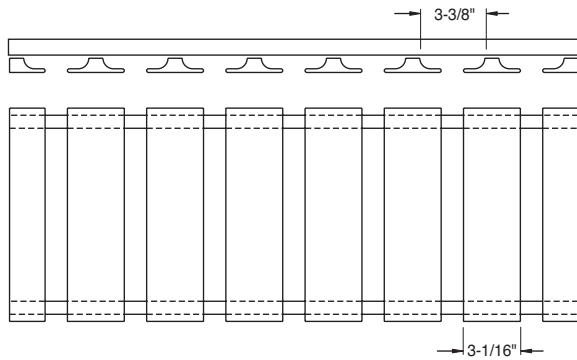

- 30" (7 slots) or 36" (8 slots) lengths.
- Spacing between slats:
30" stemware holder – 1-1/8".
36" stemware holder – 1-3/8".
- Depth 11-1/4".
- Thickness 1-1/2".
- Accommodates most stemware styles.
- Available unfinished or finished. See the Finishing Program Section for pricing.

Specie	Unfinished Price	
	30"	36"
Cherry		
Hard Maple		
Red Oak		

Custom Cutting Boards

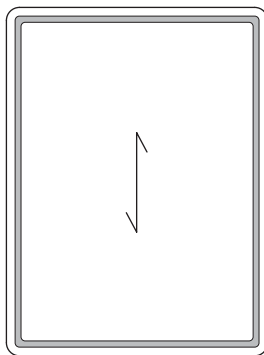

1-Piece Slab

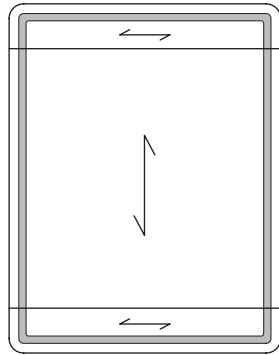

3-Piece Slab

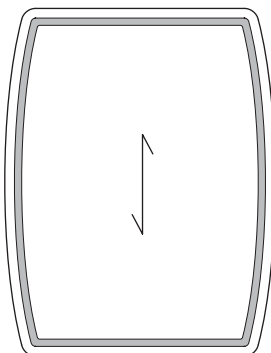

1-Piece Barrel

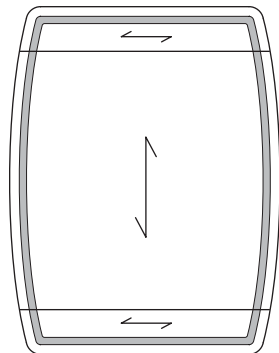

3-Piece Barrel



Hand Pull - 1/4" deep,
3-1/2" long, 1/2" wide

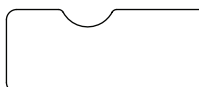

Drip Groove - 5/32" deep

- Cutting boards are available in all published species except Rustic Knotty.
- All cutting boards utilize Category B Material Charge.
- Cutting boards available in 3/4" and 1" thickness.
- Minimum size for all styles is 10" x 10", maximum size is 18" x 22".
- All designs include 3/4" radius corners and 3/32" radius edges.
- 3-Piece designs are made using 2-5/16" wide rails on face (horizontal grain) with pinless construction.
- All cutting boards have a routed drip groove into the face of the board to collect liquids.
- No oils or finishing treatments will be applied by Conestoga.
- Care instructions for wood cutting boards:
 - Treat wood with butcher block oil or mineral oil only.
 - To clean, wipe with a mixture of warm water and a mild dish detergent. Never submerge cutting boards in water or place in dishwasher.
- Hand pull option on back of cutting board is available: Priced per pull.
- Due to repetitive exposure to liquids, cutting boards will not be warranted against bowing, warping, splitting or twisting.

Front Frame Specifications

- Double dowel construction on standard width framing.
- Material will be Standard grade unless otherwise noted. Premium grade available, upcharges apply.
- Standard framing width is 1-1/2"; additional widths available, upcharges apply.
- 3/4" framing thickness standard; 1" thick material is available, upcharges apply.
- Minimum framing width 3/4"; 15/16" for front frames with an edge profile.
- Material surfaced on four sides.
- Assembled frames sanded on front only with 220 grit sandpaper.
- Maximum front frame sizes are 120" in one direction and 48" in the other direction. For example, a front frame can be ordered 48" x 120" or 120" x 48" but not 120" x 120".
- Framing wider than 4-1/2" may have one glue joint. Framing wider than 6-1/2" may have two glue joints.
- Minimum glue-in trimmable insert width is 1/2"; maximum glue-in trimmable insert width is 3".

Front Frame Tolerances

- A tolerance of +/- 1/32" is considered acceptable on front frame exterior and interior opening dimensions.
- A tolerance of +/- 1/16" out of square is considered acceptable on all front frames.
- 1/32" offset on frame back at any joint is considered acceptable.
- 1/64" offset at any exterior joint on the outside perimeter is considered acceptable.

Front Frame Ordering Information

- Conestoga's custom front frames can be ordered as beaded, non-beaded or profiled. To specify, check the appropriate box in the beaded area of the order form.

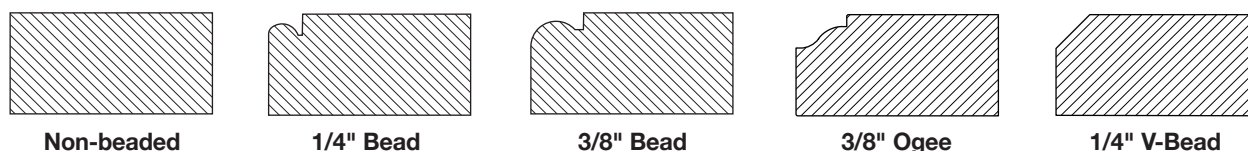

- Front frame exterior dimensions, interior opening dimensions and framing widths can be ordered to the nearest 1/16".
- On beaded orders, customers may select specific openings to be "non-beaded" by specifying the opening letter designation. Example: "Do not bead opening S."
- When ordering custom front frames for Conestoga Cabinet Systems, all framing and opening sizes must be specified by the customer. Only standard groove locations available.
- Front Frame Configuration Template Packet can be found on the Customer Business Portal. Contact Customer Service for sign on information or, request the Front Frame Configuration Template Packet from your Customer Service representative.

Front Frame Pricing

Pricing Instructions

- Front frame pricing is based on the number of openings and the external frame perimeter.
- Use frame perimeter (linear inches) x specie price per linear inch. Use the appropriate column to determine the material price based on specie and the number of openings.
- Add the appropriate cost per opening charges from the chart below.

Cost per Opening	
First opening	
Additional openings, each	

Material Charge per Opening				
Specie	1 or 2	3 or 4	5 or 6	7 or 8
Alder				
Bamboo				
Birch, Red				
Birch, White*				
Cherry*				
Hickory*				
Maple, Hard*				
Paint Grade Hard Maple				
Maple, Soft				
Oak, Red*				
Oak, White*				
Pine, Knotty				
Walnut*				

*Indicates premium specie availability – upcharges apply.

Options Pricing	
Option	Additional Cost
Premium grade material (subject to availability)	35% of material price
1" thick framing (Bamboo not available)	30% of material price
Face and back sand	Priced per frame
Beaded inset framing (1/4" or 3/8" bead)	Priced per opening
Ogee or V-Bead framing	Priced per opening
Pre-fit inset door or drawer front	Priced per door or drawer front
Groove to fit Conestoga Cabinet Systems	Priced per frame
Edge profile around outside perimeter	Priced per frame
Glue-in trimmable inserts	Priced per opening
Cut Backs	Priced per opening
Roman shaped rails - non-beaded	Priced per rail
Beaded shaped rails available through Special Designs	Call for quote
Oversize front frame assembly Tier 1: 58" to 99-15/16" in width and height	Priced per frame
Oversize front frame assembly Tier 2: 100"+ in width or height	Priced per frame
Oversize front frame sanding (frames exceeding 48" in width or height)	Priced per frame
Unassembled front frames	No upcharge

Pricing Methodology for Finishing Custom Front Frames

Front frame Material Charges are calculated using the perimeter of the front frame multiplied by 4, and then divide the result by 144. Multiply the result by the applicable Material Charge. Add the appropriate number of Design Charges based on the number of front frame openings.

Example: 2 opening front frame 30" x 36" in Harvest Gold

Pricing for all parts will be based on design + material methodology using material charges from Conestoga's finishing program (see Finishing Program Section for Material and Design Charges).

Custom Front Frame Finishing	
Number of openings	Design Charge Multiplier
1	1
2 to 3	1.5
4 to 5	2
6 to 7	2.5
8+	3

Front Frame Pricing (continued)

Non-Standard Framing Widths	
Material Width	Upcharge per stile or rail
3/4" to 1-7/16"	
1-1/2"	no upcharge
1-9/16" to 5-15/16"	
6" to 7-7/16"	
7-1/2" and wider	





Non-standard frame configurations will be processed through Special Designs.

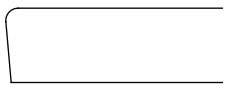

Front Frames Lead-Times			
Product	Standard Lead-Time	Expedite max. 6 frames	
		Code Red	Code Blue
Custom front frames	10	2	5
Options - additional working days			
Shaped rail	3	3	3
Pre-fit inset doors	2	2	2

Orders containing products with different lead-times are given the longest lead-time date.

Inset Door and Drawer Front Information

- The following edge profile options are recommended for use with inset doors and drawer fronts.
- These edges have a 5 degree back bevel edge to ensure sufficient door clearance. Machine Edge and L-149 are available upon request at no additional upcharge.
- Front frames ordered with inset doors and drawer fronts will be pre-fit to the opening size. A 3/32" margin will be used on all sides for single doors and drawer fronts and between butt door pairs.

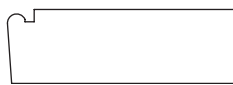
Standard Edge Profile Options	
	
L-253	L-686
	
L-947	L-967
	
L-1117	L-1120

Premium Prefit/Inset Edge Profiles
Additional charge per door or drawer front. (These 2 profiles require 2 additional working days.)

L-304

L-996

Design Exceptions

- The following door and drawer front styles are not available for inset applications due to their unique design characteristics: Alexandria, Aspen, Astoria, Boulder, CRP-1420, CRP-10191, CRP-10318, CRP-10334, CRP-10827, CRP-10875, CRP-10946, Fairhaven, Fargo, Flush Batten, LaSalle, Omaha, Prestige, Rothsford, Savoy, Topeka, Wellston and TW-10827.
- Openings with trimmable inserts are not available beaded.
- L-253 and L-686 – only edge profiles available in MDF pre-fit products.
- Finished front frames are not available with antiquing or wear sanding.
- Distressed front frames will receive a modified distressing package.

Inset Door and Drawer Front Information (continued)

- Custom front frames that are ordered with Colourtones and glazes will receive the same hand glazed finishes as doors. Cabinet Systems parts that are ordered with Colourtones and glazes will be finished with the special Colourtones that have been tinted to match the Colourtones and glaze combination. They will not receive a hand rubbed glaze. Some options, such as Heirloom and Brushed glazes that are available on Custom front frames are not available on Cabinet Systems carcass.

Inset Option with Miter Designs Not Recommended

Only miter door designs with edge profile options are available with the inset option; however, miter designs are not recommended with the inset option. The following issues are associated with inset miter designs, and will not be considered defective:

- ♦ **Miter joint lines may not intersect door corner after pre-fit sanding.** This is not considered a defect as it is a necessary part of the pre-fit process to ensure the proper fit within the frame openings. This condition may not be pleasing to some customers.
- ♦ **Panel expansion caused by high humidity may cause miter doors to bind inside frame openings.** Although Conestoga's miter door joint construction is one of the most durable in the industry, high humidity will cause solid wood center panels to expand in width. This pressure can result in framing pushing outward and creating a "barrel" effect where the framing rubs against the front frame.
- ♦ If a miter design is selected, it is highly recommended that door and drawer fronts be manufactured as 5-piece MDF, with MDF center panels or with plywood center panels. These materials will reduce the likelihood of product expansion and binding of inset doors within the front frame. While reducing the possibility of binding, expansion of solid wood framing can still occur and will not be considered defective.

1/8", 1/4" and 3/4" Plywood Program

- 1/8" thick sheet stock with Grade A face veneer applied over veneer core with sound back.
- 1/4" thick sheet stock with Grade A face and #1 back veneers applied over MDF core.
- 3/4" thick sheet stock with Grade A face veneer applied over veneer core with prefinished Natural Birch back, except where otherwise noted.
- 3/4" thick full sheets or cut-to-size panels over 96-1/16" up to 120" in length of Hard Maple/Hard Maple will have an MDF core.
- All 1/8", 1/4" and 3/4" sheet stock is available in full 4' x 8' sheets, with the exception of Hard Maple/Hard Maple which is also available in 4' x 10' sheets. All sheet stock including 4' x 10' material is also available as cut-to-size panels.
- Plywood finished in Colourtones may have pin marks and small scratches from drying racks, veneer checks, seam separation, glaze smudges, fingerprints, overspray and some dirt in topcoat. Such defects will be kept to a minimum, but are unavoidable when finishing large parts and will not be considered defective. 3/4" thick edges will not be finished unless edgeband has been applied.
- Lead-time 5 days cut-to-size, unfinished; 3 days for full sheets. Add 5-6 days for finishing.
- Additional sheet stock is available through Special Designs in common species, grades and thickness in single sheet minimums. Specify thickness, core type, specie (face and back), veneer grade (face and back) and veneer cut (face and back). Lead-times and pricing are subject to availability.
- Oversized packaging charge per item applies for large cut-to-size pieces or full 4' x 8' sheets of 1/8", 1/4" or 3/4" material. Oversize packaging parameters and conditions apply when the size exceeds 36" wide and 36" long, the size exceeds 48" wide or 84" long, or when a customer requests oversize packaging.

1/8", 1/4" and 3/4" Plywood Program (continued)

Pricing Instructions

- Multiply actual square footage of panel by the appropriate specie Material Charge.
- Add a Design Charge and applicable options.

Options

- When ordering cut-to-size plywood, specify width, height and grain direction.
- Edgeband charges (3/4" plywood only):
 - ♦ .5mm edgeband 1 to 4 edges: Cost per panel
 - ♦ 2mm edgeband 1 to 4 edges: Cost per panel.
 - ♦ For edgeband on specific edges of cut-to-size plywood, specify edges as follows: top, bottom, left, right or all edges.
- Grooving available (1/4" material only):
 - ♦ G-012, G-015 or G-056 groove profiles.
 - ♦ Spacing available in increments starting at 1/2" up to 4".
- Panel Grooving charges (per panel):
 - ♦ Up to 24" wide and 48" or under in length:
 - ♦ Up to 24" wide and over 48" in length:
 - ♦ Over 24" wide and 48" or under in length:
 - ♦ Over 24" wide and over 48" in length:
- Cut-to-size or full sheets of plywood also available finished; see Finishing Program Section for finish options and pricing.
- Colourtone finishes are available on Cherry, Hard Maple, Red Oak and White Birch plywood only.

1/8" Plywood Panel Program

Specie	Material Charge	Design Charge
Cherry		
Maple, Hard		

1/4" Plywood Panel Program

Specie	Material Charge	Design Charge
Alder		
Birch, Red		
Birch, White		
Bamboo, Caramelized		
Cherry		
Maple, Hard		
MDF (Raw)		
Hickory		
Knotty Pine		
Quarter Sawn White Oak		
Red Oak		
White Oak		
Walnut		

3/4" Plywood Panel Program

Specie (Face/Back)	Material Charge	Design Charge
Alder/Natural Birch (UV Finish)		
Bamboo, Caramelized/Bamboo (Composite core)		
Cherry/Cherry		
Cherry/Natural Birch (UV Finish)		
Hard Maple/Hard Maple		
Hard Maple/Hard Maple 120" (Composite core)		
Hard Maple/Natural Birch (UV Finish)		
MDF (Raw)		
Red Oak/Red Oak*		
Red Oak/Natural Birch* (UV Finish)		
Rift Cut White Oak/Rift Cut White Oak (Composite core)		
Walnut/Walnut (Composite core)		

*Available with .5mm edgebanding only.

1/4" Short Grain Plywood Program

- 96" x 48" panel for island back or wall panel applications.
- Grain runs vertically in the 48" direction.
- 1/4" thick material with Grade A face veneers applied over MDF core with sound back.
- Available unfinished or finished; see Finishing Program Section for finish options and pricing.
- Lead-time 3 days unfinished, add 5-6 days for finishing.
- Oversize packaging fee applies.

1/4" x 96" x 48" Plywood Short Grain Panel		
Part #	Specie	Price
1600121A	Cherry	
1600122A	Maple, Hard	

1/4" Solid Refacer's Program

- Moulding #2073 is solid 1/4" thick and designed to be applied over the face frames of existing cabinetry in field refacing applications.
- Available in 1/16" width increments from 1" to 6" wide x 96" long.
- Variable width refacer's moulding is available in Choice grade material. Sizes shown in the table below are for 1/4" thick "surfaced four sides" (S4S) square stock, molded and sanded.
- Available finished or unfinished. If finish option is chosen, moulding will be finished on face and two long edges only.

Ordering and Sizing Specifications

- Moulding is categorized and priced by width. Moulding width refers to the smallest whole-inch dimension of the refacing segment required. If the moulding is 1-1/4" wide, the appropriate pricing will be located in the 2" column. This rule is applicable to all sizes.
- Moulding wider than 5-1/16" may have one glue joint running the entire length.

1/4" Thick Solid Refacing Moulding Pricing						
Specie	Moulding Width					
	1"	2"	3"	4"	5"	6"
Alder						
Bamboo						
Birch, Red						
Birch, White						
Cherry						
Hickory						
Maple, Hard						
Maple, Soft						
Oak, Red						
Oak, White						
PG Hard Maple						
Pine						
Walnut						

Veneers

- All veneers are approximately 1/32" thick and have real wood veneer faces.
- One end and one side of any veneer sheet is guaranteed to be free from physical damage.
- Wood back veneers have a cross grain wood backer which allows trim edges to be finished to reduce "black line" effect.
- Poly back veneers are applied to a polymer resin impregnated membrane. They contain no added urea formaldehyde (NAUF), are rigid yet pliable and provide excellent moisture resistance.
- Wood back and poly back veneers are available with their applicable backer with an optional pressure sensitive adhesive (PSA) backer. PSA backed veneers have a pre-glued adhesive layer protected by a peel coat covering that must be removed prior to application.
- Phenolic Back veneers will be used in place of 48-1/4" x 96-1/2" wood back or poly back when ordered with Colortones, Prism Prints or primers. Upcharge applies, see chart below.
- Veneers are not guaranteed to perfectly match solid wood doors. Veneer is sliced from premium material; color and grain match will be more uniform than solid wood doors. Hickory veneers may contain mineral streaks and peck marks.
- Proper surface conditions and preparation is essential to successful application and performance of veneered surfaces.
- Per manufacturer's recommendations, veneers of all backer types should be placed flat and allowed to acclimate 48 hours before installation.
- Pressure sensitive veneers should not be applied to bare wood or surfaces covered with sanding sealers, high pressure laminates, melamine or other plastic materials.
- Wood back and poly back veneers are best applied with roller grade adhesives. Sufficient adhesive coverage on both the veneer and substrate surface will ensure proper adhesion and performance.
- Conestoga is not liable for product failure due to improper surface preparation, adhesive selection or installation technique.
- Finishing Option available. Stained veneers may vary slightly in color from solid wood products of the same specie. Finishing adds 5-6 days to standard lead-time.
- Conestoga does not accept returns of veneers.

PSA Wood Back

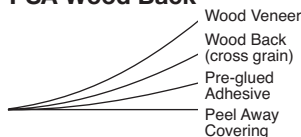

PSA Poly Back

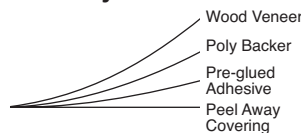

Wood Back



Poly Back

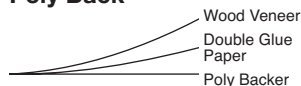

Phenolic Back



	24" x 96"		48-1/4" x 96-1/2"	
Specie	PSA Wood Back	PSA Poly Back	Wood Back	Poly Back
Alder				
Bamboo				
Birch, Red				
Birch, White				
Cherry				
Hard Maple				
Hickory				
Oak, Red				
Oak, White				
Pine, Knotty				
Quarter Sawn White Oak				
Walnut				

	48-1/4" x 96-1/2"
Specie	Phenolic Back*
Maple, Hard	

* Available with primers, Colourtone and Prism Paint finishes only.

☐ Stock item 3 day lead-time. ☐ Custom item 10 day lead-time.

Wood Edgeband Program

Conestoga offers 7/8" wide x 500' rolls of .5mm wood edgeband to complete your panel processing requirements. Select species are also offered in 250' rolls. See pricing charts below for specie availability.

- Real wood veneer applied to an unglued fleece backer.
- Edgeband is not guaranteed to perfectly match solid wood doors or sheet stock. Veneer edgeband is sliced from premium material; color and grain match will be more uniform than solid wood doors.
- Edgeband will contain multiple splice joints which will not be considered a defect.
- Conestoga is not liable for product failure due to improper surface preparation, adhesive selection or installation technique.
- All Conestoga finishing options are available as outlined in the Finishing Program Section of this manual.
- Lead-time 5 days unfinished for stock species, add 5-6 days for finishing. Expedite lead-times not available.
- Conestoga does not accept returns of finished edgeband.

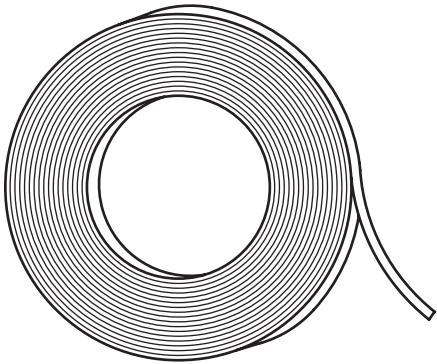

500' Wood Edgeband			
Specie	Price	Specie	Price
Alder		Pine	
Bamboo		Red Oak	
Cherry		Walnut	
Hard Maple		White Birch	
Hickory		White Oak	

250' Wood Edgeband	
Specie	Price
Cherry	
Hard Maple	

Price per roll, unfinished; see the Finishing Program section for finish pricing.

- ☐ Stock item 5 day lead-time.
☐ Non-stock item 15 day lead-time.

PVC Edgeband Program

Thermoplastic PVC Edgeband

- PVC edgeband rolls are 15/16" wide, 600' in length and .018" (.5mm) thick.
- Rolls of PVC edgeband are available in over 120 colors and grain patterns to match popular Conestoga finishes.
- The back side of the edgeband is coated with a bonding agent for superior adhesion when used with hot melt glues or solvent-based adhesives.
- PVC edgebands are impact resistant and perform well with cutting tools.
- The PVC edgebands listed provide a close match in appearance to the specie and finish referenced, however, due to color variations in wood substrates we cannot guarantee a perfect match. Some edgebands contain a slight texture and are identified with an asterisk in the chart. Edgeband finishes with two asteriks are 1mm thick and have a slight texture.
- Conestoga is not liable for product delamination or adhesion failure due to improper surface preparation, adhesive selection or installation technique.
- Full rolls only, partial rolls are not available through this program.
- Lead-time is 4 days, expedites not available.

Since Conestoga offers thousands of specie, finish and glaze combinations, customers may have a need for an edgeband not listed in our standard offering. In this case, Conestoga will attempt to work with our suppliers to see if an existing match can be identified. Since a sample chip of the specie/finish must be produced and shipped to the supplier, there will be a fixed charge for this exercise, regardless if a match is found or not.

Part #	Specie	Finish	Per Roll	Part #	Specie	Finish	Per Roll
Colourtones				Wiping Stains			
2602345A	CH	Crystal White w/Antiquing		2602435A	AL	Autumn	
2602347A	CH	Ebony		2602436A	AL	Autumn w/Brown	
2602340A	HM	Antique White		2602437A	AL	Bordeaux	
2602341A	HM	Arctic White		2602438A	AL	Chestnut	
2602422A	HM	Cadet Grey		2602439A	AL	Colonial	
2602342A	HM	Cadet Grey w/Onyx Pinstriping		2602440A	AL	Colonial w/Sable	
2602343A	HM	Chesapeake		2602442A	AL	Dark Roast	
2602344A	HM	Crystal White		2602443A	AL	Espresso	
2602346A	HM	Designer White		2602444A	AL	Honey	
2602348A	HM	Frosty White		2602445A	AL	Honey w/Sable	
2602423A	HM	Frosty White w/Chai		2602446A	AL	Natural	
2602349A	HM	Frosty White w/Coffee		2602447A	AL	Natural w/Brown	
2602350A	HM	Frosty White w/Oyster		2602448A	AL	Nickel	
2602351A	HM	Frosty White w/Pewter		2602449A	AL	Nickel w/White	
2602424A	HM	Hearthstone Grey w/Coffee		2602450A	AL	Nitefall	
2602425A	HM	Regent Blue		2602451A	AL	Nutmeg	
Heirloom				2602452A	AL	Saddle	
2602426A	CH	Cadet Grey w/Coffee		2602453A	AL	Saddle w/Sable	
2602427A	CH	Crystal White w/Coffee		2602454A	AL	Washington Cherry	
2602428A	CH	Ebony/Cordovan Accents		2602455A	AL	Washington Cherry w/Sable	
2602429A	CH	Hearthstone Grey w/Coffee		2602608A	BA	Chestnut	
2302430A	HM	Crystal White w/Coffee		2602609A	BA	Driftwood	
Brushed Glaze				2602610A	BA	Natural	
2602431A	HM	Crystal White w/Coffee		2602611A	BA	Nutmeg	
2602432A	HM	Crystal White w/Pewter		2602612A	BA	Espresso	
2602434A	HM	Hearthstone Grey w/Coffee		2602352A	CH	Bordeaux	
				2602353A	CH	Bordeaux w/Sable*	

*Textured

PVC Edgeband Program (continued)

Part #	Specie	Finish	Per Roll	Part #	Specie	Finish	Per Roll
Wiping Stains				Wiping Stains			
2602354A	CH	Chestnut		2602376A	HM	Portabella	
2602356A	CH	Colonial		2602377A	HM	Portabella w/White	
2602357A	CH	Colonial w/Sable		2602378A	HM	Saddle	
2602417A	CH	Dark Roast		2602379A	HM	Saddle w/Brown	
2602358A	CH	Espresso		2602380A	HM	Washington Cherry	
2602418A	CH	Ginger		2602456A	RO	Alpine*	
2602359A	CH	Harvest Gold		2602457A	RO	Autumn	
2602360A	CH	Honey w/Sable		2602458A	RO	Bordeaux	
2602361A	CH	Natural		2602939A	RO	Chestnut*	
2602362A	CH	Natural w/Sable		2602941A	RO	Chestnut w/Onyx*	
2602363A	CH	Nickel w/Brown		2602460A	RO	Dark Roast	
2602364A	CH	Nitefall		2602461A	RO	Driftwood*	
2602419A	CH	Nutmeg		2602960A	RO	Driftwood w/Sable**	
2602420A	CH	Portabella*		2602938A	RO	Espresso	
2602421A	CH	Portabella w/Brown*		2602463A	RO	Harvest Gold	
2602365A	CH	Saddle		2602464A	RO	Natural	
2602366A	CH	Saddle w/Sable*		2602942A	RO	Natural w/Caramel	
2602367A	CH	Washington Cherry		2602940A	RO	Nutmeg	
2602472A	HI	Autumn		2602466A	RO	Portabella	
2602474A	HI	Chestnut		2602943A	RO	Portabella w/Brown**	
2602475A	HI	Colonial		2602467A	RO	Portabella w/Pewter	
2602476A	HI	Colonial w/Sable		2602468A	RO	Saddle	
2602477A	HI	Dark Roast*		2602469A	RO	Saddle w/Brown	
2602478A	HI	Driftwood*		2602470A	RO	Saddle w/Sable*	
2603243A	HI	Ginger*		2602471A	RO	Washington Cherry	
2602479A	HI	Honey w/Sable		2603251A	WA	Autumn w/Sable	
2602480A	HI	Natural*		2603249A	WA	Chestnut	
2602481A	HI	Natural w/Brown		2603248A	WA	Chestnut w/Sable	
2602482A	HI	Nickel		2603246A	WA	Colonial	
2602483A	HI	Nitefall		2603247A	WA	Colonial w/Sable	
2602484A	HI	Nutmeg		2603253A	WA	Dark Roast	
2602485A	HI	Portabella		2603254A	WA	Espresso	
2602486A	HI	Saddle		2603250A	WA	Natural	
2603242A	HI	Saddle w/Caramel		2603252A	WA	Natural w/Sable	
2602951A	HI	Saddle w/Sable		2603244A	WA	Nickel	
2602368A	HM	Bordeaux		2603255A	WA	Nitefall	
2602369A	HM	Bordeaux w/Sable		2603245A	WA	Saddle	
2602370A	HM	Chestnut		2602946A	WO	Colonial	
2602371A	HM	Dark Roast		2602947A	WO	Driftwood*	
2602372A	HM	Driftwood*		2602949A	WO	Driftwood w/Sable**	
2602952A	HM	Ebony		2602944A	WO	Espresso	
2602373A	HM	Espresso		2602948A	WO	Natural	
2602374A	HM	Espresso w/Sable		2602950A	WO	Natural w/White	
				2602945A	WO	Nitefall	

*Textured **1MM & Textured

PVC Edgeband Program (continued)

Part #	Specie	Finish	Per Roll
Truetones			
2602487A	CH	Ashen w/Sable	
2602489A	CH	Cocoa	
2602490A	CH	Cocoa w/Sable	
2602491A	CH	Shale w/Sable	
2602492A	HM	Ashen	
2602493A	HM	Ashen w/Brown	
2602494A	HM	Cocoa w/Sable	
2602495A	HM	Shale w/Oyster	
2602496A	HM	Shale w/Sable	
2602497A	HM	Sienna	
2602498A	WO	Ashen	
2602499A	WO	Ashen w/Brown	
2602500A	WO	Shale*	
2602501A	WO	Shale w/Sable	

*Textured

3D Panels

3D Panels are a functional way to create built-in appearances, commonly used as refrigerator end panels, at the end of cabinet runs, a bridge above or beneath wall cabinets, and as island ends. All three panel models include inner supports to prevent panels bowing or cupping. 3D Panels up to 96" are made from 3/4" thick composite core plywood. Panels above 96" will be either composite core plywood or veneer core plywood. Species available are Plain Sliced Cherry, Hard Maple, Raw MDF, Rift Cut White Oak and Walnut.

Sizing

- Custom sizing is available to the nearest 1/16" in width, depth and height within program parameters.
- Minimum height for all models is 24", maximum standard height is 96" with vertical grain, maximum height for MDF is 96". Taller MDF heights available, but must be quoted through Special Designs. Additional lead-time required.

Pricing

- Calculate the actual square footage of the exposed/exterior side. Multiply the panel square footage by the appropriate specie list price. A 3 square foot minimum applies, regardless of actual size.
 - ♦ Cherry & Hard Maple – Priced per square foot.
 - ♦ MDF - Priced per square foot.
 - ♦ Rift White Oak & Walnut – \$27.65 per square foot.
- Multiply the total material cost established in the prior step by the model multiplier: Box Panel - 2.2, J-Panel - 1.5, U-Panel - 2.0.

Order Placement

- When placing order for any of the 3D Panel models, include the following dimensions:
 - ♦ Width of front panel (B side and/or D side).
 - ♦ Depth of exterior/exposed side panel (A side and/or C side).
 - ♦ Height of exterior/exposed side panel (A side and/or C side).
 - ♦ Vertical or horizontal grain direction.

Program Features

- Specify vertical or horizontal grain. (maximum size perimeters vary by grain direction).
- Finish options – available unfinished or finished in all published specie/finish selections except Heirloom, Unitones, Brushed Glazes and Distressing.
 - ♦ Finishing charges follow Conestoga's design plus material pricing method.
 - A minimum of 3 square feet will be applied, regardless of actual size.
 - 3.00 to 6.00 square feet – 2x Design Charge plus actual square footage charge of the exterior panel.
 - 6.01 square feet to 10.00 square feet – 3x Design Charge plus the actual square footage charge of the exterior panel.
 - 10.01 square feet and greater – 4x Design Charge plus the actual square footage charge of the exterior panel.
- Internal supports in 3-D Panel ends and backs are positioned 1" in from edges to fit over cleats mounted to the floor, wall and/or ceiling.
- Lead-time is 10 business days unfinished. Add 5 to 6 days for finishing.
- Expedites are not available.

3D Panels (continued)

11

Specialty Products

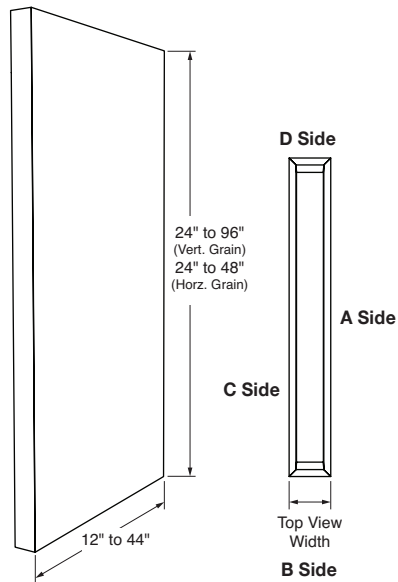

Box Panel

- Primarily used as island ends when both the front and back edges are exposed.
- Both ends of the Box Panel will be equal in width and height (B and D sides).
- Both side panels of the Box Panel will be equal in depth and height (A and C sides).
- Width range of front and back panels: 1-1/2" to 3" (B and D sides).
- Depth range of side panels: 12" to 44" (vertical grain) (A and C sides).
- Height range of side panels: 24" to 96" (vertical grain), 96" MDF. Veneered panels available 96-1/16" to 120" – additional lead-time required. Horizontal grain height range 24" to 48".

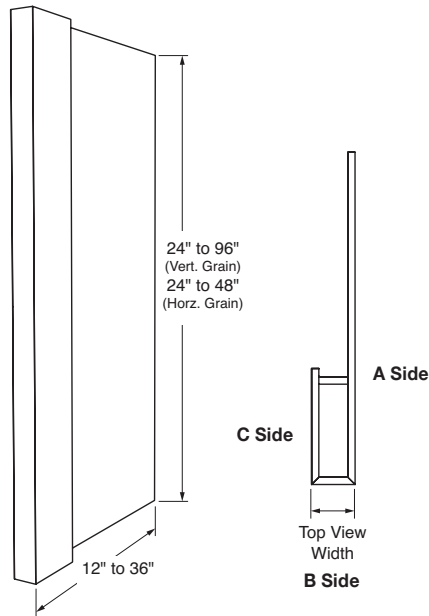

J-Panel

- Typically mounted against wall as base and refrigerator cabinet ends. Unfinished back edge must butt against a wall.
- The interior leg of the J-Panel (C side) is fixed at 8" depth, regardless of overall exterior panel depth.
- Width range of front panels 1-1/2" to 3" (B side).
- Depth range of side panel: 12" to 36" (A side).
- Height range of side panel: 24" to 96" (vertical grain), 96" MDF. Veneered panels available 96-1/16" to 120" – additional lead-time required. Horizontal grain height range 24" to 48".

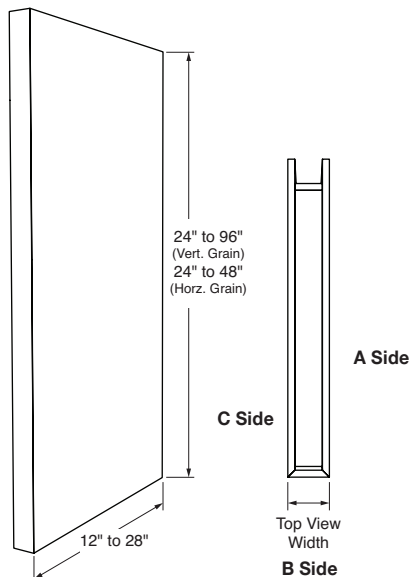

U-Panel

- Primarily used against wall, base and refrigerator ends as well as a bridge above or beneath wall cabinets to create a built in appearance. Unfinished back edges must butt against a wall.
- Both side panels of the U-Panel will be equal in depth and height (A and C sides).
- Width range of front panels 1-1/2" to 3" (B side).
- Depth range of side panel: 12" to 28" (A and C sides).
- Height range of side panels: 24" to 96" (vertical grain), 96" MDF. Veneered panels available 96-1/16" to 120" – additional lead-time required. Horizontal grain height range 24" to 48".

Blum COMPACT BLUMOTION Hinge Program

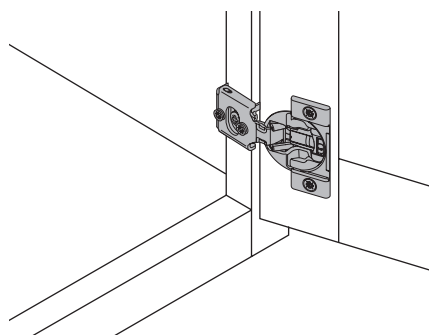

1/2" Overlay Hinge
COMPACT BLUMOTION 38N
105° opening angle

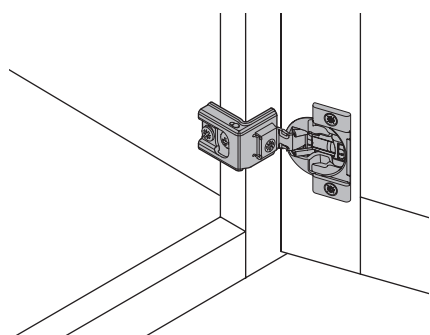

1-1/4" and 1-3/8" Overlay Hinge
COMPACT BLUMOTION 39C
110° opening angle

Blum Hinges with Integrated Soft Close

- One-piece steel, concealed, self closing hinges designed for use with 3/4" thick front frames.
- Available for 1/2", 1-1/4" and 1-3/8" overlays.
- Soft close feature is integrated in the hinge cup itself.
- Soft close function can be easily deactivated with a switch on individual hinges as needed based on the door size and weight.
- Hinges packed in pairs with mounting screws.
- All hinges feature side, height, and depth adjustment for fine tuning door spacing with wraparound face frame mounting for ease of installation.
- All hinges require Pattern A – Cup Only concealed hinge boring.
- COMPACT BLUMOTION hinges carry a limited lifetime warranty.
- Lead-time is 5 days.

COMPACT w/Integrated BLUMOTION		
Part No.	Overlay	Price per pair
2100150A	1/2"	
2100151A	1-1/4"	
2100152A	1-3/8"	

Integrated BLUMOTION Bulk Pack (50 hinges)		
Part No.	Overlay	Price per pack
2100153A	1/2"	
2100154A	1-1/4"	
2100155A	1-3/8"	

Blum Frameless Cabinetry Hinge Program

- Hinge and in-line mounting plate systems for standard, specialty and angled frameless cabinets.
- Soft close feature is integrated in the hinge cup itself unless otherwise noted.
- Soft close function can be easily deactivated with a switch on individual hinges as needed based on the door size and weight.
- Hinges packed in pairs with mounting plates and instructions.
- No screws required for hinge or mounting plate installation unless otherwise noted. Most hinges use cam style insert plugs.
- In-line mounting plates utilize 32mm system holes and are concealed behind the hinge arm when installed for a clean interior appearance.
- Hinge and mounting plate feature side to side, height and depth adjustment for fine tuning of door spacing.
- Hinges require Pattern B with Insert Holes concealed hinge boring unless otherwise noted.
- Blum hinges carry a limited lifetime warranty.
- Lead-time is 5 days.

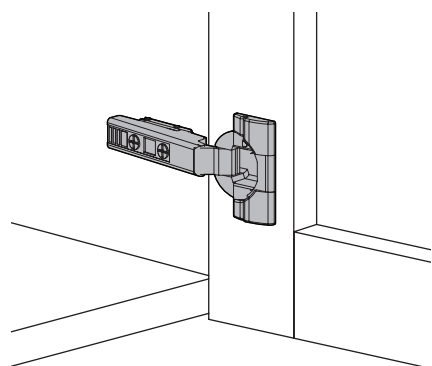

CLIP top BLUMOTION 110° hinge
EXPANDO in-line mounting plate

Blum INSERTA 110° Hinges

- Hinge and in-line mounting plate system for standard frameless wall, base and tall cabinetry. Will not work in angle or specialty frameless cabinetry.
- 110° opening angle.
- Part number: 2103574.
- Pricing: per pair.

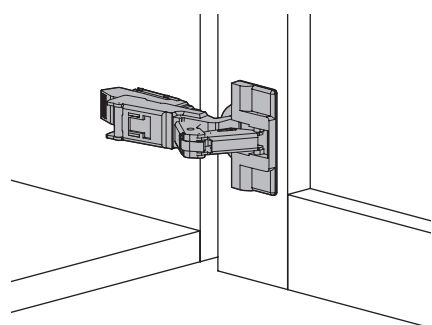

CLIP top 170° corner hinge
EXPANDO in-line mounting plate

Blum INSERTA 170° Corner Hinges

- Provides full access to corner cabinet interiors.
- 170° opening angle.
- Does not include soft close feature.
- INSERTA feature is not available on mounting plate. Kit includes installation screws.
- Part number: 2103575.
- Pricing: per pair.

Blum Frameless Cabinetry Hinge Program (continued)

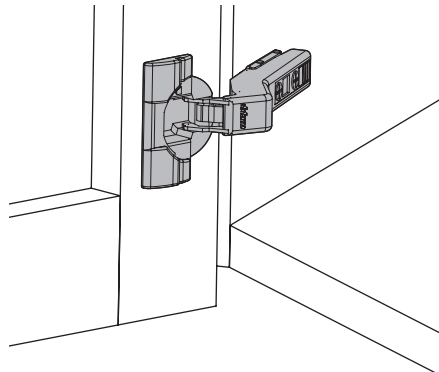

CLIP top BLUMOTION +45° hinge
EXPANDO in-line mounting plate

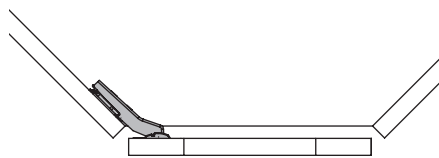

Top view

Blum INSERTA Positive +45° Angle Hinge

- Hinge and in-line mounting plate system for frameless diagonal corner or any angle cabinet with a 45 degree front.
- 110° opening angle.
- Part number: 2103581.
- Pricing per pair.

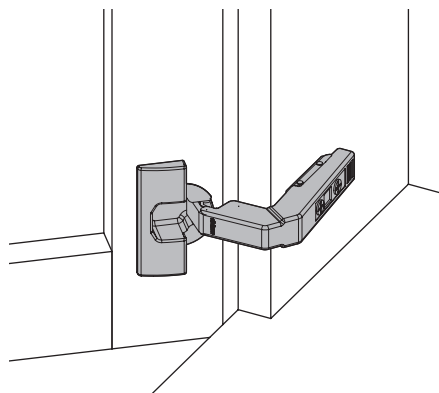

CLIP top 95° Overlay Blind Corner hinge
EXPANDO in-line mounting plate

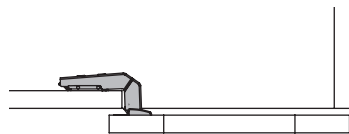

Top view

Blum INSERTA 95° Overlay Blind Corner Hinge

- Hinge and in-line mounting plate system for wall or base blind corner cabinets.
- 95° opening angle.
- Part number: 2103582.
- Pricing: per pair.

Blum Frameless Cabinetry Hinge Program (continued)

11

Specialty Products

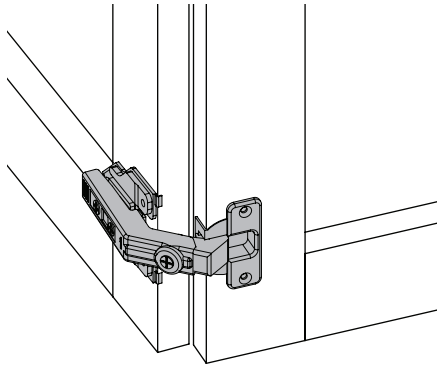

CLIP top 60° Bi-Fold hinge
Frame adaptor mounting plate

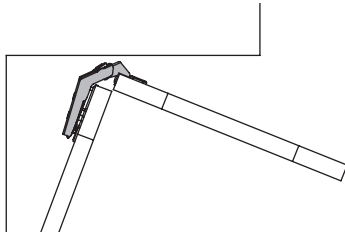

Top view

Blum 60° Bi-Fold Door Hinge

- Hinge and edge style mounting plate to join two doors in a bi-fold application.
- INSERTA installation feature is not available on hinge or mounting plates. Kit includes installation screws.
- Use with an 170° corner hinge on adjacent door (part number 2103575).
- Does not include soft close feature.
- Requires Bi-Fold Hinge Bore without Insert Holes – See Section 7.
- 60° opening angle.
- Part number: 2103583.
- Pricing: per pair.

Blum INSERTA Negative -45° Hinge

- Hinge and in-line mounting plate system for frameless angle cabinets or cabinet hinging on the opposite side of a 45°.
- 110° opening angle.
- Part number: 2103584.
- Pricing: per pair.

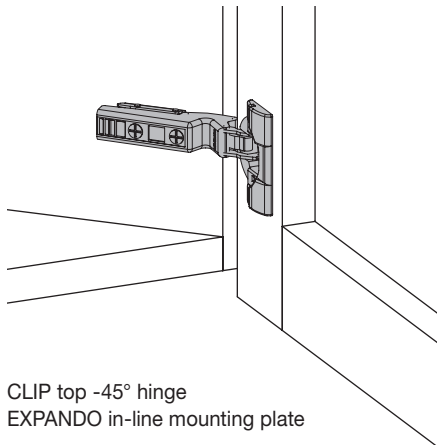

CLIP top -45° hinge
EXPANDO in-line mounting plate

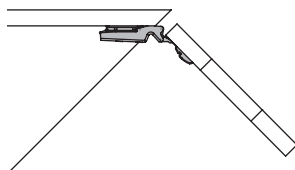

Top view

Blum AVENTOS Door Lift System Hardware

- Blum's AVENTOS Door Lift Systems are available for hinge upward applications.
- AVENTOS HK models provide all the necessary hardware to install lift up door access for wall and tall cabinets. AVENTOS HK-XS models utilize conventional door hinges.
- Kits are designed to accommodate different door design types, weights and overlay options as well as for framed or frameless cabinet construction.
- All AVENTOS mechanisms have an integrated BLUMOTION soft close feature and include installation instructions and screws.

To determine which AVENTOS Lift System is suited for your particular application, two reference sources are available:

- ♦ A file containing our AVENTOS Lift System Calculator is provided on Conestoga's Customer Business Portal under the Marketing Resources tab. Use this tool to calculate the weight of your door and select the appropriate lift kit for your application.
- ♦ Using the charts which correspond to the different AVENTOS models below, determine the weight of the door then calculate the Blum Power Factor required to adequately lift the door as follows:

Door Weight + (Handle/Pull Weight X 2) = Subtotal X Door Height = Power Factor
Specie and Door Weight reference chart applies to both HK-XS and HK lift systems

Specie & Door Design Weight (approx. weight of 1 sq. ft. 3/4" thick door)				
Specie (all grades)	Slab Design	TW-series Design	CRP-series Design	Frame Only*
Alder, Pine	1.6 lb.	1.2 lb.	1.5 lb.	1 lb.
Birch (Red, White)	2.8 lb.	2.1 lb.	2.6 lb.	1.7 lb.
Cherry	2.5 lb.	1.9 lb.	2.3 lb.	1.5 lb.
Maple (Hard, Soft)	2.9 lb.	2.1 lb.	2.7 lb.	1.8 lb.
Hickory	3.2 lb.	2.4 lb.	3 lb.	2 lb.
Allure DLV, High Gloss, MDF	2.4 lb.	1.8 lb.	NA	1.5 lb.
Pine	2 lb.	1.5 lb.	1.9 lb.	1.3 lb.
Red Oak	3 lb.	2.2 lb.	2.8 lb.	1.9 lb.
Intrigue, Strata, Vogue TTS	2.6 lb.	1.9 lb.	NA	1.6 lb.
Walnut	2.6 lb.	2 lb.	2.5 lb.	1.6 lb.
White Oak	3.1 lb.	2.3 lb.	2.9 lb.	1.9 lb.

*Does not include weight of glass.

Blum AVENTOS Door Lift System Hardware (continued)

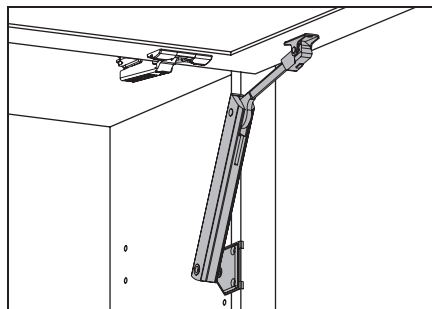

Blum AVENTOS HK-XS

- XS-Series utilize conventional hinges (not included).
- Units are symmetrical and can be installed on one or both sides.
- Cabinet heights from 9-1/2" to 24" and cabinet widths up to 72".
- Minimum interior depth required is 5".
- Four AVENTOS kits provide all the necessary hardware designed for different weight doors for both framed and frameless cabinet construction.

AVENTOS HK-XS Reference Chart

Power Factor (1 Lift)	Power Factor (2 Lifts)	Door Weight	Part No.	Price
Framed Cabinet Construction				
17 – 84	34 – 124	Light	2103578	
113 – 180	225 – 336	Heavy	2103580	
Frameless Cabinet Construction				
17 – 84	34 – 124	Light	2103577	
113 – 180	225 – 336	Heavy	2103579	

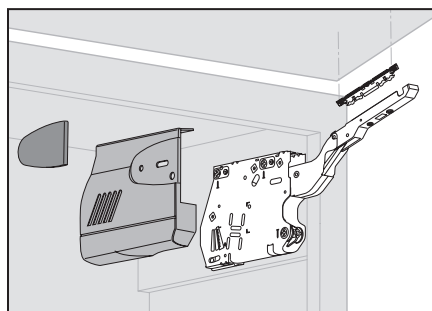

Blum AVENTOS HK

- Simple, virtually tool free assembly and easy adjustment.
- Specifically designed for frameless wall and tall utility applications.
- Cabinet heights from 11-13/16" to 24" and cabinet widths to 72".
- Minimum cabinet interior depth required is 8-1/4".

AVENTOS HK Reference Chart

Power Factor	HK Kit Series	Part No.	Price
43 – 99	2300	2100350	
100 – 174	2500	2100351	
175 – 349	2700	2100352	
350 – 792	2900	2100353	

AVENTOS Accessory Items

Description	Part No.	Price
Mounting Hardware Set	2100354	
100° Restriction Clip	2100355	
75° Restriction Clip	2100356	

Entry Level Range Hoods

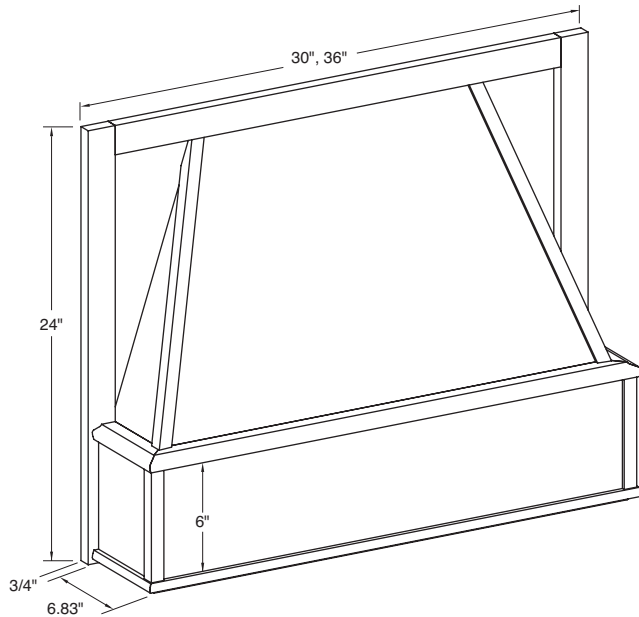

Select Range Hood

- Hood must be secured to adjacent cabinets.
- Manufactured from solid wood and wood veneers.
- Includes 24 gauge silver metallic liner.
- Liner accommodates the following Broan ventilators: 250CFM - RHVBF10SM
390CFM - RHVBB20SM
Contact Omega National Products:
(800) 533-8809.
- Lead-time 10 days unfinished, add 5-6 days for finishing.
- **Custom sizes not available.**

Specie	Unfinished Price	
	30"	36"
Alder		
Cherry		
Hard Maple		
Red Oak		

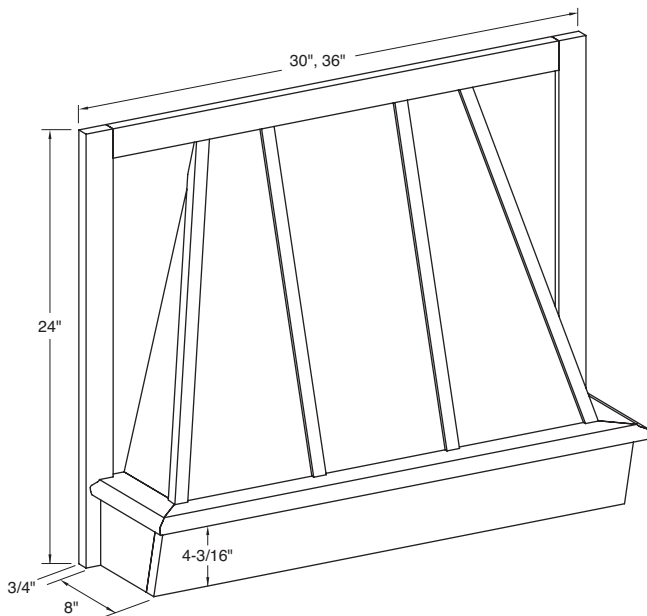

Batten Select Range Hood

- Hood must be secured to adjacent cabinets.
- Manufactured from solid wood and wood veneers.
- Includes 24 gauge silver metallic liner.
- Liner accommodates the following Broan ventilators: 250CFM - RHVBF10SM
390CFM - RHVBB20SM
Contact Omega National Products:
(800) 533-8809.
- Lead-time 10 days unfinished, add 5-6 days for finishing.
- **Custom sizes not available.**

Specie	Unfinished Price	
	30"	36"
Alder		
Cherry		
Hard Maple		
Red Oak		

Range Hoods

Straight Farmhouse Hood

- Shiplap wall-mounted hood with galvanized steel mounting bracket for easy installation.
- Manufactured from solid wood and veneer core plywood.
- Moulding at top of hood is attached with 6 screws allowing for easy removal if the top needs to be trimmed to height.
- Shiplap spaced at 6" intervals.
- Solid wood arched valance.
- 1-3/8" wood corner mouldings are shipped loose to allow for trimming to desired height.
- Includes silver metallic powder-coated liner.
- Liner accommodates the following Broan ventilators:
 - 250 CFM - RHVBF10SM
 - 390 CFM - RHVBB20SM
 - 500 CFM - RHVBB30SS
 - 1100 CFM - RHVBHLB11
- Contact Omega National Products: (800) 533-8809.
- Lead-time 15 days unfinished, add 5-6 days for finishing.
- **Custom sizes not available.**

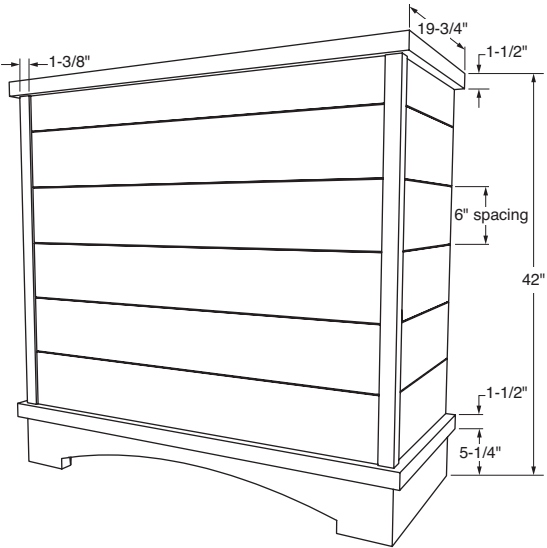

Specie	Unfinished Price		
	36"	42"	48"
Alder, Cherry			
Hard Maple			
PGHM Hybrid*			
Red Oak			

*MDF w/Maple mouldings.

Range Hoods (continued)

Tapered Farmhouse Hood w/Detached Chimney

- Shiplap wall-mounted hood with galvanized steel mounting bracket for easy installation.
- Manufactured from solid wood and veneer core plywood.
- Chimney and base ship in separate cartons. Moulding at top of chimney is attached with 4 screws allowing for easy removal if the top needs to be trimmed to height. Mouldings on the side of the chimney are shipped loose to allow for trimming if needed.
- 6" hardwood base.
- Shiplap spaced at 6" intervals.
- 1-3/8" wood corner mouldings attached.
- Includes silver metallic powder-coated liner.
- Liner accommodates the following Broan ventilators:
 - 250 CFM - RHVBF10SM
 - 390 CFM - RHVBB20SM
 - 500 CFM - RHVBB30SS
 - 1100 CFM - RHVBHLB11
- Contact Omega National Products: (800) 533-8809.
- Lead-time 15 days unfinished, add 5-6 days for finishing.
- **Custom sizes not available.**

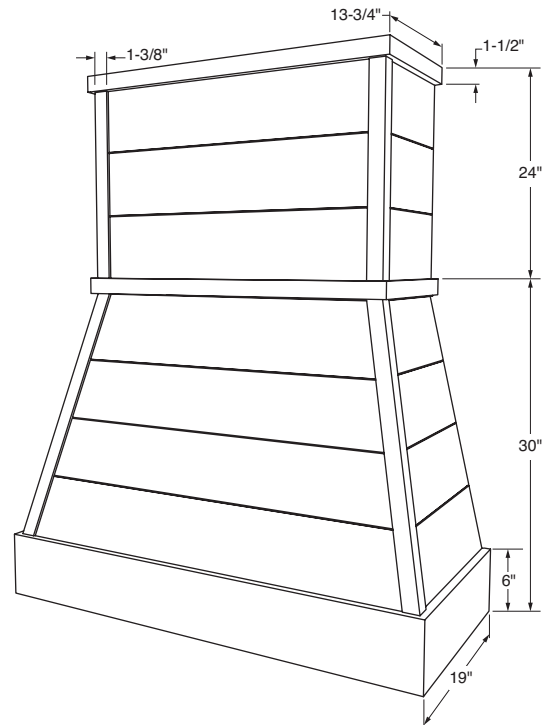

Specie	Unfinished Price			
	30"	36"	42"	48"
Alder, Cherry				
Hard Maple				
PGHM Hybrid*				
Red Oak				

*MDF w/Maple mouldings.

Range Hoods (continued)

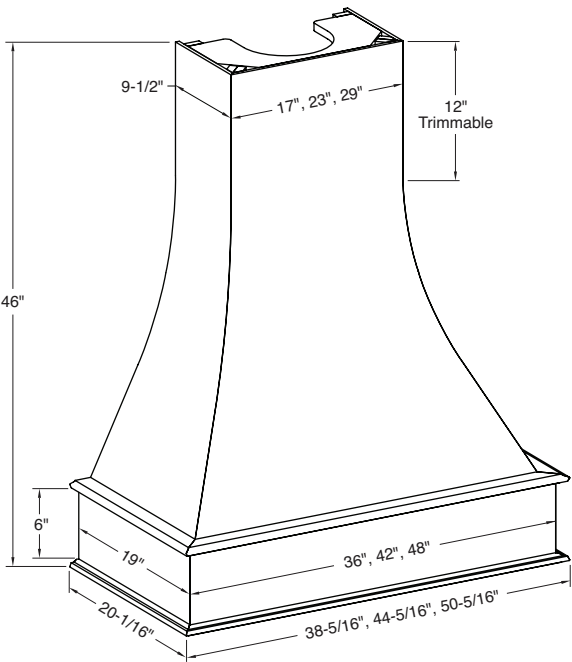

Artisan Range Hood

- Complete turnkey solution with patented hanging cleat for quick and easy installation.
- Manufactured from solid wood and wood veneers.
- Up to 12" may be trimmed from the top of the chimney.
- Includes silver metallic powder-coated liner.
- Liner accommodates the following Broan ventilators:
 250 CFM - RHVBF10SM
 390 CFM - RHVBB20SM
 500 CFM - RHVBB30SS
 1100 CFM - RHVBHLB11
 Contact Omega National Products:
 (800) 533-8809.
- Lead-time 15 days unfinished, add 5-6 days for finishing.
- **Custom sizes not available.**

Specie	Unfinished Price			
	30"	36"	42"	48"
Cherry				
Hard Maple				
PGHM Hybrid*				
Red Oak				

*MDF w/Maple mouldings.

Le Marcin Range Hoods

Conestoga's Le Marcin line of range hoods offers attractive design at highly competitive pricing. With savings ranging from 15% to 40% below comparable designs, these mantle style hoods are constructed with plywood cases with solid wood fronts. Offering design flexibility, LM Series hoods complement traditional, transitional or shaker styling with attributes that include display shelves, choices of framing beads, panel raises and optional corbel packages for select hoods.

Program Details

- All models are constructed using 1/2" plywood cases including full backs and full removable bottoms that can be trimmed to accommodate a variety of ventilation systems and top stretchers to ensure stability and squareness.
- Range hood fronts are fabricated using 3/4" thick solid wood or with Metal Water panels when Paint Grade Hard Maple is selected.
- Range hood bottoms are lined with an anodized aluminum laminate or stainless steel finish. Laminated bottoms are removable for ease of cutting ventilation.
- Metal laminate provides 1/A fire rating and GreenGuard Low VOC certification.
- This full width and depth liner provides superior flexibility for ventilation system.
- Located 4-1/2" above bottom of hood for models LM1, LM2, LM3, LM4 and LM5.
- Located 6" above bottom of hood for models LM6 and LM7.
- Profile options:
 - Framing beads: choose from any of the 7 framing beads (page 7.2).
 - Panel raises: choose from any of the 1 panel raises (page 7.2). P-106 raise not available in Paint Grade Hard Maple.
- Specie options include Cherry, Hard Maple, Paint Grade Hard Maple Hybrid.
- The inside dimensions of all LM Series hoods are 2" less in width than the exterior dimensions of the hood width. The interior depth is 21".
- Shelf edge profiles – select from any of the 7 shelf edge profiles to accentuate the design of the hood. B-2, H-2, L-034, M-2, P-106, R-2, S-2, T-2 or V-2.
- Each shelf is 1/2" thick solid wood.
- Height of the hood is 42" or 48" depending on the model. When the valance height is 12-1/2".
- Range hood is available unfinished or finished; see Finishing Program Section for finish options.
- Ventilation system is not included. Stainless steel ventilation units for the Le Marcin series of hoods are available through Zephyr. Contact (888) 880-8368 to locate a dealer or visit www.zephyronline.com and click "Find a Dealer" for the ventilation models listed below.

Standard Dimensions

	LM1 – LM7	LM8
Widths	30", 36", 42", 48", 54"	33", 39", 45", 51"
Heights	24", 30", 36", 42", 48"	24", 27", 30", 33", 36", 39", 42"
Depth	21" (no options)	21" (no options)

Zephyr Ventilation Systems

Model	Range Hood Width								
	30"	33"	36"	39"	42"	45"	48"	51"	54"
Twister AK8000BS	X	X	X						
Tornado I AK8100AS- BF	X	X	X						
Tornado II AK8200AS			X	X	X	X	X		
Tornado III AK8300ASX				X	X	X	X	X	X

- All hoods will ship from East Earl, PA.
- Lead-time is 10 days unfinished with an additional 5 to 6 days for most finishes.
- Expedites not available.
- **Customization in size, specie or design is not available.**
- Example: LM3B4842 = LM3 model, B indicates 5-3/4" wide stiles, 48" width and 42" height.

Le Marcin Range Hoods (continued)

Range Hood Nomenclature

When ordering your range hood from the Le Marcin collection, follow these guidelines to identify the correct part number for your hood:

- The first 3 characters identify the hood design – LM1, LM2, LM3, LM4, LM5, LM6, LM7 or LM8.
- The fourth character designates the width of the framing stiles – 3 options exist:
 - ♦ “A” designates hood with 2-3/4" framing.
 - ♦ “B” designates hood with 5-3/4" framing.
 - ♦ “X” designates hood with doors (LM6 model only).
 - ♦ LM8 has no framing or door designation.
 - ♦ There are no other options - must select A, B or X.
- The fifth and sixth characters are the overall hood width.
- The seventh and eighth characters are the overall hood height.

Corbel Options

Three popular corbel designs are available to accessorize your range hood: Jennings and Pickford.

- When Corbel Option is selected, pricing includes 2 corbels installed beneath the display shelf.
- 2-3/4" stiles will receive 1-3/4" wide corbels. 5-3/4" stiles will receive 3" wide corbels.
- When selecting Corbel Option, indicate material for corbel below.

Concord						
	Part No.	Specie	Width	Depth	Height	Per Hood
	2652890A	Cherry	1-3/4"	5"	8-1/16"	
	2652891A	Maple	1-3/4"	5"	8-1/16"	
	2652892A	Paint Grade	1-3/4"	5"	8-1/16"	
	2652893A	Cherry	3"	5"	8-1/16"	
	2652894A	Maple	3"	5"	8-1/16"	
Jennings						
	Part No.	Specie	Width	Depth	Height	Per Hood
	2652741A	Cherry	1-3/4"	4-7/8"	9-1/2"	
	2652742A	Maple	1-3/4"	4-7/8"	9-1/2"	
	2652743A	Paint Grade	1-3/4"	4-7/8"	9-1/2"	
	2652760A	Cherry	3"	4-7/8"	9-1/2"	
	2652761A	Maple	3"	4-7/8"	9-1/2"	
Pickford						
	Part No.	Specie	Width	Depth	Height	Per Hood
	2652695A	Cherry	1-3/4"	5"	7-1/2"	
	2652696A	Maple	1-3/4"	5"	7-1/2"	
	2652697A	Paint Grade	1-3/4"	5"	7-1/2"	
	2652720A	Cherry	3"	5"	7-1/2"	
	2652721A	Maple	3"	5"	7-1/2"	
	2652722A	Paint Grade	3"	5"	7-1/2"	

Le Marcin Range Hoods (continued)

LM1A and LM1B Mantle Hood w/Display Shelf

- Mantle style hood with arched valance, designed to mount between wall cabinets.
- Arch valance and upper section of face can receive raised or recessed panels.
- Removable front top panel is standard.
- Includes a 1" thick, 6" deep display shelf, attached. Shelf located between top panel and arched apron.
- LM1A – 2-3/4" stiles. LM1B – 5-3/4" stiles.
- Corbel Options available - see page 11.38.
- 2" fixed top rail to attach crown mouldings.
- Anodized aluminum laminated bottom is located 6" above bottom of hood.
- **Custom size, specie or design is not available.**

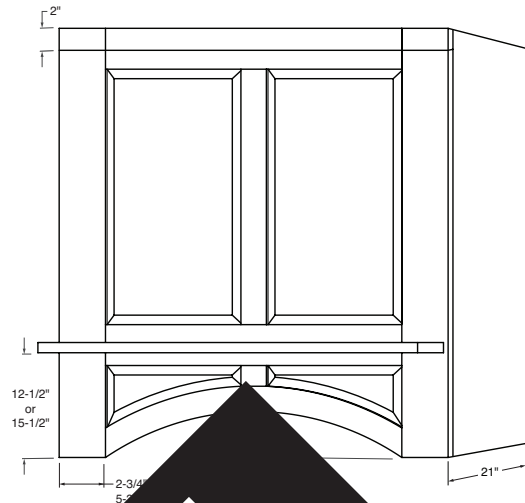

Specie	Part Num'											
	LM1-36x24	LM1-36x30	LM1-42x30	LM1-36x36	LM1-42x36	LM1-48x36	LM1-36x42	LM1-48x42	LM1-54x42	LM1-48x48	LM1-54x48	LM1-48x48
Cherry												
Hard Maple												
PG Hard Maple												

LM2A and LM2B Mantle Hood w/Display Shelf

- Mantle style hood with 1-piece arched valance, designed to be mounted between adjacent cabinetry.
- Removable front top panel is standard and can receive raised or recessed panels.
- Includes a 1" thick, 6" deep display shelf, with under shelf support attached. Shelf located between top panel and arched apron.
- LM2A – 2-3/4" stiles. LM2B – 5-3/4" stiles.
- 2" fixed top rail to attach crown mouldings.
- Anodized aluminum laminated bottom is located 6" above bottom of hood.
- **Custom size, specie or design is not available.**

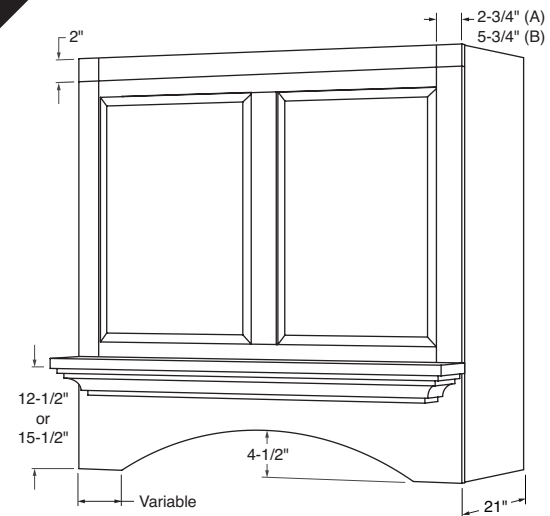

Specie	Part Number											
	LM2-36x24	LM2-36x30	LM2-42x30	LM2-36x36	LM2-42x36	LM2-48x36	LM2-30x42	LM2-36x42	LM2-42x42	LM2-48x42	LM2-54x42	LM2-48x48
Cherry												
Hard Maple												
PG Hard Maple												

Le Marcin Range Hoods (continued)

LM3A and LM3B Shaker Hood w/Display Shelf

- Shaker style mantle hood designed to be mounted to the wall and adjacent wall cabinets.
- Removable front top panel is standard and can receive raised or recessed panels.
- Includes a 1" thick, 6" deep display shelf, attached. Shelf located between top panel and apron.
- LM3A – 2-3/4" stiles. LM3B – 5-3/4" stiles.
- Corbel Options available - see page 11.38.
- 2" fixed top rail to attach crown mouldings.
- Anodized aluminum laminated bottom is located 6" above bottom of hood.
- **Custom size, specie or design is not available.**

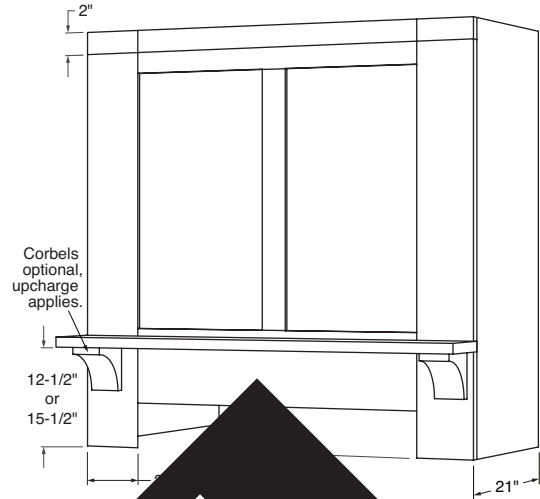

Specie	Part Number										
	LM3-36x24	LM3-36x30	LM3-42x30	LM3-36x36	LM3-42x36	LM3-48x36		LM3-48x42	LM3-54x42	LM3-48x48	
Cherry											
Hard Maple											
PG Hard Maple											

LM4A and LM4B Arched Valance Hood

- Mantle style hood with solid top panel designed to be mounted to the wall and adjacent cabinetry.
- Removable 4 panel top panel is standard.
- Shelf and Corbel Options available with LM4 series.
- LM4A – 2-3/4" stiles. LM4B – 5-3/4" stiles.
- 2" fixed top rail to attach crown mouldings.
- Anodized aluminum laminated bottom is located 6" above bottom of hood.
- **Custom size, specie or design is not available.**

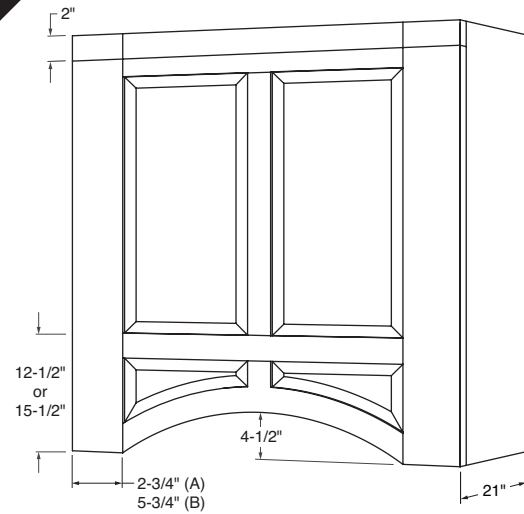

Specie	Part Number											
	LM4-36x24	LM4-36x30	LM4-42x30	LM4-36x36	LM4-42x36	LM4-48x36	LM4-30x42	LM4-36x42	LM4-42x42	LM4-48x42	LM4-54x42	LM4-48x48
Cherry												
Hard Maple												
PG Hard Maple												

Le Marcin Range Hoods (continued)

LM5A and LM5B Mantle Hood w/Elegant Arch Valance

- Mantle style hood with elegant arched valance and under shelf moulding build-up.
- Upper section can receive raised or recessed panels.
- Removable front top panel is standard to access ventilation system. Shelf located between top panel and arched apron.
- Includes an attached 6" deep display shelf.
- LM5A – 2-3/4" stiles. LM5B – 5-3/4" stiles.
- 2" fixed top rail to attach crown mouldings.
- Corbel Option not available with LM5 Series.
- Laminated bottom is located 6" above bottom of hood.
- **Custom size, specie or design is not available.**

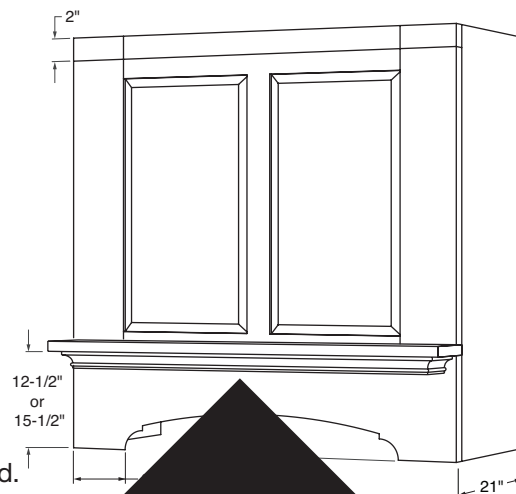

Specie	Part Number									
	LM5-36x24	LM5-36x30	LM5-42x30	LM5-36x36	LM5-42x36	LM5-48x36	LM5-42x42	LM5-48x42	LM5-54x42	LM5-48x48
Cherry										
Hard Maple										
PG Hard Maple										

LM6X Mantle Hood w/Doors

- Mantle style hood with straight valance. Top section is a full width panel with 2 to 3 openings to access ventilation system. Doors designed to match surrounding cabinetry.
- 30" - 48" wide doors.
- 54" wide doors.
- Functioning doors to access to ventilation system.
- Must be installed with overlay.
- Overlays 1/2", 1-1/4" and 1-3/8".
- Allure, Intrigue, Arata, Vogue, Polyethylene, Synchronicity and Aluminum Framed doors not available with LM6 Series.
- Corbel Option not available with LM6 Series.
- Includes a 1" thick, 6" deep display shelf, with under shelf moulding build-up attached.
- Anodized aluminum laminated bottom is located 4-1/2" above bottom of hood.
- **Custom size, specie or design is not available. Doors not included in price.**

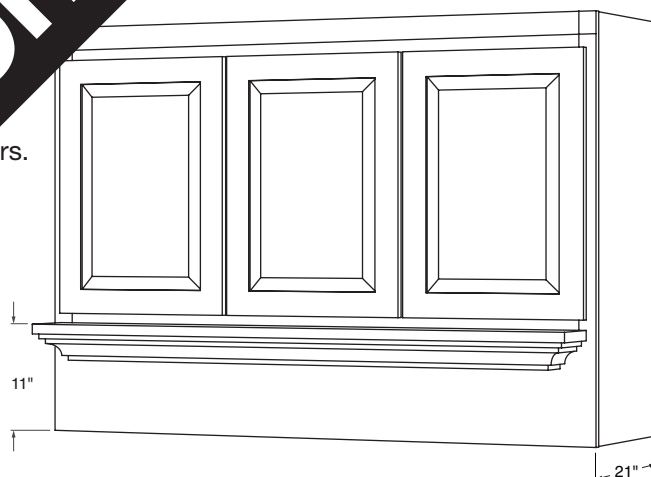

Specie	Part Number											
	LM6-36x24	LM6-36x30	LM6-42x30	LM6-36x36	LM6-42x36	LM6-48x36	LM6-30x42	LM6-36x42	LM6-42x42	LM6-48x42	LM6-54x42	LM6-48x48
Cherry												
Hard Maple												
PG Hard Maple												

Le Marcin Range Hoods (continued)

LM7B Mantle Hood w/Bottom Shelf Base

- Mantle style hood with 4-1/2" deep by 8" high mantle shelf capped with decorative moulding.
- Panel section of face can receive raised or recessed panels.
- Removable front top panel is standard to access ventilation system.
- LM7B – 5-3/4" stiles only.
- 2" fixed top rail to attach crown mouldings.
- Corbel Option not available with LM7 Series.
- Anodized aluminum laminated bottom is located 4-1/2" above bottom of hood.
- **Custom size, specie or design is not available.**

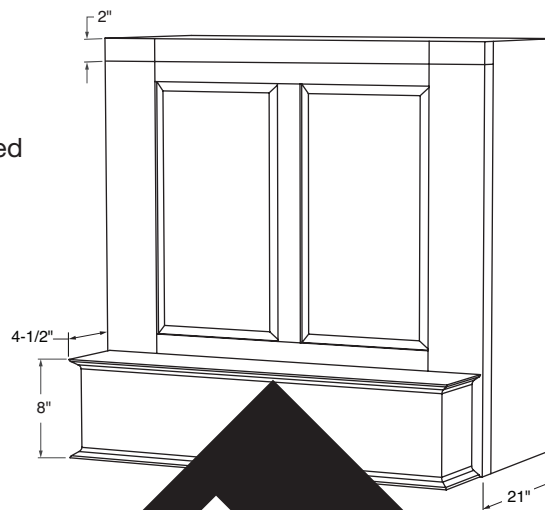

Specie	Part Number										
	LM7-36x24	LM7-36x30	LM7-42x30	LM7-36x36	LM7-42x36	LM7-48x36	LM7-48x42	LM7-54x42	LM7-48x48	LM7-54x48	LM7-60x48
Cherry											
Hard Maple											
PG Hard Maple											

LM8 Modern Hood w/Tapered Panel

- Modern style hood with 8" high tapered upper panel.
- Exterior depth always 21 inches.
- Trim moulding between tapered upper panel has a 1" overhang on sides and front.
- Hood width always 21 inches including the moulding overhang.
- Apron is made of same specie base or stainless steel. Must specify.
- Removable front top panel. Corbel Option not available with LM8 Series.
- Anodized aluminum laminated bottom is located 4-1/2" above bottom of hood.
- **Custom size, specie or design is not available.**

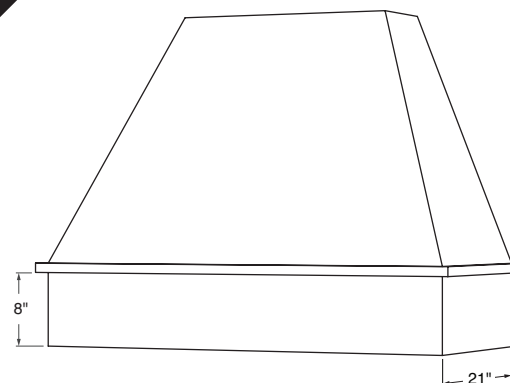

Specie	Part Number											
	LM8-39x27	LM8-45x27	LM8-33x30	LM8-45x30	LM8-39x33	LM8-33x36	LM8-39x36	LM8-45x36	LM8-33x42	LM8-45x42	LM8-51x36	LM8-51x42
Cherry												
Hard Maple												
PG Hard Maple												

Stanisci Design Range Hoods

Stanisci Design is the leading manufacturer of wood range hoods for the custom kitchen industry. This program allows for convenient ordering of custom range hoods and ventilation units. Conestoga's published offering includes several popular hood designs with panel raise and bead options. Both plywood and raised panel hoods are available in a wide variety of heights and widths.

Program Details

- Range hoods are available unfinished or finished; see Finishing Program Section for finish options and pricing.
- Most prefinished hoods will ship from Conestoga's Kenly, N.C. facility.
- Custom species include African Mahogany, Hickory and Rustic Knotty Alder. Contact Special Designs for other specie availability.
- Custom sizes and designs are available. Contact Special Designs for a quote.

Examples of custom designs:

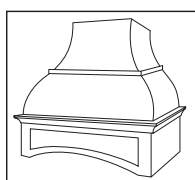

Hood shown with single panel valance

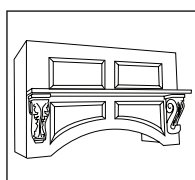

Hood shown with integrated corbels

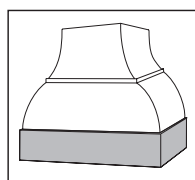

Hood shown with stainless steel base

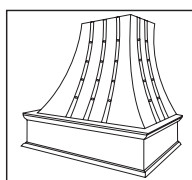

Hood shown with metal banding

- Liners are not included with hood unless otherwise noted. Stainless steel ventilation units and liners are available from Stanisci Design with discounted Conestoga program pricing. Contact Stanisci Design at (248) 572-6880.
- Recommended ventilator: Stainless steel units from 300 to 1500 CFM are available through Stanisci Design (248) 572-6880.
- Stanisci hoods are available in catalog format, compatible with 20/20 Design software. Contact your Sales Representative for information.
- Value line ventilation systems are also available for Stanisci Design range hoods: silver metallic powder coat finish, 390 CFM multi-blower with two 40w lights (no discount available).

PLEASE NOTE: All Stanisci Range Hoods should be mounted no closer than 30" above cook tops, although some cook tops require additional clearance. Please check local building codes and appliance specifications.

Removable Options

Removable Applied Panel

- Available on I-Series hood design only.
- Allows for easy installation and access for Building Inspectors.
- Panel features applied moulding for finished look after installation.
- Specify "Removable Panel Option"

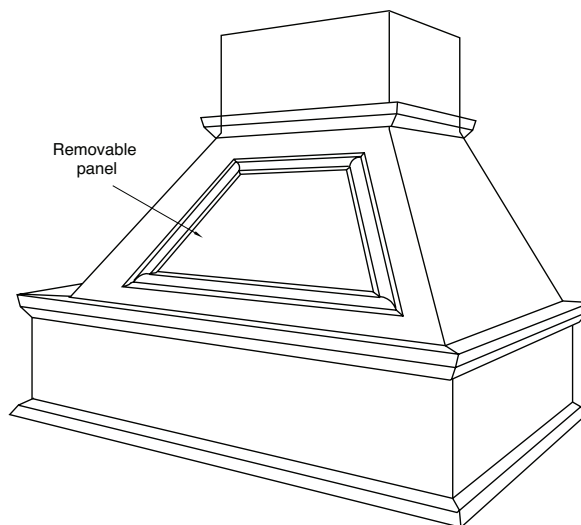

Removable Front

- Available on P, J, and Z200 series hoods at no additional charge.
- With this option, the entire front fascia lifts straight up for easy removal. When installed, the hood face is secured in place with concealed clips.
- If this option is selected, the depth of the P and Z200 box will be modified to 16" deep, while the J box depth will be 14". Overall hood depth will remain the same as standard depth.
- No additional lead-time required.
- When ordering, specify the hood design then "Removable Option".

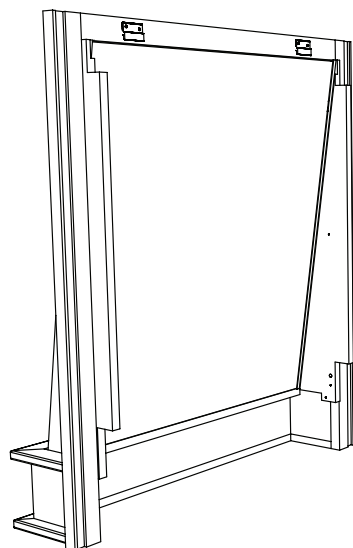

Face

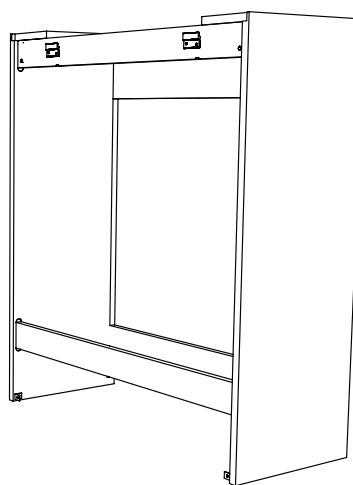

Box

Removable Top

- Available on the CHW, CHWB, E, G, GRA, T and TRA series hoods at no additional charge.
- This option allows the base of the hood to be installed separately, followed by the ventilation. After ventilation hookup has been completed, the top portion of the hood can lower into place and be secured to the base.
- No additional lead-time required.
- When ordering, specify the hood design then "Removable Option".

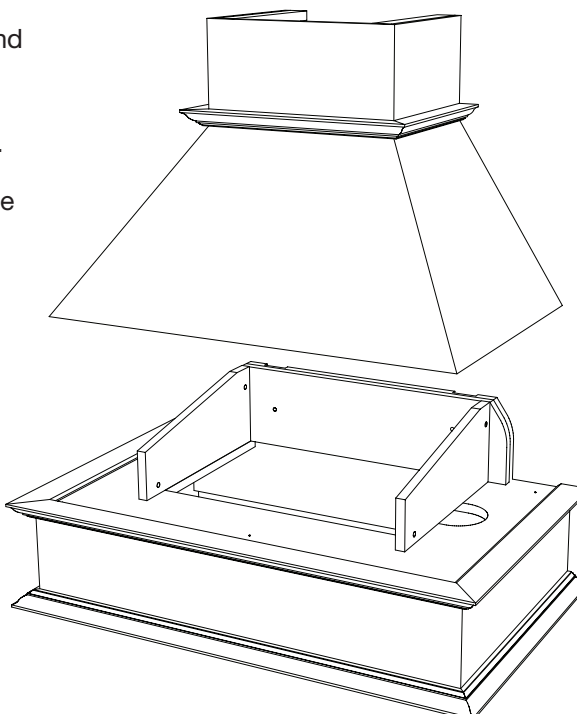

Stanisci Design Range Hoods (continued)

Optional Moulding Packages

- Several hoods are available with a choice of Classic, Simple or Basic moulding packages. See illustrations below for examples of differences between the three moulding profiles.
- Classic package is a more traditional style moulding. Simple and Basic packages are made for contemporary/transitional kitchens.
- Moulding packages have no effect on pricing, lead-time or overall dimensions.
- Moulding packages available on all Stanisci hoods except BX, BXB, CHW, CHWB, FX, L2, M, Q, VCHM-AV, VCHM-SV, VCHM-VRS and Z300 hoods.
- Below moulding packages available for E, G, H, I, J, S, T and W hoods (P and Z200 available in Basic package only).
- When ordering a range hood specify the desired moulding package.



Classic Package



Simple Package



Basic Package

Antiquing, Distressing and Wear Sanding

To allow our customers to purchase prefinished Stanisci range hoods with the same overall appearance of their doors, Conestoga offers a modified version of our Antiquing, Distressing and Wear Sanding Options on the solid wood portions of Stanisci hoods.

- These treatment options available with Stanisci-brand range hoods only.
- Not available on Paint Grade Hard Maple Hybrid specie hoods.
- Availability of these options varies by hood design.
- Wear Sanding Design Charge is priced per panel.
- Antiquing Design Charges and square foot Material Charges are equal to published finishing fees.
- Distressing Design Charges and square foot Material Charges are equal to published finishing fees.

Stanisci Design Range Hoods (continued)

VCHIM Series Hood – Straight Valance

- Stylish straight valance complements traditional or contemporary designs.
- Designed to fit up to a 9 foot ceiling.
- Plywood chimney and upper. Solid wood apron.
- 17-1/4" chimney can be trimmed to desired height and is shipped unattached.
- Lead-time 5 days unfinished, add 7 days for finishing.
- Fixed panel standard. Removable top not available.
- Ventilators available through Stanisci Design.
- **Custom sizes not available.**

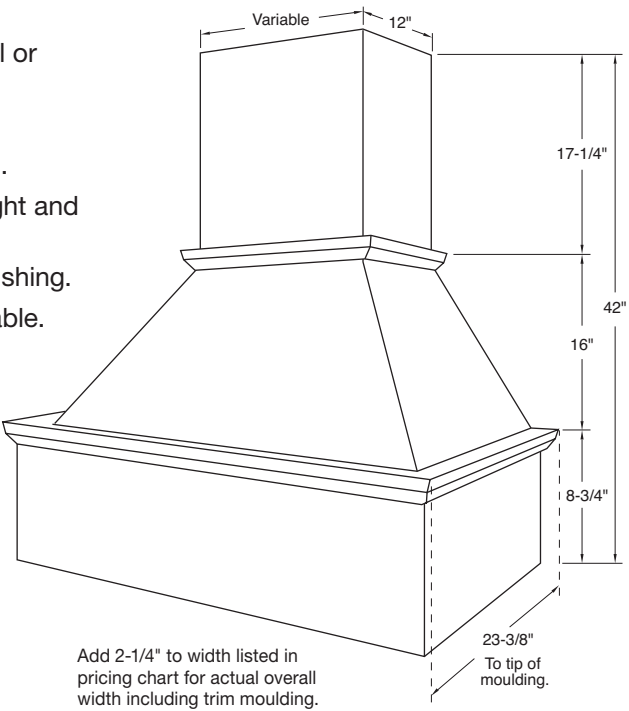

Specie	Part Number			
	SV-30x42	SV-36x42	SV-42x42	SV-48x42
Alder				
Cherry				
Hard Maple				
Red Oak				

VCHIM Series Hood – Arched Valance

- Stylish arched valance complements traditional and transitional designs.
- Arched valance has Regular bead, G-Cove Raise - no options.
- Designed to fit up to a 9 foot ceiling.
- 17-1/4" plywood chimney can be trimmed to desired height and is shipped unattached.
- Lead-time 5 days unfinished, add 7 days for finishing.
- Fixed panel standard. Removable top not available.
- Ventilators available through Stanisci Design.
- **Custom sizes not available.**

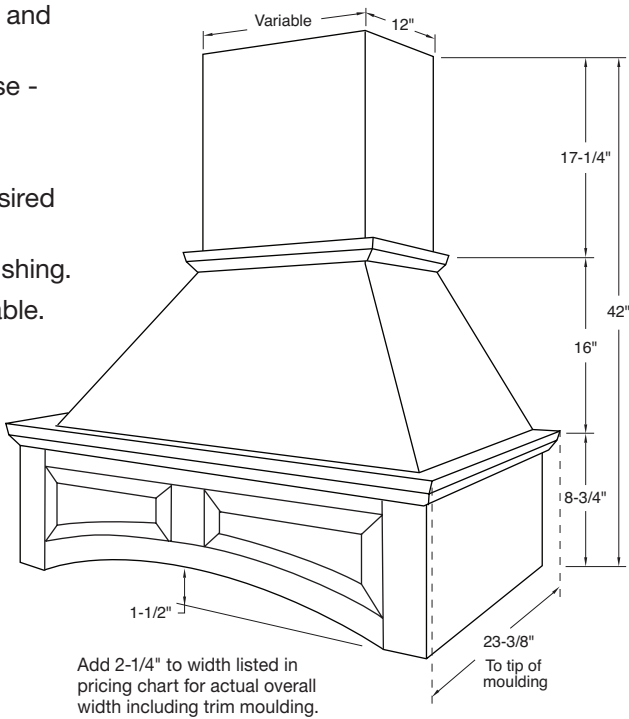

Specie	Part Number			
	AV-30x42	AV-36x42	AV-42x42	AV-48x42
Alder				
Cherry				
Hard Maple				
Red Oak				

Stanisci Design Range Hoods (continued)

VCHIM Series Hood – Two Panel Straight Valance

- Stylish straight valance complements transitional or traditional designs.
- Two panel straight valance has Square bead, flat panel - no options.
- Designed to fit up to a 9 foot ceiling.
- 17-1/4" plywood chimney can be trimmed to desired height and is shipped unattached.
- Lead-time 5 days unfinished, add 7 days for finishing.
- Fixed panel standard. Removable top not available.
- Ventilators available through Stanisci Design.
- **Custom sizes not available.**

Specie	Part Number			
	VRS-30x42	VRS-36x42	VRS-42x42	VRS-48x42
Alder				
Cherry				
Hard Maple				
Red Oak				

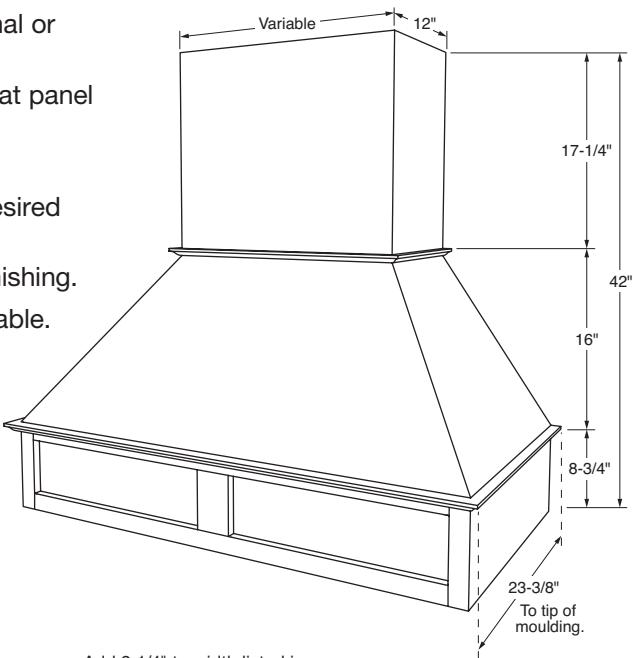

Add 2-1/4" to width listed in pricing chart for actual overall width including trim moulding.

Stanisci Design Range Hoods (continued)

BX-Standard Hood

- BX-Series is a contemporary or transitional hood.
- Horizontal grain only.
- Lead-time 10 days unfinished, add 7 days for finishing.
- Fixed panel only.
- Moulding package not available.
- Standard sizes: 30", 36", 42", 48", 54" and 60" widths; 24", 30", 36" and 42" heights.
- **Custom sizes available through Special Designs.**

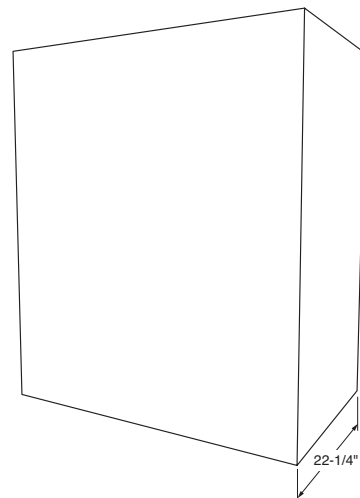

Specie	Part Number											
	BX-30x24	BX-42x24	BX-30x30	BX-36x30	BX-42x30	BX-30x36	BX-36x36	BX-42x36	BX-48x36	BX-42x42	BX-48x42	BX-54x42
Alder, Cherry												
Hard Maple												
PGHM Hybrid												
Red Oak												
Walnut												
Q.S. White Oak												

BXB-Horizontal Beading Hood

- BX-Series is a shiplap hood.
- Horizontal grain only with shiplap style beading.
- Width face of shiplap moulding varies by hood height.
- Lead-time 10 days unfinished, add 7 days for finishing.
- Fixed panel only.
- Moulding package not available.
- Standard sizes: 30", 36", 42", 48", 54" and 60" widths; 24", 30", 36" and 42" heights.
- **Custom sizes available through Special Designs.**

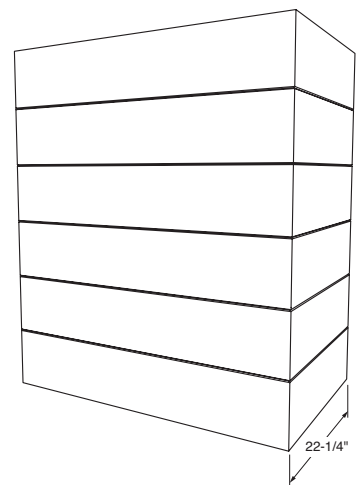

Specie	Part Number											
	BXB-30x24	BXB-42x24	BXB-30x30	BXB-36x30	BXB-42x30	BXB-30x36	BXB-36x36	BXB-42x36	BXB-48x36	BXB-42x42	BXB-48x42	BXB-54x42
Alder, Cherry												
Hard Maple												
PGHM Hybrid												
Red Oak												
Walnut												
Q.S. White Oak												

Stanisci Design Range Hoods (continued)

CHW-Standard Hood

- CHW-Series is a contemporary or transitional hood.
- Horizontal grain panel and valance only.
- 6" hardwood valance in matching specie only.
- Lead-time 10 days unfinished, add 7 days for finishing.
- Fixed panel standard. Removable top optional.
- Moulding package not available.
- Standard sizes: 30", 36", 42", 48", 54" and 60" widths; 24", 30", 36", 48" and 54" heights.
- **Custom sizes available through Special Designs.**

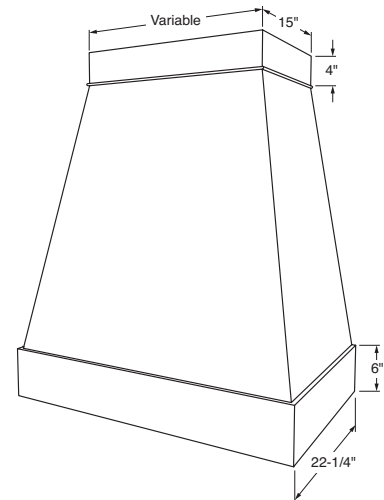

Specie	Part Number											
	CHW-30x24	CHW-42x24	CHW-30x30	CHW-36x30	CHW-42x30	CHW-30x36	CHW-36x36	CHW-42x36	CHW-48x36	CHW-42x42	CHW-48x42	CHW-54x42
Alder, Cherry												
Hard Maple												
PGHM Hybrid												
Red Oak												
Walnut												
Q.S. White Oak												

CHWB-Horizontal Beading

- CHWB-Series is a shiplap style hood.
- Horizontal grain only with shiplap style beading.
- 6" hardwood valance in matching specie only.
- Width face of shiplap moulding varies by hood height.
- Lead-time 10 days unfinished, add 7 days for finishing.
- Fixed panel standard. Removable top optional.
- Moulding package not available.
- Standard sizes: 30", 36", 42", 48", 54" and 60" widths; 24", 30", 36", 48" and 54" heights.
- **Custom sizes available through Special Designs.**

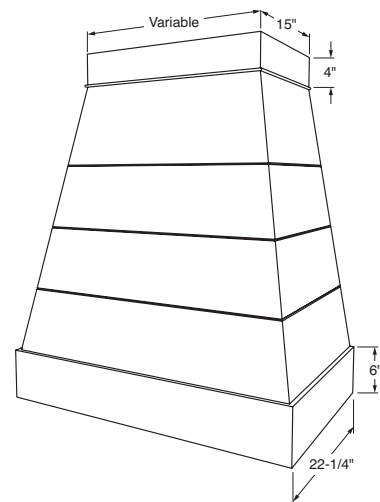

Specie	Part Number											
	CHWB-30x24	CHWB-42x24	CHWB-30x30	CHWB-36x30	CHWB-42x30	CHWB-30x36	CHWB-36x36	CHWB-42x36	CHWB-48x36	CHWB-42x42	CHWB-48x42	CHWB-54x42
Alder, Cherry												
Hard Maple												
PGHM Hybrid												
Red Oak												
Walnut												
Q.S. White Oak												

Stanisci Design Range Hoods (continued)

G-Standard Hood

- G-Series is designed to best fit 8 foot ceilings.
- Removable chimney may be trimmed to desired height.
- Lead-time 10 days unfinished, add 7 days for finishing.
- Fixed panel standard. Removable top optional.
- **Custom sizes available through Special Designs.**

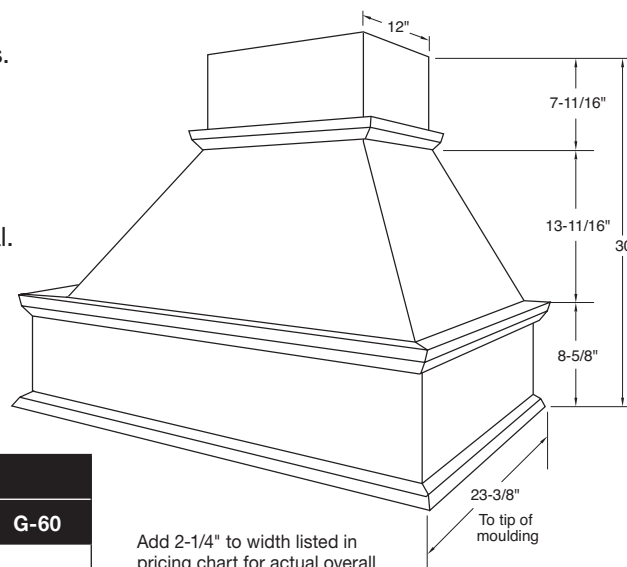

Specie	Part Number				
	G-36	G-42	G-48	G-54	G-60
Alder, Cherry					
Hard Maple, Red Oak					
PGHM Hybrid					
Walnut					
Q.S. White Oak					

G-Raised Arch Hood

- G-Raised Arch Series is designed to best fit 8 foot ceilings.
- Profile options –
Framing Bead: Regular, Elite, Ogee, Square or F-1223.
Panel Raise: Slant, G-Cove, RM, M-Bead or P-057.
- Removable chimney may be trimmed to desired height.
- Lead-time 10 days unfinished, add 7 days for finishing.
- Fixed panel standard. Removable top optional.
- **Custom sizes available through Special Designs.**

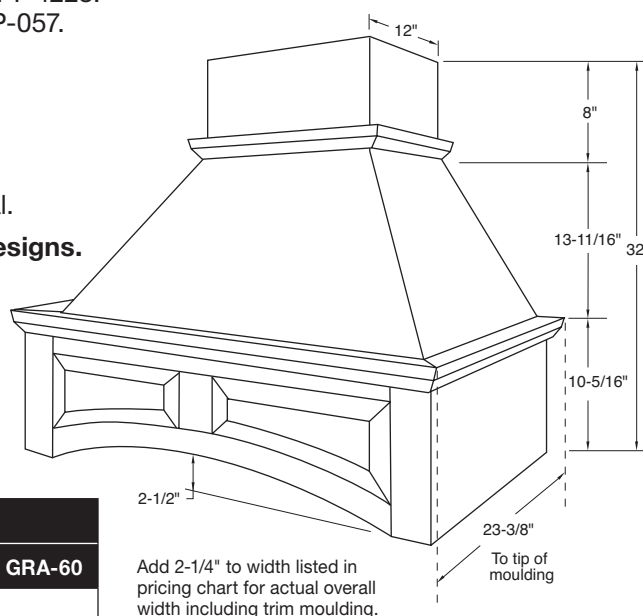

Specie	Part Number				
	GRA-36	GRA-42	GRA-48	GRA-54	GRA-60
Alder, Cherry					
Hard Maple, Red Oak					
PGHM Hybrid					
Walnut					
Q.S. White Oak					

Stanisci Design Range Hoods (continued)

T-Standard Hood

- T-Series is designed to best fit 9 foot ceilings and taller.
- Removable chimney may be trimmed to desired height.
- Lead-time 10 days unfinished, add 7 days for finishing.
- Fixed panel standard. Removable top optional.
- **Custom sizes available through Special Designs.**

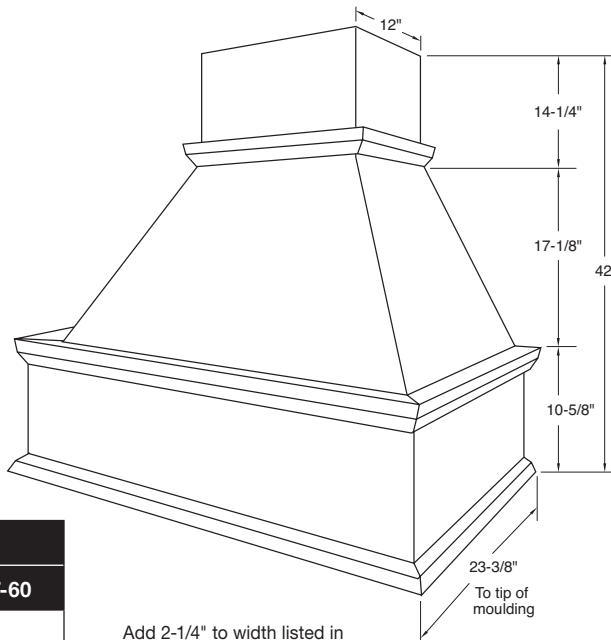

Specie	Part Number				
	T-36	T-42	T-48	T-54	T-60
Alder, Cherry					
Hard Maple, Red Oak					
PGHM Hybrid					
Walnut					
Q.S. White Oak					

T-Raised Arch Hood

- T-Raised Arch Series is designed to best fit 9 foot ceilings and taller.
- Profile options – Framing Bead: Regular, Elite, Ogee, Square or F-1223. Panel Raise: Slant, G-Cove, RM, M-Bead or P-057.
- Removable chimney may be trimmed to desired height.
- Lead-time 10 days unfinished, add 7 days for finishing.
- Fixed panel standard. Removable top optional.
- **Custom sizes available through Special Designs.**

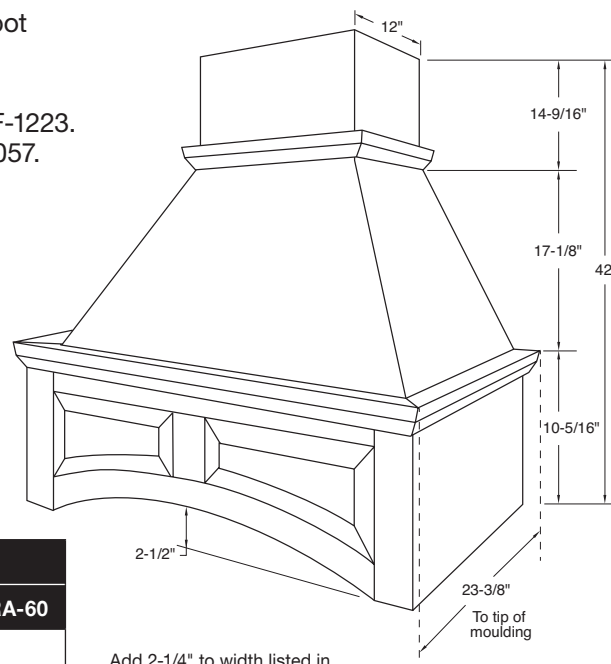

Specie	Part Number				
	TRA-36	TRA-42	TRA-48	TRA-54	TRA-60
Alder, Cherry					
Hard Maple, Red Oak					
PGHM Hybrid					
Walnut					
Q.S. White Oak					

Stanisci Design Range Hoods (continued)

M-Series Hood w/Display Shelf

- Will accommodate corbels up to 5" wide, 10-1/2" high and 6" deep under display shelf. See the Wood Accents and Ornament pages in Section 12 or the Art for Everyday catalog on the CBP for potential corbel selections.
- Profile options –
Framing Bead: Regular, Elite, Ogee, Square or F-1223.
Panel Raise: Slant, G-Cove, RM, M-Bead or P-057.
- Hood includes 6-3/4" deep display shelf, shipped unattached.
- Lead-time 10 days unfinished, add 7 days for finishing.
- Removable panel only. Fixed top rail standard.
- Standard sizes: 30", 36", 42", 48", 54" and 60" widths; 24", 30", 36", 42" and 48" heights.
- **Custom sizes available through Special Designs.**

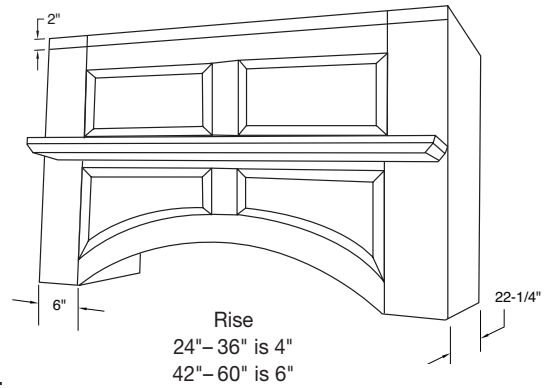

Specie	Part Number									
	M-30x24	M-36x24	M-42x24	M-48x24	M-54x24	M-60x24	M-30x30	M-36x30	M-42x30	M-48x30
Alder, Cherry										
Hard Maple										
PGHM Hybrid										
Red Oak										
Walnut										
Q.S. White Oak										
Specie	M-54x30	M-60x30	M-30x36	M-36x36	M-42x36	M-48x36	M-54x36	M-60x36	M-30x42	M-36x42
Alder, Cherry										
Hard Maple										
PGHM Hybrid										
Red Oak										
Walnut										
Q.S. White Oak										
Specie	M-42x42	M-48x42	M-54x42	M-60x42	M-30x48	M-36x48	M-42x48	M-48x48	M-54x48	M-60x48
Alder, Cherry										
Hard Maple										
PGHM Hybrid										
Red Oak										
Walnut										
Q.S. White Oak										

Stanisci Design Range Hoods (continued)

Q-Standard Hood w/Display Shelf

- Valance/mantle style hood is designed to be mounted between left and right cabinets.
- Profile options –
Framing Bead: Regular, Elite, Ogee, Square or F-1223.
Panel Raise: Slant, G-Cove, RM, M-Bead or P-057.
- Hood includes attached shelf and shelf supports.
- Lead-time 10 days unfinished, add 7 days for finishing.
- Removable panel only. Fixed top rail standard.
- Standard sizes: 30", 36", 42", 48", 54" and 60" widths;
24", 30", 36", 42" and 48" heights.
- **Custom sizes available through Special Designs.**

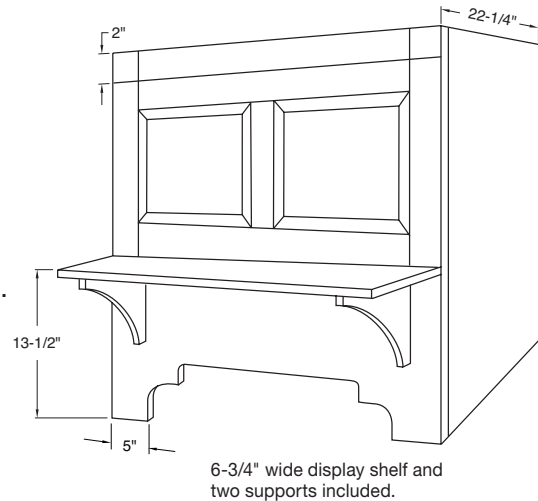

Specie	Part Number											
	Q-36x24	Q-42x24	Q-30x30	Q-36x30	Q-42x30	Q-48x30	Q-36x36	Q-42x36	Q-48x36	Q-36x42	Q-42x42	Q-54x42
Alder, Cherry												
Hard Maple												
PGHM Hybrid												
Red Oak												
Walnut												
Q.S. White Oak												

J-Raised Arch Hood

- J-Raised Arch is designed to be mounted between left and right cabinets.
- Hood can be sized to best fit 8 or 9 foot ceilings.
- Profile options –
Framing Bead: Regular, Elite, Ogee, Square or F-1223.
Panel Raise: Slant, G-Cove, RM, M-Bead or P-057.
- Lead-time 10 days unfinished, add 7 days for finishing.
- Fixed panel standard. Removable front optional (rear box increases 14").
- Standard sizes: 33", 39", 45", 51", 57" and 63" widths;
30", 36" and 42" heights.
- **Custom sizes available through Special Designs.**

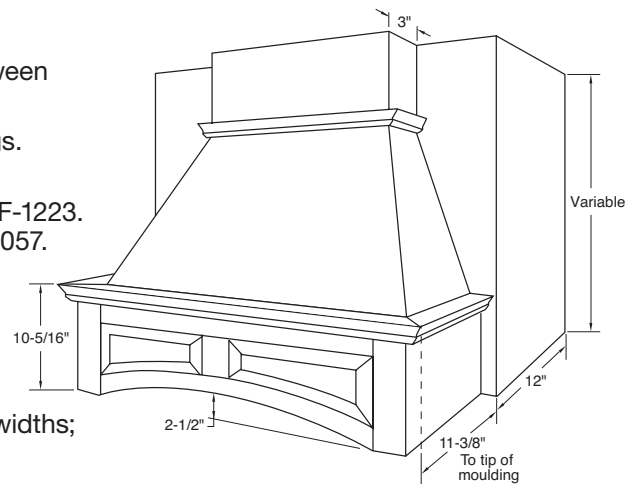

Specie	Part Number											
	JRA-33x30	JRA-39x30	JRA-45x30	JRA-51x30	JRA-57x30	JRA-63x30	JRA-33x36	JRA-39x36	JRA-45x36	JRA-51x36	JRA-57x36	JRA-63x36
Alder, Cherry												
Hard Maple												
PGHM Hybrid												
Red Oak												
Walnut												
Q.S. White Oak												

Stanisci Design Range Hoods (continued)

S-Raised Arch Hood w/Display Shelf

- Profile Options –
Framing Bead: Regular, Elite, Ogee, Square or F-1223.
Panel Raise: Slant, G-Cove, RM, M-Bead or P-057.
- Display shelf depth is 6-1/8" deep.
- Lead-time 10 days unfinished, add 7 days for finishing.
- Removable panel only.
- Standard sizes: 33", 39", 45", 51", 57" and 63" widths; 24", 30", 36" and 42" heights.
- **Custom sizes available through Special Designs.**

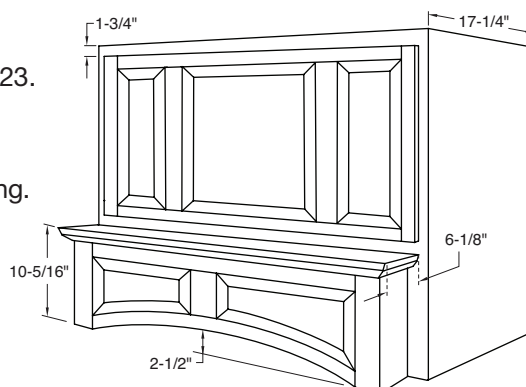

Specie	Part Number											
	SRA-39x24	SRA-45x24	SRA-51x24	SRA-39x30	SRA-45x30	SRA-51x30	SRA-39x36	SRA-45x36	SRA-51x36	SRA-39x42	SRA-45x42	SRA-51x42
Alder, Cherry												
Hard Maple												
PGHM Hybrid												
Red Oak												
Walnut												
Q.S. White Oak												

H-Raised Arch Hood w/Display Shelf

- Hearth style hood featuring incorporated display shelf.
- Profile options –
Framing Bead: Regular, Elite, Ogee, Square or F-1223.
Panel Raise: Slant, G-Cove, RM, M-Bead or P-057.
- Display shelf depth is 8-1/8" to tip of moulding.
- 54" and 60" wide hoods – have two top panels.
- 66" wide hoods have three panels on top wainscot.
- Accommodates corbels up to 9" wide, 10-1/2" high and 6-3/4" deep.
- Lead-time 10 days unfinished, add 7 days for finishing.
- Removable panel only. Fixed top rail standard.
- Standard sizes: 54", 60" and 66" widths; 44", 50" and 56" heights.
- **Custom sizes available through Special Designs.**

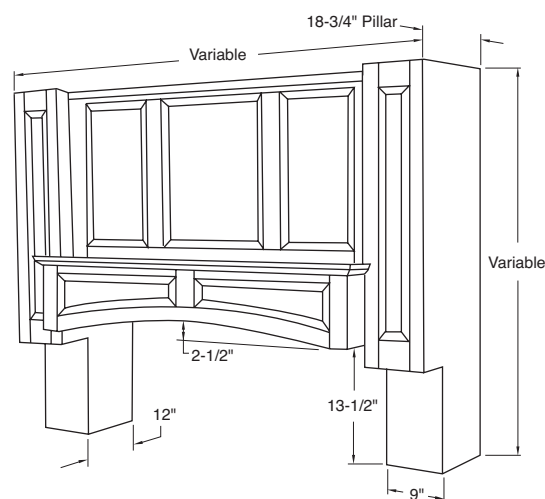

Specie	Part Number								
	HRA-54x44	HRA-60x44	HRA-66x44	HRA-54x50	HRA-60x50	HRA-66x50	HRA-54x56	HRA-60x56	HRA-66x56
Alder, Cherry									
Hard Maple									
PGHM Hybrid									
Red Oak									
Walnut									
Q.S. White Oak									

Stanisci Design Range Hoods (continued)

W-Raised Arch Hood w/Display Shelf

- Profile options –
Framing Bead: Regular, Elite, Ogee, Square or F-1223.
Panel Raise: Slant, G-Cove, RM, M-Bead or P-057.
- Specify full panel or small panel pillars. Small panel pillars can accommodate corbels up to 9" wide, 10-1/2" high and 6" deep.
- 30" clearance between bottom of pillars and bottom of arched panel.
- Display shelf depth is 8-1/8" deep.
- Ships in four pieces, ready to assemble.
- Spice Rack Pull-Out Option includes racks in both left and right pillars; \$900 upcharge applies.
- Spice rack dimensions: 26" high x 10-3/4" wide; upcharge applies.
- Lead-time 10 days unfinished, add 7 days for finishing.
- Removable panel only. Fixed top rail standard.
- Standard sizes: 66", 72", 84" and 90" widths; 60", 72" and 84" heights.
- Minimum width is 66".
- **Custom sizes available through Special Designs.**

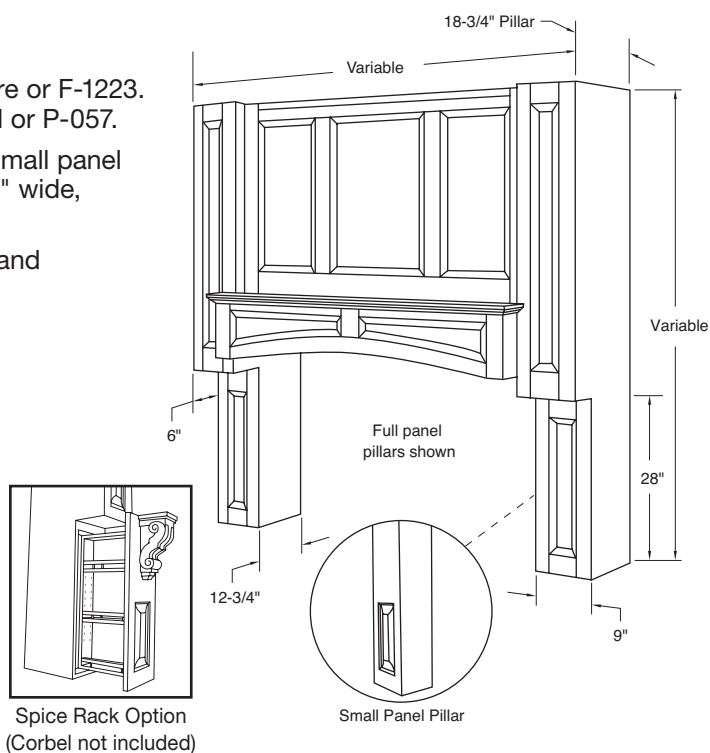

Specie	Part Number											
	WRA-66x60	WRA-72x60	WRA-84x60	WRA-90x60	WRA-66x72	WRA-72x72	WRA-84x72	WRA-90x72	WRA-66x84	WRA-72x84	WRA-84x84	WRA-90x84
Alder, Cherry												
Hard Maple												
PGHM Hybrid												
Red Oak												
Walnut												
Q.S. White Oak												

Stanisci Design Range Hoods (continued)

E-Standard Hood

- E-Series can be sized to fit 8 or 9 foot ceilings.
- E-Series hoods are not trimmable. Specific heights available through Special Designs.
- Lead-time 10 days unfinished, add 7 days for finishing.
- Fixed panel standard. Removable top optional.
- Standard sizes: 36", 42", 48", 54" and 60" widths; 30", 42" and 48" heights.
- **Custom sizes available through Special Designs.**

Specie	Part Number		
	E-36x30	E-42x30	E-54x30
Alder, Cherry			
Hard Maple			
PGHM Hybrid			
Red Oak			
Walnut			
Q.S. White Oak			
Specie	E-36x42	E-42x42	E-48x42
Alder, Cherry			
Hard Maple			
PGHM Hybrid			
Red Oak			
Walnut			
Q.S. White Oak			

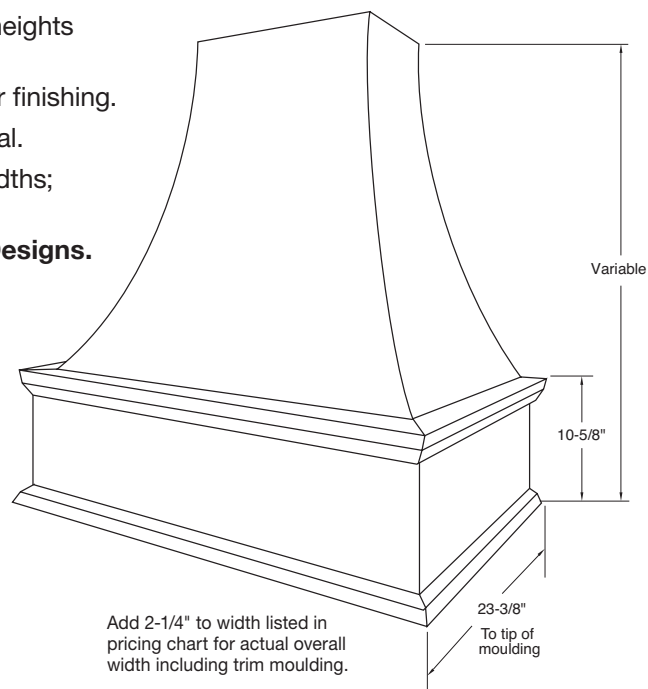

I-Series (Four-sided Island Hood)

- I-Series hood is designed to provide ventilation above an island range.
- Overall height must be provided when ordering I-series.
- Prefinished hoods will be finished on all 4 sides.
- Includes installation hardware.
- Lead-time 10 days unfinished, add 7 days for finishing.
- Fixed panel standard. Removable panel optional.
- **Custom sizes available through Special Designs.**

Specie	Part Number				
	I-36	I-42	I-48	I-54	I-60
Alder, Cherry					
Hard Maple					
PGHM Hybrid					
Red Oak					
Walnut					
Q.S. White Oak					

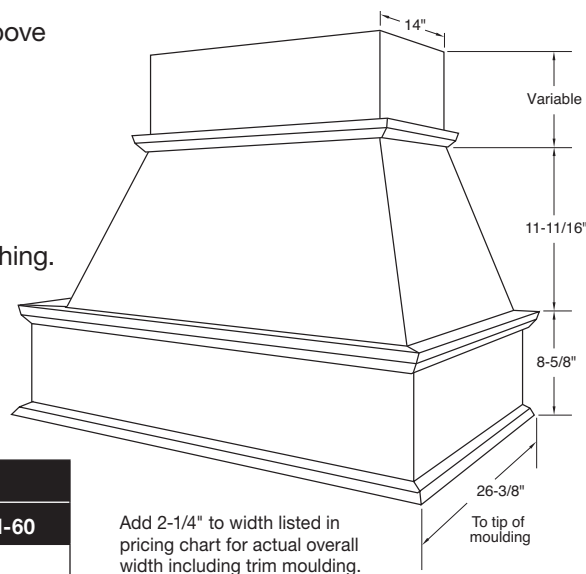

Stanisci Design Range Hoods (continued)

P-Series Hood

- P-Series is designed to be mounted to the wall and adjacent cabinets.
- Lead-time 10 days unfinished, add 7 days for finishing.
- Fixed panel standard. Removable front optional (rear box increases to 16").
- Available with Basic Moulding Package only.
- Standard sizes: 33", 39", 45", 51", 57" and 63" widths; 30", 36" and 42" heights.
- **Custom sizes available through Special Designs.**

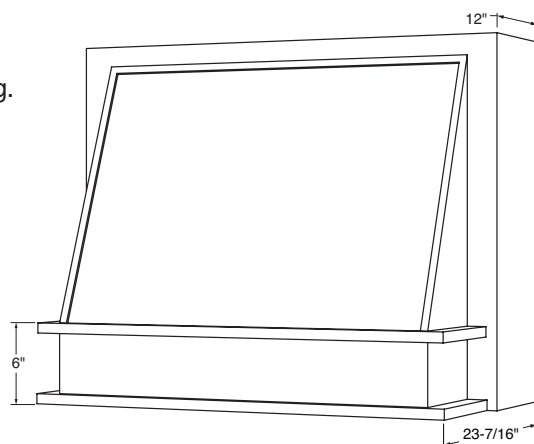

Specie	Part Number											
	P-39x30	P-45x30	P-57x30	P-33x36	P-39x36	P-45x36	P-51x36	P-57x36	P-33x42	P-45x42	P-51x42	P-63x42
Alder, Cherry												
Hard Maple												
PGHM Hybrid												
Red Oak												
Walnut												
Q.S. White Oak												

Z200

- Z200 series is a transitional hood designed to be mounted to the wall and adjacent cabinets.
- Lead-time 10 days unfinished, add 7 days for finishing.
- Fixed panel standard. Removable front optional (rear box increases to 16").
- Only available with Basic Moulding Package.
- Standard sizes: 33", 39", 45", 51", 57" and 63" widths; 30", 36" and 42" heights.
- **Custom sizes available through Special Designs.**

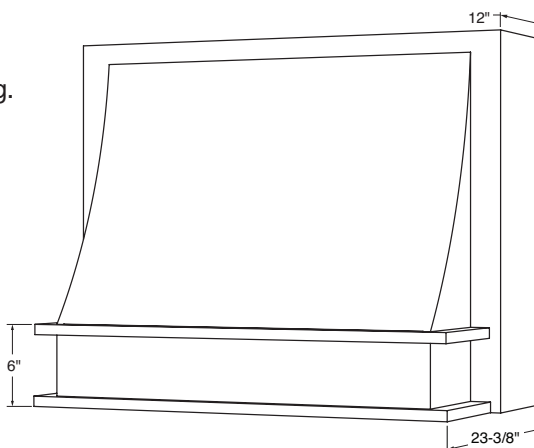

Specie	Part Number											
	Z200-39x30	Z200-45x30	Z200-57x30	Z200-33x36	Z200-39x36	Z200-45x36	Z200-51x36	Z200-57x36	Z200-33x42	Z200-45x42	Z200-51x42	Z200-63x42
Alder, Cherry												
Hard Maple												
PGHM Hybrid												
Red Oak												
Walnut												
Q.S. White Oak												

Stanisci Design Range Hoods (continued)

Z300

- Z300 series is a transitional hood designed to be mounted to the wall and adjacent cabinets.
- 6" apron can be detached for ease of finishing.
- Lead-time 10 days unfinished, add 7 days for finishing.
- Fixed panel only.
- Moulding Package not available.
- Standard sizes: 30", 36", 42", 48", 54" and 60" widths; 24", 30", 36" and 42" heights.
- **Custom sizes available through Special Designs.**

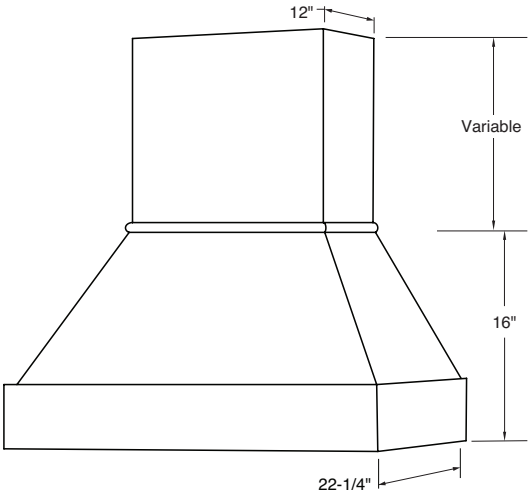

Specie	Part Number											
	Z300-36x24	Z300-42x24	Z300-36x30	Z300-42x30	Z300-48x30	Z300-48x36	Z300-60x36	Z300-36x42	Z300-42x42	Z300-48x42	Z300-54x42	Z300-60x42
Alder, Cherry												
Hard Maple												
PGHM Hybrid												
Red Oak												
Walnut												
Q.S. White Oak												

L2

- L2 Series is a transitional hood designed to be either mounted as stand-alone or between cabinets.
- Profile options –
Framing Bead: Regular, Elite, Ogee, Square or F-1223.
Panel Raise: Slant, G-Cove, RM, M-Bead or P-057.
- Lead-time 10 days unfinished, add 7 days for finishing.
- Removable panel only.
- Hoods with widths from 30"-48" will have two panels on top and two panels on the bottom. Hoods over 48" will have three panels on top and three panels on the bottom.
- Standard hood apron height is 6" with flat center panels or 8.75" with raised center panels.
- Standard sizes: 30", 36", 42", 48", 54" and 60" widths; 24", 30", 36" and 42" heights.
- **Custom sizes and panel configurations available through Special Designs.**

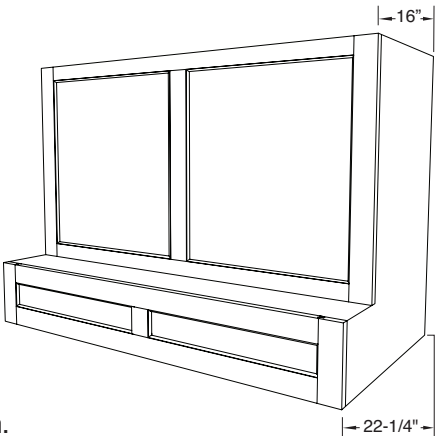

Specie	Part Number											
	L2-30x24	L2-42x24	L2-30x30	L2-36x30	L2-42x30	L2-30x36	L2-36x36	L2-42x36	L2-48x36	L2-42x42	L2-48x42	L2-54x42
Alder, Cherry												
Hard Maple												
PGHM Hybrid												
Red Oak												
Walnut												
Q.S. White Oak												

Stanisci Design Range Hoods (continued)

FX

- FX Series is a transitional hood designed to be either mounted as stand-alone or between cabinets.
- Profile options –
Framing Bead: Regular, Elite, Ogee, Square or F-1223.
Panel Raise: Slant, G-Cove, RM, M-Bead or P-057.
- Lead-time 10 days unfinished, add 7 days for finishing.
- Removable panel only.
- Hoods with widths from 30"-48" will have two panels on top and two panels on the bottom. Hoods over 48" will have three panels on top and three panels on the bottom.
- Standard hood apron height is 6" with flat center panels or 8.75" for raised center panels.
- Standard sizes: 30", 36", 42", 48", 54" and 60" widths; 24", 30", 36" and 42" heights.
- **Custom sizes and panel configurations available through Special Designs.**

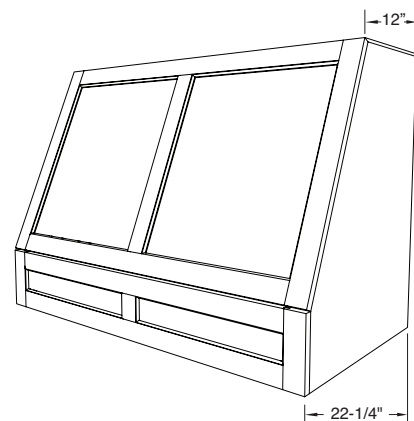

Specie	Part Number											
	FX-30x24	FX-42x24	FX-30x30	FX-36x30	FX-42x30	FX-30x36	FX-36x36	FX-42x36	FX-48x36	FX-42x42	FX-48x42	FX-54x42
Alder, Cherry												
Hard Maple												
PGHM Hybrid												
Red Oak												
Walnut												
Q.S. White Oak												