

Custom Dovetail Drawer Boxes

- Conestoga's Drawer Box program offers multiple wood specie selections and custom options. Information about dovetail drawer boxes and related options are found on the following pages.
- Dovetail drawer boxes are fully assembled; Hard Maple, Soft Maple and Walnut can be ordered unfinished or finished; Natural Birch drawer boxes are only available finished. See finishing information contained in this section.
- Natural Birch, Hard Maple, Soft Maple and Walnut drawer box options and accessories have a 7 day standard lead-time, and a 2 day Code Red expedite lead-time; add 2 days for finishing. All other non-published drawer box species, add 5 additional days.

Custom Dovetail Drawer Box Specifications

The following species are available for the 5/8" Custom Dovetail Drawer Box program:

- Hard Maple and Soft Maple boxes are constructed with solid Maple sides, fronts and backs and 1/4" or 3/8" thick Maple veneer (wood composite core) bottom.
- Natural Birch drawer boxes are constructed with solid Birch sides, fronts, backs and 1/4" or 3/8" thick Birch veneer face and sound back plywood bottom.
- Walnut boxes are constructed with solid Walnut sides, fronts, backs and Walnut 1/4" or 3/8" thick veneer plywood bottom.
- Two finishing options are available with custom drawer boxes.
 - ◆ Standard finish on all program species is a durable, low emission UV topcoat.
 - ◆ Hand sprayed, catalyzed conversion varnish is available at an additional upcharge on Hard Maple, Soft Maple and Walnut drawer boxes.
- Both finish options have a 15° sheen topcoat. See Additional Options and Pricing Chart.
- Natural Birch drawer boxes are also available with unsanded/unfinished dovetails as a cost savings. Sides, backs and bottoms have a clear UV finish. Unfinished dovetails not available on Hard Maple, Soft Maple or Walnut when finishing option is selected.

To determine the list price of a Dovetail Drawer Box:

- Multiply the perimeter of the box in linear inches (2 x [width + depth]) by the appropriate height/specie price.
- Add the mandatory assembly charge per box. All drawer boxes are assembled.
- Add the price of all selected options.
- A minimum of 50 linear inches applies.

Dovetail Drawer Box Size Parameters			
Description	Minimum	Maximum	Increments
Height	2"	12"	1/2"
Width	3"	46"	1/16"
Depth	3"	31"	1/16"

*1/8" added to accomodate 3/8" bottoms.

Dovetail Drawer Box Pricing

Drawer Box Height, 1/4" Bottom						
Specie	2" – 3"	3-1/2" – 4"	4-1/2" – 6"	6-1/2" – 8"	8-1/2" – 10"	10-1/2" – 12"
Natural Birch, unfinished dovetails						
Natural Birch						
Maple, Hard						
Maple, Soft						
Walnut						
Drawer Box Height, 3/8" Bottom 1/8" added to accommodate 3/8" bottoms						
Specie	2-1/8" – 3-1/8"	3-5/8" – 4-1/8"	4-5/8" – 6-1/8"	6-5/8" – 8-1/8"	8-5/8" – 10-1/8"	10-5/8" – 12-1/8"
Natural Birch*						
Maple, Hard						
Maple, Soft*						
Walnut						

*Natural Birch and Soft Maple 3/8" drawer box bottoms utilize Hard Maple veneer with composite core.

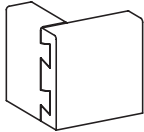
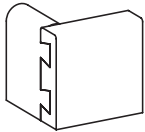
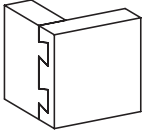
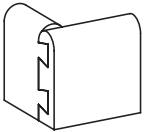
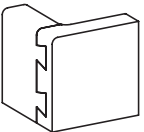
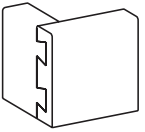
Additional Options and Pricing		
Bottom Thickness		
1/4"	Standard	See drawer box height charts for pricing
3/8"	Requires 1/8" to be added to the drawer box height	
No Bottom	Optional	No Upcharge
Bottom Reveal		
1/2"	Standard	No Upcharge
3/8"	Optional	
Finishing Options (clear topcoat only, per box)		
Standard UV finish		
100 linear inches or fewer per box		
Greater than 100 linear inches per box		
Hand spray finish (pricing per box in addition to standard finishing charges)		
Logo Burn		
Private label logo burn		Priced per box**
Top Edge Profiles (unfinished dovetail option not available)		
<div>    </div> <div>    </div>		

Reveal Detail

Reveal: 1/2" or 3/8"

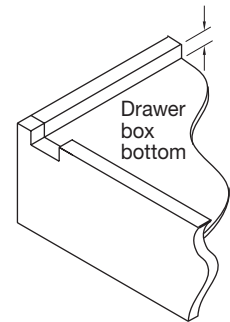

**Contact Customer Service for tooling requirements and costs.

Dovetail Drawer Box Options

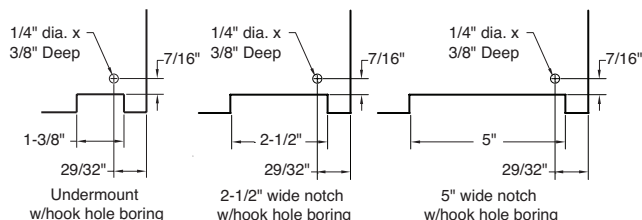
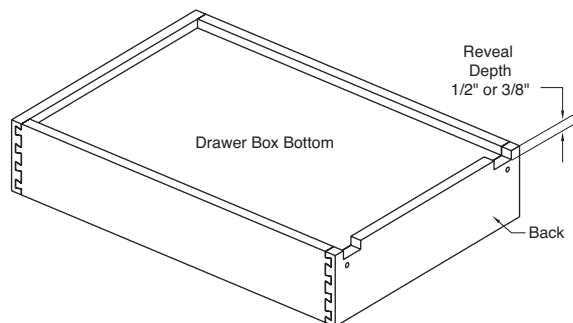

Undermount Notching Options

- Undermount notching only ($1-3/8"$).
- Undermount notching with hook ($1-3/8"$) hole boring (detail shown below).
- $2-1/2"$ wide undermount notching only.
- $2-1/2"$ wide undermount notching with hook hole boring (detail shown below).
- $5"$ wide undermount notching with hook hole boring (included standard).
- Minimum drawer box widths:
 - ♦ Standard notch: $6"$.
 - ♦ $2-1/2"$ and $5"$ notch: $11-1/4"$.

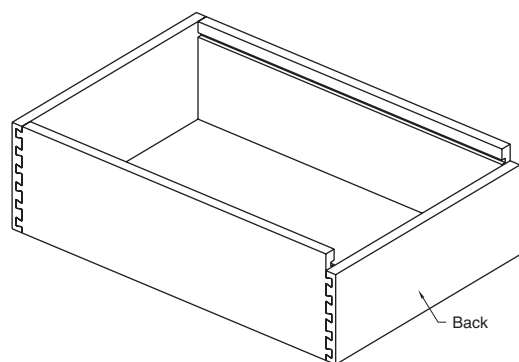

Bread Box Top Routing

- Designed for $1/8"$ or $1/4"$ thick lids.
- $9/32"$ deep groove on sides only.
- $1/8"$ rout is $5/32"$ wide.
- $1/4"$ rout is $9/32"$ wide.
- Minimum box height $4"$.
- **Lid not included.**

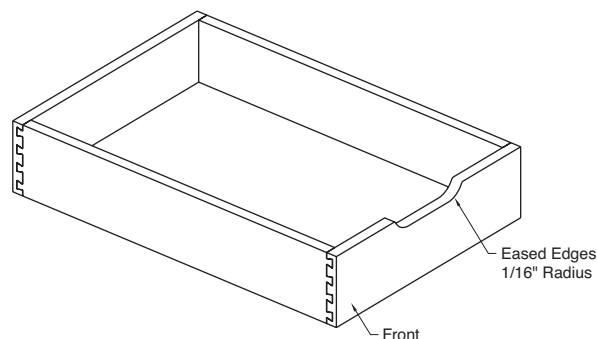

Hand Pull

- Minimum box width is $8"$.
- Hand pull is $5-1/4"$ wide and $11/16"$ deep, centered on front of drawer box.
- Unfinished dovetails not available.

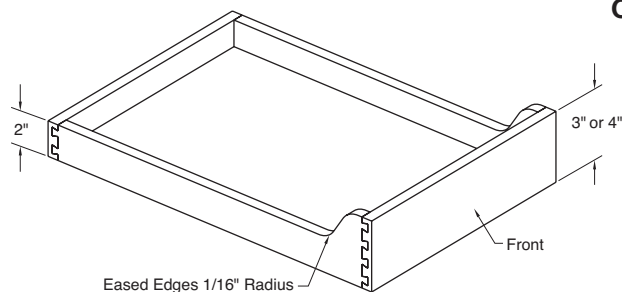

Cut-Down Sides

- Available for $3"$, $4"$ or $6"$ high drawer boxes only.
- Add $1/8"$ to box height dimensions when ordering $3/8"$ bottoms.
- Rear box height $2"$.
- Unfinished dovetails not available.

Dovetail Drawer Box Options (continued)

- Minimum box width 12".
- Minimum box height 2".
- Maximum box height 3-1/8".
- Unfinished dovetails not available.

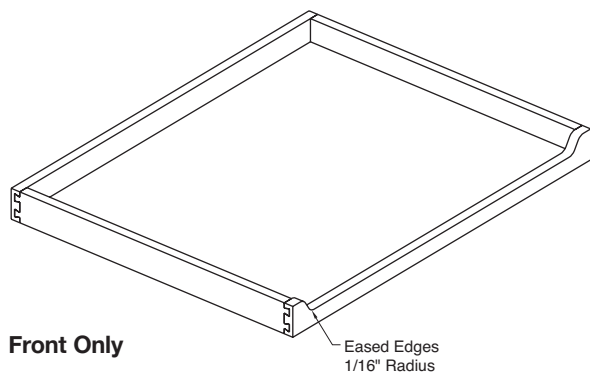

Front Only

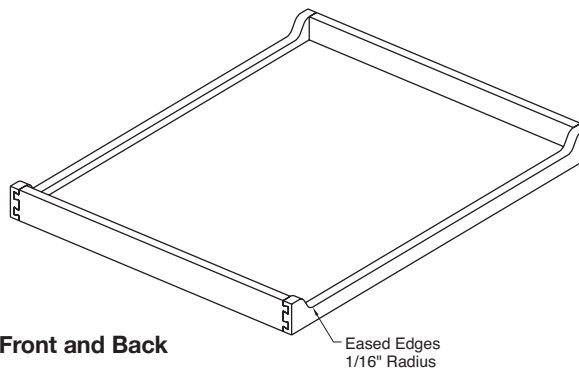

Front and Back

Blum TANDEM Clip Options

- Pre-drilling and installation options are for Blum TANDEM drawer hardware.
- Pre-drilled pilot holes are drilled at the proper angle and spacing to accept TANDEM clips.
- Minimum box width 5-1/2".
- 1/2" bottom reveal only.
- Undermount notching with hook hole boring are an option and must be specified.
- Blum TANDEM Clips feature side-to-side, height and depth adjustment for fine tuning drawer front alignment. Loose clips not available.

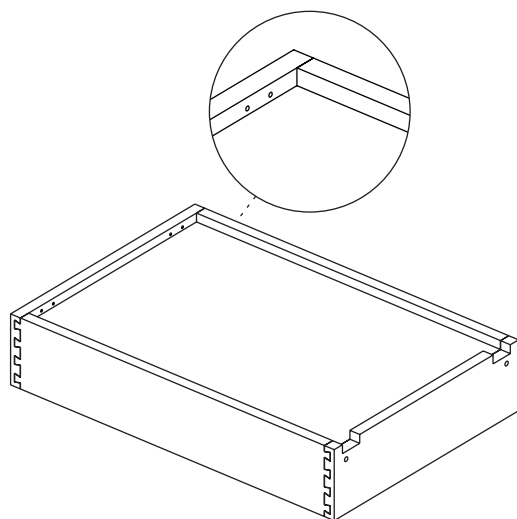

Blum TANDEM Clips Pre-drilled

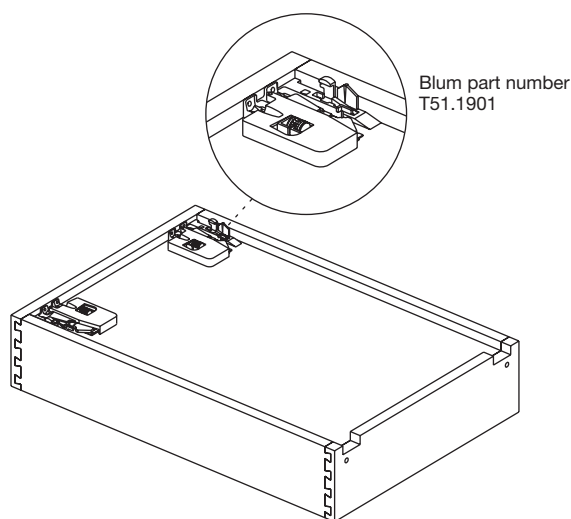

Blum TANDEM Clips Installed

Dovetail Drawer Box Options (continued)

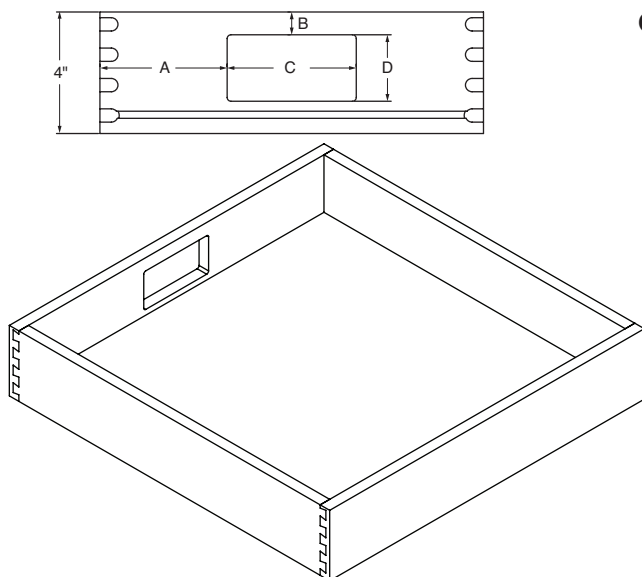

Charging Station Rout

- Customizable rout is designed to accommodate charging station and drawer mounted receptacle devices (rout only – charging device not included).
- Rout is always in the back of the drawer box; no options.
- Minimum drawer box width is 12", minimum box height is 4".
- Must specify A, B, C and D dimensions. Use Form #6-A – Specialty Drawer Box Order Form.
- Charging rout can be centered or off-set from either side.
- Minimum dimensions for Charging Station Rout:
 - ♦ Dimension A is 1".
 - ♦ Dimension B is 1/2".
 - ♦ Dimension C is Drawer Box width minus 2".
 - ♦ Dimension D is Drawer Box height minus 1-1/2".
- Not available with unfinished dovetail option.

Dovetail Drawer Box Options (continued)

Roll Out Drawer Front Option

- Drawer box front is 1" wider than the overall ordered box width.
- Minimum box width is 8".

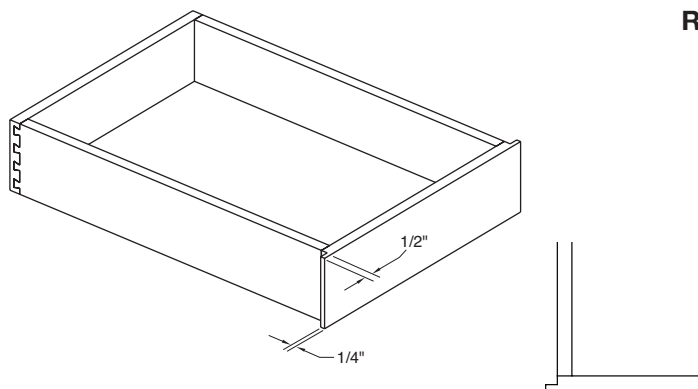

Visible Storage Unit Routing

- Minimum box width is 12".
- Maximum box width is 24".
- Minimum box height is 7".
- Removable divider included. Located 1-1/2" behind front of drawer box.

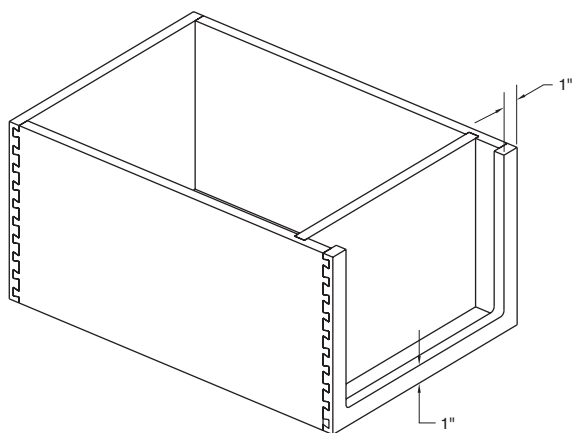

Back Recessed Option

- Minimum drawer box width is 12".
- Minimum depth is 8-1/4".
- Must specify A, B and C dimensions.
- Recess can be centered or off-set from either side.
 - ♦ Minimum dimension for A and B is 4".
 - ♦ Minimum dimension for C is 3-5/8".

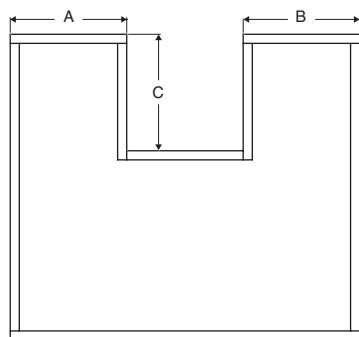
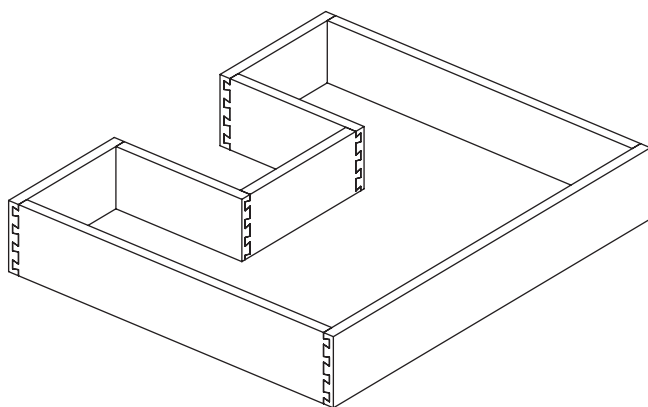

Custom Drawer Accessories

Cutlery Dividers

- Available in Hard Maple, Natural Birch and Walnut.
- All cutlery divider designs are constructed with a 1/4" bottom unless "No Bottom" is specified.
- When ordering specify design A, B, C, D, E, F, G or H.
- Specify depth and width in 1/16" increments. Both dimensions are measured from outside edge to outside edge.
- Depth for all designs must be between 16" to 22". Refer to specific design for width range.
- When ordered with a drawer box, cutlery dividers are sized 1-5/16" less than the exterior width and depth of the overall drawer box size.
- To order a custom size cutlery divider, specify the depth, width and design as a separate line item on the order form.
- Standard height is 3-1/8". Height modifications available; see following pages for options and pricing.
- Finishing Option charge:

Design A:

Natural Birch
Hard Maple
Walnut

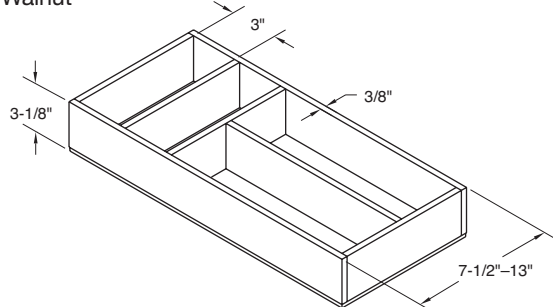

Design C:

Natural Birch
Hard Maple
Walnut

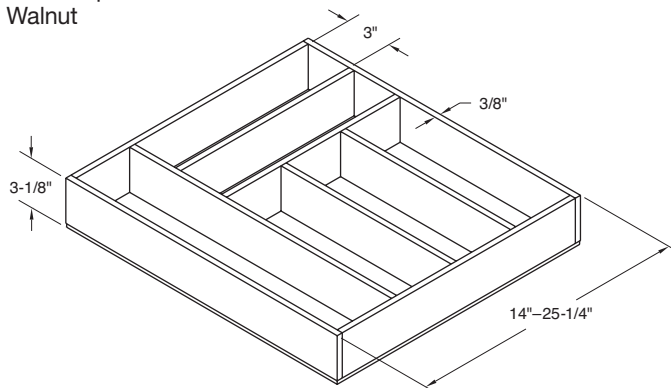

Design B:

Natural Birch
Hard Maple
Walnut

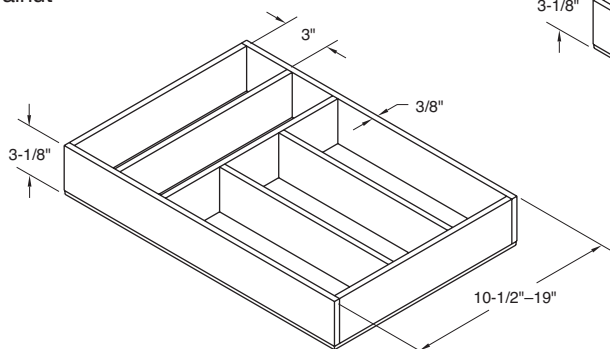

Design D:

Natural Birch \$
Hard Maple
Walnut

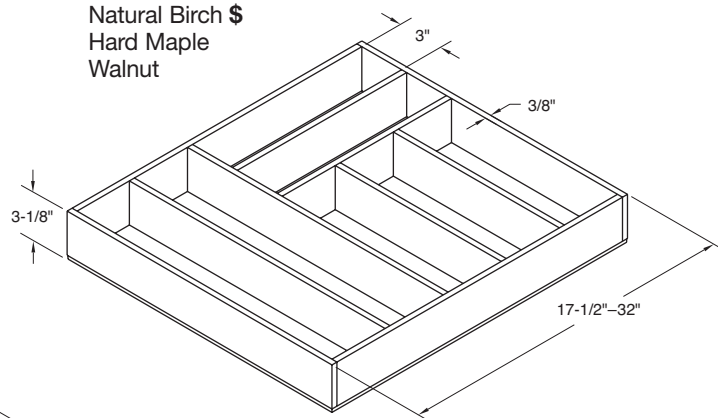

Custom Drawer Accessories (continued)

Design E:

Natural Birch
Hard Maple
Walnut

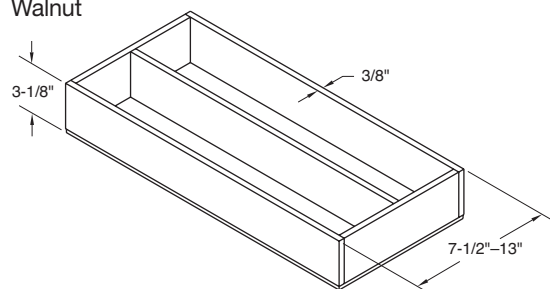

Design G:

Natural Birch
Hard Maple
Walnut

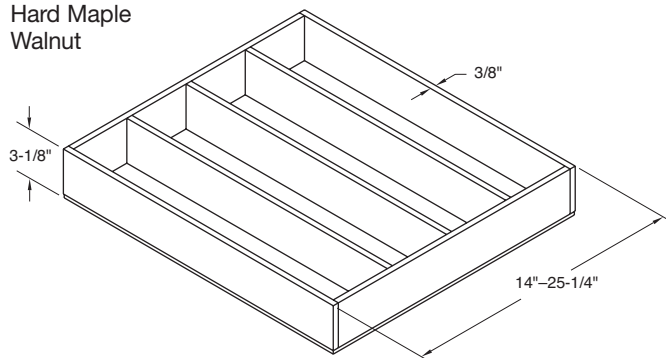

Design F:

Natural Birch
Hard Maple
Walnut

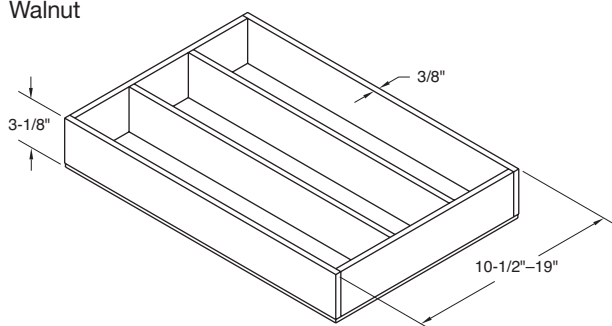

Design H:

Natural Birch
Hard Maple
Walnut

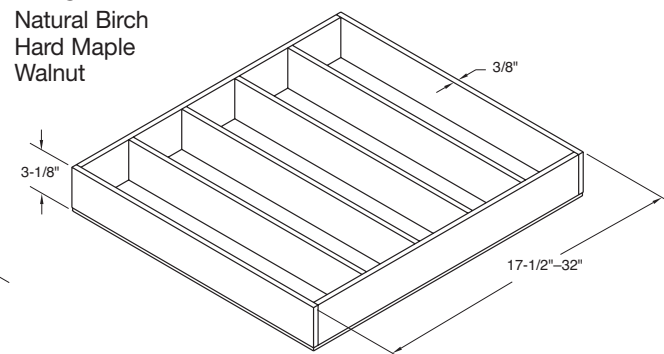

No Bottom Option

- No upcharge.
 - ♦ All cutlery divider designs are constructed with a 1/4" bottom unless "NO BOTTOM" is specified.
 - ♦ Maximum height of cutlery dividers with no bottom is 2-7/8".

Reduced Height Option

- Upcharge applied.
 - ♦ All divider designs can be reduced in height for specialty applications.
 - ♦ Specify divider height when ordering.
 - ♦ Minimum divider height with bottom is 1-5/8".
 - ♦ Minimum divider height without bottom is 1-3/8".

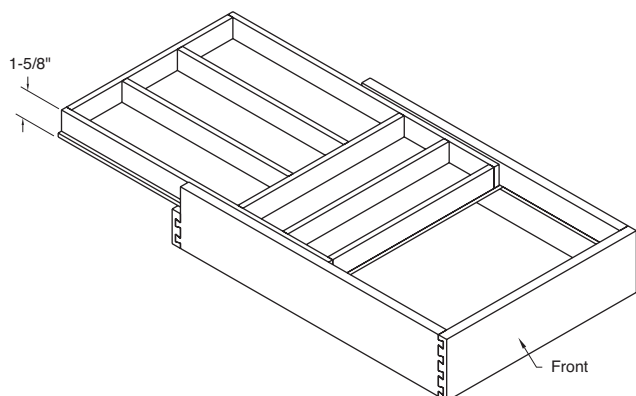

Sliding Cutlery Divider

- Divider Design Charge.
 - ♦ Available with all divider configurations; specify design when ordering.
 - ♦ Top divider is 1-3/8" high mounted on a 1/4" base.
 - ♦ Recommended maximum drawer box width is 24" to ensure proper operation.

Custom Drawer Accessories (continued)



Fineline Cutlery Dividers

- Unique, tapered divider design affords sturdy compartment divisions with pleasing minimal profile.
- Available in Natural Birch or Walnut with a clear finish.
- Unit size prior to trimming is 1-15/16" high x 20-13/16" long. Standard widths shown in the pricing chart below.
- Base plate is designed to be trimmed to fit the interior dimensions of a specific drawer box.
- Each unit includes a trimmable depth extender for a truly custom fit and maximum storage.
- Optional knife block can be incorporated into cutlery units for maximum utensil storage.
 - ♦ Knife block measures 5-7/16" wide x 16-11/16" deep and accommodates 5 pieces of cutlery.
- **Cut-to-size Option**
 - ♦ All Fineline dividers can be cut to fit inside a drawer box. Specify interior dimensions of drawer box.
 - ♦ Dividers will be packaged independently of the drawer box.
 - ♦ Cut-to-Size Option:

Part No.	Description	Price
556.87.601	Fineline Cutlery Insert – Walnut – 15-9/16" wide	
556.87.602	Fineline Cutlery Insert – Walnut – 21-9/16" wide	
556.87.603	Fineline Cutlery Insert – Walnut – 27-5/8" wide	
556.87.604	Fineline Cutlery Insert – Walnut – 33-9/16" wide	
556.87.901	Fineline Cutlery Insert – Birch – 15-9/16" wide	
556.87.902	Fineline Cutlery Insert – Birch – 21-9/16" wide	
556.87.903	Fineline Cutlery Insert – Birch – 27-5/8" wide	
556.87.904	Fineline Cutlery Insert – Birch – 33-9/16" wide	

Part No.	Description	Price
556.91.640	Fineline Knife Block – Walnut – 5-7/16" wide x 16-11/16" long	
556.91.940	Fineline Knife Block – Birch – 5-7/16" wide x 16-11/16" long	

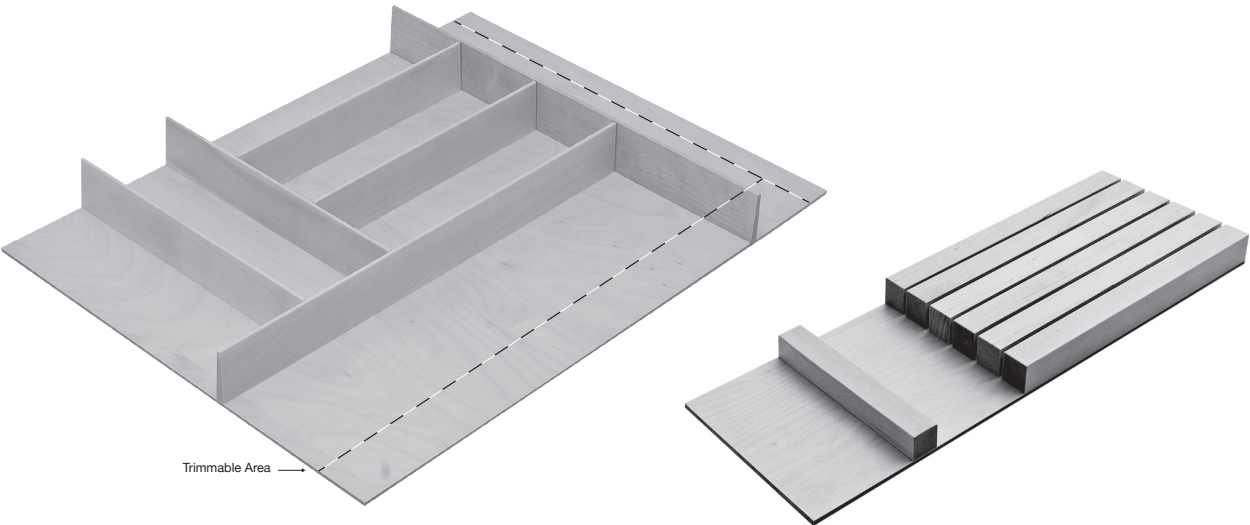

Custom Drawer Accessories (continued)

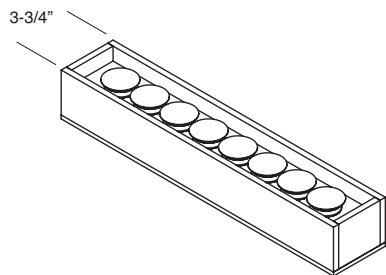

Single Insert Design:

Natural Birch
Hard Maple
Walnut

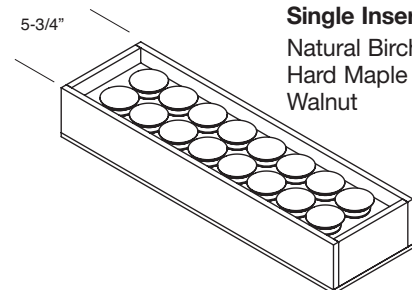

Double Insert Design:

Natural Birch
Hard Maple
Walnut

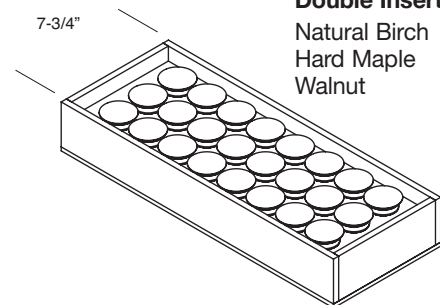

Triple Insert Design:

Natural Birch
Hard Maple
Walnut

Individual Serving Beverage Pod Drawer Inserts

- Available in Hard Maple, Natural Birch and Walnut.
- All inserts are constructed using 3/8" sides and ends, 1/4" bottom and 5/8" top storage panel.
- Height is 3-1/8". Width is fixed by design – no customization.
- Depth on all inserts is customizable between 16" and 22" in 1/16" increments.
- When ordered with a drawer box, inserts are sized 1-5/16" less than the exterior width and depth of the overall drawer box size.
- Inserts can be combined with any cutlery divider design to fully utilize entire drawer width. When this treatment is desired, specify the insert design as well as the divider design.
- Finishing Option charge.

Custom Drawer Accessories (continued)

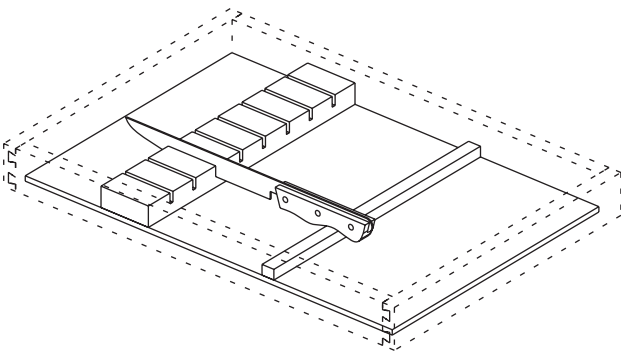

Knife Block Insert

Natural Birch
Hard Maple
Walnut

- Can be sized to fit a specific drawer box or ordered separately. If ordering separately, specify width and depth.
- Knife block and handle rest are unfinished mounted on a prefinished 1/4" bottom.
- Spacing is 1-1/4" between slots.
- Minimum insert: 7-1/2" wide x 16" deep.
- Maximum insert: 21" wide x 22" deep.

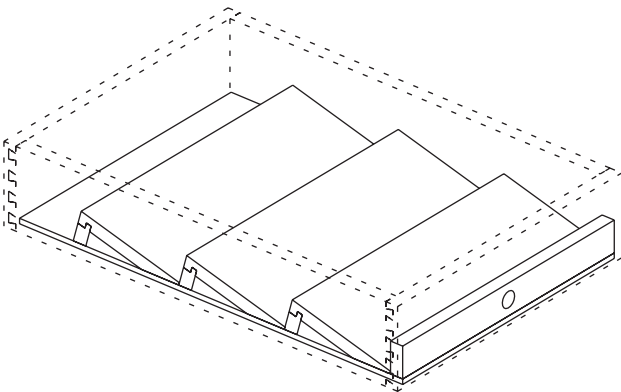

Spice Tray Insert

- Can be sized to fit a specific drawer box or ordered separately. If ordering separately, specify width and depth.
- 3/4" diameter finger hole centered on lead rail for ease of removal from drawer box.
- Spice rests are 5-1/4" wide, 1-1/2" high, mounted on a prefinished 1/4" bottom.
- Minimum insert: 7-1/2" wide x 17" deep.
- Maximum insert: 32" wide x 22" deep.

Spice Tray Insert Width			
Specie	7-1/2" – 15"	15-1/16" – 23"	23-1/16" – 32"
Natural Birch			
Maple, Hard			
Walnut			

Custom Drawer Accessories (continued)

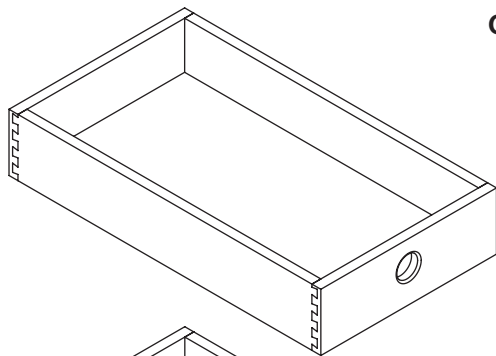

Circle Hand Pull

- Minimum box width 5-3/4", minimum height 4".
- Circle pull diameter is 1-1/2", placed 1" down from top edge and centered on the width of the front of the box.
- Front and back placement is optional and must be specified. Additional upcharge applies.
- Not available with unfinished dovetail option.

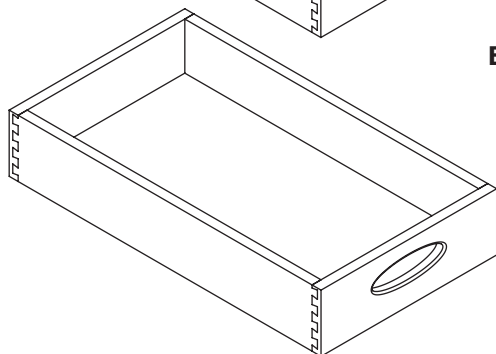

Ellipse Hand Pull

- Minimum box width 9", minimum height 4".
- Ellipse pull width is 5", placed 1" down from top edge and centered on the width of the front of the box.
- Front and back placement is optional and must be specified. Additional upcharge applies.
- Not available with unfinished dovetail option.

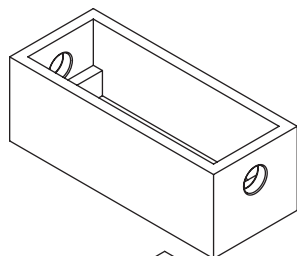

Single Set Design:

Natural Birch
Hard Maple
Walnut

Circle pull front/
back standard

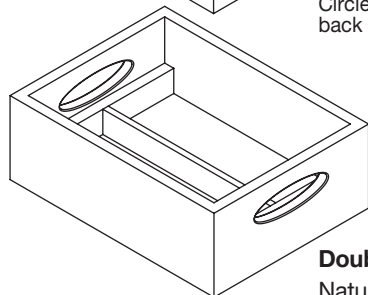

Double Set Design:

Natural Birch
Hard Maple
Walnut

Ellipse pull front/
back standard

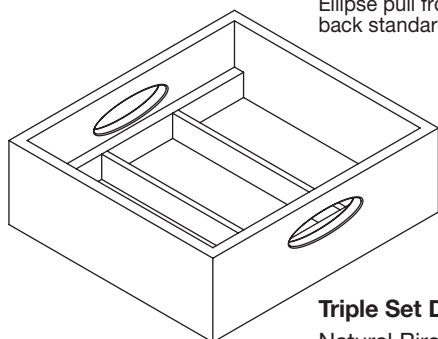

Triple Set Design:

Natural Birch
Hard Maple
Walnut

Ellipse pull front/
back standard

Finish Sample Chip Display Boxes

- Dovetailed drawer boxes with hand pulls and interior dividers accommodate Conestoga's standard size sample finish chips (3/8" thick x 4-3/8" wide x 6-1/8" high). Custom box sizing is also available to accommodate custom dimensioned chips.
- Finish sample chip sets must be ordered separately.
- Matching specie wooden spacers are installed in the front and back of each display box to allow easy indexing of samples.
- 5" high boxes standard.
- Sizing for standard Conestoga 26 piece chip sets:
 - ◆ Single set design: 5" high x 5-3/4" wide x 14" deep.
 - ◆ Double set design: 5" high x 10-5/8" wide x 14" deep.
 - ◆ Triple set design: 5" high x 15-1/2" wide x 14" deep.
- To accommodate 32 piece chip sets, depth for all designs should be ordered 16-5/8" deep.
- Sample box price follows drawer box specie per lineal inch Material Charge, assembly and finishing charges plus the Design Charges.
- To order customized Finish Sample Chip Display Boxes, follow these min./max. size guidelines:
 - ◆ Single set design: min. width 5-3/4", max. width 15", max. depth 21".
 - ◆ Double set design: min. width 10-5/8", max. width 24", max. depth 21".
 - ◆ Triple set design: min. width 15-1/2", max. width 31", max. depth 21".

Custom Drawer Accessories (continued)



Drawer Peg Storage System

- The Drawer Peg Storage System is designed to be installed in deep drawer boxes for stacked dishware storage.
- Each kit consists of a 5/8" thick Maple or Walnut plywood base plate with a durable clear UV finish and matching specie posts.
- Base plates are available in 3 sizes and can easily be trimmed to fit the interior dimensions of most drawer boxes.
- Base plates are pre-drilled with patterned holes to accept the press in solid wood posts.
- Matching specie posts are 6" in height.
- Drawer Front not included.

Base Plate Size	Posts Per Kit	Hard Maple		Walnut	
		Part No.	Price	Part No.	Price
5/8" x 24-1/4" x 21-1/4"	9	2103597		2103600	
5/8" x 30-1/4" x 21-1/4"	12	2103598		2103601	
5/8" x 39-1/4" x 21-1/4"	16	2103599		2103602	

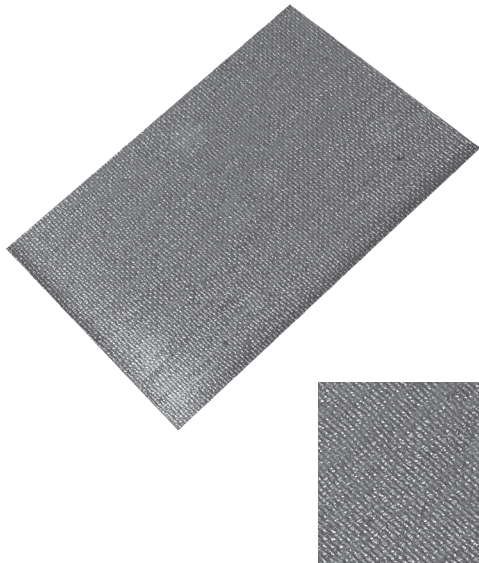

Non-Slip Drawer Liners

- Non-Slip Drawer Liners are the perfect anti-slip material to keep utensils in place as drawers are opened and closed.
- The liner face is a non-slip rubber surface applied over a polystyrene backer to deaden sound and protect your drawer bottoms against drips and minor spills.
- The attractive grey fiber pattern looks great with Birch, Maple, Walnut and metal drawer boxes.
- Available in sheet form, these non-slip liners can be easily trimmed for an exact fit.

Part No.	Color	Size (W x H x D)	Price
547.92.525	Grey	19-3/4" x 46-1/6"	
547.92.526	Grey	23-5/8" x 46-1/16"	

Cabinet Accessories

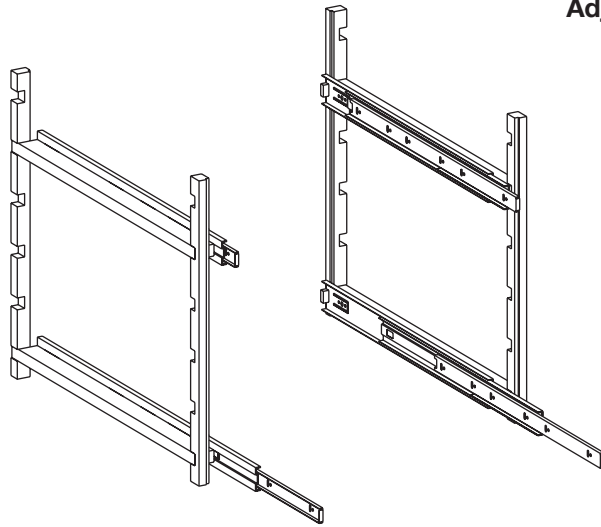

Base/Vanity Corner Cleats

4 pieces 3/4" x 1" x 19-1/4" (six positions).

Tall Corner Cleats

4 pieces 3/4" x 1" x 51-3/4" (16 positions).

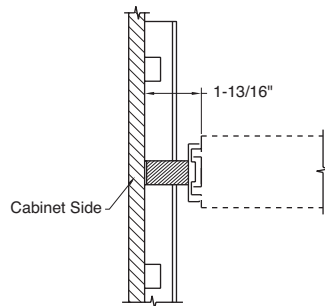

System Cleat width "A"

For frameless and overlay applications.

Base/Tall: 3/4" x 1-5/16" x 21-15/16".

Vanity: 3/4" x 1-5/16" x 18-15/16".

Adjustable Pull-Out Tray System Kits

- Adjustable Pull-Out Tray Hardware Systems feature unfinished Soft Maple components and 75 lb. capacity ball bearing full extension drawer slides. Drawer boxes not included.
- Kits are available for base (24" deep), vanity (21" deep) or tall utility (21" and 24" deep) cabinetry applications. Base and vanity kits include hardware for 2 full width pull-outs. Tall kits include hardware for 4 full width pull-outs.
- Two cleat widths "A" or "B" (horizontal drawer slide supports) are available to accommodate overlay or inset and framed or frameless cabinet construction.
- Vertical corner cleats can be trimmed in height to accommodate adjustable shelves.
- 4 day Standard lead-time, 2 day Code Red expedite lead-time.

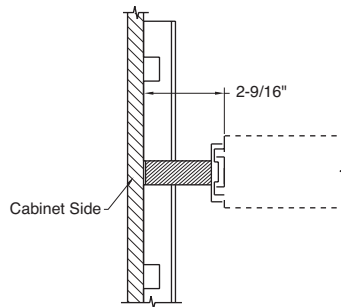

System Cleat width "B"

For framed and inset applications.

Base/Tall: 3/4" x 2-1/16" x 21-15/16".

Vanity: 3/4" x 2-1/16" x 18-15/16".

System Kits - Cleat Width "A"			System Kits - Cleat Width "B"		
Kit Number	Description	Price	Kit Number	Description	Price
SYSB24-AA	Base 24" (3/4" x 1-5/16" x 21-15/16")		SYSB24-BA	Base 24" (3/4" x 2-1/16" x 21-15/16")	
SYSTB24-AA	Tall 24" (3/4" x 1-5/16" x 21-15/16")		SYSTB24-BA	Tall 24" (3/4" x 2-1/16" x 21-15/16")	
SYSV21-AA	Vanity 21" (3/4" x 1-5/16" x 18-15/16")		SYSV21-BA	Vanity 21" (3/4" x 2-1/16" x 18-15/16")	
SYSTV21-AA	Tall 21" (3/4" x 1-5/16" x 18-15/16")		SYSTV21-BA	Tall 21" (3/4" x 2-1/16" x 18-15/16")	
Single Shelf Kits - Cleat Width "A"			Single Shelf Kits - Cleat Width "B"		
Kit Number	Description	Price	Kit Number	Description	Price
SYSSB24-AA	Base 24" (3/4" x 1-5/16" x 21-15/16")		SYSSB24-BA	Base 24" (3/4" x 2-1/16" x 21-15/16")	
SYSSV21-AA	Vanity 21" (3/4" x 1-5/16" x 18-15/16")		SYSSV21-BA	Vanity 21" (3/4" x 2-1/16" x 18-15/16")	

Cabinet Accessories (continued)

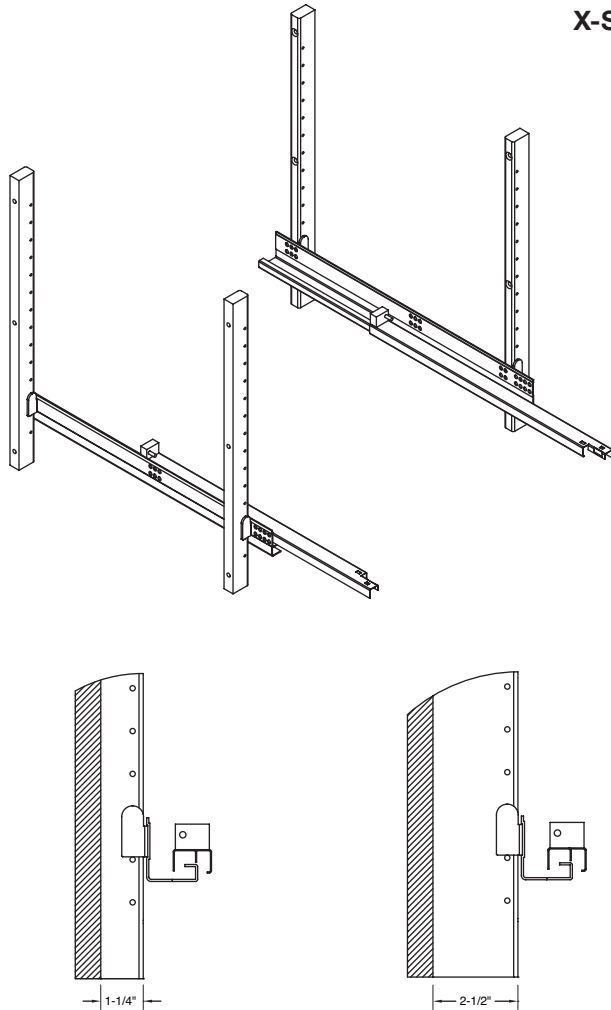

1-1/4" Pilaster kits with brackets

For frameless and most framed overlay applications.

2-1/2" Pilaster kits with brackets

For inset, wide framing and thick door applications.

X-Series Adjustable Pull-Out Tray System Kits

- Adjustable Pull-Out Tray Hardware Systems feature clear prefinished Hard Maple components and patented drawer slide installation/adjustment brackets. Drawer slides not included.
- Installation/adjustment clips are designed for TANDEM style undermount drawer slides.
- Pilasters and brackets use 5mm x 32mm spacing.
- Kits are available for base, vanity or tall utility cabinetry applications.
- Two cleat widths are available to accommodate overlay or inset and framed or frameless cabinet construction.
- Pilasters (vertical uprights) can be trimmed in width or height for installation in varied styles of cabinet construction and interior configurations.
- Drawer box width and depth dimensions are based on the requirements of the drawer hardware being used and must be ordered separately.
- 4 day Standard lead-time, 2 day Code Red expedite lead-time.

1-1/4" Pilaster Kits with Brackets			
Kit Number	Description	Cabinet Application	Price
2100160	20-7/8" Pilasters (4), Brackets (8)	Base with door and drawer	
2100161	28" Pilasters (4), Brackets (8)	Base full height door	
2100162	58-5/8" Pilasters (4), Brackets (20)	Tall Utility	
2-1/2" Pilaster Kits with Brackets			
Kit Number	Description	Cabinet Application	Price
2100163	20-7/8" Pilasters (4), Brackets (8)	Base with door and drawer	
2100164	28" Pilasters (4), Brackets (8)	Base full height door	
2100159	58-5/8" Pilasters (4), Brackets (20)	Tall Utility	

Cabinet Accessories (continued)

Spice Storage Units

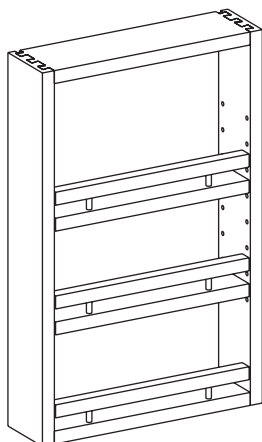

- Dovetail construction with 5/8" thick sides and ends.
- 1/4" plywood back flush with back of unit.
- 32mm line bore shelf support system.
- 5mm locking shelf clips.
- Matching specie retainer rail attached to unit bottom and each adjustable shelf.
- Installation hardware is not included. Additional hinges and adequate installation hardware are required to ensure proper operation.
- Available size range:
Height: 18" to 36".
Width: 8" to 21".
Depth: 3-1/8" fixed.
- Finishing Option charge per spice storage unit.

Spice Storage Unit Pricing			
Unit Height	Unit Width		
	8" – 13"	13-1/16" – 17"	17-1/16" – 21"
Natural Birch			
21" – 23"			
23-1/16" – 31"			
31-1/16" – 36"			
Hard Maple			
21" – 23"			
23-1/16" – 31"			
31-1/16" – 36"			
Walnut			
21" – 23"			
23-1/16" – 31"			
31-1/16" – 36"			

Shelves Per Unit	
Unit Height	# Per Unit
18" – 23"	2
23-1/16" – 31"	3
31-1/16" – 36"	4

To determine the list price of an interior storage unit:

- Find the size range of the unit in the applicable specie table. Select the price based on the overall width and height of the unit.
- Add finishing charges if applicable.

Spice Storage Unit Loose Shelves

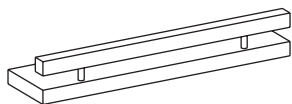

Natural Birch, Hard Maple, Walnut.

- Specify spice storage and unit width.
- Finishing is included in price.

Cabinet Accessories (continued)

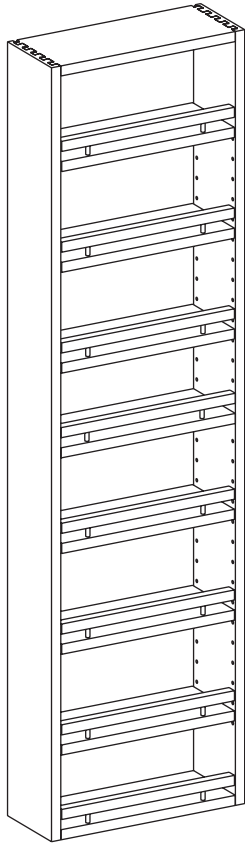

Can Storage Units

- Dovetail construction with 5/8" thick sides and ends.
- 1/4" plywood back flush with back of unit.
- 32mm line bore shelf support system.
- 5mm locking shelf clips.
- Matching specie retainer rail attached to unit bottom, fixed center shelf and each adjustable shelf.
- For structural integrity, units over 39" high have one fixed shelf, centered.
- Installation hardware is not included. Additional hinges and adequate installation hardware are required to ensure proper operation.
- Available size range:
Height: 21" to 60".
Width: 8" to 21".
Depth: 5" fixed.
- Finishing Option charge per can storage unit.

Can Storage Unit Pricing			
Unit Height	Unit Width		
	8" – 13"	13-1/16" – 17"	17-1/16" – 21"
	Natural Birch		
21" – 23"			
23-1/16" – 31"			
31-1/16" – 39"			
39-1/16" – 47"			
47-1/16" – 55"			
55-1/16" – 60"			
Unit Height	Hard Maple		
21" – 23"			
23-1/16" – 31"			
31-1/16" – 39"			
39-1/16" – 47"			
47-1/16" – 55"			
55-1/16" – 60"			
Unit Height	Walnut		
21" – 23"			
23-1/16" – 31"			
31-1/16" – 39"			
39-1/16" – 47"			
47-1/16" – 55"			
55-1/16" – 60"			

Shelves Per Unit	
Unit Height	# Per Unit
21" – 23"	2
23-1/16" – 31"	3
31-1/16" – 39"	4
39-1/16" – 47"*	5
47-1/16" – 55"*	6
55-1/16" – 60"*	7

*Units over 39" include 1 fixed shelf.

Can Storage Unit Loose Shelves

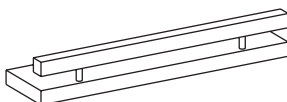

Natural Birch, Hard Maple, Walnut.

- Specify can storage and unit width.
- Finishing is included in price.

Cabinet Accessories (continued)



Wall Organizer Units

- Designed to be installed inside 9" or 12" wide full height door wall cabinets.
- Adjustable door mount hardware included.
- Organizer units are fully assembled and packaged with installation instructions.
- Units include adjustable shelves with chrome rails and full-extension ball bearing drawer glides.
- Prefinished in Natural Birch only; unfinished units are not available.
- Doors not included.

Part No.	Size (W x H x D)	Fits Cabinet	Price
2100778	5" x 26-1/4" x 10-3/4"	9" wide	
2100779	8" x 26-1/4" x 10-3/4"	12" wide	

Cabinet Accessories (continued)

Pull-Out Storage Units

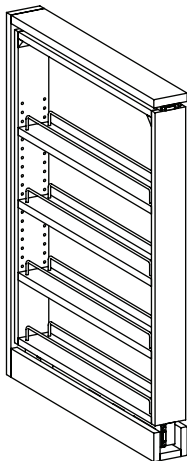

Base Units

All Base Storage Units 23" deep and 30" high.

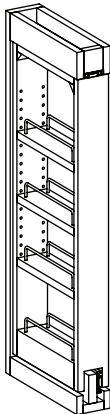

Wall Units

Available in 30", 36" and 42" high.
All Wall Storage Units 11-1/8" deep.

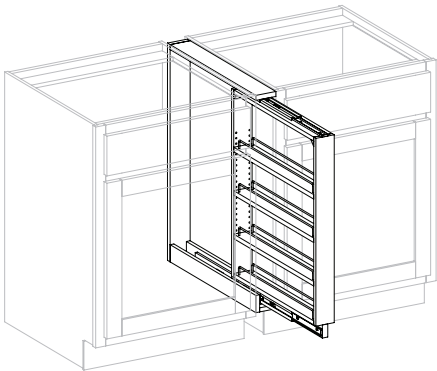

Pull-Out Storage Unit Installed

Mount Pull-Out Storage Units to adjacent cabinets.

- Pull-Out Storage Units are designed for 3" or 6" spaces between cabinets and can be accessed from both sides.
- Storage units are fully assembled and packaged with installation instructions.
- Wall and base storage units include adjustable shelves with chrome rails and full-extension ball bearing slides.
- Prefinished Natural Birch only; unfinished units are not available.
- Doors not included.

Pull-Out Storage Unit Pricing		
Part No.	Description	Price
2100750A	3" Base Pull-Out Storage Unit	
2100751A	6" Base Pull-Out Storage Unit	
2100752A	3" Wall Pull-Out Storage Unit - 30" high	
2100753A	6" Wall Pull-Out Storage Unit - 30" high	
2100754A	3" Wall Pull-Out Storage Unit - 36" high	
2100755A	6" Wall Pull-Out Storage Unit - 36" high	
2100756A	3" Wall Pull-Out Storage Unit - 42" high	
2100757A	6" Wall Pull-Out Storage Unit - 42" high	

Cabinet Accessories (continued)



(Optional Grooming Organizer shown)

Vanity Base Pull-Out

- Vanity Base Pull-Out ships fully assembled and includes drawer hardware and floor mounting cleats for quick and easy installation.
- Can be installed in both framed and frameless vanity cabinets regardless of overlay or inset application.
- Constructed from Natural Birch solids and plywood finished with a durable, clear UV topcoat.
- Includes two fixed shelves and one adjustable shelf.
- Concealed undermount hardware is full extension with soft close feature. Heavy duty top slide is rated for 225 lbs. and eliminates excessive side to side movement and sagging, even when fully extended.
- Integrated 6-way adjustable door mounting hardware allows for easy installation for all overlays and framing widths. Requires a full height door.
- This Vanity Base Pull-Out Unit can also be fitted with an optional Grooming Organizer or Acrylic Tray Insert.
- Door not included.

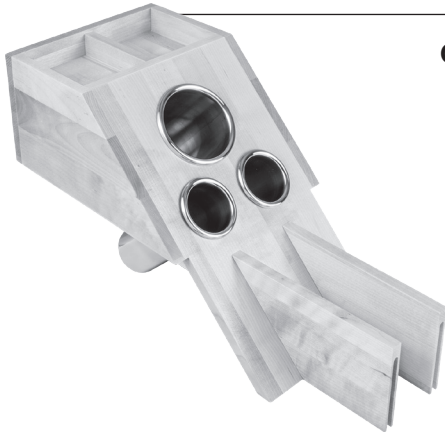

Grooming Organizer

- Grooming Organizer Unit ships fully assembled. Simply place on the top shelf of the Vanity Base Pull-Out unit.
- Includes one 3" and two 2" stainless canisters with heat shields to prevent heat from transferring to surrounding wood surfaces.
- Features dividers for appliance cords and two open storage trays on top of unit for additional organization.



Acrylic Tray Insert

- Clear acrylic tray sized to fit on top shelf of Vanity Base Pull-Out Unit.
- Divided into four separate compartments, the Acrylic Tray Insert can be conveniently lifted out of the Vanity Pull-Out Unit as needed.

Part No.	Description	Size (W x H x D)	Fits Cabinet	Min. Opening	Price
2103585	Vanity Base Pull-Out	8" x 19-7/8" x 18-13/16"	12"	9"	
2103586	Grooming Organizer	8" x 18-7/32" x 9"	12"	9"	
2103587	Acrylic Tray Insert	8" x 10-3/32" x 3-7/16"	12"	9"	

Cabinet Accessories (continued)

Under Drawer Base Pull-Out

- Designed especially for use in base cabinets with a functioning top drawer.
- Under Drawer Base Pull-Out Units ship fully assembled and includes drawer hardware and floor mounting cleats for quick and easy installation.
- Can be installed in both framed and frameless cabinetry.
- Constructed from Natural Birch solids and plywood finished with a durable, clear UV topcoat.
- Includes two fixed shelves and one adjustable shelf.
- Concealed undermount hardware is full extension with soft close feature. Heavy duty top slide is rated for 225 lbs. capacity and eliminates excessive side to side movement and sagging, even when fully extended.
- Integrated 6-way adjustable door mounting hardware allows for easy installation for all overlays and framing widths.
- Door not included.

Part No.	Description	Size (W x H x D)	Fits Cabinet	Min. Opening	Price
2103589	Under Drawer Base Pull-Out	5-1/2" x 20" x 22"	9"	6"	
2103590	Under Drawer Base Pull-Out	8-1/2" x 20" x 22"	12"	9"	

Utensil Base Pull-Out

- Utensil Base Pull-Out Unit ships fully assembled and includes drawer hardware and floor mounting cleats for quick and easy installation.
- Can be installed in both framed and frameless cabinetry.
- Constructed from Natural Birch solids and plywood finished with a durable, clear UV topcoat.
- Top shelf houses four round stainless steel canisters 4" wide and 6-1/4" deep (included) for utensil storage.
- Concealed undermount hardware is full extension with soft close feature. Heavy duty top slide is rated for 225 lbs. capacity and eliminates excessive side to side movement and sagging, even when fully extended.
- Integrated 6-way adjustable door mounting hardware allows for easy installation for all overlays and framing widths.
- Door not included.

Part No.	Description	Size (W x H x D)	Fits Cabinet	Min. Opening	Price
2103588	Utensil Base Pull-Out	8-1/2" x 24" x 22"	12"	9"	

Cabinet Accessories (continued)



Base Organizer Units

- Designed to be installed inside 9", 12" or 15" wide full height door base cabinets.
- Adjustable door mount hardware included.
- Organizer units are fully assembled and packaged with installation instructions.
- Units include adjustable shelves with chrome rails and full-extension ball bearing drawer glides.
- Prefinished in Natural Birch only; unfinished units are not available.
- Door not included.

Part No.	Size (W x H x D)	Fits Cabinet	Price
2100771	5" x 25-1/2" x 22-1/2"	9" wide	
2100772	8" x 25-1/2" x 22-1/2"	12" wide	
2100773	11" x 25-1/2" x 22-1/2"	15" wide	



Base Pull-Out Unit

- Designed to be installed in framed or frameless full height door base cabinets from 9" wide to 24" wide.
- Each Pull-Out requires one full extension frame and one shelf kit, based on the opening width.
- Works in both inset and overlay applications.
- Includes all cabinet and door mounting hardware.
- Each shelf kit contains two trays that can be installed at the desired height.
- Shelf surfaces are covered with a Maple patterned, non-slip matting to keep stored items in place.
- Full extension, soft close runners have an 80 lb. load capacity.
- Attractive Champagne finish coordinates well with cabinet interiors and exterior colors.
- Door not included.

Part No.	Description	Price
546.62.806	Full Extension Frame – Champagne – 3-3/4" wide x 21-3/8" deep	
546.63.878	Base Pull-Out Maple – Champagne – 4" wide x 19-3/4" deep	
546.63.877	Base Pull-Out Maple – Champagne – 5" wide x 19-3/4" deep	
546.63.859	Base Pull-Out Maple – Champagne – 7" wide x 19-3/4" deep	
546.63.812	Base Pull-Out Maple – Champagne – 8" wide x 20-3/8" deep	
546.63.832	Base Pull-Out Maple – Champagne – 10" wide x 20-3/8" deep	
546.63.813	Base Pull-Out Maple – Champagne – 11" wide x 20-3/8" deep	
546.63.833	Base Pull-Out Maple – Champagne – 13" wide x 20-3/8" deep	
546.63.814	Base Pull-Out Maple – Champagne – 14" wide x 20-3/8" deep	
546.63.834	Base Pull-Out Maple – Champagne – 16" wide x 20-3/8" deep	
546.63.815	Base Pull-Out Maple – Champagne – 17" wide x 20-3/8" deep	
546.63.835	Base Pull-Out Maple – Champagne – 19" wide x 20-3/8" deep	

Cabinet Accessories (continued)



Ready to Install Base Pull-Out

- Base Pull-Out Unit ships fully assembled and includes drawer hardware and floor mounted cleats for easy installation.
- Can be installed in both framed or frameless and overlay or inset cabinet applications.
- Constructed from Natural Birch edgebanded plywood finished with a durable, clear UV topcoat.
- Unique top mount support bracket is rated at 225lb. capacity. Eliminates excessive side-to-side movement and sag when fully extended.
- Drawer hardware is undermount, full extension with soft close feature.
- Integrated 6-way adjustable door mounting hardware allows for easy installation for all overlays and framing widths.
- Door not included.

Part No.	Size (W x H x D)	Fits Cabinet	Min. Opening	Price
2100832	5-1/2" x 24" x 22"	9" base	6"	
2100833	8-1/2" x 24" x 22"	12" base	9"	
2100834	11-1/2" x 24" x 22"	15" base	12"	
2100835	14-1/2" x 24" x 22"	18" base	18"	



Ready to Install Bottom Mount Trash Can Pull-Out

- Unit ships fully assembled, including drawer hardware and floor mounted cleats for easy installation.
- Constructed from Natural Birch edgebanded plywood finished with a durable, clear UV topcoat.
- Single and double units include one or two white polyethylene trash cans with 35 or 50 quart capacity.
- Single or double 50 quart units require full height base cabinets.
- Drawer hardware is undermount style full extension with soft close feature.
- Single can units fit in a 15" wide cabinet. Double can units fit in an 18" wide cabinet.
- Integrated 6-way adjustable door mounting hardware allows for easy installation for all overlays and framing widths.
- Door not included.

Part No.	Description/Dimensions	Price
2100836	Single 35 quart can – 12"w x 21-3/8"d x 19-13/16"h	
2100837	Double 35 quart cans – 15"w x 21-3/8"d x 19-13/16"h	
2100838	Single 50 quart can – 12"w x 21-3/8"d x 24"h	
2100839	Double 50 quart cans – 15"w x 21-3/8"d x 24"h	

Cabinet Accessories (continued)

Pull-Out Bottom Mount Trash Can Units

- Units are fully assembled and include trash cans, installation instructions and hardware.
- Attaches to back of door with 6 way adjustability. Door hinging is not required.
- Platinum metal base and grey trash cans.
- Trash cans are 36 quart capacity.
- Bottom mount unit with full extension soft close slides.
- 110 lb. weight capacity.
- Single and double trash can units available.
- Door not included.

Single Trash Can Unit

Minimum Opening Width: 12" Framed Cabinets.
 12-3/4" Frameless Cabinets.

Minimum Opening Height: 19-1/4".

Minimum Interior Depth: 21-13/16".

Part No.	Price
503.15.821	

Double Trash Can Unit

Minimum Opening Width: 14-3/4" Framed Cabinets.
 15-1/2" Frameless Cabinets.

Minimum Opening Height: 19-1/4".

Minimum Interior Depth: 21-13/16".

Part No.	Price
503.15.822	

Cabinet Accessories (continued)

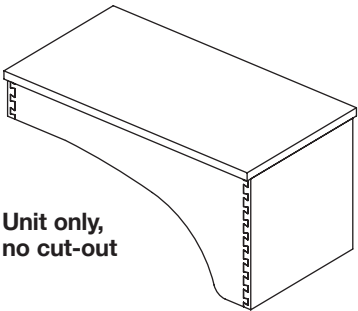
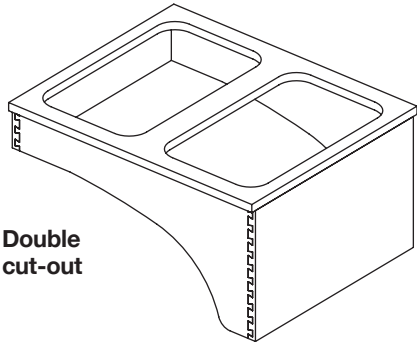
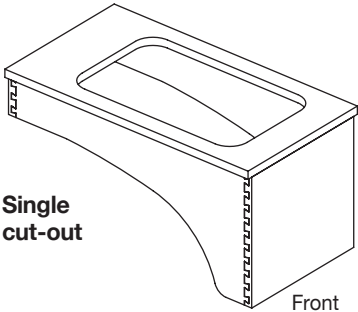

Trash Can Pull-Out

- 3/4" Hard Maple plywood top for Hard Maple and Natural Birch units.
- When ordering Trash Can Pull-Outs, specify the drawer box width. The top will extend 3/8" past the sides of the drawer box.
- Designed to be used with side mount full extension slides – hardware not included.
- Unit with single cut-out includes one 7 gallon, grey color waste can; double cut-out includes two waste cans; no cut-out option does not include a waste can.
- Front height is 10" to accommodate door mounting hardware. Rear height is 3".
- Depth: 21-3/4" fixed.
- Finishing: Priced per pull-out.

Single cut-out:

Minimum width: 11".
Maximum width: 21".

Double cut-out:

Minimum width: 15".
Maximum width: 27".

Unit only, no cut-out (solid top shipped loose):

Minimum width: 11".
Maximum width: 27".

Waste can only: Part #2100102A

Trash Can Pull-Out			
Specie	Single Cut-Out	Double Cut-Out	No Cut-Out
Natural Birch			
Maple, Hard			
Walnut			

Cabinet Accessories (continued)

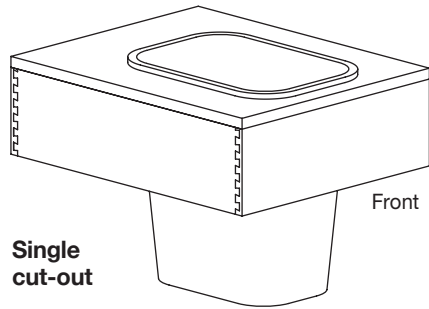

Single cut-out

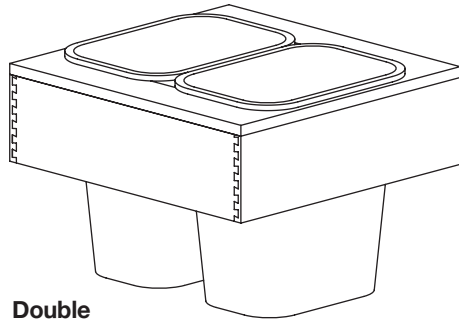

Double cut-out

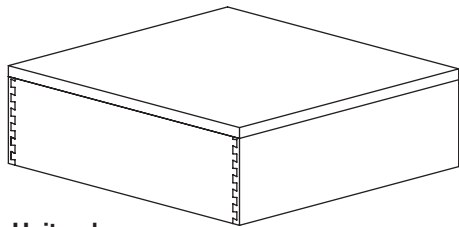

Unit only, no cut-out

TANDEM Trash Can Pull-Out

- 3/4" Hard Maple plywood top for Hard Maple and Natural Birch units.
- Designed to be used with Blum TANDEM plus Blumotion full extension drawer slides and narrow drawer front locking clips (not included).
- Hardware reference numbers:
 - ♦ Blum TANDEM plus Blumotion: 563H5330B.
 - ♦ Narrow Drawer Front Locking Clips: T51.0801.20 (L/R).
- Unit with single cut-out includes one 7 gallon grey color waste can; double cut-out includes two waste cans; no cut-out option does not include a waste can.
- Cut-outs also accommodate 13 gallon trash cans.
- Height: 6-3/4" fixed (including 3/4" plywood top).
- Depth: 21-3/4" fixed.
- Finishing: Priced per pull-out.

Single cut-out:

Minimum width: 14-5/8".

Maximum width: 19-1/8".

Double cut-out:

Minimum width: 20-5/8".

Maximum width: 28-1/8".

Unit only, no cut-out (solid top shipped loose):

Minimum width: 14-5/8".

Maximum width: 28-1/8"

Waste can only: \$12.00 Part #2100102

Tandem Trash Can Pull-Out			
Specie	Single Cut-Out	Double Cut-Out	No Cut-Out
Natural Birch			
Maple, Hard			
Walnut			

Cabinet Accessories (continued)

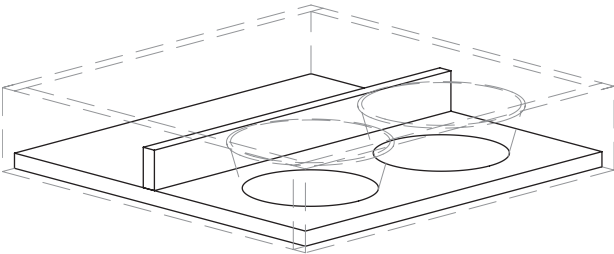

Pet Insert

- Can be sized to fit a specific drawer box or ordered separately. If ordered separately, specify width and depth.
- Available in Hard Maple and Natural Birch.
- 3/4" thick Natural Birch plywood insert and divider.
- Insert accommodates 5", 6-1/2" and 7-3/8" diameter bowls (not included). Bowls are available at most pet stores.
- Not intended to accommodate water bowls.
- 2" high plywood divider is shipped loose. Plywood base plate is pre-drilled with pilot holes for divider installation.
- Available in drawer box depths between 18" to 21".

Single cut-out:

Natural Birch
Hard Maple

Minimum width: 12-3/4".

Maximum width: 18".

Double cut-out:

Natural Birch
Hard Maple

Minimum width: 15".

Maximum width: 36".

Cabinet Accessories (continued)



Wood Half Moon Lazy Susan



Plastic Half Moon Lazy Susan

Half Moon Lazy Susan System

- Designed to fit into blind corner cabinetry, providing greater access to items stored in recessed areas of the cabinet.
- Half moon units will not work with concealed inset hinges.
- Shelves swing out and also slide forward for ease of access to individual shelving.
- Shelving material options include:
 - ♦ Wood: 5/8" thick Maple veneer core plywood with a 1" high solid Maple finger jointed rim; all finished with a durable UV clear coat.
 - ♦ Plastic: white polymer molded shelves that are moisture and stain resistant.
- Half Moon Lazy Susan Wood Shelf System Kit includes:
 - ♦ Two shelves with shelf supports.
 - ♦ Two positioning bases.
 - ♦ Two pairs of slides.
 - ♦ One 17" chrome plated shaft with aluminum bearings.
 - ♦ One standard bracket for framed cabinetry.
 - ♦ One Euro bracket for frameless cabinetry.
 - ♦ Template and mounting instructions.
- Half Moon Lazy Susan Plastic Shelf System Kit includes:
 - ♦ Two shelves with shelf supports.
 - ♦ Two positioning bases.
 - ♦ Two pairs of slides.
 - ♦ One 15-7/8" chrome plated shaft with aluminum bearings.
 - ♦ One standard bracket for framed cabinetry.
 - ♦ One Euro bracket for frameless cabinetry.
 - ♦ Template and mounting instructions.
- Units are universal – swing left or right.

Part No.	Description	Framed Min. Opening	Frameless Min. Opening	Price
2103591	32" Half Moon Susan Set w/Wood Shelves	12"	13-1/4"	
2103592	35" Half Moon Susan Set w/Wood Shelves	15"	16-1/4"	
2103593	38" Half Moon Susan Set w/Wood Shelves	18"	19-1/4"	
2103594	31" Half Moon Susan Set w/Plastic Shelves	13-1/4"	15"	
2103595	33" Half Moon Susan Set w/Plastic Shelves	16-1/8"	17-7/16"	
2103596	39" Half Moon Susan Set w/Plastic Shelves	19-1/4"	20-3/4"	

Cabinet Accessories (continued)



LeMans II Corner Pull-Out Shelf

- Designed to be installed inside either full height or drawer/door blind corner base cabinets.
- Minimum door opening angle of 90 degrees required.
- Unit includes 2 trays and 2 posts.
- Shelves have Maple patterned non-slip surfaces with platinum colored metal rails.
- Shelf height is adjustable.
- Can easily be retrofitted into existing blind corner cabinetry.
- Maximum load per shelf is 65 lbs.

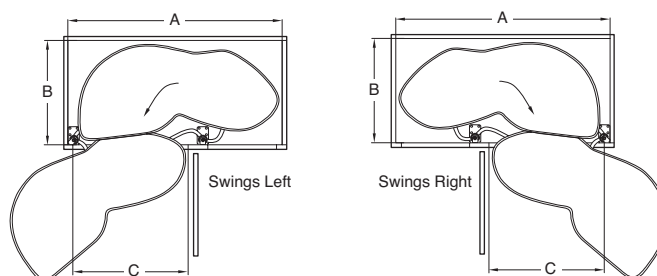

Corner Pull-Out Shelf							
Part Number	Shelf Size	Interior Width A	Interior Depth B	Opening width (Framed) C	Opening Width (Frameless) C	Swing	Price
541.32.445	15"	32-1/4"	21"	16-1/8"	17-1/8"	Right	
541.32.446	15"	32-1/4"	21"	16-1/8"	17-1/8"	Left	
541.32.450	18"	36-1/4"	21"	17-3/4"	18-3/4"	Right	
541.32.451	18"	36-1/4"	21"	17-3/4"	18-3/4"	Left	
541.32.460	21"	38"	21"	21-1/4"	22-1/4"	Right	
541.32.461	21"	38"	21"	21-1/4"	22-1/4"	Left	



Blind Corner System

- Swing-out pantry and roll out shelves maximize accessibility in blind corners.
- Units include drawer slides and installation instructions.
- Designed for blind cabinets with 15" wide or larger openings.
- Minimum frame opening height required is 19-3/4".
- Minimum cabinet interior depth is 22-5/8". Will not work with standard depth Cabinet Systems cabinetry or inset applications.
- Piano hinge on swing-out unit is reversible for left and right installation applications.
- 1/2" thick Maple with a clear finish; unfinished units not available.

Part No.	Description	Price
2100790	Blind Corner System	

Cabinet Accessories (continued)



Two-Tier Cookware Organizers

- Units are designed to be installed inside 15" or 24" wide base cabinets*.
- Two independent racking systems accommodate pots, pans and their corresponding lids.
- Vertical dividers are independently adjustable.
- Units mount to floor, side and back of cabinets.
- 100 lb. capacity full extension drawer glides.
- Installation hardware included.
- Wire frame construction with chrome finish.

Part No.	Size (W x H x D)	Fits Cabinet*	Price
2100767	11-3/4" x 18" x 22"	15" wide	
2100768	20-3/4" x 18-1/8" x 22"	24" wide	

*Use of concealed inset hinges will require a 3" wider cabinet to accommodate unit.



Heavy Duty Mixer Lift

- Side mounted hardware kit designed to be installed in full height base cabinets.
- Recommended for use in 18", 21" or 24" wide full height door cabinets.
- Adjustable spring-loaded mechanism with silver finish.
- 60 lb. weight capacity accommodates most stand style mixers.
- Installation hardware included.
- Shelf not included.

Part No.	Fits Cabinet	Price
2100774	18", 21" or 24" (wide)	

Cabinet Accessories (continued)



Tray Roll-Out

- Designed to be installed inside 9", 12" or 15" wide cabinets.
- Units are fully assembled including drawer slides and installation instructions.
- Maple plywood construction with removable dividers.
- Units are 10" high and 22-5/16" deep fixed. Will not work with standard depth Cabinet Systems cabinetry or inset applications.
- Door requires special lower hinge height location to clear 3-1/4" high drawer front; 6" from bottom of door is recommended with 1-1/2" cabinet framing.
- Does not work with concealed inset hinges.
- Prefinished in Natural Birch only; unfinished units are not available.

Part No.	Description	Price
2100791	Roll-out for 9" base cabinet (5-3/4" wide) – 1 divider	
2100792	Roll-out for 12" base cabinet (8-3/4" wide) – 2 dividers	
2100793	Roll-out for 15" base cabinet (11-3/4" wide) – 3 dividers	



U-Shaped Tray Dividers

- Floor or shelf mounted units designed to be installed in most wall, base and tall cabinets.
- Sold individually, each unit provides 3" of storage space; use multiple units as necessary to divide and accommodate cabinet interior space.
- Installation hardware included.
- Wire frame construction with chrome finish.

Part No.	Size (W x H x D)	Price
2100765	3" x 10" x 11-7/8"	

Cabinet Accessories (continued)



Sink Front Tip-Out Trays

- Designed to provide convenient storage behind sink drawer fronts.
- Sold in pairs; can be used individually for smaller drawer fronts or in tandem for wider drawer fronts.
- Trays are almond, high impact polystyrene. One tray is open and one includes an integral soap dish and ring post.
- Each kit includes two pairs of spring loaded scissor style hinges and installation hardware.
- Drawer fronts are not included.

Part No.	Size (W x H x D)	Price
2100769	11"x 3-13/16"x 2-1/8"	
2100770	14"x 3-13/16"x 2-1/8"	



Under-Sink Mat

- Designed to contain water or other fluids to prevent damage to cabinet.
- Dimpled surface can collect 1 gallon of liquid per 6 square feet.
- Can be easily cut to fit most cabinet interiors.
- Polystyrene sheet with grey/stainless finish.

Part No.	Size	Price
547.91.550	24-5/8" x 45-1/2"	



File Drawer Support Systems

- Insert unit designed to fit inside of deep drawers to accommodate hanging folder systems.
- Designed for 18" or 21" wide cabinets. Rails are trimmable for additional customization.
- Small file system accommodates letter size hanging folders.
- Large file system accommodates legal size hanging folders.
- Wire frame construction with black finish.
- Hanging folders and drawer fronts not included.

Part No.	Size (W x H x D)	Price
2100775	13" x 9-3/4" x 19-1/4"	
2100776	15-7/8" x 9-3/4" x 19-1/4"	

Cabinet Accessories (continued)

Lazy Susan Shelves

- Wood susans are designed to be installed onto adjustable shelves or cabinet floors. Pricing includes susan and mounting ring bearing only, cabinet shelves not included.
- Susans mount directly onto shelving and cabinet bottom - no center pole is required.
- All susans are prefinished with a clear topcoat; unfinished units not available.

Standard Wood Lazy Susan Shelves

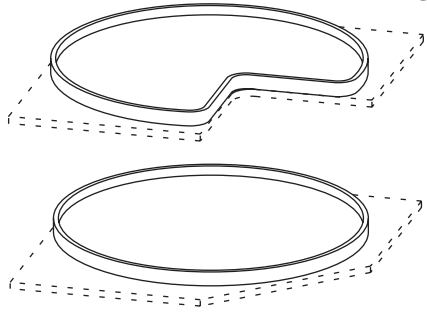

- 1/2" thick Hard Maple plywood with a 1-1/2" high laminated edge.
- Sold individually and includes a center mounted ring bearing.

Part No.	Description	Price
2100053A	18" Full Round Wood Lazy Susan	
2100051A	32" Full Round Wood Lazy Susan	
2100052A	28" Kidney Wood Lazy Susan	
2100050A	32" Kidney Wood Lazy Susan	

Wire Rim Wood Susan Shelves

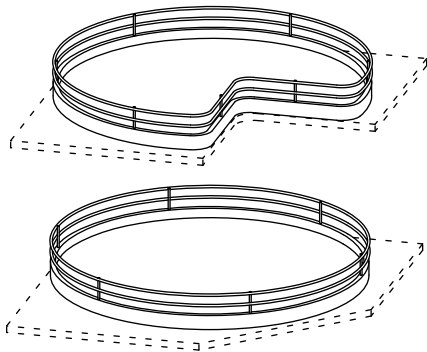

- 1/2" thick Hard Maple plywood with 1-1/2" high laminated edge and 2" high powder coated wire rim.
- Interior height is 3".
- Both the full round and kidney shelves wire rim include a center mounted ring bearing.
- Sold in pairs only.

Part No.	Description	Price
2100785A	28" Full Round Wire Rim Lazy Susan Set	
2100786A	32" Full Round Wire Rim Lazy Susan Set	
2100787A	28" Kidney Wire Rim Lazy Susan Set	
2100788A	32" Kidney Wire Rim Lazy Susan Set	

Cabinet Accessories (continued)

Lattice Wine Rack Pricing			
Model	Size	Unfinished Price	
		Cherry	Hard Maple
Standard	17" x 36"		
	24" x 30"		
	24" x 43"		
Square	17" x 36"		
	24" x 30"		
	24" x 43"		
Deluxe	17" x 36"		
	24" x 30"		
	24" x 43"		

Lattice Wine Racks

- Sold individually (specify two pieces if pair is desired).
- Trimmable in length and width.
- Standard rack bottle openings are 4" x 4".
- Square and Deluxe bottle openings are 4-1/4" x 4-1/4".
- Square and Deluxe wine racks can be used to make a pair.
- Available unfinished or finished. See Finishing Program Section for pricing.

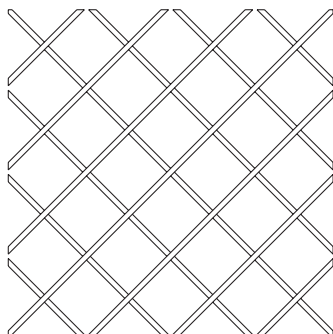
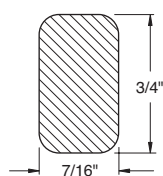
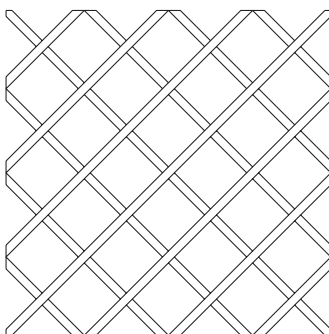
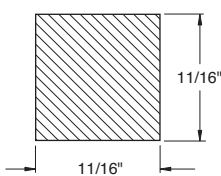
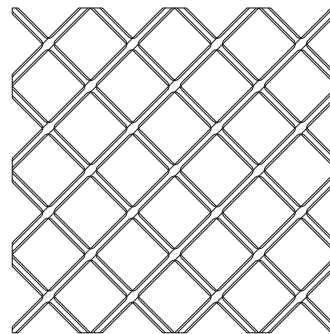
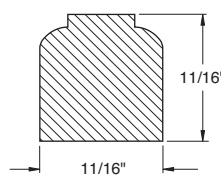
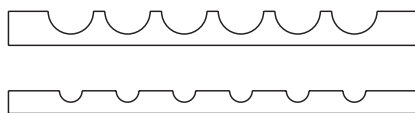
Standard

 Standard
cross section

Square

 Square
cross section

Deluxe

 Deluxe
cross section

Half Round Wine Racks

- Design Charge, Material Category B.
- Use price per sq. ft. to calculate 30" racks and price per sq. ft. to calculate 36" racks.
- Sold in pairs (front and back).
- 3/4" thick only, 30" or 36" length.
- Front is 2" high, back is 3" high.
- Bottle cut-outs start 3" from end on 30" and 3-1/2" from end on 36".
- 30" holds 5 bottles, 36" holds 6 bottles.
- Horizontal grain direction only.
- Available unfinished or finished. See Finishing Program Section for pricing.

Closet Accessory Program



Oval Wardrobe Tube and Accessories

- Unique oval design provides support for hanging clothes in closets and tall utility cabinets.
- Dimensions: 1-3/16" high x 9/16" wide x 48" long. Can be easily trimmed to length using a hacksaw.
- Wardrobe Tube Supports are required for wall to wall, between closet panels or inside cabinet installation applications.
- Surface Mount Center Supports are required on longer wardrobe tube spans or when using full length tubes.
- End Caps are used to cover cut exposed ends or when not using Wardrobe Tube Supports.
- Wardrobe Tube, Tube Supports, Oval Bracket Surface Mount and End Cap have a chrome finish.



Oval Bracket
Surface Mount



End Cap



Tube Support

Part No.	Description	Price
801.13.244	2 Oval Wardrobe Tubes – Chrome – with 2 supports	
802.04.208	Oval Bracket Surface Mount – Chrome – 1-13/16" high	
802.05.295	End Cap – Chrome – 1-3/16" wide	