

## Value

Specifications Guide / Valid thru August 2022

**Please Note:** Items are subject to change without prior notice. This spec book is missing some updated information, so to stay up to date with product specifications and modification options please use our new digital spec book which can be found at <https://ezpricing.fabuwood.com/specbook>

## Construction Specifications

### Doors and Drawer Fronts:

Doors and drawer fronts are made of solid wood rails with a MDF center panel to reduce the possibility of shrinkage.

The 5 piece Hallmark modified full overlay door has a 1/2" thick MDF center panel captured in a 3/4" x 2 1/4" mortise and tenon solid wood frame and is complimented with a 5 piece recessed panel drawer front. The overlay on top of all wall cabinets has been modified to accept a crown moulding.

### Hinges:

Compact Blumotion soft close hinges (Blum model #39C355B.20).

### Drawers:

5/8" thick solid wood dovetail drawer box with a 3/8" plywood bottom attached to Tandem plus Blumotion concealed drawer runners (Blum model #563H)

### Shelving:

15mm (5/8") thick select veneered wood with matching wood edge-banding is used on all wall and base cabinetry where applicable. The adjustable shelves are supported by plastic self locking shelf clip.

### Cabinet Sides, Backs, Tops and Bottoms:

1/2" thick veneered plywood with natural finished interiors. The backs are stapled and screwed into place for additional support.

### Face Frame:

3/4" x 1 1/2" solid wood stiles and rails jointed with glue and dowels. Back of face frames are grooved to accept side panels. The Hallmark face frame is engineered so that the bottom of all base and wall cabinets are flushed with the top inside edge of the face frame creating a custom look.

### Toe Kick:

3/4" x 4 1/2" select unfinished plywood toe kick is added to each assembled cabinet. Additional 1/4" 8-foot lengths of toe kicks are available in matching colors to our cabinetry.

### Panel Beams:

A panel beam is fastened into a dovetail groove at the top of each base cabinet to ensure a straight fully integrated side, and for use of support and mounting of a countertop.

## Construction Specifications

- 1 Solid wood door and drawer front stiles and rails are constructed with mortise and tenon joints.
- 2 Compact Blumotion soft-close mechanism integrated in concealed six-way adjustable hinges. Hinges open at 110°
- 3 5/8" solid wood dovetail drawer with a 3/8" plywood bottom features Tandem plus Blumotion full-extension concealed drawer runners
- 4 2 1/2" interior drawer height.
- 5 3/4" x 1 1/2" solid wood face frame.
- 6 1/2" select veneered plywood back with a natural finished interior.
- 7 1/2" select unfinished plywood side panels grooved into face frame.
- 8 15mm (5/8") select veneered plywood adjustable shelving with matching wood veneer edge banding.
- 9 3/4" x 4 1/2" unfinished plywood toe kick attached to cabinet. Matching 1/4" toe kick cover to be ordered separately.
- 10 2 1/2" x 1/2" plywood panel beams dovetailed into the side panels for strength and stability.
- 11 Base cabinet has 11 7/8" deep shelf.
- 12 Base has a full overlay door.
- 13 When placing an order, need to select exposed sides; Right, Left or Both.  
A 1/4" select medium-density fiberboard panel will be applied to the selected side(s), and the side will be near flush finished.
- 14 Wall cabinet has a modified overlay door. Crown can be mounted on the face frame.

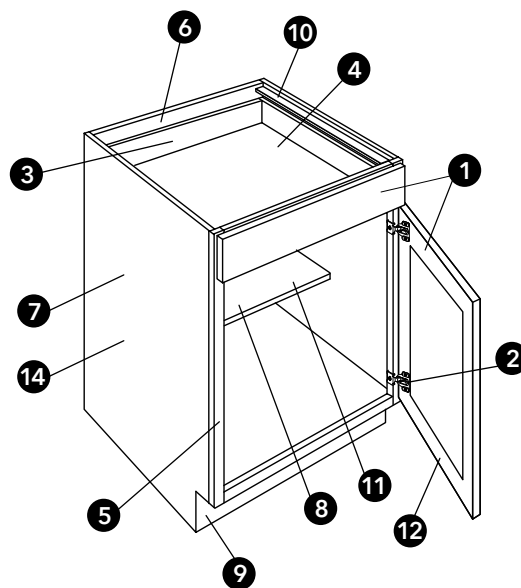
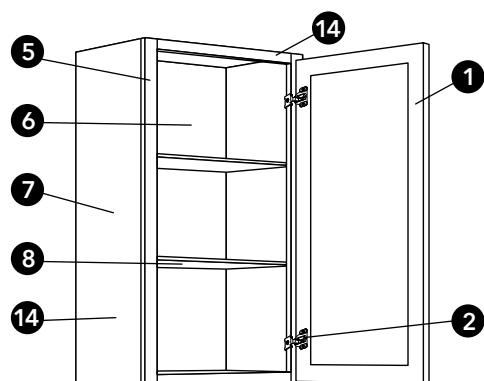

Featuring  
**blum®**

## 5 Year Limited Warranty

### COVERAGE OF WARRANTY

Fabuwood Cabinetry Corp ("Fabuwood") is pleased to provide the following limited warranty on all cabinets imported to and assembled and sold in the United States by Fabuwood. This warranty does not cover cabinets sold or shipped outside of the United States. This limited warranty is subject to all limitations, exclusions, disclaimers and procedures set forth herein. Fabuwood warrants to the original purchasing consumer that all cabinets purchased from Fabuwood will be free from all unnatural defects in material and workmanship in accordance with the Fabuwood quality standards sheet under normal residential use for 5 years from the date of the original purchase or as long as the original purchasing consumer owns the home in which such cabinets are installed, whichever is less. This warranty is non transferable to subsequent owners of the home.

### EXCLUSIONS

THIS WARRANTY SUPERSEDES ANY AND ALL PREVIOUS WARRANTIES BY FABUWOOD AND CONSTITUTES THE EXCLUSIVE REMEDY AGAINST FABUWOOD FOR ALL DEFECTS, DAMAGES AND WORKMANSHIP. THERE ARE NO IMPLIED WARRANTIES EXTENDING BEYOND THE TERMS OF THIS WARRANTY. FABUWOOD SHALL NOT BE LIABLE FOR ANY INDIRECT, SPECIAL, PUNITIVE, INCIDENTAL OR CONSEQUENTIAL COSTS, EXPENSES OR DAMAGES. THIS WARRANTY GIVES YOU SPECIFIC LEGAL RIGHTS, AND YOU MAY ALSO HAVE OTHER RIGHTS, WHICH VARY FROM STATE TO STATE. IT IS POSSIBLE THAT ONE OR MORE OF THE LIMITATIONS AND EXCLUSIONS IN THIS WARRANTY MAY NOT APPLY TO YOU. THIS WARRANTY APPLIES ONLY TO FABUWOOD PRODUCTS PURCHASED ON OR AFTER MARCH 15, 2014

### LIMITATIONS

This warranty shall become void if the cabinets, cabinetwork, drawer slides or hinges are modified from its original form, improperly installed or damaged prior to or during the installation, or used in any way other than for residential purposes. This warranty covers only parts and materials of the cabinets as supplied by Fabuwood. This warranty does not cover any products used or installed in connection with cabinets, such as gas or electric appliances, countertops, or plumbing fixtures. This warranty does not apply to products installed in locations that do not maintain year-round environmental controls. This warranty shall not apply to damages caused by transportation, storage, dirt, chemicals, exposure to moisture, humidity or excessive heat or cold, nor does it cover defects arising from normal wear and tear, misuse, neglect, accidents, alterations, improper use or failure to maintain properly, house settling, or acts of God. No installer, retailer, distributor, agent or employee of Fabuwood has the authority to alter the obligations or limitations in this warranty.

### QUALITY STANDARDS

This warranty covers all damages and unnatural defects that are deemed as such under the current Fabuwood Quality Standards sheet. The current Fabuwood Quality Standards sheet is available for download in the dealer login section of the Fabuwood website ([www.fabuwood.com](http://www.fabuwood.com)), which should be reviewed at each time a claim for warranty service is being considered. Fabuwood reserves the right to modify or change the Fabuwood Quality Standards sheet at any time without notice.

### DISCLAIMERS

The following is a brief recap of some of the characteristics of the wood and finishes on the cabinets you are about to purchase. Please read them carefully. If some of these characteristics concern you, please choose something else. We bring these characteristics to your attention so you will realize that Fabuwood will not be held responsible for these variations in your cabinetry. It is important

to note that wood products claimed as defective are most often the result of atmospheric conditions such as excess moisture and humidity. Fabuwood strongly recommends testing the intended location of the products for such conditions prior to installation.

**WOOD AND COLOR VARIATIONS:** Wood is a product of nature, and since no two trees are alike, cabinets may vary in color, texture and grain. Wood characteristics naturally occurring such as variations in color, grain, mineral streaks, pinholes and knots are not considered defects. Color variations in cabinets are also a natural occurrence due to species, age, character of cabinets, and exposure to UV light and sunlight. For these reasons, new and/or replacement cabinets may not match display samples and/or existing cabinets. This may result in overall color variations, but is not considered a defect.

**WOOD DOORS:** Wood by nature will undergo expansion and contraction movements year after year as it compensates and adjusts to ever changing atmospheric humidity and temperature conditions. It is very common for center panels on doors to shrink, expand or move during these transitions. Typically, the panel will return to its normal position within a year once it has adjusted to seasonal changes. It is for these same reasons that it is very common for doors to warp during these periods. Doors that are warped up to 1/4" are not considered defective. Note: It is advisable to check if the door was properly installed, since doors that appear warped are very often the result of improper installation.

**PAINTED FINISHES:** Plywood is a non-porous, smooth grained wood. Additionally, wood by nature undergoes periods of expansion and contraction while it adjusts to atmospheric conditions mentioned above. As such, finish stress lines may become visible on painted cabinets especially at the joints. Any such occurrence is not considered a defect.

**GLAZED FINISHES:** A glazed finish by character is an uneven finish. Some edges and profiles will have heavier hang up than others and glazing may vary cabinet to cabinet, door to drawer and item to item. This may result in overall color variations but is not considered a defect.

### WARRANTY PERFORMANCE

If a defect does occur within the terms and conditions of this warranty such defective part will be repaired or replaced by Fabuwood at its sole discretion. Fabuwood will not provide or pay for the cost of removal of defective product, transportation of defective, repaired or replaced product or installation of repaired or replaced product. Fabuwood will not be responsible for any shipping damages to the defective, replaced or repaired product. If defective item has been discontinued or is not available at the time, Fabuwood reserves the right to replace the item with the most similar item available in Fabuwood's inventory at that time. Fabuwood cannot guarantee that the finish of any replacement will exactly match the finish and appearance of the defective item due to the natural ageing process of the wood and finishes of the cabinets. Fabuwood may require at its discretion that the customer submit a clear photo, or that a company representative view the item being claimed before honoring this warranty.

### CLAIMS

To submit a claim covered under this warranty, the original proof of purchase and full payment or copies thereof must be provided. Please email all documents to [customerservice@fabuwood.com](mailto:customerservice@fabuwood.com). Your dealer will contact you once your claim has been reviewed.

### NOTE

Please do not send back any items to Fabuwood prior to receiving proper authorization from customer service. Fabuwood takes no responsibility on any items sent back to Fabuwood without proper return authorization.



## Door Style

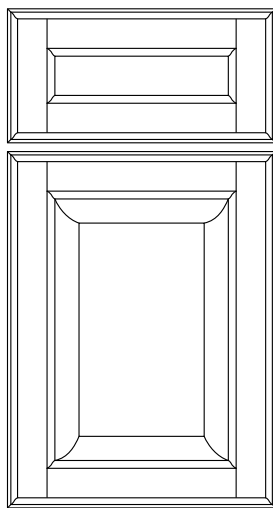

### HALLMARK

COLOR	FINISH
Frost	Paint

- Full overlay door with modified overlay on wall cabinets.
- Stiles and rails are solid wood  $\frac{3}{4}$ " thick and  $2\frac{1}{4}$ " wide.
- Constructed with mortise and tenon joints.
- $\frac{1}{2}$ " thick MDF raised center panel.
- 5-piece recessed panel drawer front matches door design.
- Compact Blumotion Soft Close Hinges (Blum Model #39C355B.20)
- Tandem Plus Blumotion Concealed Drawer Runners (Blum Model #563H)

## Sales Tools

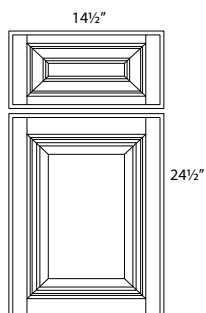

### DOOR SAMPLES WITH DRAWER FRONT

ITEM	DESCRIPTION
SDHF	HALLMARK FROST

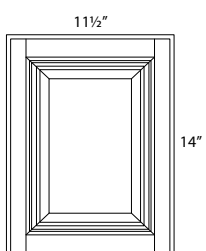

### SMALL DOOR SAMPLES

ITEM	DESCRIPTION
SDHF-2	HALLMARK FROST

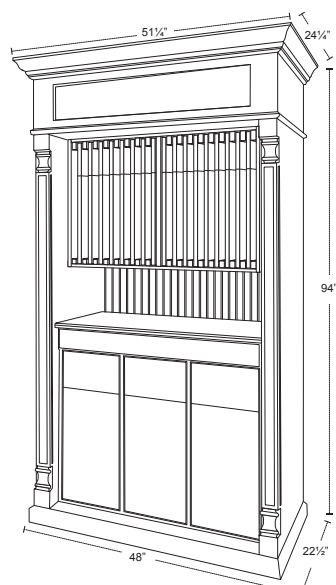

### SELLING CENTER

ITEM	DESCRIPTION
DEALER SELLING CENTER	FABUWOOD SELLING CENTER

## Sales Tools

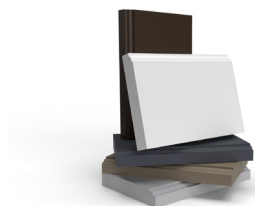

### COLOR BLOCKS

ITEM	DESCRIPTION
COLOR BLOCK	BOX OF COLOR BLOCKS



### SAMPLE PACKAGES

ITEM	DESCRIPTION
SMALL SAMPLE PACKAGE	SMALL SAMPLE PACKAGE
DEALER PACKAGE	LITERATURE AND ACCESSORIES



### DIGITAL BROCHURE

ITEM	DESCRIPTION
DIGITAL BROCHURE QR	QR CODE KEY RING



### STYLE GUIDE

ITEM	DESCRIPTION
SG22	25PK. 2022 STYLE GUIDE BROCHURE

## Modifications

### CUT ITEMS

ITEM	DESCRIPTION
CUT-BASE	Reduce depth of base cabinet (min. depth 12")
CUT-DBASE	Reduce depth of drawer base cabinet (min. depth 12")
CUT-SBASE	Reduce depth of sink base cabinet (no min.)
CUT-WALL	Reduce depth of wall cabinet (no min.)
CUT-TALL	Reduce depth of tall cabinet (no min.)
CUT-DOOR	Cut out center panel of door for glass insert (per door, glass not included)
CUT-COLUMN	Reduce depth of column (specify depth)
CUT-BASE HEIGHT	Reduce height of base cabinet by cutting off top drawer (total base height: 28½")
CUT-TK	Reduce toe kick height (no min.)
CUT-PANEL	Cut down a panel to any size
CUT-ROD	Reduce depth of rollout drawer (specify depth of cabinet)

### PIPE CHASE

ITEM	DESCRIPTION
CHASE-BASE	Make chase in base cabinet
CHASE-DBASE	Make chase in drawer base cabinet
CHASE-WALL	Make chase in wall cabinet
CHASE-TALL	Make chase in tall cabinet
CHASE-CORNER	Make chase in corner cabinet (WDC, WPC & ERB only)

*Must supply a drawing for all chase modifications.*

### CUSTOMIZATIONS

ITEM	DESCRIPTION
CREATE-ERB	Remove tray, install bottom panel on top, to create easy reach
CREATE-RETURN WALL*	Create a return wall filler up to 6"W x 15"D x 42"H (materials incl.)
CREATE-RETURN TALL*	Create a return tall filler up to 6"W x 30"D x 96"H (materials incl.)
CREATE-COLUMN BASE*	Create a 3" column up to 30"D by 34½"H
CREATE-COLUMN TALL*	Create an oversized column
CREATE-COLUMN WALL*	Create a 3" column up to 15"D x 42"H
HAMPER	Install door mounted pull out wood hamper in cabinet (cabinet not incl.)
CUSTOM DOOR	Order any custom size door

\* Email orders@fabuwood.com for quote

### MODIFICATIONS

ITEM	DESCRIPTION
REMOVE-DRAWER	Remove cabinet drawer to create false drawer front
CLOSE-BLIND	Close open section of a blind wall or base cabinet
ATTACH-TK	Attach toe kick on wall cabinet
RECESS-TK	Recess toe kick of base cabinet (must supply a drawing)



## Modifications

### MODIFICATIONS CONT.

ITEM	DESCRIPTION
EDGE-BAND	Additional edge banding (price per linear foot)
PEN-CABINET	Create a peninsula cabinet from 2 cabinets (cabinets not incl.)
INCREASE-BASE	Increase depth on base cabinet
INCREASE-WALL	Increase depth on wall cabinet
INCREASE-TALL	Increase depth on tall cabinet
MATCH-INTERIOR	Stain interior of cabinet to match exterior
CREATE- SQ BOTTOM	Square bottom shelf for wall open end to enable light rail molding
FLUSH-WALL BOTTOM	Flush the bottom of a wall cabinet
FLUSH-TOE KICK	Flush toe kick of base cabinet to face frame (sides not finished)
FULL-DOORS	Create full height door base cabinet from 2 cabinets (cabinets not incl.)
OE6	Cut OE12 to 6"

\* Email orders@fabuwood.com for quote

### UPGRADES

ITEM	DESCRIPTION
INSTALL-ACCES	Install any accessory in a cabinet (accessories not incl.)
GLAZE	Custom glazes available for a charge
CUSTOM COLOR PAINT	Refinish to custom color paint

\* Email orders@fabuwood.com for quote

### LOOSE PARTS

ITEM	DESCRIPTION
SHELF BASE	Loose 24" deep shelf (specify cabinet size)
SHELF WALL	Loose 12" deep shelf (specify cabinet size)
SHELF TALL	Loose 24" deep shelf (specify cabinet size)
SHELF-DSB	Loose shelf (specify cabinet size)
SK BASE	Skin for base cabinet with adhesion
SK MC	Skin for microwave wall cabinet with adhesion
SK TALL	Skin for tall cabinet with adhesion
SK W30	Skin for 30" high wall cabinet with adhesion
SK W36	Skin for 36" high wall cabinet with adhesion
SK W42	Skin for 42" high wall cabinet with adhesion

*Many more modifications available- please contact your customer service rep.*

## 12"-18" High Wall Cabinets

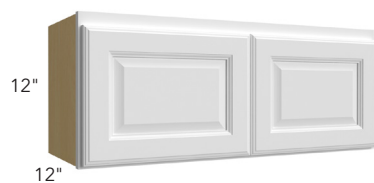

### 12" HIGH

#### ITEM

W3012

W3612

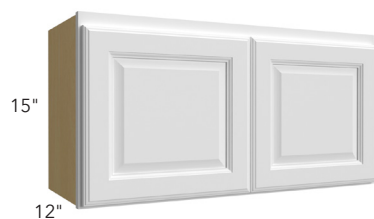

### 15" HIGH

#### ITEM

W2115\*

W2415

W3015

W3315

W3615

\* One door only



\* single door cabinet

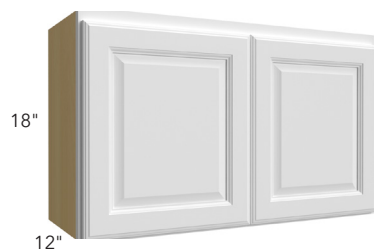

### 18" HIGH

#### ITEM

W2118\*

W2418

W3018

W3318

W3618

\* One door only

## 15"- 24" High & 24" Deep Wall Cabinets

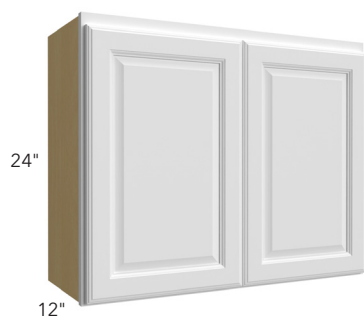

### 24" HIGH

#### ITEM

W2424

W3024

W3324

W3624



### 24" DEEP

#### ITEM

W301524

W331524

W361524

W301824

W331824

W361824

W302424\*

W332424\*

W362424\*

\* Has 1 shelf



## 30" High Wall Cabinets



### 30" HIGH

#### ITEM

W0930

W1230

W1530

W1830

W2130

- Peninsula cabinet modification pg. IX

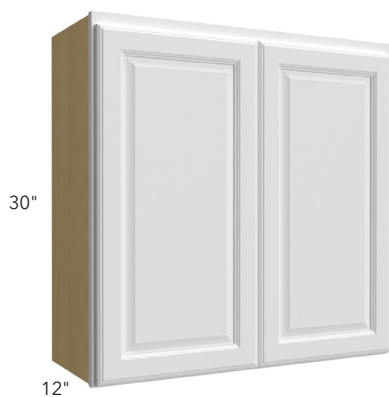

### 30" HIGH

#### ITEM

W2430

W2730

W3030

W3330

W3630

- Peninsula cabinet modification pg. IX

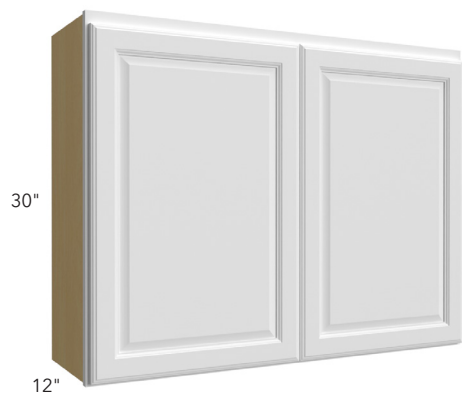

### 30" HIGH

#### ITEM

W3930

W4230

- 1½" center stile
- Peninsula cabinet modification pg. IX



## 30" High Wall Cabinets



### 30" SINGLE DOOR BLIND

#### ITEM

WBC2430

WBC3030

WBC3630

- Must use filler on adjacent side (not supplied)
- Measurements are rounded off to closest 1/8"

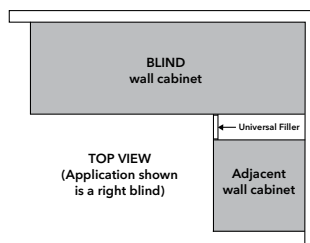

	Act.	Max	Door	Stile	Open (door side)
WBC2430	24"	27"	10 3/8"	6"	7 3/4"
WBC3030	30"	33"	16 3/8"	6"	13 3/4"
WBC3630	36"	39"	22 3/8"	6"	19 3/4"



### 30" DOUBLE DOOR BLIND

#### ITEM

WBC4230

- Must use filler on adjacent side (not supplied)
- Measurements are rounded off to closest 1/8"

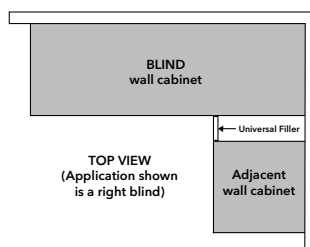

	Act.	Max	Door	Stile	Open (door side)
WBC4230	42"	45"	14 1/8"	6"	25 1/8"

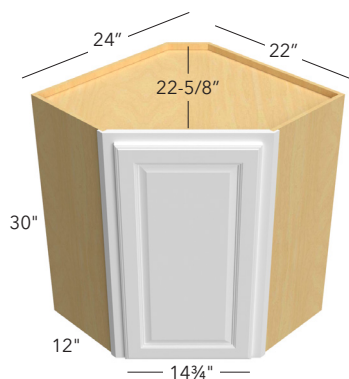

### 30" DIAGONAL CORNER

#### ITEM

WDC2430

- Uses 3/8" overlay hinge
- For Lazy Susan see accessories on pg. 22

## 30" High Wall Cabinets



### 30" GLASS DOOR

ITEM
GD1230
GD1530
GD1830
GD2430♦
GDD2430*
GD3030♦
GD3630♦

\* 14¾" wide for WDC2430 only

♦ Cost is for a single door - must order quantity of 2 doors per cabinet

• Glass doors are pre-installed with clear glass only

## 36" High Wall Cabinets



### 36" HIGH

#### ITEM

W0936

W1236

W1536

W1836

W2136

- Peninsula cabinet modification pg. IX



### 36" HIGH

#### ITEM

W2436

W2736

W3036

W3336

W3636

- Peninsula cabinet modification pg. IX



### 36" SINGLE DOOR BLIND

#### ITEM

WBC2436

WBC3636

- Must use filler on adjacent side (not supplied)
- Measurements are rounded off to closest 1/8"

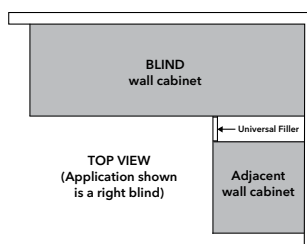

	Act.	Max	Door	Stile	Open (door side)
WBC2436	24"	27"	10 7/8"	6"	7 3/4"
WBC3636	36"	39"	22 3/8"	6"	19 3/4"

## 36" High Wall Cabinets

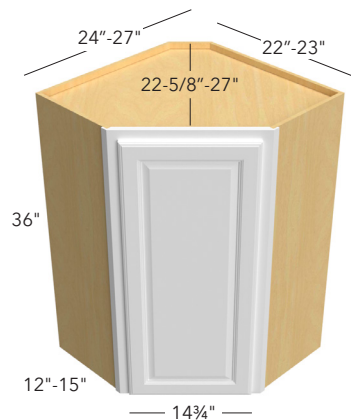

### 36" DIAGONAL CORNER

#### ITEM

WDC2436

WDC2736\*

- \* Cabinet exposed sides come pre-finished with near-flush finished ends.
- Uses  $\frac{3}{8}$ " overlay hinge
- Lazy Susan pg. 27

### 36" GLASS DOOR

#### ITEM

GD1236

GD1536

GD1836

GD2436♦

GDD2436\*

GD3036♦

GD3636♦

- \* 14 3/4" wide for WDC2436 & WDC2736
- ♦ Cost is for a single door - must order quantity of 2 doors per cabinet
- Glass doors are pre-installed with clear glass only



## 42" High Wall Cabinets



### 42" HIGH

#### ITEM

W0942

W1242

W1542

W1842

W2142

- *Peninsula cabinet modification pg. IX*



### 42" HIGH

#### ITEM

W2442

W2742

W3042

W3342

W3642

- *Peninsula cabinet modification pg. IX*



### 42" HIGH

#### ITEM

W3942

- *1½" center stile*
- *Peninsula cabinet modification pg. IX*

## 42" High Wall Cabinets

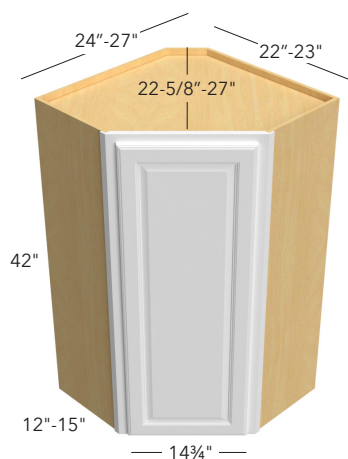

### 42" SINGLE DOOR BLIND

#### ITEM

WBC2442

WBC3642

- Must use filler on adjacent side (not supplied)
- Measurements are rounded off to closest 1/8"

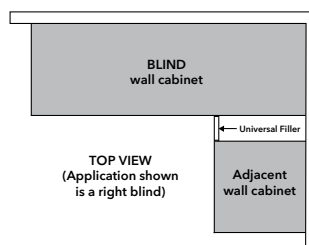

	Act.	Max	Door	Stile	Open (door side)
WBC2442	24"	27"	10 3/8"	6"	7 3/4"
WBC3642	36"	39"	22 3/8"	6"	19 3/4"

### 42" DIAGONAL CORNER

#### ITEM

WDC2442

WDC2742\*

- \* Cabinet exposed sides come pre-finished with near-flush finished ends.
- Uses 3/8" overlay hinge
- Lazy Susan pg. 27

### 42" GLASS DOOR

#### ITEM

GD1242

GD1542

GD1842

GD2442♦

GDD2442\*

GD3042♦

GD3642♦

- \* 14 3/4" wide for WDC2442 & WDC2742
- ♦ Cost is for a single door - must order quantity of 2 doors per cabinet
- Glass doors are pre-installed with clear glass only

## Specialty Wall Cabinets



### DOOR PREPPED FOR GLASS

ITEM
DFG1230
DFG1236
DFG1242
DFG1530
DFG1536
DFG1542
DFG1830
DFG1836
DFG1842
DFG2430*
DFG2436*
DFG2442*
DFG3030*
DFG3036*
DFG3042*
DFG3630*
DFG3636*
DFG3642*

- Glass not included
  - Comes with the center panel removed; vinyl gasket is included for easy installation of glass in the field.
- \* Cost is for a single door, need to order quantity of 2 doors per cabinet

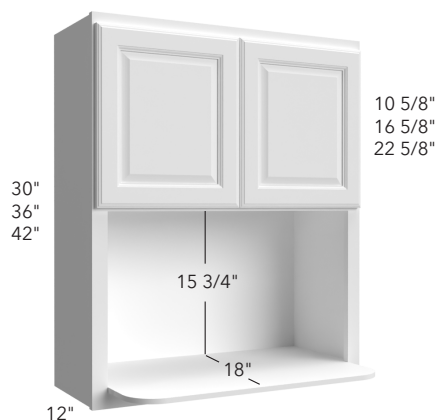

### MICROWAVE

ITEM
MW3030
MW3036
MW3042

## Specialty Wall Cabinets

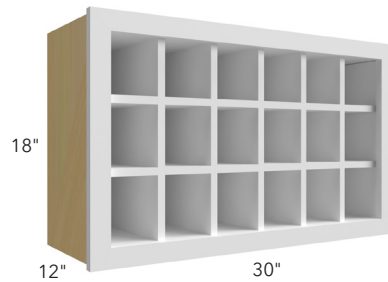

NOTE: DESIGN CHANGE

### WINE RACK

#### ITEM

WR3018

- Finished interior
- 1-½" Framed cabinet construction
- Fits 18 bottles

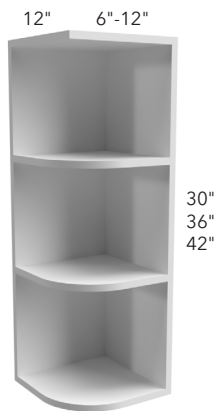

### OPEN END

#### ITEM

OE1230

OE1236

OE1242\*

- Comes as 12" (Fabuwood will cut to 6" at no charge)
- \* Has three shelves

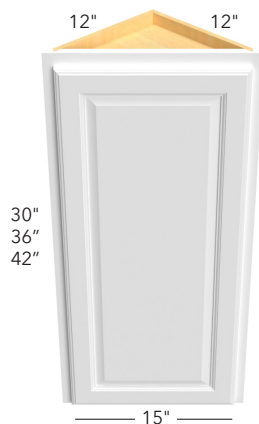

### ANGLE END

#### ITEM

WAE1230

WAE1236\*

WAE1242\*

- Can use glass door from a Diagonal Corner Wall cabinet - will require a 1" overlay hinge
- Adjustable shelves
- \* Has three shelves



## Base Cabinets



### SINGLE DOOR

ITEM
B09
B12
B15
B18
B21

- *B09 accessories pg. 25*
- *Peninsula cabinet modification pg. IX*
- *Roll Outs pg. 23*



### DOUBLE DOOR

ITEM
B24
B27
B30

- *Peninsula cabinet modification pg. IX*
- *Roll Outs pg. 23*



### DOUBLE DOOR & DRAWER

ITEM
B33
B36
B39*
B42*

- \* *Has 3" center stile*
- *Roll Outs pg. 23*

## Base Cabinets

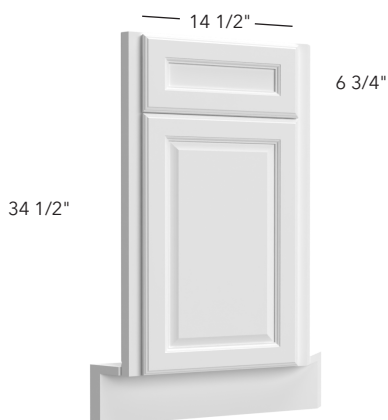

### DRAWER

#### ITEM

DB12

DB15

DB18

DB24

DB30

DB36

### BLIND

#### ITEM

BLB36/39

BLB42/45

BLB48/51

- Must use filler on adjacent side (not supplied)
- Measurements are rounded off to closest 1/8"

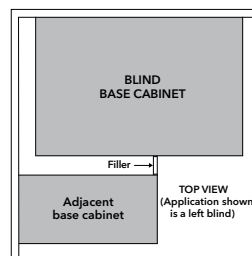

	Act.	Min.	Max	Door	Stile	Open
BLB36/39	27"	36"	41 1/4"	10 1/2"	8"	8"
BLB42/45	39"	42"	47 1/4"	15 1/4"	9"	14"
BLB48/51	48"	48"	52"	21 1/4"	7 1/4"	18 3/4"

### DIAGONAL SINK FRONT

#### ITEM

DSF36\*

DSFL36\*\*

- Uses 3/8" overlay hinge
- Tilt Out pg. 29
- \* DSF36 The sink front has a 17" face dimension.
- \*\* DSFL36 The floor must be ordered separately

## Base Cabinets

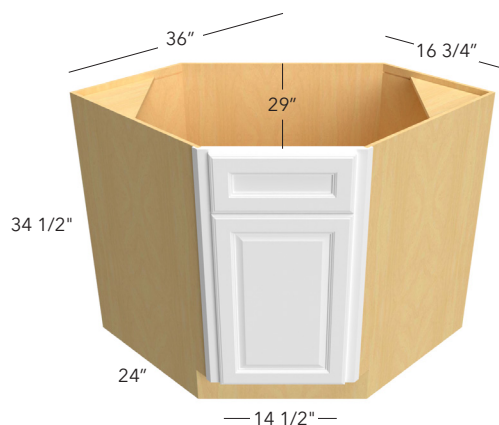

### DIAGONAL SINK

#### ITEM

DSB36

- Uses  $\frac{3}{8}$ " overlay hinge
- Tilt Out pg. 29

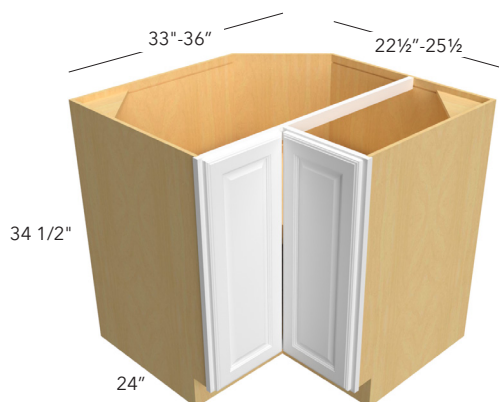

### LAZY SUSAN

#### ITEM

LSB33

LSB36

- Once assembled, door cannot be reversed
- Both wooden Lazy Susan trays rotate independently
- Center tray is mounted on 15mm ( $\frac{9}{16}$ " ) adjustable shelf

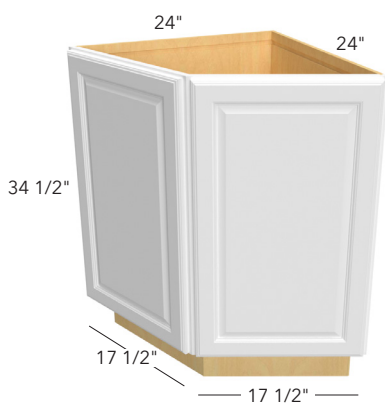

### RETURN ANGLE

#### ITEM

BRA24

- Door width: 17  $\frac{1}{2}$ "
- Adjustable shelving

## Base Cabinets



**BASE TRANSITIONAL  
RIGHT SHOWN**

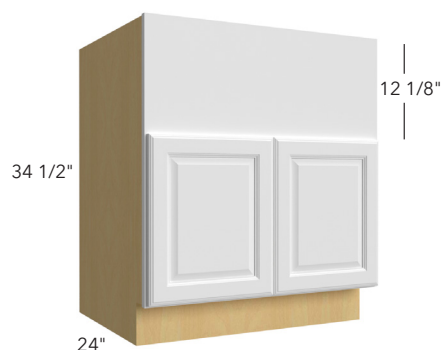
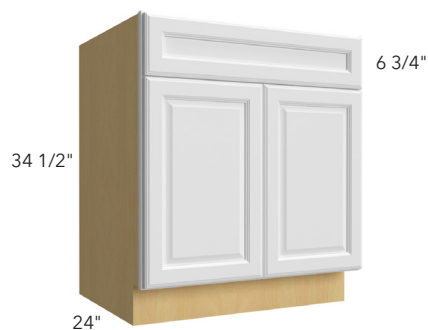

### TRANSITIONAL

#### ITEM

BTR12

BTL12

- Cabinet exposed side comes pre-finished with near-flush finished end.
- Cabinet unexposed side comes flush and is not able to have a loose skin or applied finished end. If Interior side needs to be finished, please reach out to Customer Service to have a quote for this modification.

### SINK

#### ITEM

SB24

SB27

SB30

- Tilt Out pg. 29

### SINK

#### ITEM

SB33

SB36

SB39\*

SB42\*

- Tilt Out pg. 29
- \* Has a 3" center stile

### FARM SINK

#### ITEM

FS30

FS33

FS36

- Cut opening on job site
- Frame has a full closed top panel Maximum cutout height 12"
- Maximum cutout width 1½" less than the cabinet size

**Note:** To avoid damage please apply extra care when cutting the front panel.

## Tall Pantry Cabinets



### SINGLE DOOR

#### ITEM

TP152484

TP182484

TP152490

TP182490

TP152496

TP182496

- 84" high - 5 shelves
- 90" & 96" high - 6 shelves
- 18" deep shelves
- Roll Outs pg. 23



### DOUBLE DOOR

#### ITEM

TP242484

TP302484

TP242490

TP302490

TP242496

TP302496

- 84" high - 5 shelves
- 90" & 96" high - 6 shelves
- 18" deep shelves
- Roll Outs pg. 23

## Oven Cabinets

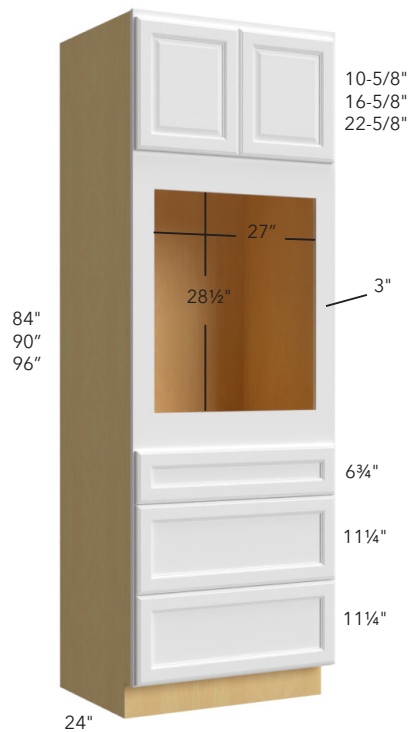

### OVEN CABINET SINGLE WITH 3 DRAWERS

#### ITEM

OC3384S

OC3390S

OC3396S

- \* Has one shelf in top cabinet.
- 3" Wide rails face frame to be trimmed on site

#### When using a Single Oven:

- Wide rails face frame to be trimmed on side
- Minimum Width opening 27"
- Maximum **cut out** width 31"
- Minimum Height opening 28 1/2"
- Maximum **cut out** height is 37"
- Maximum **overall** oven Height 37 1/2"

Full panel face frame to be trimmed on site (not by Fabuwood).

**Note:** To avoid damage to the frame & side panels, please apply extra care when cutting the front panel.

### SPECIFICATION FOR OVEN CABINET

Tall Oven Cabinets come with single fixed shelf above top drawer.  
Fixed shelf will be located above the uppermost drawer; location is based on the selected configurations: Single  
Frame is to be trimmed on site to accommodate configuration & appliance needs.

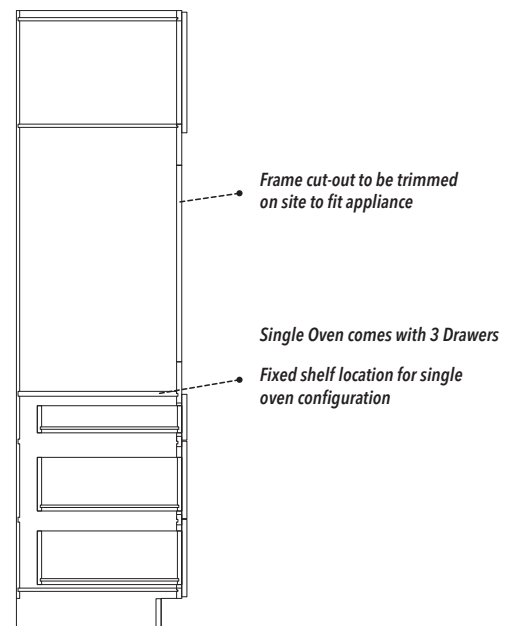

## Oven Cabinets



### OVEN CABINET COMBO WITH 2 DRAWERS

#### ITEM

OC3384C

OC3390C

OC3396C

- \* Has one shelf in top cabinet.
- 3" Wide rails face frame to be trimmed on site

#### When using a Combo Oven:

- Wide rails face frame to be trimmed on side
- Minimum Width opening 27"
- Maximum **cut out** width 31"
- Minimum **cut out** height 39 3/8"
- Maximum **cut out** height is 44"
- Maximum **overall** oven Height 44 5/8"

#### When using two appliances:

Will need to insert a filler and fixed shelf to support top appliance, filler and shelf to be purchased separately

Full panel face frame to be trimmed on site (not by Fabuwood).

**Note:** To avoid damage to the frame & side panels, please apply extra care when cutting the front panel.

### SPECIFICATION FOR OVEN CABINET

Tall Oven Cabinets come with single fixed shelf above top drawer.  
Fixed shelf will be located above the uppermost drawer; location is based on the selected configurations: Combo  
Frame is to be trimmed on site to accommodate configuration & appliance needs.

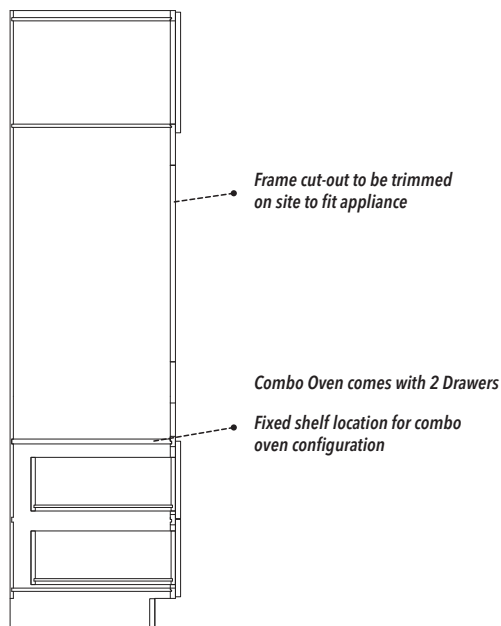

## Oven Cabinets

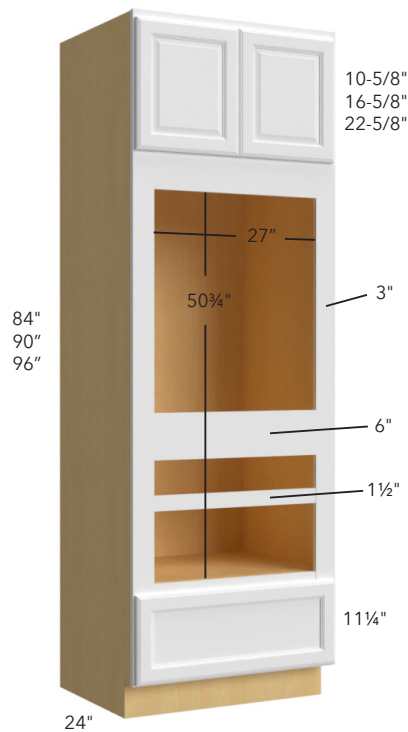

### OVEN CABINET DOUBLE WITH 1 DRAWER

#### ITEM

OC3384D

OC3390D

OC3396D

- \* Has one shelf in top cabinet.
- 3" Wide rails face frame to be trimmed on site

#### When using a Double Oven:

- Wide rails face frame to be trimmed on side
- Minimum Width opening 27"
- Maximum cut out width 31"
- Minimum cut out height is 50 3/4"
- Maximum cut out height is 55 1/2"
- Maximum overall oven Height 56"

#### When using two appliances:

Will need to insert a filler and fixed shelf to support top appliance, filler and shelf to be purchased separately

Full panel face frame to be trimmed on site (not by Fabuwood).

**Note:** To avoid damage to the frame & side panels, please apply extra care when cutting the front panel.

### SPECIFICATION FOR OVEN CABINET

Tall Oven Cabinets come with single fixed shelf above top drawer.  
Fixed shelf will be located above the uppermost drawer; location is based on the selected configurations: Double  
Frame is to be trimmed on site to accommodate configuration & appliance needs.

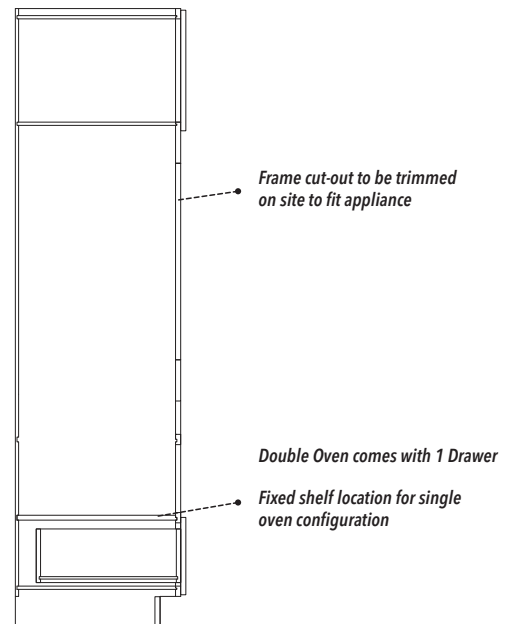



## Vanities

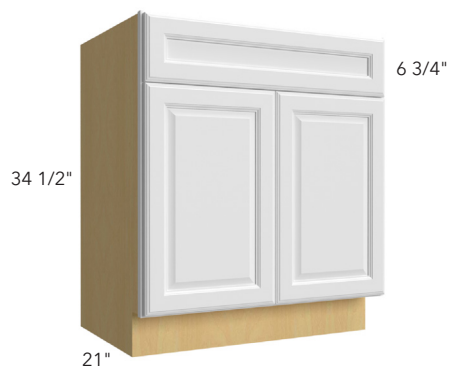

### 34 1/2" HIGH VANITY SINK BASE

#### ITEM

VSB24-34

VSB30-34



### 34 1/2" HIGH VANITY SINK BASE

#### ITEM

VSB36-34



### 34 1/2" HIGH VANITY DRAWER BASE

#### ITEM

VDB12-34

VDB15-34

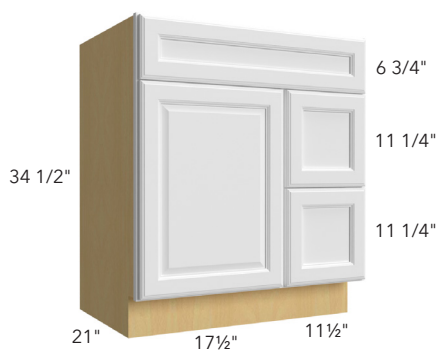
**VSD30DR SHOWN**

### VANITY SINK BASE COMBO

#### ITEM

VSD30DR

VSD30DL

*Need to select drawer on right or left side, cabinet can't be reversed R/L after assembled.*

## Vanities

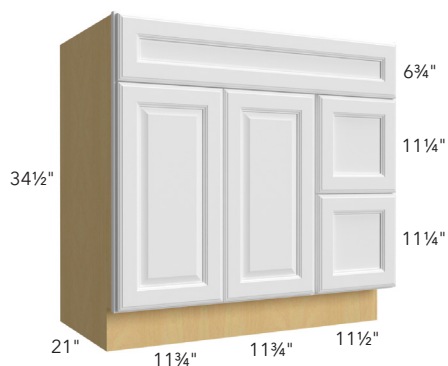

**VSD36DR SHOWN**

### VANITY SINK BASE COMBO

#### ITEM

VSD36DR

VSD36DL

*Need to select drawer on right or left side, cabinet can't be reversed R/L after assembled.*

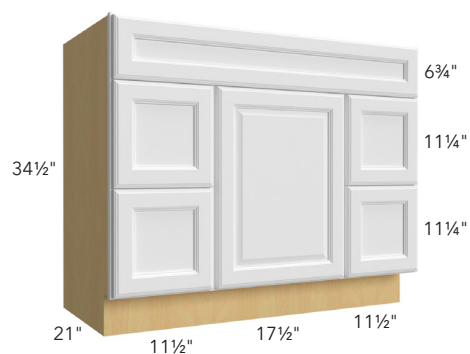

### VANITY SINK BASE COMBO

#### ITEM

VSD42 (34" high)



### VANITY SINK BASE COMBO

#### ITEM

VSD48 (34" high)

## Waste Solutions / Accessories



TC15

### TRASH CAN

#### ITEM

TC15

TC18

TC21

- Cabinet not included, cabinet must be ordered separately
- Full extension slides (not soft-close)
- 35 qt. can(s) included
- \* One garbage can and one bags bin



TC15

### TRASH CAN (W/ BLUM SLIDES)

#### ITEM

TC15 BLUM

TC18 BLUM

TC21 BLUM

TCV15 BLUM♦

- Tandem plus Blumotion full extension concealed drawer runners
- Cabinet not included, cabinet must be ordered separately
- 2 - 35 qt. cans included
- \* Single 35 qt. can + one bags bin
- ♦ Smaller depth for vanity cabinets 21" deep



TC15FHD BLUM

### TRASH CAN FULL HEIGHT DOOR (W/ BLUM SLIDES)

#### ITEM

TC15FHD BLUM

TC21FHD BLUM

- Tandem plus Blumotion full extension concealed drawer runners
- Cabinet not included, cabinet must be ordered separately
- 2 - 50 qt. can included
- Includes installation
- Not for ADA cabinet use
- FULL-DOORS modification is required
- \* Single 50 qt. can + one bags bin

## Base / Accessories



### ROLL OUT (PARTIAL EXTENSION BLUM SLIDES)

#### ITEM

ROD-B15 BLUM E

ROD-B18 BLUM E

ROD-B21 BLUM E

ROD-B24 BLUM E

ROD-B27 BLUM E

ROD-B30 BLUM E

ROD-B33 BLUM E

ROD-B36 BLUM E

- Cabinet not included
- Price is for a single Roll Out drawer
- Blumotion partial extension concealed drawer runners
- Drawers are adjustable
- Can be used for pantries



### ROLL OUT (FULL EXTENSION BLUM SLIDES)

#### ITEM

ROD-B15 BLUM H

ROD-B18 BLUM H

ROD-B21 BLUM H

ROD-B24 BLUM H

ROD-B27 BLUM H

ROD-B30 BLUM H

ROD-B33 BLUM H

ROD-B36 BLUM H

- Cabinet not included
- Price is for a single Roll Out drawer
- Blumotion full extension concealed drawer runners
- Drawers are adjustable
- Can be used for pantries

## Base / Accessories



### TWO-TIER COOKWARE ORGANIZER

#### ITEM

CWO-B18 BLUM

CWO-B24 BLUM

- Cabinet not included
- Full-extension Blum slides
- Pegboard bottoms
- 4 Press-in pegs included



### 3" TOWEL BAR PULL OUT

#### ITEM

TBPO-BF3

- Filler & Overlay Filler are required and need to be ordered separately
- 2 Towel bars
- Single static shelf with chrome wire accents
- UV coated maple wood
- Installed on site
- Installed between two cabinets
- Full-extension, ball-bearing slides with soft-close



### SPICE PULL OUT BASE 9"

#### ITEM

SPO-B9

SPO-B9 BLUM

- Cabinet not included, cabinet must be ordered separately
- FULL-DOORS modification is required
- Chrome rails
- Adjustable shelves
- UV coated maple wood
- \* Full extension ball-bearing slides (not soft-close)

## Storage / Accessories



### UTENSIL PULL OUT BASE 9" (W/ BLUM SLIDES)

#### ITEM

UPO-B9 BLUM

- Cabinet not included, cabinet must be ordered separately
- FULL-DOORS modification is required
- Chrome rails
- Adjustable shelves
- UV coated maple wood
- Features Blumotion soft-close drawer slides



### UTENSIL & KNIFE PULL OUT

#### ITEM

UKBPO-B12 BLUM

- Cabinet not included, cabinet must be ordered separately
- FULL-DOORS modification required
- Knife block features flex rod technology that adjust to securely hold knives
- Chrome rails
- Adjustable top shelf
- 2 qt. removable stainless steel bin included
- 4 flexible plastic cutting mats included
- UV coated maple wood
- Features Blumotion soft-close drawer slides



### TRAY DIVIDER PULL OUT BASE 9" (W/ BLUM SLIDES)

#### ITEM

TDPO-B9 BLUM

- Cabinet not included, cabinet must be ordered separately
- FULL-DOORS modification is required
- UV coated maple wood
- Features Blumotion soft-close drawer slides

## Base & Wall / Accessories



### SPICE PULL OUT BASE FILLER

#### ITEM

SPO-BF3\*

SPO-BF6\*

SPO-BF3 BLUM

SPO-BF6 BLUM

- Filler & Overlay Filler are required and need to be ordered separately
- Chrome rails
- Adjustable shelves
- UV coated maple wood
- Installed on site
- Installed between two cabinets
- Not for ADA cabinet use
- Wall filler 30" high is recommended instead of a base filler, requires to build toe kick separately

\* Full extension ball-bearing slides (not soft-close)

### SPICE PULL OUT WALL FILLER

#### ITEM

SPO-WF330

SPO-WF336

SPO-WF342

SPO-WF630

SPO-WF636

SPO-WF642

- Filler & Overlay Filler are required and need to be ordered separately
- Chrome rails
- Full extension ball-bearing slides (BLUM soft-close slides not available)
- Adjustable shelves
- UV coated maple wood
- Installed on site
- Installed between two cabinets
- Wall filler 30" high is recommended instead of a base filler, requires to build toe kick separately

## Wall / Accessories

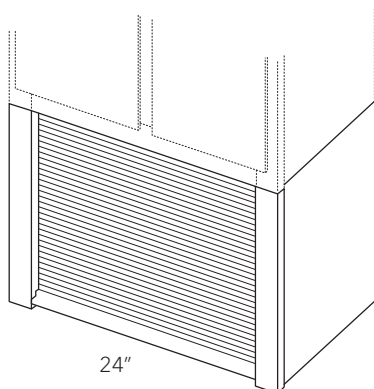
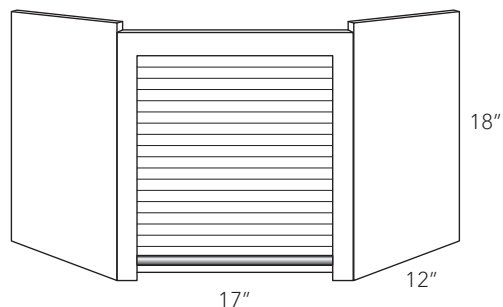
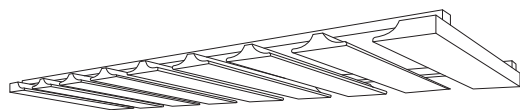

### LAZY SUSAN

ITEM	
PLASTIC	LSP24 30
	LSP24 36/42
WOOD	LSW24 30
	LSW24 42
	LSW27 30*
	LSW27 42*

- Adjustable metal post
- 42" lazy susan has 3 trays
- Prepared for installation at job site
- 42" poles can be cut to fit 36" high cabinet
- \* 20" trays

### STEMWARE RACK

ITEM	
STEMWARE 30	
STEMWARE 36	

- Comes unfinished. Product finished per order. May have extended ETA.

### CORNER APPLIANCE GARAGE

ITEM	
APPLIANCE GARAGE	

- Comes unfinished. Product finished per order. May have extended ETA.
- Designed to be installed under a diagonal corner wall 24".

### STRAIGHT APPLIANCE GARAGE

ITEM	
APPLIANCE GARAGE 24"	

- Comes unfinished. Product finished per order. May have extended ETA.
- Designed to be placed under a 24" wide wall cabinet.
- Stiles are 2" wide



## Wall / Accessories



### STAINLESS STEEL FLOATING SHELF

ITEM
SSFLS24
SSFLS30
SSFLS36

- *Hanging bracket included*
- *Dimensions:*  
*Width: 24", 30", 36"*  
*Height - 2½"*  
*Depth - 10"*

## Sink / Accessories



### TILT OUT

#### ITEM

TILTOUT 11"

TILTOUT 14"

TILTOUT 24"

- *White plastic tray*

## Drawer / Accessories



### TIERED DEEP DRAWER

#### ITEM

DTD-DB30 BLUM

DTD-DB36 BLUM

- For DB30 & DB36 only
- Replaces the original drawer box of cabinet
- UV coated maple wood
- Drawer front not included
- 3 drawer compartments
- Blumotion full extension concealed drawer runners



### CUTTING BOARD & KNIFE DRAWER

#### ITEM

CBKD-B18 BLUM

- For 18" cabinet drawer only
- Replaces the original drawer box of cabinet
- UV coated maple wood
- Up to 4 compartments and built-in knife organizer
- 1 wooden cutting board
- Blumotion full extension concealed drawer runners



### CHARGING DRAWER

#### ITEM

CHD-B18 BLUM

- For 18" cabinet drawer only
- Replaces the original drawer box of cabinet
- UV coated maple wood
- Blumotion full extension concealed drawer runners
- (2) 120V plugs and (2) 201 amp USB ports
- Tamper resistant outlets
- Max current: AC: 12 amps @ 120VAC; USB 2.1 amp & 5 VDC
- Power cord with NEMA 5 - 15 plug
- Integrated cord guide to ensure safe operation
- Shock absorbent mat, black
- Overall safety of this product is determined by its end use

## Drawer / Accessories



### 2-TIER CUTLERY DRAWER

#### ITEM

DCD-15 BLUM

DCD-18 BLUM

DCD-21 BLUM

DCD-24 BLUM

- *UV coated maple wood*
- *Includes complete 3¾" high drawer box*
- *Blumotion full extension concealed drawer runners*



### 2-TIER CUTLERY COMBO DRAWER

#### ITEM

DCD-30 BLUM

DCD-36 BLUM\*

- *UV coated maple wood*
- *Includes complete 3¾" high drawer box*
- \* *For DB36 only*



### TRIMMABLE KNIFE DIVIDER

#### ITEM

DKI-18/24

- *UV coated maple wood*
- *Total height: 2"*
- *¾" plywood bottom*

## Vanity / Accessories



### VANITY OUTLET GROOMING ORGANIZER

#### ITEM

VGO12FD BLUM

- Cabinet not included, cabinet must be ordered separately
- FULL-DOORS modification required
- 2 removable stainless steel bins included
- 2 shelves with non-skid vinyl lining and acrylic accents
- In-drawer receptacle with (2) 120V plugs
- Tamper-resistant outlets
- Max Current: AC: 12 amps @ 120VAC
- Power cord with NEMA 5 - 15 plug
- Integrated cord guide ensures safe operation
- Drawer stop prevents items from being stored "ON" inside the cabinet
- Its end-use determines the overall safety of this product
- UV coated maple wood
- Not for ADA cabinet use
- Blumotion full extension concealed drawer runners



### TRIMMABLE VANITY DRAWER ORGANIZER INSERT

#### ITEM

VDO

- Designed for 21" or smaller vanity base drawers
- Anti-skid vinyl lining
- Up to 13 compartments
- 2 clear acrylic lids
- UV coated maple wood



### VANITY APPLIANCE STORAGE RACK

#### ITEM

VASR-30

- Designed for 30" vanity base cabinet
- Mounts to inside of right or left door
- Non-skid lining on lower level shelf
- (2) 1.25 qt. stainless steel bins
- UV coated maple wood

## Vanity / Accessories



### VANITY ORGANIZER PULL OUT

#### ITEM

VOPO-24 BLUM

- Tandem plus Blumotion full extension drawer runners
- Designed for 24"-30" Vanity Sink Base
- Reversible
- 6 Acrylic bins included



### U-SHAPED VANITY SINK BASE PULL OUT

#### ITEM

UVTCPO-30 BLUM

- Tandem plus Blumotion full extension drawer runners
- Designed for 30" Vanity Sink Base, but works great in standard depth base cabinets as well
- Non-skid vinyl lining
- 4 adjustable dividers
- 8 qt. waste container included

*Any accessories can be ordered and installed through Fabuwood*

## Fillers / Accessories

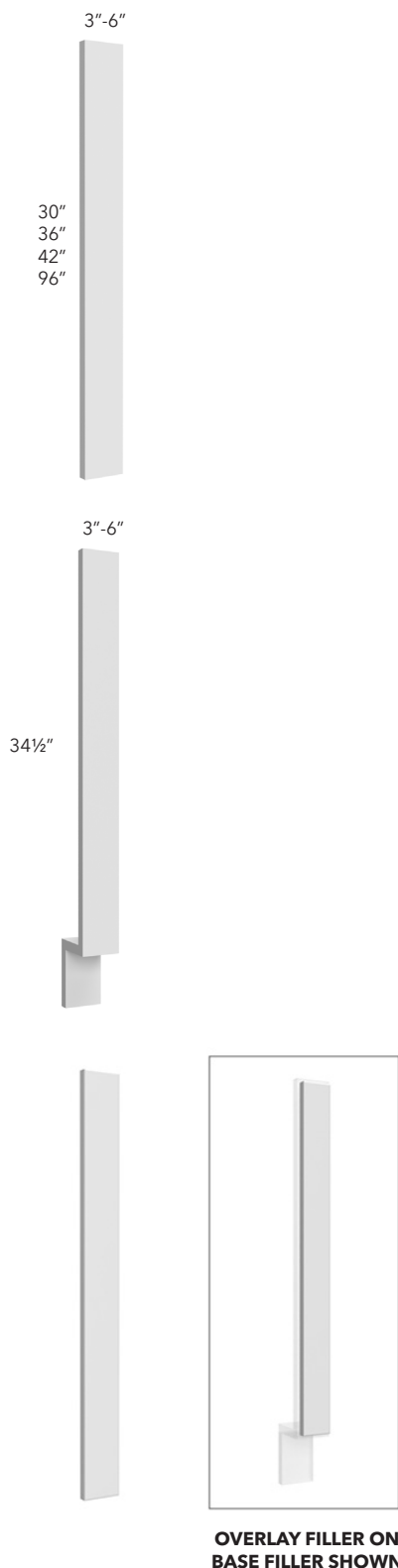

### WALL & TALL

ITEM
WF330
WF336
WF342
WF630
WF636
WF642
TF396
TF696

- 2 long edges are finished

### BASE

ITEM
BF3
BF6

- 2 long edges are finished

### OVERLAY

ITEM
OLFBF3
OLFBF6
OLF330♦
OLF336
OLF342
OLF630♦
OLF636
OLF642

- Overlay Base Filler is 29½" high
- Sides of filler are finished
- ♦ Will not fit for a base cabinet

## Valances / Accessories



**OGEE  
PROFILE**

### STRAIGHT

#### ITEM

VST96



**OGEE  
PROFILE**

### ARCHED

#### ITEM

VAR54



## Posts & Pilasters / Accessories

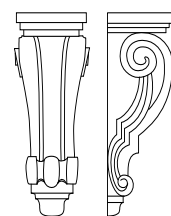

**CT**  
(H6½"xW3¾"xD3½")

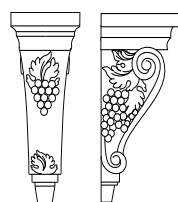

**CG**  
(H10"xW4⅝"xD5¼")

### CORNER POST

#### ITEM

CP36

- Must trim 2" from top or bottom

*Disclaimer: Pilasters are handmade and may therefore feature inconsistencies in shape or form. These are in no way considered defects.*

### PILASTER BASE

#### ITEM

PP-BASE

- Must trim 2" from top or bottom
- Features a toe kick block behind the pilaster

*Disclaimer: Posts are handmade and may therefore feature inconsistencies in shape or form. These are in no way considered defects.*

### PILASTER WALL

#### ITEM

PP-W30

PP-W36

PP-W42

*Disclaimer: Posts are handmade and may therefore feature inconsistencies in shape or form. These are in no way considered defects.*

### CORBELS

#### ITEM

CTS

CGS

*Disclaimer: Corbels are handmade and may therefore feature inconsistencies in shape or form. These are in no way considered defects.*

## Moldings (8') / Accessories

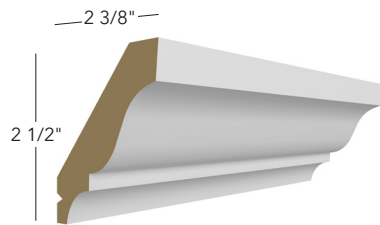

### SMALL CROWN

#### ITEM

CM-1

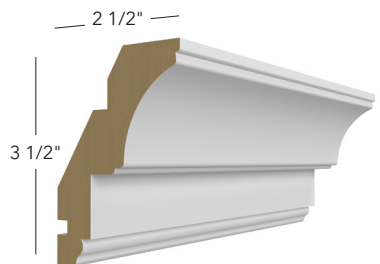

### ROYAL CROWN & INLAY

#### ITEM

TCM\*

RM

DM

\* Back-mounting cleat included

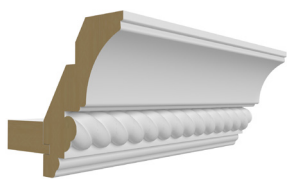

**ROPE  
MOLDING**

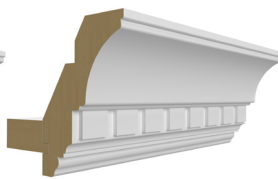

**DENTIL  
MOLDING**

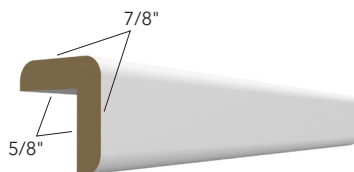

### OUTSIDE CORNER

#### ITEM

OCM8



### INSIDE CORNER

#### ITEM

ICM8

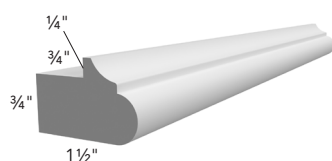

### LIGHT RAIL

#### ITEM

LRM

## Moldings (8') / Accessories



### QUARTER ROUND

ITEM

QRM



### SCRIBE

ITEM

SM8



### BATTEN

ITEM

BM3/4

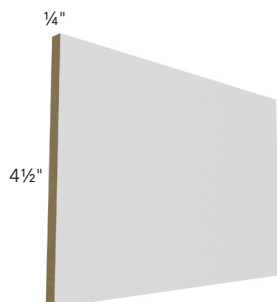

### TOE KICK

ITEM

TK8

- Matching color medium-density fiberboard toe kick

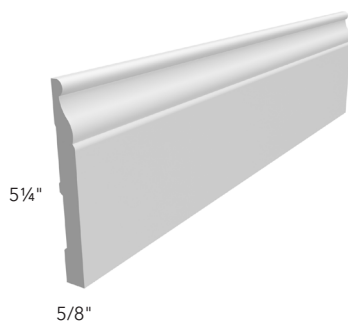

### BASE

ITEM

BBM

## Panels / Accessories

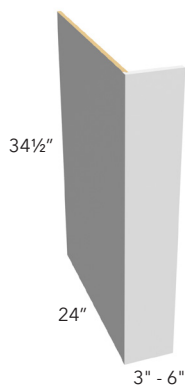

### DISHWASHER END PANEL

#### ITEM

DWR3

DWR6

- Sides are flush finished (no 1/4" reveal)

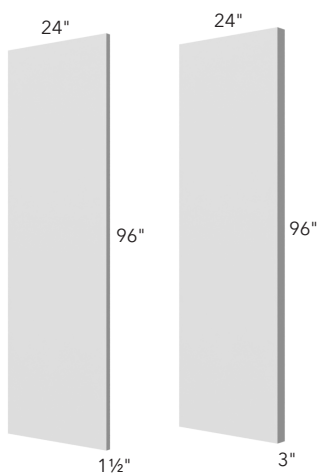

### REFRIGERATOR END PANEL WITH RETURN

#### ITEM

REP1-1/2

REP3

- Sides are flush finished (no 1/4" reveal)

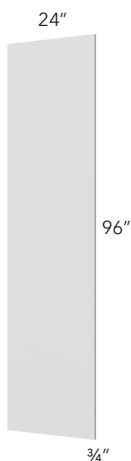

### REFRIGERATOR END PANEL

#### ITEM

REP2496

- Edge banded on both 96" sides.

## Panels / Accessories



### WAINSCOT

#### ITEM

WP-BASE

WP-W30

WP-W36

WP-W42

WP-T84

WP-T90

WP-T96

- BASE - 23-1/2" X 29-1/2"
- W30 - 11-1/2" X 28-5/8"
- W36 - 11-1/2" X 34-5/8"
- W42 - 11-1/2" X 40-5/8"
- TALL WIDTH - 11-3/4" each door
- TALL BOTTOM DOORS ARE 49-1/4"H

*Tall panels can be used for 12"D Pantry by using 2 pieces from the set of 4.*

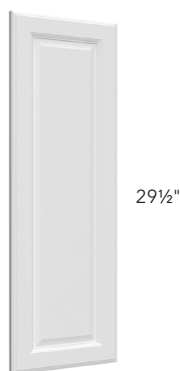

8 1/2", 11 1/2", 14 1/2", 17 1/2", 20 1/2"

### DECO DOOR

#### ITEM

DD B09FD

DD B12FD

DD B15FD

DD B18FD

DD B21FD

- Door height is 29-1/2"
- Door width is same as door on cabinet

*Wainscot Panels may come with hinge holes pre-drilled on the back of the door*

## Panels / Accessories

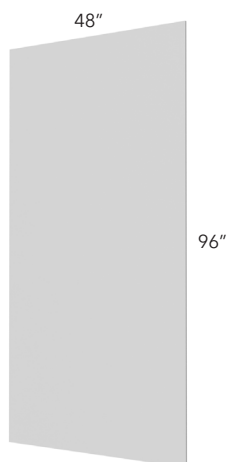

### PLYWOOD

#### ITEM

PAN-1/4

PLY-1/2

PLY-3/4

- *Finished 2 sides only*

### TOUCH UP KIT

#### ITEM

TOUCH UP KIT

[illegible]

## This image shows a single sheet of white paper with horizontal ruling lines. The lines are evenly spaced and run across the width of the page. There are no margins, text, or other markings on the paper.



Copyright © 2022 by Fabuwood Cabinetry Corp.

All rights reserved.

No part of this publication may be reproduced, distributed, or transmitted in any form or by any means, including photocopying, scanning, or other electronic or mechanical methods, including online sharing, without the prior written permission of Fabuwood Cabinetry Corp.



69 Blanchard Street | Newark, NJ 07105 | T: (201) 432-6555 | F: (201) 432-6055 | [www.fabuwood.com](http://www.fabuwood.com)

