

# TEDD WOOD

---

FINE CABINETRY

---



## FRAMELESS/FULL ACCESS INSTALLATION GUIDE



---

**LUXURY LINE**

---

FULL ACCESS CABINETRY

# FRAMELESS INSTALLATION STEPS

1. Open & Inspect for damages. *(If damages are discovered contact dealer/supplier immediately).*
2. Verify delivery vs Layout and note finished sides.
3. Mark space and cabinet positioning on walls.
4. Locate and mark studs for installation.
5. Check plumb and level of floor and walls.  
*(This should really be done during demo and room preparation).*
6. Determine high/low points of room.
7. Gage height differences and prepare shimming and graduation of cabinets on slope if any.
8. Verify window center and appliance locations.
9. Remove all doors and drawers from cabinets for clamping and easier installation.  
*(Stage where damages cannot occur. Must be careful to store properly).*
10. Begin installation with corner base cabinet. Shim cabinetry to be level and then attach to the wall.
11. Clamp cabinet cases together for screw installation.
12. Continue installation around the room from the corner outward on both walls and bases.

## ROOM PREPARATION

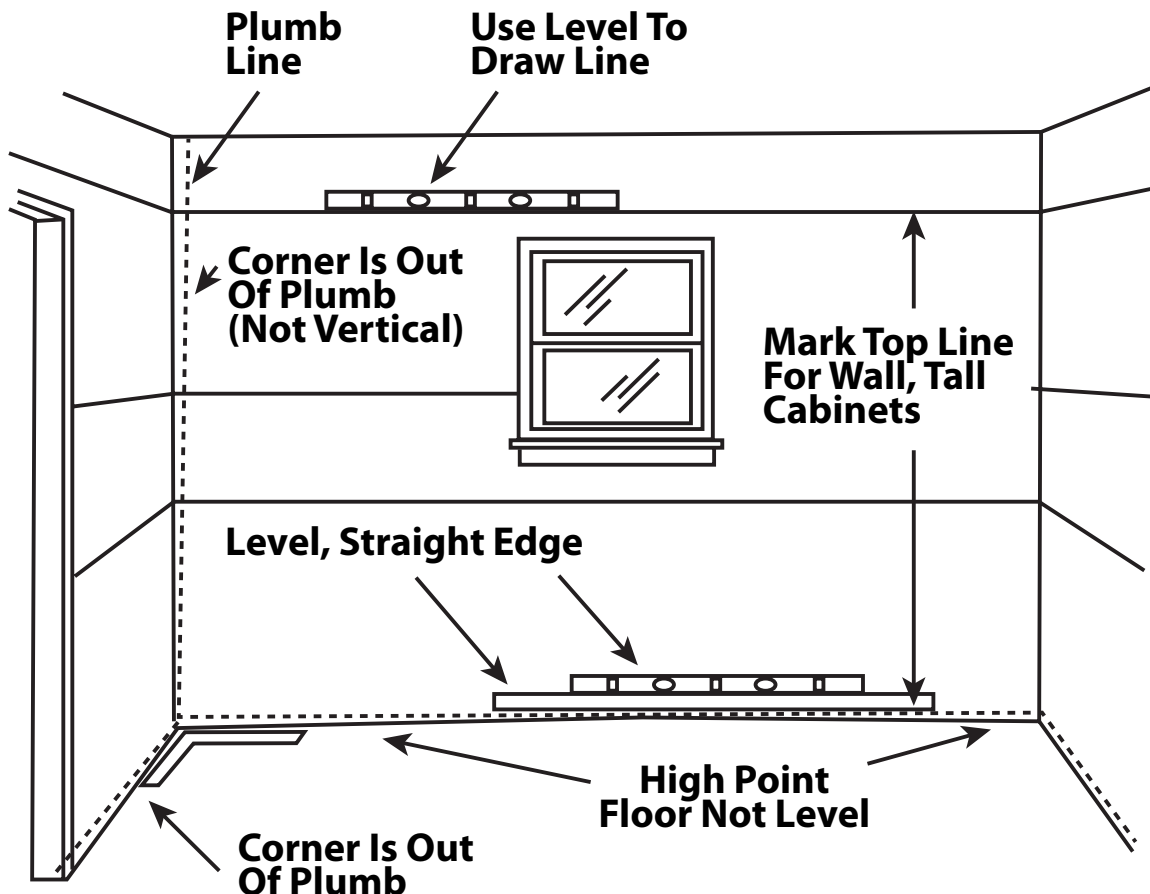

# FRAMELESS INSTALLATION

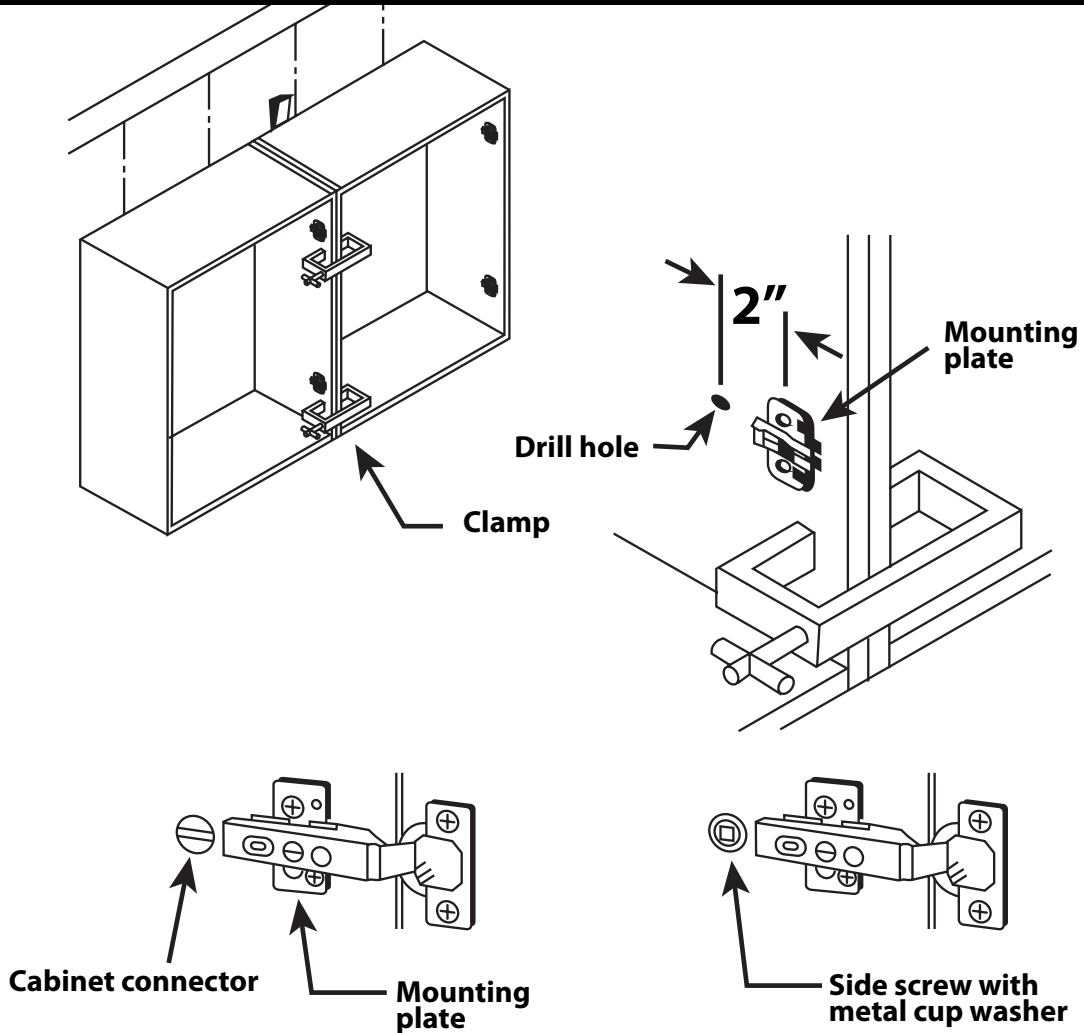

# ATTACHMENT OF FRAMELESS CABINETS

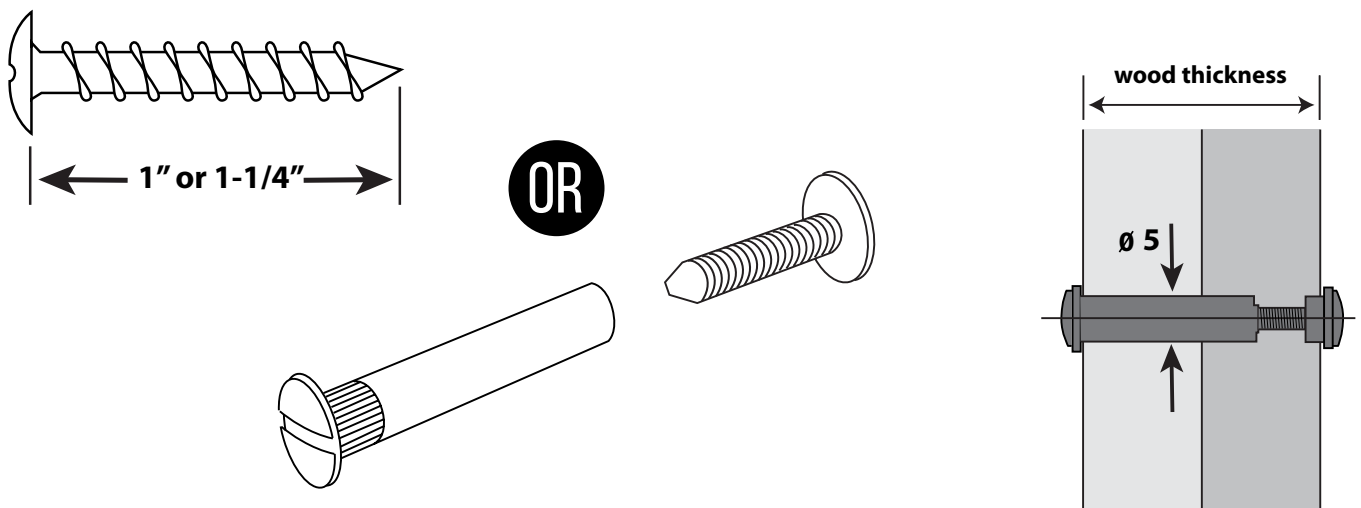

# CABINET LAYOUT ESSENTIALS

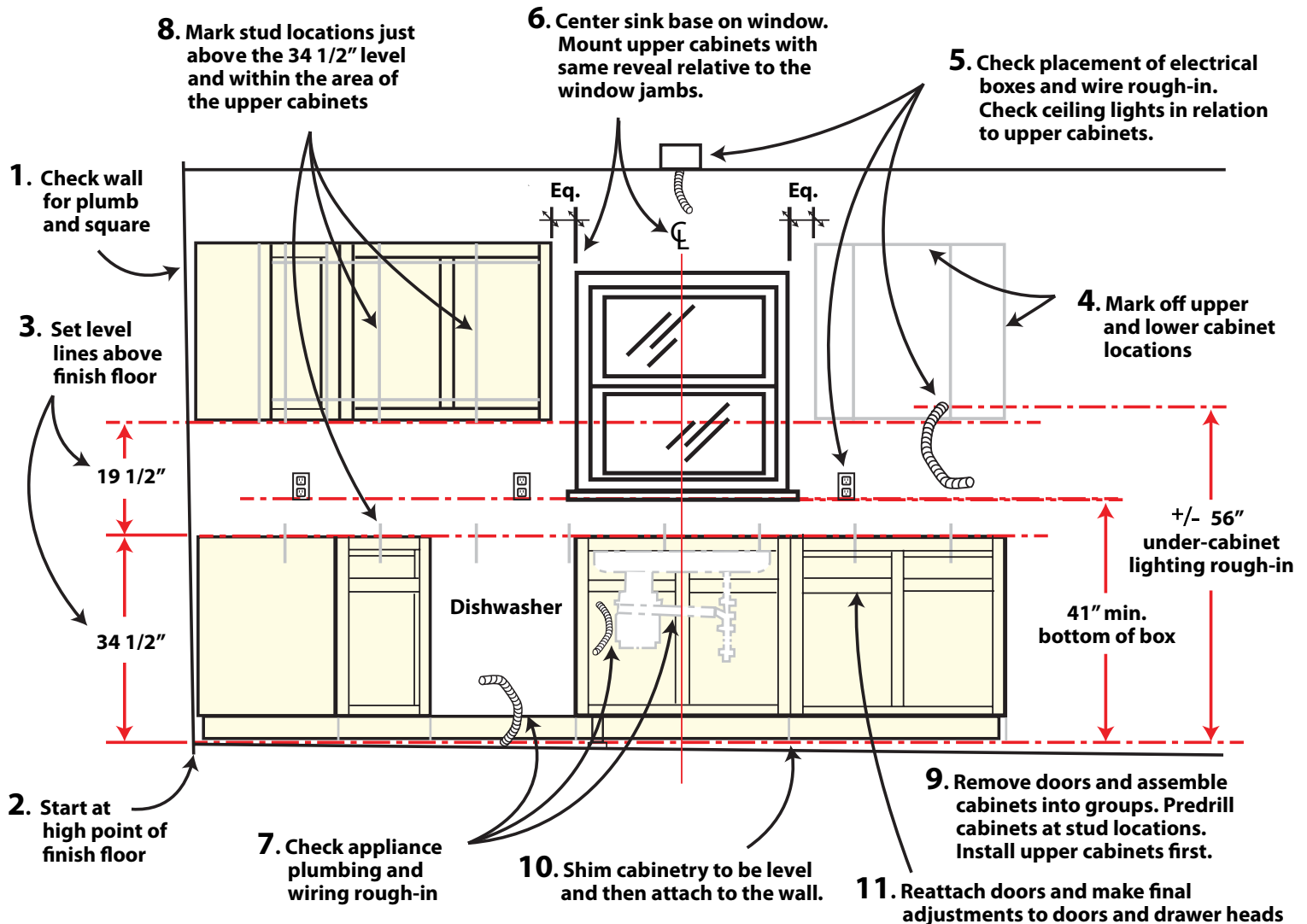

## FRAMELESS CABINETS

### Expectations & A Mindful Installation

#### Installation Challenges:

- Racking: Because full access cabinets do not have face frames they are more susceptible to "racking" out of square.
- Room preparation by the contractor is very important for a clean installation. The installer will need to be prepared and able to adapt to the conditions on site during his initial room assessment.
- All areas on walls or floor that are not plumb and/or level, the cabinets must be shimmed or trimmed so they are plumb and square during installation. Because of the tight 1/16th door reveals, all cabinets must remain square.

#### Expectations:

- Case assembly: Edge-banding tolerance. Alignment will be within width of the thickness of the edge-banding (1/2 mm). There should not be an expectation that the edge-banding will be perfectly flush where the box corners meet.