

Exposed Ends (EXP)

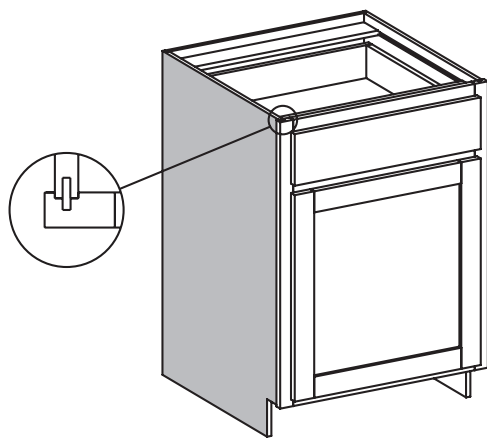

- Matching specie veneer on 1/2" thick cabinet sides.
- Specify: "L" (Left), "R" (Right) or "B" (Both).
- 1/4" reveal from edge of front frame to surface of the side.
- Hard Maple and Soft Maple cabinets have Hard Maple exposed ends.
- 1/2" thick Exposed End Option not available with Colourtones, primers or Prism Paints. If primed or painted finishes are desired, cabinets must be ordered with Flush End Option.
- Use Conestoga's online ordering system, Con-Nex or Conestoga order entry for pricing.

Flush Ends (FL)

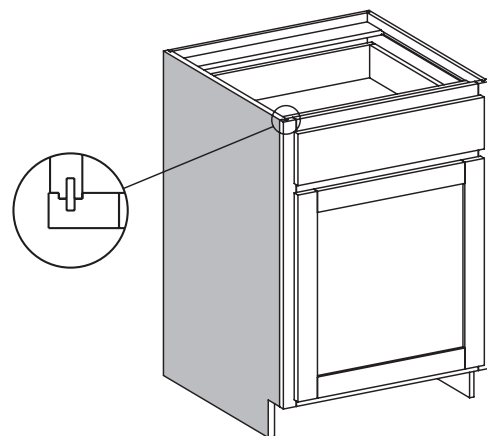

- Matching specie veneer on exposed of 3/4" thick cabinet sides.
- Specify: "L" (Left), "R" (Right) or "B" (Both).
- 1/32" reveal from edge of front frame to surface of the side.
- Hard Maple and Soft Maple cabinets have Hard Maple flush ends.
- All cabinets ordered with Colourtone, primer or Prism Paints will use a hybrid side panel.
 - ♦ Hybrid plywood side panels with Flush Ends have a paintable paper-coated MDF exterior and UV topcoated White Birch interior.
 - ♦ Hybrid plywood side panels on cabinets with both Flush Ends and Matching Interior will have a paintable MDF surface on both sides.
- Use Conestoga's online ordering system, Con-Nex or Conestoga order entry for pricing.

Flush Unexposed Ends (FUE)

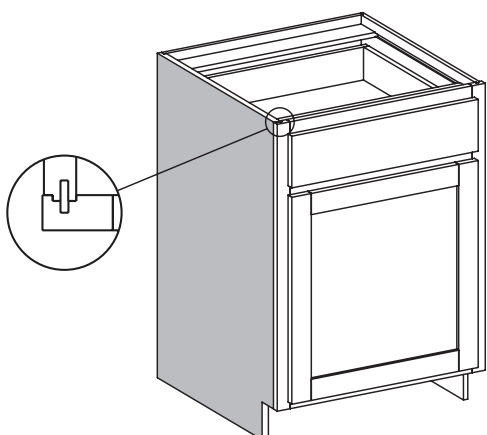

- Shop-grade veneer on exterior face of 3/4" thick cabinet sides – finishing is not available.
- Order when thicker, non-exposed sides are required for solid surface and stone countertops.
- Matching interior not available.
- Specify: "L" (Left), "R" (Right) or "B" (Both).
- 1/32" reveal from edge of front frame to surface of the side.
- Use Conestoga's online ordering system, Con-Nex or Conestoga order entry for pricing.

Prep for False Door Side Option (PFD)

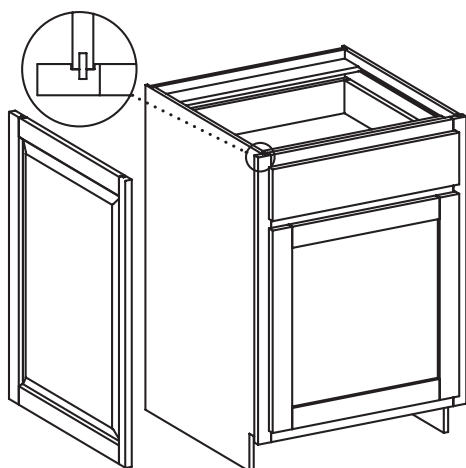

- Prepares the sides of Wall, Base, Tall or Vanity cabinets to accept 3/4" thick doors as decorative, integral cabinet sides.
- False doors not included, must be ordered separately.
- Cabinet carcass width is reduced to provide a 13/16" extension of the front frame on left, right or both sides. Overall cabinet front width remains unchanged.
- Left and right stiles are 1-1/2" wide.
- Specify: "L" (Left), "R" (Right) or "B" (Both).
- Available on most Wall, Base and Tall cabinets.
- Concealed Inset Hinges and Pull-Out Trays (POT's) are not available with Prepare for False Door Side Option.
- Order false door width 3/4" less than overall cabinet depth. Height of false door equals cabinet height.
- Use Conestoga's online ordering system, Con-Nex or Conestoga order entry for pricing.

False Door Side (FDS)

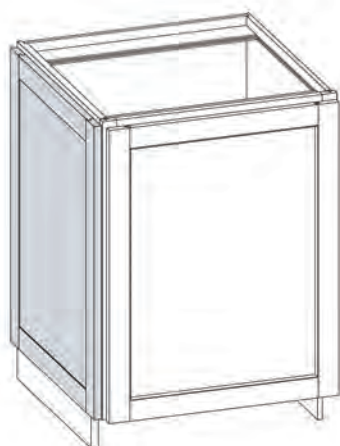

- Option calculates false door for decorative side appliques based on the overlay selected.
- Available in 1-1/4" and 1-3/8" overlays only.
- Minimum cabinet depth is 12".
- Option includes Flush End.
- Available with Custom Top Reveal (CTR) and Custom Bottom Reveal (CBR) Options. Calculation rules apply.
- Specify FDS "L" (Left), "R" (Right) or "B" (Both).
- Available on most Wall, Base and Tall cabinets.
- Use Conestoga's online ordering system, Con-Nex or Conestoga order entry for pricing.

Extend Side Back (ESB)

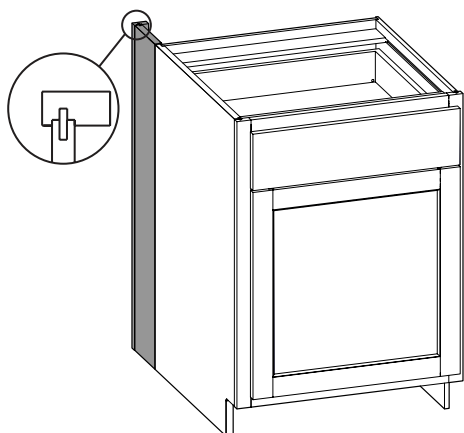

- Option extends cabinet side(s) to create island back seating space on most Base cabinets.
- Extension is customizable in 1/16" increments between 1" to 15" in depth.
- Maximum extension depth is 15".
- Extension edge can be ordered with end treatment options. Specify 1-1/2" to 3" width. The extension edge will receive a spline groove and a 3/4" thick stile will be grooved for standard Cabinet Systems spline assembly.
- Order 1/4" cut-to-size plywood to finish the inside of the extension and or the back of the island configuration.
- Use Conestoga's online ordering system, Con-Nex or Conestoga order entry for pricing.

Extended Height Option - Tall Cabinets

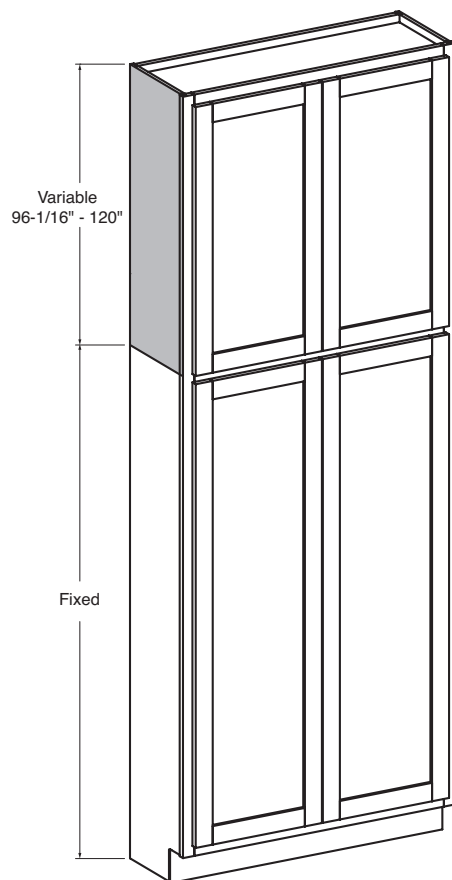

- Extended Height Option - Tall Cabinets
- Choose to extend height of Custom Size Tall Cabinets from 96-1/16" to 120".
- Available in Cherry and Hard Maple only.
- Flush ends only.
- Matching interiors not available. White Birch UV topcoated material will be used.
- Fixed section is based on cabinet configuration chosen.
- Separate 4" high toe platform is available in all heights and is strongly recommended for the extended height option.
- When cabinet height changes, top opening height changes accordingly.
- Maximum overall height is 120".
- 96-1/16" to 108" tall cabinet has eight shelves.
- 108-1/16" to 120" tall cabinet has nine shelves.
- Use Conestoga's online ordering system, Con-Nex or Conestoga order entry for pricing.

Toe Space Side Option (TSS)

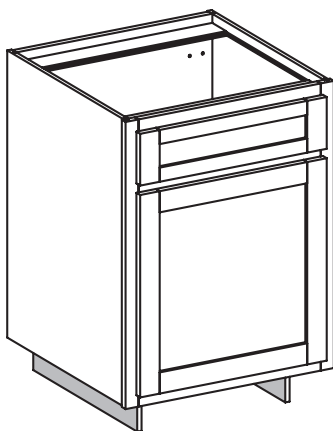

- Places standard toe space depth on the left, right or both sides of most base cabinets.
- Specify "TSS" – "L" (Left), "R" (Right) or "B" (Both).
- Toe Space Side is not available on the following cabinets: BLS, BSC, BCFD, BAE, BEAL/R, RTB, RTR, RTL, TCH, DB, DBFD, DB2D, DB3D, LF2D, ORS, DWEP, REP, BFC, WSUD and FS.
- Minimum cabinet width and depth is 15". TSS on both sides requires minimum depth of 18".
- Use Conestoga's online ordering system, Con-Nex or Conestoga order entry for pricing.

Plywood Toeboard Strips

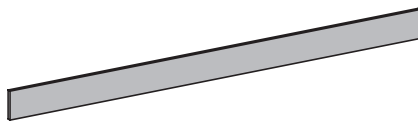

Plywood Toeboard Strips TE5003 (96" x 4")	
Specie	
Cherry	
Maple	
Oak, Red	

- 1/2" thick 96" x 4" plywood strips available in Cherry, Hard Maple or Red Oak.
- Order as a loose part; specify specie.
- Moulding Cut-Down Option is available on plywood Toeboard Strips to combat the exorbitant fees freight carriers are charging for packages 96" or longer.
- Option cuts down toestrip to 90".
- To order specify "Cut-Down to 90 Inch" Option.
- Upcharge applies; use Conestoga's online ordering system, Con-Nex or Conestoga order entry for pricing.

Plywood Toeboard Backer (PTB)

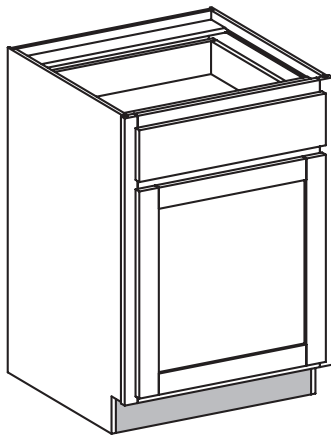

- 1/2" thick unfinished plywood strips.
- Designed to fully enclose Base, Tall and Vanity toe spaces and provide a backer for finished toeboards or mouldings.
- Backers are 4-15/16" high, sized to fit between cabinet sides in the toe space notch.
- To order, select Toeboard Backer Option.
- Use Conestoga's online ordering system, Con-Nex or Conestoga order entry for pricing.

Square Toe Kick Notch Option (STN)

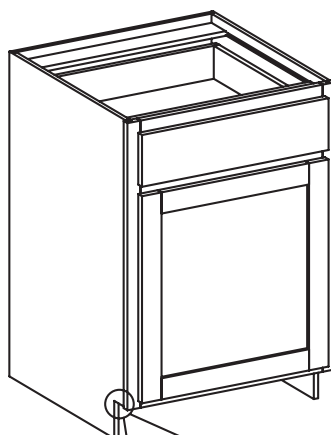

Standard 1/4" radius 90° square toe notch

- Intersecting corner of Square Toe Kick Notch is 90°.
- Aids in Toeboard moulding installation.
- Available on most Base, Tall and Vanity cabinets.
- Not available with Flush Toe or Shaped Bottom Rail Options.
- Use Conestoga's online ordering system, Con-Nex or Conestoga order entry for pricing.

Extended Stiles (EXT)/Custom Extended Stiles (CSEXT)

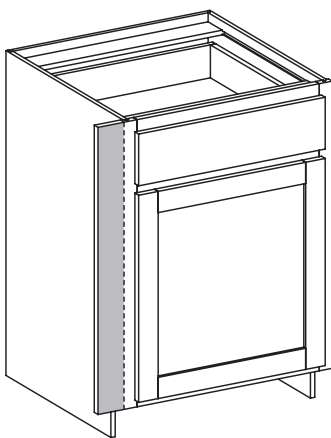

- Provides 3" wide frame extension (standard) for field trimming or custom width stile extensions to avoid cutting at installation.
- If CSEXT is ordered, stile width can be specified between 1/4" and 3" in 1/16" increments.
- For standard 3" extension specify: EXL (Extended Left), EXR (Extended Right) or EXB (Extended Both).
- For custom extension specify: CSEXL (Custom Extended Left), CSEXR (Custom Extended Right) or CSEXB (Custom Extended Both) followed by the width required.
- Available on most Wall, Base, Tall, Vanity and Home Office units.
- Use Conestoga's online ordering system, Con-Nex or Conestoga order entry for pricing.

Flush Toe (FT)

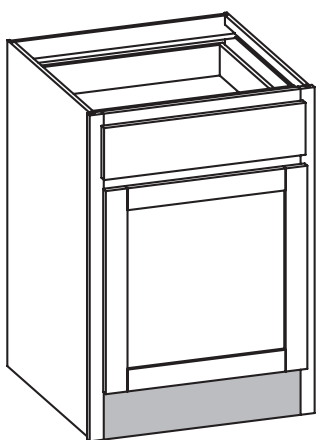

- Bottom rail height is 5-1/2".
- Specify: "FT" (Flush Toe).
- Cabinet side is manufactured without toe notch.
- 96" Tall cabinets do not use a toe platform.
- Available on most Base and Tall cabinets.
- Use Conestoga's online ordering system, Con-Nex or Conestoga order entry for pricing.

Leg Extension (LE)

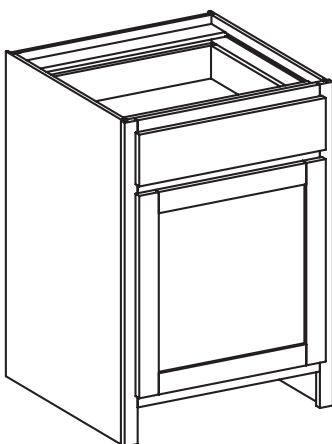

- Option extends exterior frame stiles to the floor into toe space for furniture "leg" styling.
- Specify "LE" – "L" (Left), "R" (Right) or "B" (Both).
- When "LE"- "B" is ordered with beaded inset, bottom opening will be beaded.
- Stile width is 1-1/2".
- Not available with loose toe platform or shaped bottom rail.
- Toe Space Side Option is available, not on the same side as the extension.
- Available on most Base, Tall and Vanity cabinets.
- Minimum cabinet width is 9".
- Toeboard Backer Option available. Install prior to final cabinet installation
- Use Conestoga's online ordering system, Con-Nex or Conestoga order entry for pricing.

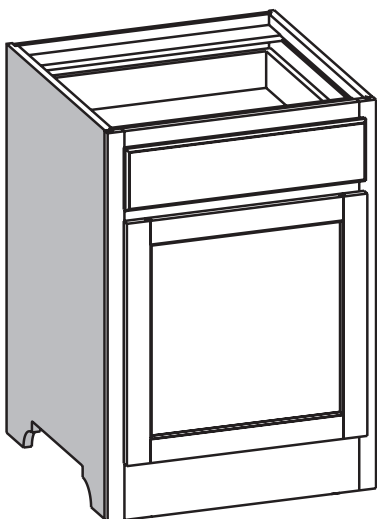
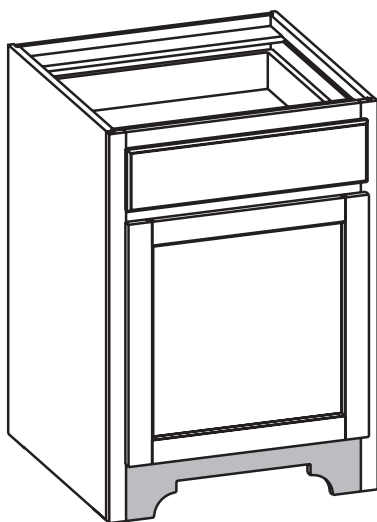
Shaped Bottom Rail (SBR)/Shaped Side Option (SS)

CWS6
Elegant Arch shown on both

- Rail height is 5-1/2". Flush toe is standard; cabinet side is constructed without toe notch.
- Roman, Elegant, Classic and Traditional Arch designs are centered on bottom rail and length of cabinet side.
- To order specify using CWS designations associated with the design – see shape options below.
- Not available with Loose Toe Platform (LTP) or Toe Space Side (TSS).
- Available on most Base, Tall and Vanity cabinets.
- Minimum cabinet width and depth is 15".
- **Shaped Side (SS)**
 - ♦ Specify "SS" – "L" (Left), "R" (Right) or "B" (Both).
 - ♦ Not available with Extended Stiles (EXT) or Flush Unexposed Ends (FUE).
- **Shaped Bottom Rail (SBR)**
 - ♦ Elegant 2 and Traditional 2 designs are available on the Left only, Right only or Both sides of the bottom rail.
 - ♦ Elegant 2 and Traditional 2 designs rise to 1-1/2" framing. These designs will not match Elegant or Traditional Arch designs.
 - ♦ Elegant 2 and Traditional 2 designs are not available with the Shaped Side Option.
- Use Conestoga's online ordering system, Con-Nex or Conestoga order entry for pricing.

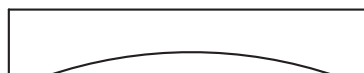
Shape Bottom Rail / Shaped Side

CWS4 – Roman Arch

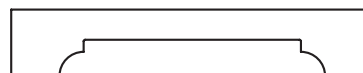

CWS6 – Elegant Arch



CWS5 – Classic Arch

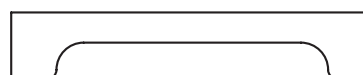

CWS7 – Traditional Arch

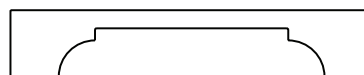
Shape Bottom Rail Only

Elegant 2:
AB1B – Both
AB1L – Left
AB1R – Right

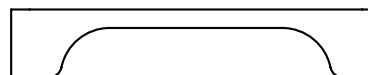

Traditional 2:
AB2B – Both
AB2L – Left
AB2R – Right

Shelf Options

Omit Shelving (OS)

- Choose to omit interior shelving in Wall, Base and Tall cabinets.
- Wall and Base Omit Shelving Option deletes all shelves.
- Tall cabinets: specify top, bottom or all shelves.
- Omits shelving only if shelf holes are not required, specify No Shelf Hole Option.
- Use Conestoga's online ordering system, Con-Nex or Conestoga order entry for pricing.

No Shelf Hole Option (NSH)

- Choose to omit line boring for shelf rests in Wall, Base and Tall cabinets.
- Most Wall and all Base No Shelf Hole Option deletes all holes.
- Two Tiered Wall (TTW) cabinets and Tall cabinets: specify Top, Bottom or All holes.
- Select No Shelf Holes Option only if shelves are not required, also specify Omit Shelving Option.
- No upcharge.

Extra Deep Shelf Option (EDS)

- Option increases shelf depth as cabinet depth is increased.
- Shelf depth is approximately 2" less than the overall cabinet depth.
- Plywood shelves only; not available with Solid Wood Shelf upgrade.
- Use Conestoga's online ordering system, Con-Nex or Conestoga order entry for pricing.

Solid Wood Shelf Upgrade (WS)

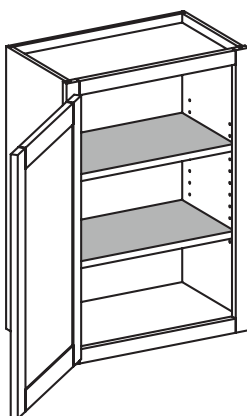

- Replaces 3/4" thick prefinished plywood shelving with 3/4" thick, prefinished solid wood shelving with a bullnose on front edge.
- Solid Wood Shelves available up to 18" deep.
- Solid Wood Shelf upgrade is not available with Matching Interior.
- Use Conestoga's online ordering system, Con-Nex or Conestoga order entry for pricing.

Matching Interior (MI)

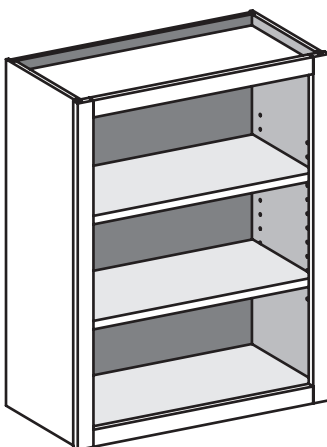

- Cabinets will have unfinished matching specie interior sides, tops, bottoms, shelves and backs.
- Specify: "MI" (Matching Interior).
- Flush unexposed ends are not available.
- Shelves are matching specie 3/4" plywood with veneer edgebanding on front edge.
- Matching specie available in Cherry, Hard Maple, Red Oak.
- Hard Maple and Soft Maple cabinets have Hard Maple veneered interior components.
- Cabinets with Matching Interior standard do not have the Matching Interior upcharge included in the cabinet price.

Dust Top (DT)

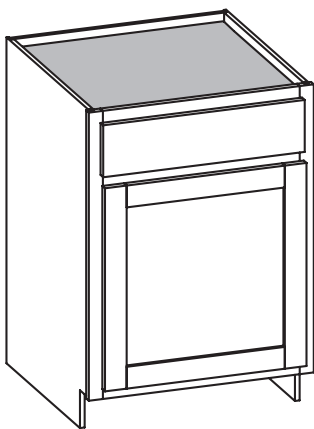

- Full top in place of front and back top strips.
- Use Conestoga's online ordering system, Con-Nex or Conestoga order entry for pricing.

Natural Finished Bottom (NB)

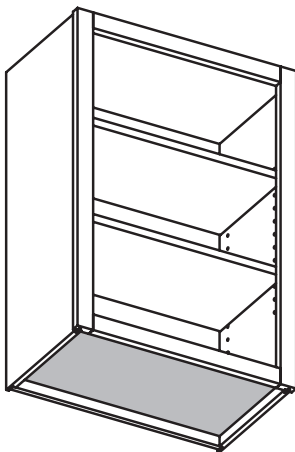

- Clear UV topcoated finish on White Birch veneer on top and bottom of Wall cabinets.
- To order, specify Natural finished bottom.
- Use Conestoga's online ordering system, Con-Nex or Conestoga order entry for pricing.

Custom Top Reveal (CTR)

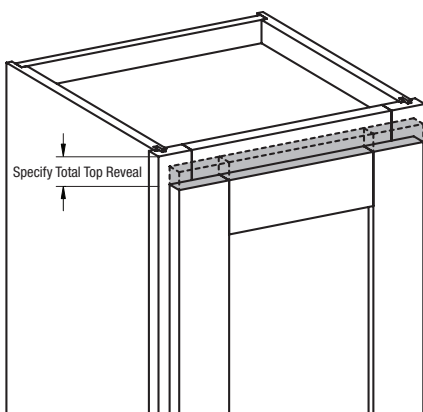

- Reduces door height to provide additional space to attach decorative mouldings directly to a cabinet front frame.
- Left, right and bottom reveal remain unchanged.
- Available with 1-1/4" and 1-3/8" overlay only.
1-1/4" overlay – 1/2" top reveal is standard, CTR available – 9/16" – 1-1/4". 1-3/8" overlay – 1/4" top reveal is standard, CTR available – 5/16" – 1-1/4".
- Reveal can be specified in 1/16" increments.
- Specify: "CTR" followed by the total amount of top reveal required.
- Maximum reveal is 1-1/4".
- See the Doors/Overlay Options Section for standard overlay rules.
- Use Conestoga's online ordering system, Con-Nex or Conestoga order entry for pricing.

Custom Bottom Reveal (CBR)

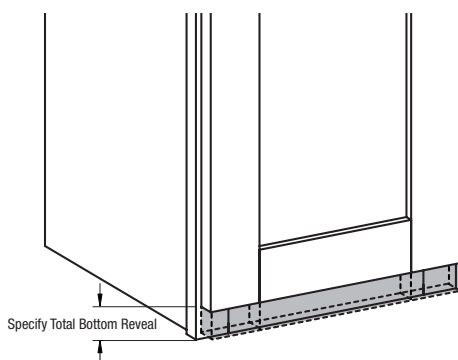

- Reduces door height to provide additional space to attach light rail or decorative mouldings directly to the bottom rail of the cabinet front frame.
- Left, right and top reveal remain unchanged.
- Available with 1-1/4" and 1-3/8" overlay only.
- Reveal can be specified in 1/16" increments.
- Specify: "CBR" followed by the total amount of bottom reveal required.
- Maximum reveal is 1-1/4".
- See the Doors/Overlay Options Section for standard overlay rules.
- Use Conestoga's online ordering system, Con-Nex or Conestoga order entry for pricing.

Increase Side Reveal (ISR)

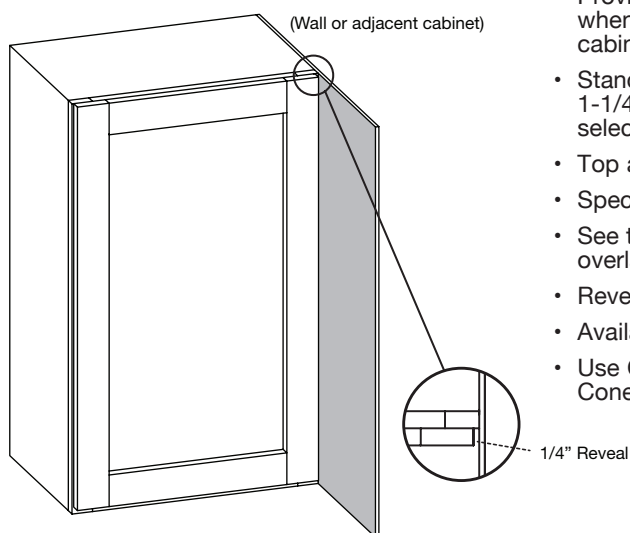

- Provides additional door clearance for 1-3/8" overlay when cabinets are installed adjacent to walls or deeper cabinetry.
- Standard reveal is changed from 1/8" to 1/4" and 1-1/4" overlay hinges will be provided when hinges are selected.
- Top and bottom reveal remain unchanged.
- Specify: "ISR" Left, Right or Both.
- See the Doors/Drawer Fronts Section for standard overlay rules.
- Reveal increased on the hinged side of doors.
- Available on most Wall, Base, Tall and Vanity cabinets.
- Use Conestoga's online ordering system, Con-Nex or Conestoga order entry for pricing.

Cabinet Hinge Options

BLUM Hinge Program Overview

- 1-piece steel, nickel-plated concealed hinges.
- Hinges packed in pairs or bulk pack and include mounting screws, installation instructions and warranty information.
- Hinge option is only available on door styles and edge profiles which support concealed hinge boring.
- Doors over 42" high will receive 3 hinges.
- Specify hinging Left or Right for single door cabinets if Hinge Boring Option is selected.
- Blum hinges carry a Limited-Lifetime Warranty.

COMPACT BLUMOTION – Hinges with Integrated Soft Close

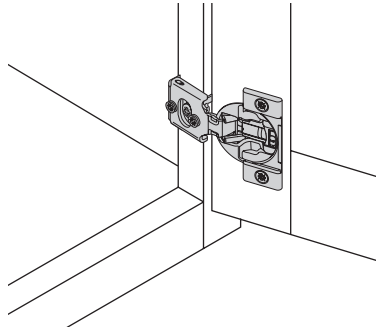

1/2" Overlay Hinge

Blum COMPACT BLUMOTION 38N
105° opening angle.

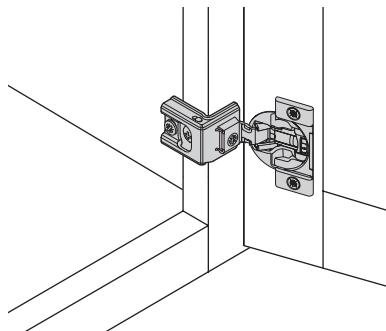

1-1/4" and 1-3/8" Overlay Hinge

Blum COMPACT BLUMOTION 39C
110° opening angle.

- Available for 1/2", 1-1/4" and 1-3/8" overlays.
- Available on 3/4" and 25/32" thick doors.
- Soft close feature is integrated within the hinge cup itself.
- Soft close function can be easily deactivated with a switch on individual hinges as needed based on the door size and weight.
- All hinges feature side, height, and depth adjustment for fine-tuning door spacing with wraparound front frame mounting for ease of installation.
- Blum COMPACT BLUMOTION hinges require Pattern "A" cup only boring.
- **Note:** When 1-1/4" or 1-3/8" overlay is ordered, Extended Stiles or Loose Filler Strips may be required in applications where cabinets are installed next to a tall cabinet, corner cabinet or a wall.
- Hinges available packaged in pairs or bulk pack (50 hinges per pack), including mounting screws.

COMPACT BLUMOTION Hinges (per pair)

Part #	Overlay
2100150A	1/2"
2100151A	1-1/4"
2100152A	1-3/8"

COMPACT BLUMOTION Bulk Pack Hinges (50 hinges)

Part #	Overlay
2100153A	1/2"
2100154A	1-1/4"
2100155A	1-3/8"

Cabinet Hinge Options (continued)

Blum Specialty Hinges

170° Hinges

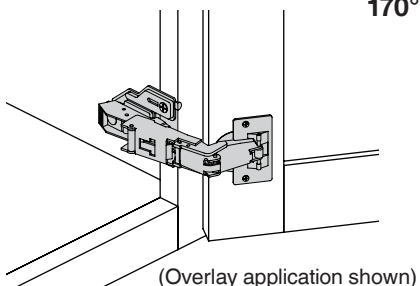

Overlay Application:

Blum 71T6550 hinge
Blum 175H6000 mounting plate

Inset Application:

Blum 71T6650 hinge
Blum 175H5030 mounting plate

- Provides full access to cabinet interiors with 170° opening angle for overlay and inset door applications.
- In 1-1/4" and 1-3/8" overlay applications, cabinets will have their doors sized as 1/2" overlay in width only.
- Available on 3/4" and 25/32" thick doors.
- 2-piece, clip style hinge with side, height and depth adjustment points.
- 170° corner hinges require Pattern "B" cup only boring.
- BLUMOTION soft close feature is not available.
- Standard on WCP and BCP cabinets.
- To order loose, specify:
 - Overlay application – part# 2100063A.
 - Inset application – part# 2100509A.
- Use Conestoga's online ordering system, Con-Nex or Conestoga order entry for pricing.

Inset Hardware

Inset Mounting Brackets for TANDEM plus BLUMOTION Drawer Slides

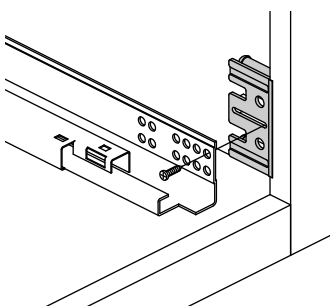

- Drawer slide adjustable mounting plate system for inset applications with framed cabinetry.
- Eliminates the need for supplemental blocking behind front frames to secure TANDEM slides.
- Sold in pairs, bracket sets include installation screws and instructions.
- Brackets afford up to 5/8" depth adjustment using standard TANDEM rear mounting brackets.
- To order loose, specify part# 2100200 (pairs).
- Use Conestoga's online ordering system, Con-Nex or Conestoga order entry for pricing.

Concealed Inset Hinges

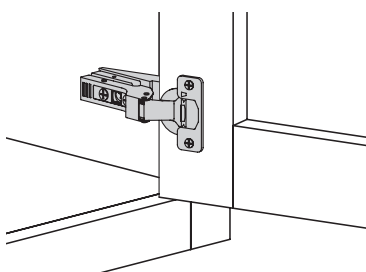
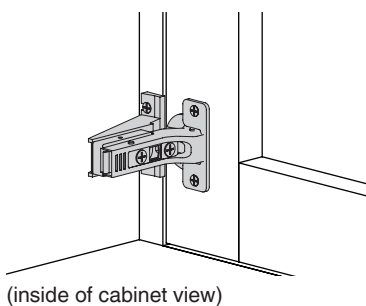

120° opening angle

Blum 71B3650NI hinge
Blum 175H5030.21 mounting plate

- Hinge and mounting plate system for concealed inset applications with framed cabinetry.
- Available on 3/4" and 25/32" thick doors.
- Soft close feature is integrated in the hinge cup.
- Hinge packs include screws and two adjustable door stops with bumpers.
- Concealed inset hinges require Pattern "B" cup only boring.
- Door and front frame thickness must match.
- To order loose, specify part# 2100067A (pairs).
- Use Conestoga's online ordering system, Con-Nex or Conestoga order entry for pricing.

Cabinet Hinge Options (continued)

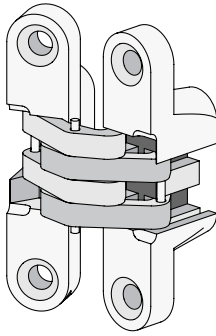

SOSS Hinge

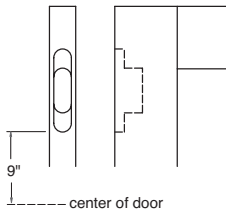

SOSS Hinge Option

- SOSS Hinge Model 204 Invisible Hinge provides 180 degree bi-fold hinge for corner pie cut cabinets.
- Available with WCP/CSWCP, WCPLS/CSWCLPLS, BCP/CSBCP and BCPLS cabinets.
- Available in Brass or Chrome finish; specify finish when ordering.
- Includes SOSS hinge boring; Routs are placed 9" off center, measure from the vertical center of the door to the start of the rout.
- Not available on doors over 42" high or under 25-1/8" high.

Drawer Slide Options

Blum TANDEM Plus BLUMOTION Integrated Soft Close

- Standard slide for drawer boxes in 12", 15", 18", 21", 24", 27" and 30" deep cabinets.
- Full extension zinc-coated steel with rear mount screw-in bracket (15", 18", 21" or 24" deep).
- Cabinet backs have pilot holes to locate rear mounting brackets.
- Side mount with cleats (12", 27", or 30" deep).
- 1/2" bottom reveal, undermount notch and hook hole required. Blum TANDEM sizing without slides also available.
- Blum drawer slides carry a Limited-Lifetime Warranty.
- Use Conestoga's online ordering system, Con-Nex or Conestoga order entry for pricing.

Ordering - Loose Parts

Cabinet Depth	Blum TANDEM Plus BLUMOTION
12" Deep	2100497A
15" Deep	2100498A
18" Deep	2100476A
21" Deep	2100475A
24" Deep	2100474A

Cabinet Depth	Blum MOVENTO with Soft Close
27" Deep	2100499A
30" Deep	2100500A