

## WEP – Wall End Panel

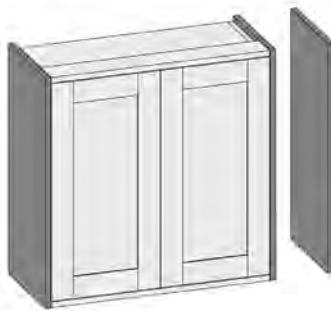

- When ordering Wall End Panel (WEP) enter cabinet depth and height and system will add 7/8" to width and 1-1/2" to the length of the panel to give the cabinet an inset look.
- WEPs are edgebanded on 4 sides with door matching edgeband color.
- For Intrigue TTS, Strata TTS and Vogue TTS doors the WEP material color will automatically configure to match the door material color.
- When wood doors with or without a finish are selected the plywood WEP is configured to match specie and finish if applicable (Cherry, Hard Maple, Paint Grade, Red Oak, Rift Cut White Oak and Walnut only).
- When using Con-Nex, select drop down in "Finish Side Left/Finish Side Right" to automatically configure WEP for cabinet.

## BEP – Base End Panel

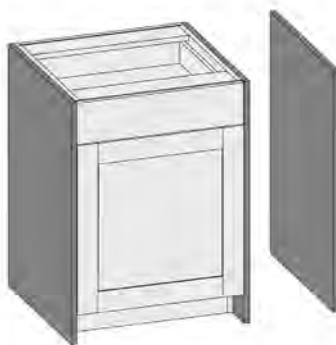

- When ordering Base End Panel (BEP) enter cabinet depth and height and system will add 7/8" to width of the panel to give the cabinet an inset look.
- BEPs are edgebanded on 4 sides with door matching edgeband color.
- For Intrigue TTS, Strata TTS and Vogue TTS doors the BEP material color will automatically configure to match the door material color.
- When wood doors, with or without a finish are selected the plywood BEP is configured to match specie and finish if applicable (Cherry, Hard Maple, Paint Grade, Red Oak, Rift Cut White Oak and Walnut only).
- When using Con-Nex, select drop down in "Finish Side Left/Finish Side Right" to automatically configure BEP for cabinet.
- BEP can also be used in conjunction with Wall and Tall cabinets when a flush top and bottom between cabinet and end panel is desired.

## TEP – Tall End Panel

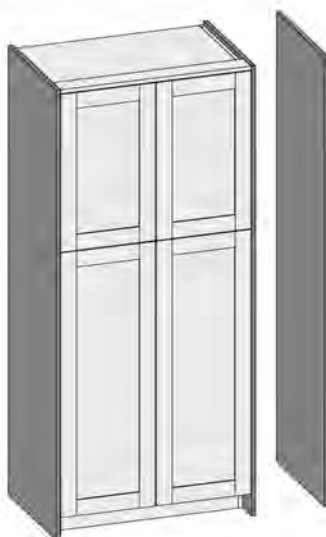

- When ordering Tall End Panel (TEP) enter cabinet depth and height and the system will add 7/8" to width and 3/4" to the length of the panel to give the cabinet an inset look.
- TEPs are edgebanded on 4 sides with door matching edgeband color.
- For Intrigue TTS, Strata TTS and Vogue TTS doors the TEP material color will automatically configure to match the door material color.
- When wood doors, with or without finish are selected, the plywood TEP is configured to match to specie and finish if applicable (Cherry, Hard Maple, Paint Grade, Red Oak, Rift Cut White Oak and Walnut only).
- When using Con-Nex select drop down in "Finish Side Left/Finish Side Right" to automatically configure TEP for cabinet.
- TEP can also be used in conjunction with Wall cabinets when a flush top or bottom between cabinet and end panel is desired.

## TP/CSTP – Trim Panel



- Trim Panels (TP) are edgebanded on 4 sides with door matching edgeband color.
- When ordering CSTP enter desired finished sizes.
- For Intrigue TTS, Strata TTS and Vogue TTS doors the TP material color will automatically configure to match the door material color.
- When wood doors with or without finish are selected, the plywood TP is configured to match the specie and finish (Cherry, Hard Maple, Paint Grade, Red Oak, Rift Cut White Oak and Walnut only).

SKU	Dimensions
TP0390	3" X 90"
TP0396	3" X 96"
TP1390	13-7/8" X 90"
TP1396	13-7/8" X 96"
TP1690	16-7/8" X 90"
TP1696	16-7/8" X 96"

## FS/CSFSW - Filler Strip (Wall)

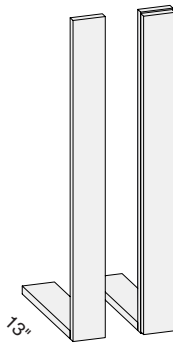

CSFSW (with overlay)

Custom Size Ranges  
 Width: 3" and 6" only  
 Height: 12" – 72"  
 Depth: 5-1/2" – 27"

- Order with or without 3/4" thick slab overlay.
- 3/4" thick slab overlay matches door color or door specie and finish.
- MCC available in Intrigue TTS, Strata TTS and Vogue TTS colors.

30" High	42" High
FS0330	FS0342
FS0630	FS0642

## FS/CSFSB - Filler Strip (Base)

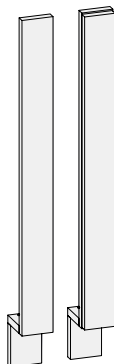

CSFSB (with overlay)

FS

Custom Size Ranges  
 Width: 3" and 6" only  
 Height: 31-1/2" – 96"  
 Depth: 4"

- Order with or without 3/4" thick slab overlay.
- 3/4" thick slab overlay matches door color or door specie and finish.
- MCC available in Intrigue TTS, Strata TTS and Vogue TTS colors.

34-1/2" High	84" High	96" High
FS0334.5	FS0684	FS0396
FS0634.5	FS0384	FS0696

### TTS Narrow Overlay Filler (Intrigue, Strata and Vogue)

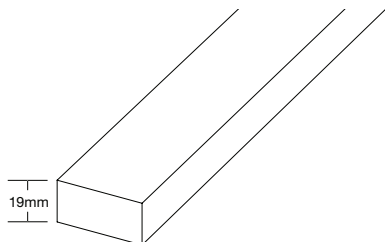

- Alternative Material Narrow Overlay Fillers (19mm thick) can be applied to installation fillers for full overlay trim applications.
- Filler width can be customized in 1/16" increments from 1-1/2" to 2-11/16" in width and lengths from 12" to 96".
- All edges are banded with matching edgeband – no option.
- Sold in pairs – no option.

### TTS L-Moulding (Intrigue, Strata and Vogue)

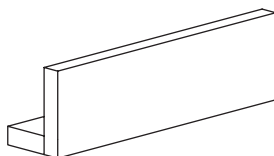

- Accent or trim moulding can be used as fascia or under cabinets as light rail.
- Face width can be customized in 1/16" increments from 2-3/4" to 8". Mounting plate is 2-3/4" wide - not customizable.
- L-Moulding length can be customized in 1/16" increments from 12" to 96".
- Matching color edgeband is standard. All edges are banded, including ends.

### TTS Scribe Moulding (Intrigue, Strata and Vogue)

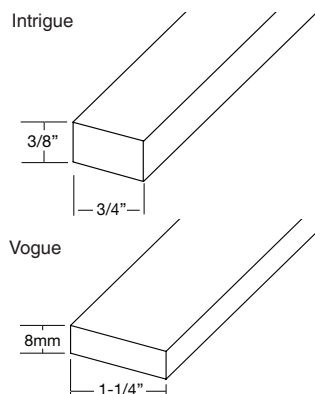

- Intrigue TTS Scribe Moulding is 3/8" thick x 3/4" wide x 96" long.
- Intrigue TTS Scribe is manufactured utilizing 19mm edgebanded panels, edgebanded on the face and both short edges of the moulding, while the two 3/8" thick long edges are the matching TFL board surface. The back of the moulding is uncoated for installation.
- Strata TTS and Vogue TTS Scribe Moulding is 8mm thick x 1-1/4" wide x 96" long.
- Strata TTS and Vogue TTS Scribe is manufactured utilizing edgebanded 8mm material, banded on one long edge and both short edges with matching edgeband.
- Moulding Cut-Down Option is available, but will remove one short edgebanded end.
- Sold in pairs – no option.

## Standard Lazy Susan Shelves

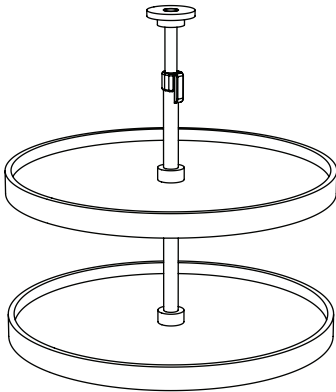

- White plastic susan with two independently rotating shelves mounted on a center pole.
- Shelves feature self lubricating nylon bearing and tool-free height adjustment.
- When standard lazy susan shelves are ordered, cabinet interior shelves are automatically omitted.
- See Con-Nex® for standard lazy susan upgrade pricing.

Part No.	Sized for Cabinet	Description
2102946	WCS/CSWCSE (30" High) WCA/CSWCA (48" High) TTWCSE/CSTTWCSE (48" High)	18" Full Round
2102947	BCFD/CSBCFD	32" Full Round
2102948	BLS/CSBLS	32" Kidney
2102949	BLS30/CSBLS30	24" Kidney

## CSFFK – Loose Fixed Floor Kit

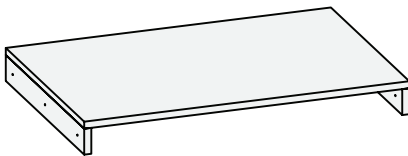

- Use Loose Fixed Floor Kits to horizontally segment almost any cabinet.
- Loose Fixed Floor Kits are sized to fit between side panels.
- To order specify CSFFK and the cabinet width and depth. Conestoga calculates the kit dimension based on the cabinet interior dimension.
- Use Conestoga's online ordering system, Con-Nex® or Conestoga order entry for pricing.

## CSLTP – Loose Toe Platform / Prep Loose for Toe Platform

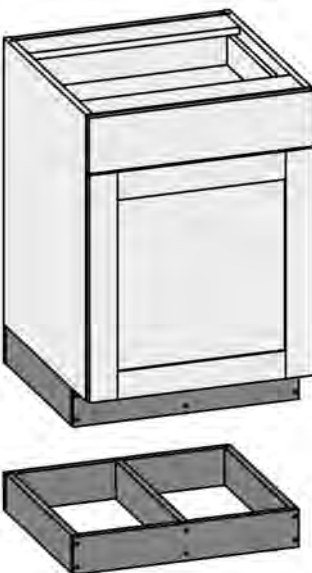

Custom Size Ranges  
 Width: 9" - 96"  
 Height: 4" fixed  
 Depth: 12" - 30"

- Loose Toe Platform is made with 3/4" prefinished Birch plywood regardless of cabinet material. Use end panels and Toeboard Strips to conceal Loose Toe Platform.
- When ordering as a cabinet option, specify Loose Toe Platform or Prep for Loose Toe Platform. Enter the desired cabinet width, height and depth. The system will automatically subtract 4" from the cabinet height and remove the toe kick to account for the Loose Toe Platform.
- Loose Toe Platform Option includes the Loose Toe Platform with the cabinet and does not need to be ordered separately.
- Prep for Loose Toe Platform Option reduces the cabinet height by 4" and removes the toe kick. Loose Toe Platform must be ordered separately.
- When ordering a custom size Loose Toe Platform independent of a cabinet, specify cabinet/cabinet run width and depth. Loose Toe Platform depth will be adjusted 3-3/4" to account for toe kick depth. Select Flush Toe Option to bring Loose Toe Platform flush with the cabinet front.
- Available on most cabinets that have a toe kick.

## ROS/CSROS – Roll Out Shelf

Custom Size Ranges  
Width: 24" – 36"  
Depth: 18", 21", 24",  
27", 30"

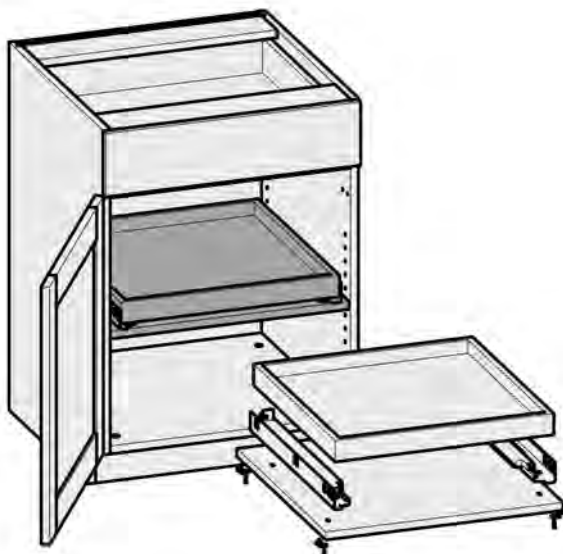

- Roll-Out Shelf (ROS) units can be added to most Full Access cabinets that have shelves 18" to 30" in depth.
- Each ROS unit contains one pre-drilled shelf, one set of Blum TANDEM Slides, Shelf Clips, and Screws. All provided shelf clips and screws must be used when installing ROS to prevent the shelf from tipping when fully extended. Conestoga will not be responsible for ROS failure or injury due to improper or incomplete installation.
- Standard drawer box height is 2". Taller drawer boxes are available and must be specified.
- When ordering ROS enter cabinet width and depth to get the correct size ROS unit. Remember to omit shelving in the cabinet to avoid having extra shelves.
- No Shelf Option is available when adding a loose ROS unit to an existing shelf or fixed cabinet floor. When No Shelf Option is selected, predrilled shelf is omitted, and customer is required to drill holes for slides. Drill locations are provided on the ROS assembly instructions.
- 27" & 30" deep cabinets use a 24" deep Blum TANDEM Slide. Drawer boxes will be manufactured at full depth with a spacer to accommodate the shorter slide length. When fully extended drawer boxes in deeper cabinet depths will not extend beyond the front of the cabinet.
- In Con-Nex, ROS units can be ordered as an option on a cabinet and all cabinet modifications will occur automatically.

### CSPOTB – Pull-Out Tray Base

Custom Size Ranges  
 Width: 15" – 36"  
 Depth: 15", 18", 21",  
 24", 27", 30"

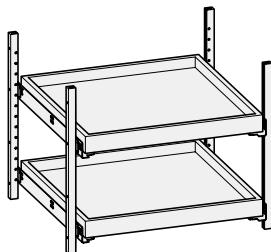

- CSPOTB includes 2 drawer boxes with a 2" height standard. Drawer box quantity and height is customizable.
- Each kit includes the following items.
  - ♦ 4 Prefinished Hard Maple Pilasters.
  - ♦ 1 hardware pack and 1 set of TANDEM Drawer Slides per drawer box.
- Pilaster length is 19-5/8" and fits a standard Base cabinet. Pilasters can be trimmed or stacked to fit most cabinet configurations.

### CSPOTBFD – Pull-Out Tray Base Full Door

Custom Size Ranges  
 Width: 15" – 36"  
 Depth: 15", 18", 21",  
 24", 27", 30"

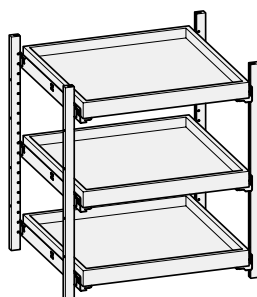

- CSPOTBFD includes 3 drawer boxes with a 2" height standard. Drawer box quantity and height is customizable.
- Each kit includes the following items
  - ♦ 4 Prefinished Hard Maple Pilasters.
  - ♦ 1 hardware pack and 1 set of TANDEM Drawer Slides per drawer box.
- Pilaster length is 27-3/16" and fits a standard Base full door cabinet. Pilasters can be trimmed or stacked to fit most cabinet configurations.

### CSPOTU – Pull-Out Tray Utility

Custom Size Ranges  
 Width: 15" – 36"  
 Depth: 15", 18", 21",  
 24", 27", 30"

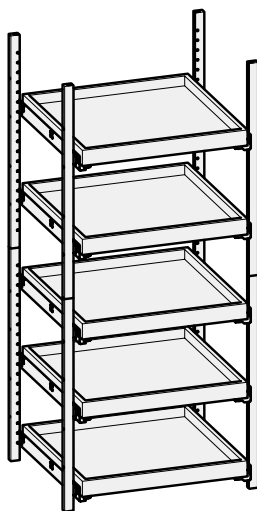

- CSPOTU includes 5 drawer boxes with a 2" height standard. Drawer box quantity and height is customizable.
- Each kit comes with the following items
  - ♦ 8 Prefinished Hard Maple Pilasters.
  - ♦ 1 hardware pack and 1 set of TANDEM Drawer Slides per drawer box.
- Pilaster length is 27-3/16" and is stacked to fit in a standard Utility cabinet. Pilasters can be trimmed or stacked to fit most cabinet configurations.