

Vesta Base Cabinet Standard Features and Options

The features below are standard on all Base cabinets where the design permits. Standard features can be omitted as needed. The option to omit standard features as well as add design options can be quickly referenced at the bottom of each page in the Base Cabinet Section labeled “Base Options Key”. For detailed descriptions and images of the options, see Options, Section 20 of this manual. Standard features and options are available on all Base cabinets unless specifically noted as **Unavailable Options**.

Edgeband – Our Base cabinets sides, tops, bottoms, mid-floors, stringers and shelves are edgebanded on the front edges only. Interior parts such as uprights or other support members are edgebanded on visible edges. Edgeband color must be specified to either match the case color (standard offering) or door color if applicable (upcharge applies). When Door Matching Edgeband Option is selected the front edges of the sides, top, bottom and mid-floor are edgebanded using the door color. The edgeband on the shelves and interior parts will match the interior case color. Door Matching Edgeband Option is available with all Allure DLV, Intrigue TTS, Strata TTS, Vogue TTS, Synchronicity High Gloss and Super Matte colors, as well as wood edgeband in Cherry, Hard Maple, Paint Grade, Red Oak, Rift Cut White Oak and Walnut.

5mm Shelf Holes – 5mm Shelf Holes are pre-drilled on 32mm centers on all cabinets with shelves. **No Shelf Holes (NSH)** and **Omit Shelving (OS)** Options are available on Base cabinets with shelves. If both the No Shelf Holes and Omit Shelving Options are required, both must be individually specified.

Hinge Hole Drilling – All Base cabinets eligible to receive doors will include Blum Frameless INSERTA Hinges and are pre-drilled with 5mm holes to accept the EXPANDO Mounting Plates. A **No Hinge Hole (NHH)** Option is available on any Base cabinet that would typically include doors. Cabinet hinges can also be omitted, but must be changed from the default Yes to No. The No Hinge Hole Option does not remove hinges; No Hinges must be specified.

Drawer Slide Hole Drilling – All Base cabinets that include drawer boxes also include Blum TANDEM Drawer Slides and are pre-drilled with 5mm holes for quick and easy installation. The **No Drawer Slide Hole (NDSH)** Option is available only on cabinets with drawer boxes. Drawer slides can be omitted, but must be changed from the default of Yes to No. The No Drawer Slide Hole Option does not automatically remove drawer slides; No Drawer Slides must be specified.

Toe Kick – Most Base cabinets come with a 3-3/4" x 4" Toe Kick Notch standard. Cabinets with a Toe Kick are available with either the **Flush Toe (FT)** and **Square Toe Notch (STN)** Options. The Flush Toe Option removes the Toe Kick from the cabinet and brings the toe backer flush with the cabinet front edge. The Square Toe Notch Option makes the intersecting corner of the Toe Notch 90° to aid in toeboard installation.

Matching Case Color (MCC) – With the Matching Case Color Option, the door and drawer front color matches the cabinet interior, exterior, and edgeband. The Matching Case Color Option is available with most Base cabinets and produced in all published Intrigue TTS, Strata TTS and Vogue TTS colors, as well as wood edgeband in Cherry, Hard Maple, Paint Grade, Red Oak, Rift Cut White Oak and Walnut.

Loose Toe Platform (LTP) – With the Loose Toe Platform Option, enter the desired cabinet height, deductions for the toe platform are calculated by our software which will automatically reduce by 4" and is produced without a toe kick. A 4" platform is provided to achieve the desired finished cabinet height. The Loose Toe Platform is available with most Base cabinets. Flush Toe and Square Toe Notch Options are not available with Loose Toe Platform.

Base Options Key: FT = Flush Toe LTP = Loose Toe Platform STN = Square Toe Notch MCC = Matching Case Color NHH = No Hinge Holes
NSH = No Shelf Holes NDSH = No Drawer Slide Holes OS = Omit Shelving

Design Notes:

Standard edgeband color matches cabinet interior color (Coastal White, Fog Grey or White Birch). If eligible, edgeband that matches doors/drawer fronts must be specified. Upcharge applies. Use fillers when installing cabinets adjacent to walls and other cabinets to ensure adequate clearance for doors and drawers. Conestoga recommends that exposed ends be capped with 19mm thick applied decorative end panels (optional and must be specified). When this treatment is used, adjust cabinet width(s) accordingly.

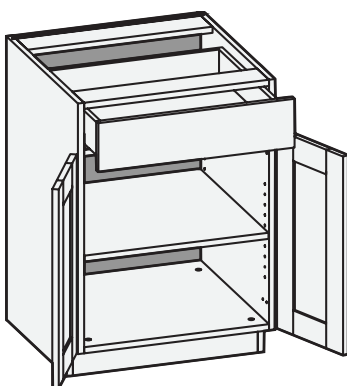
B/CSB - Base

Custom Size Ranges
 Single Door Width: 12" – 24"
 Butt Door Width: 24" – 36"
 Height: 31-1/2" – 42"
 Depth: 12", 13", 15", 16", 18",
 21", 24", 27", 30"

- When height changes, lower opening height changes. Drawer front height fixed at 5-15/16".
- Specify single or butt doors on custom size cabinets 24" wide.

24" Deep			
Single Door Cabinets		Butt Door Cabinets	
B1234.5	B2134.5	B2434.5BD	B3334.5BD
B1534.5	B2434.5	B2734.5BD	B3634.5BD
B1834.5		B3034.5BD	

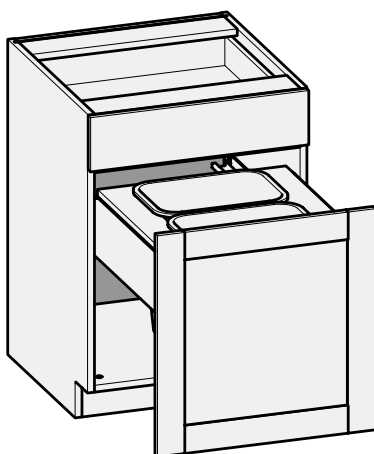
BTCP/CSBTCP - Base w/Trash Can Pull-Out

Custom Size Ranges
 Width: 18" – 27"
 Height: 31-1/2" – 34-1/2"
 Depth: 24"

- Cabinet depth is 24". Depth customization is not available due to Trash Can Pull-Out and hardware requirements.
- Trash Can Pull-Out unit is prefinished Natural Birch sides with a Hard Maple plywood top.
- Single can, double cans or units with no cut-outs are available.
- Pull-out unit is 6" high to accommodate door mounting.
- Units include 28 quart grey waste cans.
- Units 18" – 23-15/16" wide have one can; units 24" – 27" wide include 2 cans. When ordering custom size cabinets within these ranges, specify single can, double cans or no cut-outs.
- When cabinet height changes, lower opening height changes. Drawer front height fixed at 5-15/16".

24" Deep	
Single Can 34-1/2" High	Double Can 34-1/2" High
BTCP1834.5	BTCP2434.5
BTCP2134.5	BTCP2734.5

Base Options Key: FT = Flush Toe LTP = Loose Toe Platform STN = Square Toe Notch MCC = Matching Case Color NHH = No Hinge Holes
 NSH = No Shelf Holes NDSH = No Drawer Slide Holes OS = Omit Shelving

Design Notes:

Standard edgeband color matches cabinet interior color (Coastal White, Fog Grey or White Birch). If eligible, edgeband that matches doors/drawer fronts must be specified. Upcharge applies. Use fillers when installing cabinets adjacent to walls and other cabinets to ensure adequate clearance for doors and drawers. Conestoga recommends that exposed ends be capped with 19mm thick applied decorative end panels (optional and must be specified). When this treatment is used, adjust cabinet width(s) accordingly.

BS/CSBS - Base Sink w/Butt Doors

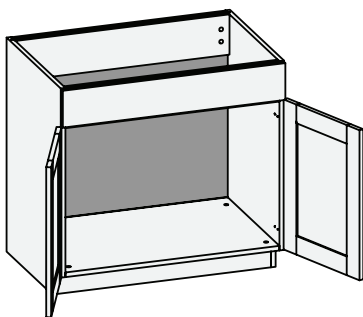

Custom Size Ranges
Width: 24" – 48"
Height: 31-1/2" – 42"
Depth: 18" – 30"

- False drawer front, height is fixed at 5-15/16".
- When height changes, lower opening height changes.
- Specify single or butt doors on custom size cabinets 24" wide.

24" Deep	
BS2434.5BD	BS3334.5BD
BS2734.5BD	BS3634.5BD
BS3034.5BD	

ASB/CSASB – Apron Sink Base

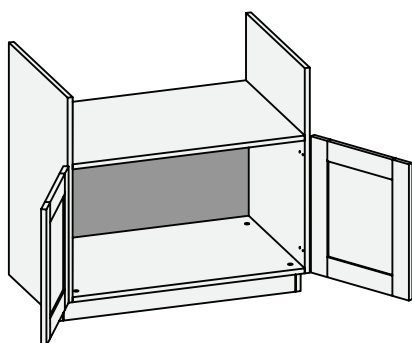

Custom Size Ranges
Width: 24" – 36"
Height: 31-1/2" – 42"
Depth: 18" – 30"

- When ordering Apron Sink Base Cabinet specify top sink bowl opening height.
- Order Trim Panels (TP/CSTP) as needed to trim out around the sink. See details in Section 19, Accessories.
- Reveal between top of doors and mid-floor is 1/8".

24" Deep	
ASB2434.5BD	ASB3334.5BD
ASB2734.5BD	ASB3634.5BD
ASB3034.5BD	

BSFD/CSBSFD – Base Sink Full Door w/ Butt Doors

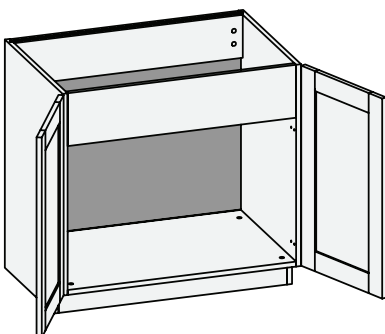

Custom Size Ranges
Width: 24" – 36"
Height: 31-1/2" – 34-1/2"
Depth: 18" – 30"

- 8" high apron conceals sink bowl, accommodates hinges and matches cabinet edgeband color.
- Specify single or butt doors on custom size cabinets 24" wide.

24" Deep	
BSFD2434.5BD	BSFD3334.5BD
BSFD2734.5BD	BSFD3634.5BD
BSFD3034.5BD	

Base Options Key: FT = Flush Toe LTP = Loose Toe Platform STN = Square Toe Notch MCC = Matching Case Color NHH = No Hinge Holes
NSH = No Shelf Holes NDSH = No Drawer Slide Holes OS = Omit Shelving

Design Notes:

Standard edgeband color matches cabinet interior color (Coastal White, Fog Grey or White Birch). If eligible, edgeband that matches doors/drawer fronts must be specified. Upcharge applies. Use fillers when installing cabinets adjacent to walls and other cabinets to ensure adequate clearance for doors and drawers. Conestoga recommends that exposed ends be capped with 19mm thick applied decorative end panels (optional and must be specified). When this treatment is used, adjust cabinet width(s) accordingly.

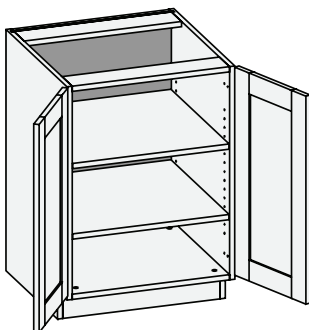
BFD/CSBFD - Base Full Door

Custom Size Ranges
 Single Door Width: 9" – 24"
 Butt Door Width: 24" – 36"
 Height: 10" – 42"
 Depth: 12" – 30"

- 10" – 22" high has no shelves.
- 22-1/16" – 28" high has one shelf.
- 28-1/16" – 40" high has two shelves.
- 40-1/16" – 42" high has three shelves.
- Specify single or butt doors on custom size cabinets 24" wide.

24" Deep			
Single Door Cabinets		Butt Door Cabinets	
BFD0934.5	BFD1834.5	BFD2434.5BD	BFD3334.5BD
BFD1234.5	BFD2134.5	BFD2734.5BD	BFD3634.5BD
BFD1534.5	BFD2434.5	BFD3034.5BD	

13" Deep			
Single Door Cabinets		Butt Door Cabinets	
BWD1234.5	BWD2134.5	BWD2434.5BD	BWD3334.5BD
BWD1534.5	BWD2434.5	BWD2734.5BD	BWD3634.5BD
BWD1834.5		BWD3034.5BD	

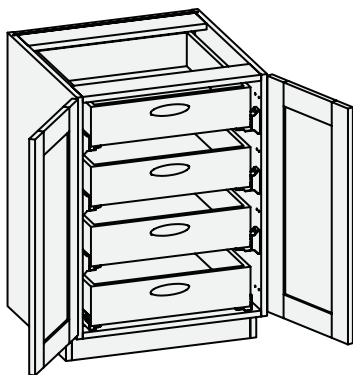
BFDRO/CSBFDRO - Base Full Door Roll-Out w/Butt Doors

Custom Size Ranges
 Width: 24" – 36"
 Height: 31-1/2" – 34-1/2"
 Depth: 12", 13", 15", 16",
 18", 21", 24", 27",
 30"

- Units are configured with four 5" high drawer boxes. Interior panels are pre-drilled for drawer slide placement and installation.
- Roll-out drawers include hand pulls. Specify Standard, Circle or Ellipse (shown) pull.

24" Deep			
Single Door Cabinets		Butt Door Cabinets	
BFDRO1234.5	BFDRO2134.5	BFDRO2434.5BD	BFDRO3334.5BD
BFDRO1534.5	BFDRO2434.5	BFDRO2734.5BD	BFDRO3634.5BD
BFDRO1834.5		BFDRO3034.5BD	

Base Options Key: FT = Flush Toe LTP = Loose Toe Platform STN = Square Toe Notch MCC = Matching Case Color NHH = No Hinge Holes
 NSH = No Shelf Holes NDSH = No Drawer Slide Holes OS = Omit Shelving

Design Notes:

Standard edgeband color matches cabinet interior color (Coastal White, Fog Grey or White Birch). If eligible, edgeband that matches doors/drawer fronts must be specified. Upcharge applies. Use fillers when installing cabinets adjacent to walls and other cabinets to ensure adequate clearance for doors and drawers. Conestoga recommends that exposed ends be capped with 19mm thick applied decorative end panels (optional and must be specified). When this treatment is used, adjust cabinet width(s) accordingly.

BOU/CSBOU – Base Open Unit



Custom Size Ranges
Width: 9" – 48"
Height: 10" – 48"
Depth: 8" – 30"

- 10" – 22" high has no shelves.
- 22-1/16" – 28" high has one shelf.
- 28-1/16" – 40" high has two shelves.
- 40-1/16" – 48" high has three shelves.

24" Deep	
BOU3034.5	BOU4234.5
BOU3334.5	BOU4534.5
BOU3634.5	BOU4834.5
BOU3934.5	

CSB1D – Base One Drawer

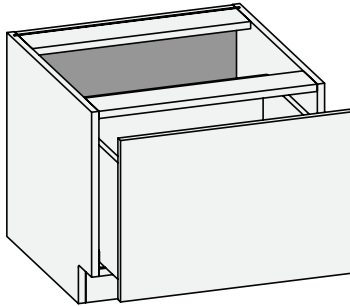

Custom Size Ranges
 Width: 12" – 36"
 Height: 12" – 21"
 Depth: 12", 13", 15", 16", 18",
 21", 24", 27", 30"

- When height changes, drawer box height changes proportionately.

B2D/CSB2D - Base Two Drawer

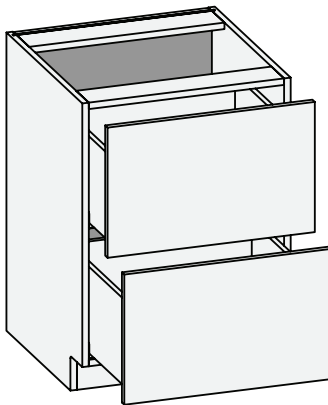

Custom Size Ranges
 Width: 12" – 39"
 Height: 31-1/2" – 34-1/2"
 Depth: 12", 13", 15", 16",
 18", 21", 24", 27",
 30"

- When height changes, both drawers remain equal in height.

24" Deep

B2D1234.5	B2D2734.5
B2D1534.5	B2D3034.5
B2D1834.5	B2D3334.5
B2D2134.5	B2D3634.5
B2D2434.5	B2D3934.5

B2DRO/CSB2DRO - Base Two Drawer Roll-Out

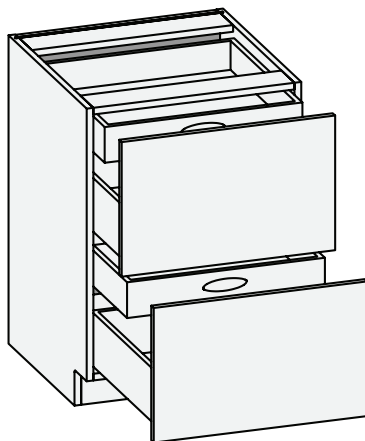

Custom Size Ranges
 Width: 12" – 39"
 Height: 31-1/2" – 34-1/2"
 Depth: 12", 13", 15", 16",
 18", 21", 24", 27",
 30"

- Units are configured with 4" high roll-out drawers over 6" high conventional drawer box in each opening.
- Roll-out drawers include hand pulls. Specify Standard, Circle or Ellipse (shown) pull.
- When height changes, both drawer heights are equal.

24" Deep

B2DRO1234.5	B2DRO2734.5
B2DRO1534.5	B2DRO3034.5
B2DRO1834.5	B2DRO3334.5
B2DRO2134.5	B2DRO3634.5
B2DRO2434.5	B2DRO3934.5

Base Options Key: FT = Flush Toe LTP = Loose Toe Platform STN = Square Toe Notch MCC = Matching Case Color NHH = No Hinge Holes
 NSH = No Shelf Holes NDSH = No Drawer Slide Holes OS = Omit Shelving

Design Notes:

Standard edgeband color matches cabinet interior color (Coastal White, Fog Grey or White Birch). If eligible, edgeband that matches doors/drawer fronts must be specified. Upcharge applies. Use fillers when installing cabinets adjacent to walls and other cabinets to ensure adequate clearance for doors and drawers. Conestoga recommends that exposed ends be capped with 19mm thick applied decorative end panels (optional and must be specified). When this treatment is used, adjust cabinet width(s) accordingly.

B3D/CSB3D - Base Three Drawer

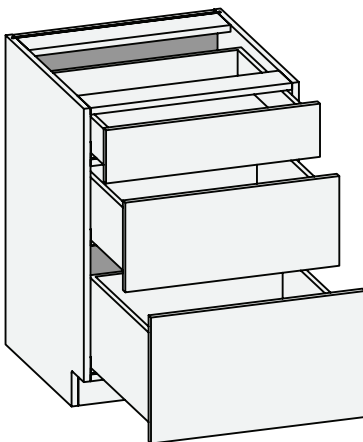

Custom Size Ranges
Width: 12" – 39"
Height: 31-1/2" – 34-1/2"
Depth: 12", 13", 15", 16",
18", 21", 24", 27",
30"

- When height changes, lower drawer height changes. Upper and middle drawer heights fixed at 5-15/16" and 10".

24" Deep	
B3D1234.5	B3D2734.5
B3D1534.5	B3D3034.5
B3D1834.5	B3D3334.5
B3D2134.5	B3D3634.5
B3D2434.5	B3D3934.5

B3DEH/CSB3DEH - Base Three Drawer w/Two Equal Height Lower Drawers

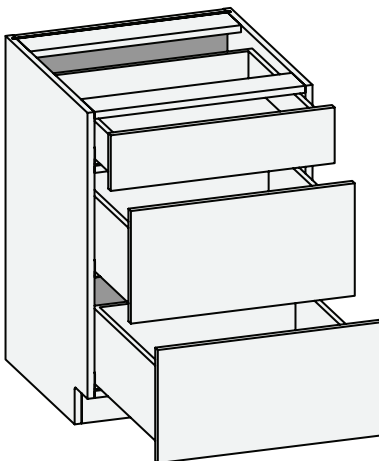

Custom Size Ranges
Width: 12" – 39"
Height: 31-1/2" – 34-1/2"
Depth: 12", 13", 15", 16",
18", 21", 24", 27",
30"

- When height changes, both lower drawer height changes. Upper drawer height fixed at 5-15/16".

24" Deep	
B3DEH1234.5	B3DEH2734.5
B3DEH1534.5	B3DEH3034.5
B3DEH1834.5	B3DEH3334.5
B3DEH2134.5	B3DEH3634.5
B3DEH2434.5	B3DEH3934.5

B4D/CSB4D - Base Four Drawer

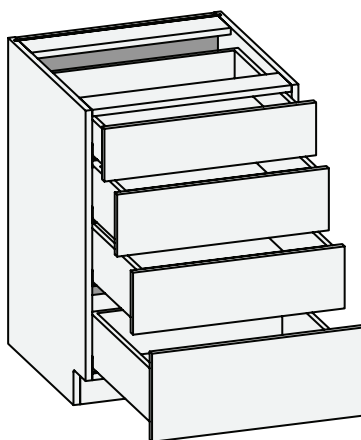

Custom Size Ranges
Width: 12" – 39"
Height: 31-1/2" – 34-1/2"
Depth: 12", 13", 15", 16",
18", 21", 24", 27",
30"

- When height changes, lower drawer height changes. Upper drawer front height fixed at 5-15/16". Middle drawer fronts fixed at 7" high.

24" Deep	
B4D1234.5	B4D2134.5
B4D1534.5	B4D2434.5
B4D1834.5	B4D2734.5

Base Options Key: FT = Flush Toe LTP = Loose Toe Platform STN = Square Toe Notch MCC = Matching Case Color NHH = No Hinge Holes
NSH = No Shelf Holes NDSH = No Drawer Slide Holes OS = Omit Shelving

Design Notes:

Standard edgeband color matches cabinet interior color (Coastal White, Fog Grey or White Birch). If eligible, edgeband that matches doors/drawer fronts must be specified. Upcharge applies. Use fillers when installing cabinets adjacent to walls and other cabinets to ensure adequate clearance for doors and drawers. Conestoga recommends that exposed ends be capped with 19mm thick applied decorative end panels (optional and must be specified). When this treatment is used, adjust cabinet width(s) accordingly.

BCP/CSBCP – Base Corner Pie Cut

Custom Size Ranges
 Width: 33" – 42"
 Height: 31-1/2" – 42"
 Depth: 33" – 42"

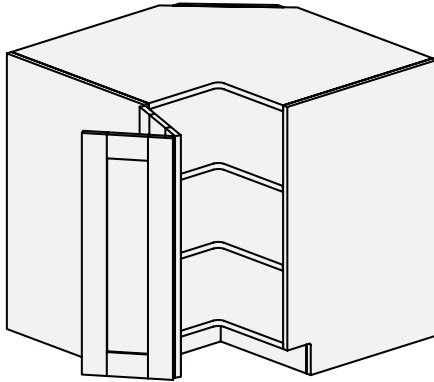

- Shelf mounted wood susan shelves are available. See Section 19 – Accessories.
- CSBCP available with custom size legs. Specified width (left dimension) and depth (right dimension). Side dimension remains fixed; pie cut opening adjusts as size changes.
- Minimum entry opening width required for BCP3634.5 is 35" (doorways, hallways etc.).
- Optional Soss hinges available.
- Unavailable Option: LTP

24" Deep Side

BCP3334.5

BCP3634.5

BCP3334.5

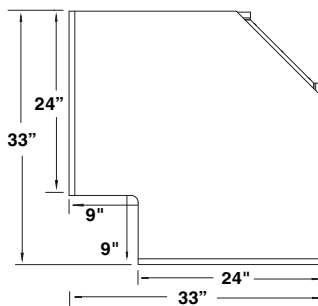

BCP3634.5

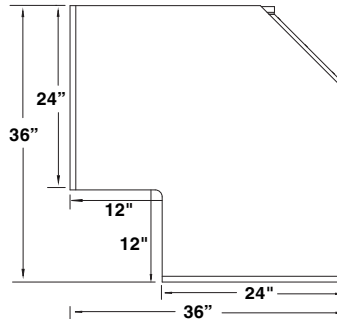

CSBCP

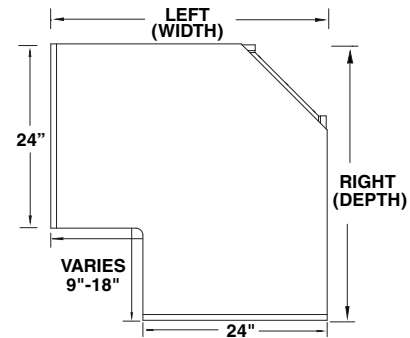

Base Options Key: FT = Flush Toe LTP = Loose Toe Platform STN = Square Toe Notch MCC = Matching Case Color NHH = No Hinge Holes
 NSH = No Shelf Holes NDSH = No Drawer Slide Holes OS = Omit Shelving

Design Notes:

Standard edgeband color matches cabinet interior color (Coastal White, Fog Grey or White Birch). If eligible, edgeband that matches doors/drawer fronts must be specified. Upcharge applies. Use fillers when installing cabinets adjacent to walls and other cabinets to ensure adequate clearance for doors and drawers. Conestoga recommends that exposed ends be capped with 19mm thick applied decorative end panels (optional and must be specified). When this treatment is used, adjust cabinet width(s) accordingly.

BCPLS – Base Corner Pie Cut Lazy Susan

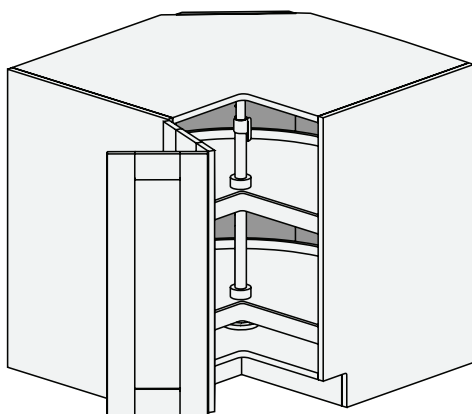

Custom Size Ranges
Width: 36"
Height: 34-1/2"
Depth: 36"

- Cabinet top and bottom is pre-drilled to accept hub assembly. Location and installation are greatly simplified.
- Cabinet includes 32" diameter plastic susan with two independently rotating kidney shelves mounted on a center pole.
- White susan shelves feature a self-lubricating nylon bearing and tool-free height adjustment.
- Height customization is not available due to susan size constraints.
- Minimum entry opening width required is 35" (doorways, hallways, etc.).
- Optional Soss hinges available.
- Unavailable Option: LTP

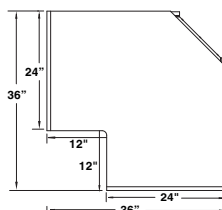

24" Deep Side

BCPLS3634.5

BCFD/CSBCFD - Base Corner Full Door

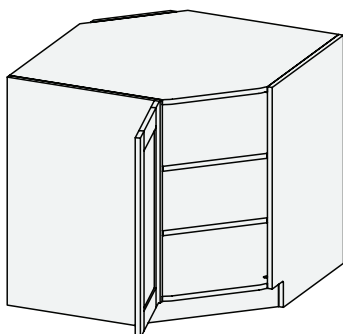

Custom Size Ranges
Width: 36"
Height: 31-1/2" – 42"
Depth: 36"

- 31-1/2" – 40" high has 2 shelves
- 40-1/16" – 42" high has 3 shelves.
- Shelf mounted wood susan shelves are available. See Section 19 – Accessories.
- Minimum entry opening width required is 35" (doorways, hallways, etc.).
- Unavailable Option: LTP

24" Deep Side

BCFD3634.5

BCFDLS - Base Corner Full Door w/ Lazy Susan

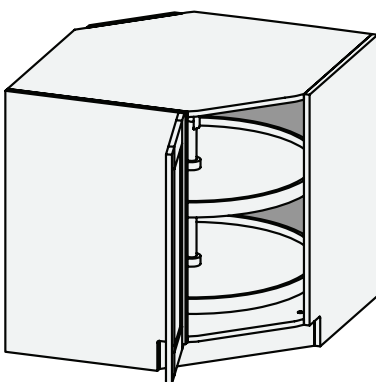

Custom Size Ranges
Width: 36"
Height: 34-1/2"
Depth: 36"

- Cabinet top and bottom is pre-drilled to accept hub assembly. Location and installation are greatly simplified.
- Cabinet includes 32" diameter plastic susan with two independently rotating shelves mounted on a center pole.
- White susan shelves feature a self-lubricating nylon bearing and tool-free height adjustment.
- Size customization is not available due to susan size constraints.
- Minimum entry opening width required is 35" (doorways, hallways, etc.).
- Unavailable Option: LTP

24" Deep Side

BCFDLS 3634.5

Base Options Key: FT = Flush Toe LTP = Loose Toe Platform STN = Square Toe Notch MCC = Matching Case Color NHH = No Hinge Holes
NSH = No Shelf Holes NDSH = No Drawer Slide Holes OS = Omit Shelving

Design Notes:

Standard edgeband color matches cabinet interior color (Coastal White, Fog Grey or White Birch). If eligible, edgeband that matches doors/drawer fronts must be specified. Upcharge applies. Use fillers when installing cabinets adjacent to walls and other cabinets to ensure adequate clearance for doors and drawers. Conestoga recommends that exposed ends be capped with 19mm thick applied decorative end panels (optional and must be specified). When this treatment is used, adjust cabinet width(s) accordingly.

BBCR/CSBBCR – Base Blind Cabinet Blind Right

Custom Size Ranges
 Width: 36" – 48"
 Height: 31-1/2" – 42"
 Depth: 12", 13", 15", 16", 18",
 21", 24", 27", 30"
 Functional opening: 12" – 24"

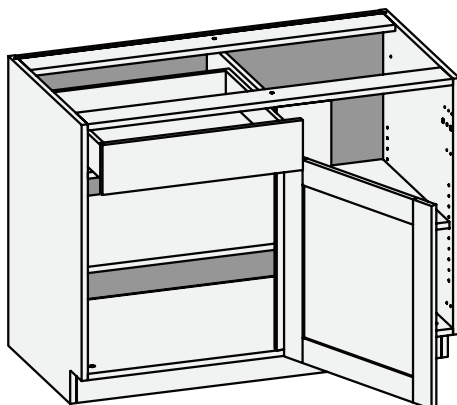

6-1/2" Wide Upright

- Overall cabinet size is the actual width specified.
- Blind section is on the right.
- Specify functional opening width between 12" and 24".
- Door is always hinged on center upright.
- When height changes, lower opening height changes. Drawer front height fixed at 5-15/16".
- Minimum exposed blind amount for all overlays is 2-1/2" to ensure adequate clearance for adjacent door and drawer function.
- Excessive hardware projection may require a greater amount of exposed blind. Design and install accordingly.
- Specify single or butt door when functional opening is 22-1/2".

24" Deep	
BBCR3634.5	BBCR4534.5
BBCR3934.5	BBCR4834.5
BBCR4234.5	

BBCL/CSBBCL – Base Blind Cabinet Blind Left

Custom Size Ranges
 Width: 36" – 48"
 Height: 31-1/2" – 42"
 Depth: 12", 13", 15", 16", 18",
 21", 24", 27", 30"
 Functional opening: 12" – 24"

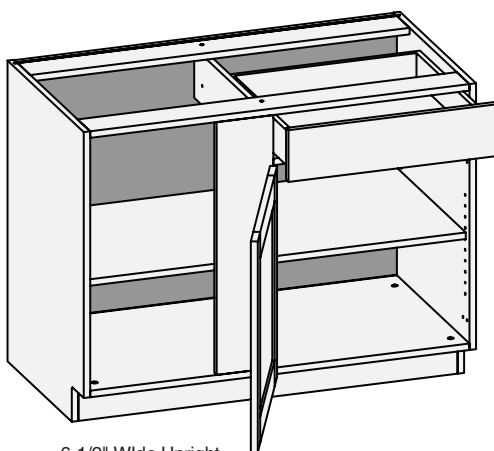

6-1/2" Wide Upright

- Overall cabinet size is the actual width specified.
- Blind section is on the left.
- Specify functional opening width between 12" and 24".
- Door is always hinged on center upright for all overlays.
- When height changes, lower opening height changes. Drawer front height fixed at 5-15/16".
- Minimum exposed blind amount for all overlays is 2-1/2" to ensure adequate clearance for adjacent door and drawer function.
- Excessive hardware projection may require a greater amount of exposed blind. Design and install accordingly.
- Specify single or butt door when functional opening is 22-1/2".

24" Deep	
BBCL3634.5	BBCL4534.5
BBCL3934.5	BBCL4834.5
BBCL4234.5	

Base Options Key: FT = Flush Toe LTP = Loose Toe Platform STN = Square Toe Notch MCC = Matching Case Color NHH = No Hinge Holes
 NSH = No Shelf Holes NDSH = No Drawer Slide Holes OS = Omit Shelving

Design Notes:

Standard edgeband color matches cabinet interior color (Coastal White, Fog Grey or White Birch). If eligible, edgeband that matches doors/drawer fronts must be specified. Upcharge applies. Use fillers when installing cabinets adjacent to walls and other cabinets to ensure adequate clearance for doors and drawers. Conestoga recommends that exposed ends be capped with 19mm thick applied decorative end panels (optional and must be specified). When this treatment is used, adjust cabinet width(s) accordingly.

BFDBCR/CSBFDBCR – Base Full Door Blind Cabinet Blind Right

Custom Size Ranges
Width: 36" – 48"
Height: 31-1/2" – 42"
Depth: 12" – 30"
Functional opening: 12" – 24"

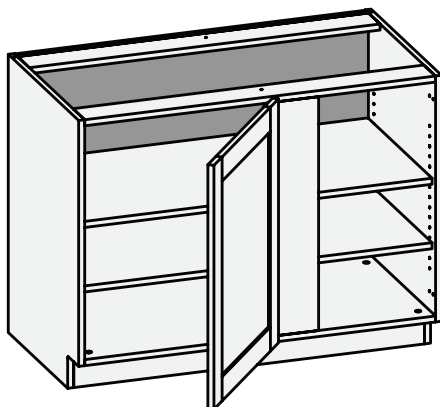

6-1/2" Wide Upright

- Overall cabinet size is the actual width specified.
- Blind section is on the right.
- Specify functional opening width between 12" and 24".
- Door is always hinged on center upright for all overlays.
- Door height and adjacent reveal will follow overlay specified.
- Minimum exposed blind amount for all overlays is 2-1/2" to ensure adequate clearance for adjacent door and drawer function.
- Excessive hardware projection may require a greater amount of exposed blind. Design and install accordingly.
- Specify single or butt door when functional opening is 22-1/2".

24" Deep	
BFDBCR3634.5	BFDBCR4534.5
BFDBCR3934.5	BFDBCR4834.5
BFDBCR4234.5	

BFDBCL/CSBFDBCL – Base Full Door Blind Cabinet Blind Left

Custom Size Ranges
Width: 36" – 48"
Height: 31-1/2" – 42"
Depth: 12" – 30"
Functional opening: 12" – 24"

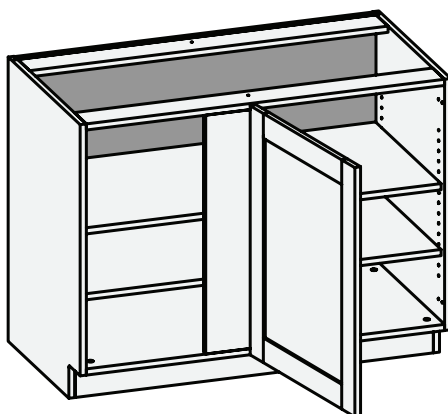

6-1/2" Wide Upright

- Overall cabinet size is the actual width specified.
- Blind section is on the left.
- Specify functional opening width between 12" and 24".
- Door is always hinged on center upright for all overlays.
- Door height and adjacent reveal will follow overlay specified.
- Minimum exposed blind amount for all overlays is 2-1/2" to ensure adequate clearance for adjacent door and drawer function.
- Excessive hardware projection may require a greater amount of exposed blind. Design and install accordingly.
- Specify single or butt door when functional opening is 22-1/2".

24" Deep	
BFDBCL3634.5	BFDBCL4534.5
BFDBCL3934.5	BFDBCL4834.5
BFDBCL4234.5	

Base Options Key: FT = Flush Toe LTP = Loose Toe Platform STN = Square Toe Notch MCC = Matching Case Color NHH = No Hinge Holes
NSH = No Shelf Holes NDSH = No Drawer Slide Holes OS = Omit Shelving

Design Notes:

Standard edgeband color matches cabinet interior color (Coastal White, Fog Grey or White Birch). If eligible, edgeband that matches doors/drawer fronts must be specified. Upcharge applies. Use fillers when installing cabinets adjacent to walls and other cabinets to ensure adequate clearance for doors and drawers. Conestoga recommends that exposed ends be capped with 19mm thick applied decorative end panels (optional and must be specified). When this treatment is used, adjust cabinet width(s) accordingly.

CSBCT2D – Base Cook Top Two Drawer

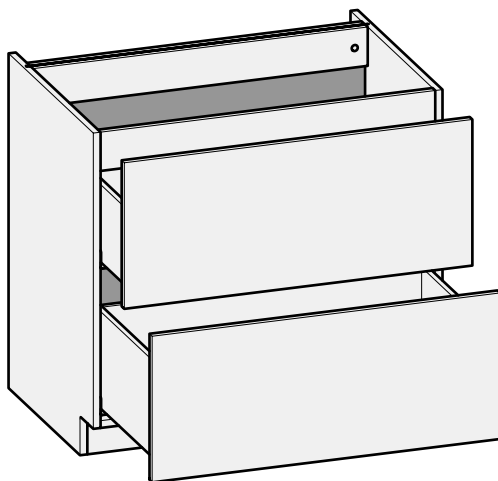

Custom Size Ranges
Width: 36" – 48"
Height: 27" - 34-1/2"
Depth: 24", 27", 30"

- Designed for countertop mounted professional-style cooktops (non-down draft ventilation units).
- Cabinet back recessed 3" to accommodate and conceal supply lines. Drawer box depth is 3" less due to the recessed back.
- Drawer front heights are equal.
- On cabinets less than 31-1/2" in height the top drawer box is 6" high to accommodate appliance housing. Bottom drawer box is 8" high.
- On cabinets equal to or greater than 31-1/2" in height the top drawer box is 8" high to accommodate appliance housing. Bottom drawer box is 10" high.

BR3D/CSBR3D – Base Range Three Drawer

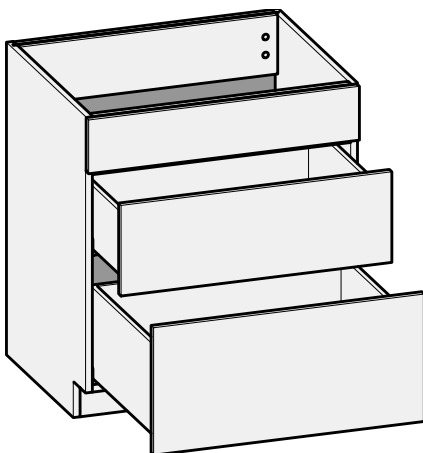

Custom Size Ranges
Width: 30" – 39"
Height: 31-1/2" – 34-1/2"
Depth: 12", 13", 15", 16",
18", 21", 24", 27",
30"

- False top drawer front.
- When height changes, lower opening height changes. Upper and middle drawer front heights fixed at 5-15/16" and 10".

24" Deep

BR3D3034.5

BR3D3634.5

Base Options Key: FT = Flush Toe LTP = Loose Toe Platform STN = Square Toe Notch MCC = Matching Case Color NHH = No Hinge Holes
NSH = No Shelf Holes NDSH = No Drawer Slide Holes OS = Omit Shelving

Design Notes:

Standard edgeband color matches cabinet interior color (Coastal White, Fog Grey or White Birch). If eligible, edgeband that matches doors/drawer fronts must be specified. Upcharge applies. Use fillers when installing cabinets adjacent to walls and other cabinets to ensure adequate clearance for doors and drawers. Conestoga recommends that exposed ends be capped with 19mm thick applied decorative end panels (optional and must be specified). When this treatment is used, adjust cabinet width(s) accordingly.

BRT2D/CSBRT2D - Base Range Top Two Drawer

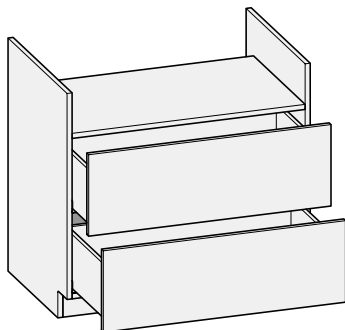

Custom Size Ranges
Width: 36" – 48"
Height: 34-1/2"
Depth: 24", 27", 30"

- Designed for professional-style cooktop units.
- 6" high standard opening includes full floor to support appliance. Opening height is customizable from 5" to 8" in 1/16" increments.
- Cabinet back recessed 3" to accommodate and conceal supply lines. Drawer box depth is 3" less due to the recessed back.
- Both drawer boxes are 8" high.

24" Deep	
BRT2D3634.5	BRT2D4534.5
BRT2D3934.5	BRT2D4834.5
BRT2D4234.5	

BUCM/CSBUCM - Base Under Counter Microwave

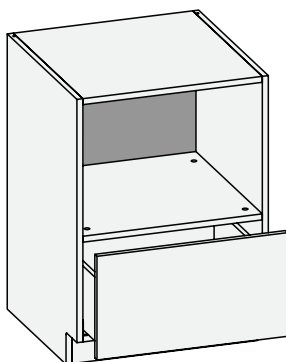

Custom Size Ranges
Width: 24" – 36"
Height: 24" - 42"
Depth: 12", 13", 15", 16", 18",
21", 23", 27", 30"

- For 34-1/2" high cabinets, top opening height is 16-1/2".
- When height changes, upper opening height changes. Lower drawer front height fixed at 13".

24" Deep
BUCM2434.5
BUCM2734.5
BUCM3034.5

BIUCM/CSBIUCM – Built In Under Counter Microwave

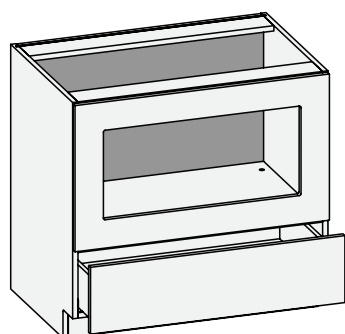

Custom Size Ranges
Width: 24" – 36"
Height: 24" - 42"
Depth: 12", 13", 15", 16", 18",
21", 23", 27", 30"

- Customer to specify height and width of Microwave opening in trim panel.
- For 34-1/2" high cabinets, top opening height is 19-3/4".
- Maximum Microwave opening height is top opening minus 5".
- Maximum Microwave opening width is cabinet width minus 6".
- When height changes, upper opening height changes. Lower drawer front height fixed at 9-1/2".

24" Deep	
BIUCM2734.5	BIUCM3334.5
BIUCM3034.5	BIUCM3634.5

Base Options Key: FT = Flush Toe LTP = Loose Toe Platform STN = Square Toe Notch MCC = Matching Case Color NHH = No Hinge Holes
NSH = No Shelf Holes NDSH = No Drawer Slide Holes OS = Omit Shelving

Design Notes:

Standard edgeband color matches cabinet interior color (Coastal White, Fog Grey or White Birch). If eligible, edgeband that matches doors/drawer fronts must be specified. Upcharge applies. Use fillers when installing cabinets adjacent to walls and other cabinets to ensure adequate clearance for doors and drawers. Conestoga recommends that exposed ends be capped with 19mm thick applied decorative end panels (optional and must be specified). When this treatment is used, adjust cabinet width(s) accordingly.